

INSTALLATION AND CARE INSTRUCTIONS

Synergy[®] Structure 2[™]

ACN# 088 609 661

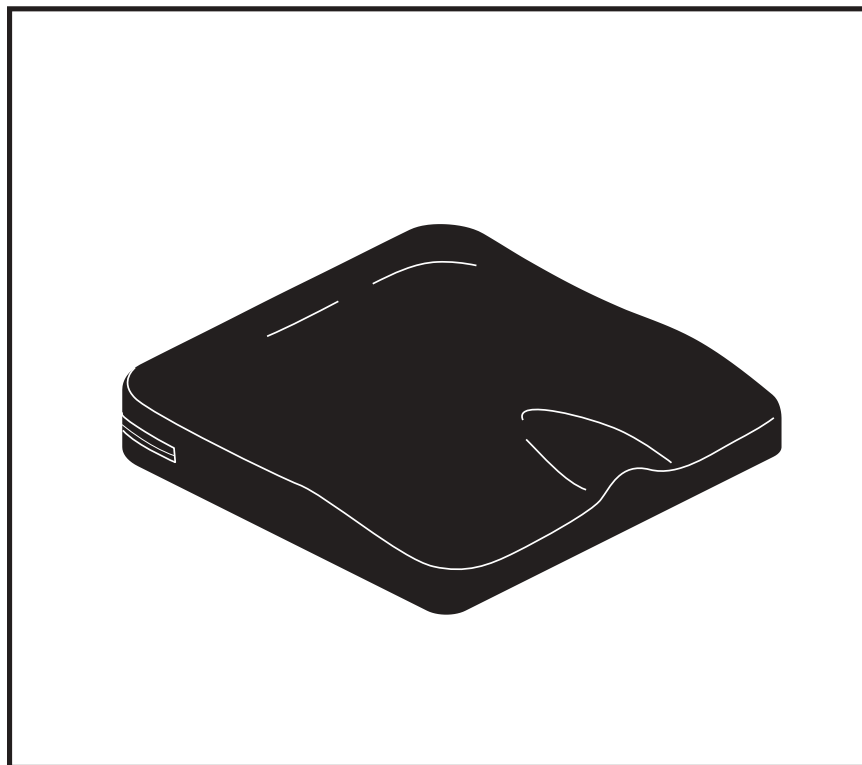

QUANTUM[®]
REHAB

A Division of Pride Mobility Products[®] Corp.

INFORMATION LABELING



WARNING! A Quantum Rehab Specialist or a qualified technician must perform the initial setup of this product and must perform all of the instructions in this manual.

The symbols below are used throughout this owner's manual and on the product to identify warnings and important information. It is very important for you to read them and understand them completely.



WARNING! Indicates a potentially hazardous condition/situation. Failure to follow designated procedures can cause either personal injury, component damage, or malfunction. On the product, this icon is represented as a black symbol on a yellow triangle with a black border.



MANDATORY! These actions should be performed as specified. Failure to perform mandatory actions can cause personal injury and/or equipment damage. On the product, this icon is represented as a white symbol on a blue dot with a white border.



PROHIBITED! These actions are prohibited. These actions should not be performed at any time or in any circumstances. Performing a prohibited action can cause personal injury and/or equipment damage. On the product, this icon is represented as a black symbol with a red circle and a red slash.

NOTE: These instructions are compiled from the latest specifications and product information available at the time of publication. We reserve the right to make changes as they become necessary. Any changes to our products may cause slight variations between the illustrations and explanations in this manual and the product you have purchased. The latest/current version of this manual is available on our website.

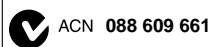

Copyright © 2007

Pride Mobility Products Corporation

INFMANU3432/Rev B/December 2007

TABLE OF CONTENTS

LABEL INFORMATION	4
INTRODUCTION	5
THE SYNERGY STRUCTURE 2	7
CLEANING	8
ASSEMBLING AND ADJUSTING THE POSITIONING COMPONENTS	9
CARE AND MAINTENANCE	11
WARRANTY	11

LABEL INFORMATION

PRODUCT SAFETY SYMBOLS

The symbols below are used on the product to identify warnings, mandatory actions, and prohibited actions. It is very important for you to read and understand them completely.



Read and follow the information in the owner's manual.

INTRODUCTION

WELCOME to Quantum Rehab, a division of Pride Mobility Products Corporation (Pride). The product you have purchased combines state-of-the-art components with **safety**, comfort, and styling in mind. We are confident that the design features will provide you with the conveniences you expect during your daily activities. Understanding how to **safely** use and care for this product should bring you years of trouble free operations and service.

Read and follow all instructions, warnings, and notes in this manual before attempting to operate your product for the first time. You must also read all instructions, warnings, and notes contained in any supplemental instructional booklets for the controller, front riggings, and/or seating system that accompanied your power chair before initial operation. Your **safety** depends upon you, as well as your provider, caretaker, or healthcare professional in using good judgement.

This manual is to be used in addition to the owner's manual that came with your chair. If there is any information in this manual which you do not understand, or if you require additional assistance for setup or operation, please contact your Quantum Rehab Specialist. **Failure to follow the instructions, warnings, and notes in this manual and those located on your Pride product can result in personal injury and/or product damage and will void Pride's product warranty.**

PURCHASER'S AGREEMENT

By accepting delivery of this product, you promise that you will not change, alter, or modify this product or remove or render unusable or unsafe any guards, shields, or other safety features of this product; fail, refuse, or neglect to install any retrofit kits from time to time provided by Pride to enhance or preserve the safe use of this product.

INFORMATION EXCHANGE

We want to hear your questions, comments, and suggestions about this manual. We would also like to hear about the safety and reliability of your new Pride product, and about the service you received from your Quantum Rehab Specialist. Please notify us of any change of address, so we can keep you apprised of important information about safety, new products, and new options that can increase your ability to use and enjoy your Pride product.

NOTE: If you ever lose or misplace your product registration card or your copy of this manual, contact us and we will be glad to send you a new one immediately.

My Quantum Rehab Specialist Is:

Name: _____

Address: _____

Phone Number: _____

Purchase Date: _____

THE SYNERGY STRUCTURE 2

The Synergy Structure 2 is labeled to assure proper placement on the chair.



WARNING! Altering the fitting position set by your healthcare professional can lead to pinching, skin abrasions, or bedsores/decubitis ulcers. Maintain the cushion in the prescribed position to ensure safe, comfortable use.

NOTE: *The Synergy Structure 2 arrives assembled and optional kits that contain additional side, leg, and well positioning pieces are available. These optional components are to be arranged by a medical professional before using your cushion. If at any time during use the positioning pieces need to be adjusted, please notify your healthcare provider.*

To place the Synergy Structure 2 on the chair:

1. Locate the “Front Bottom” label on the underside of the cushion.
2. Place the cushion on the seat so that the “Front Bottom” label is located on the front of the seat, label side facing down. The zipper on the cushion will face the rear side of the seat. See figure 1.



WARNING! Extreme temperatures can affect the temperature of your cushion components and may cause skin irritation. Use caution when your power chair has been used or stored in an extremely hot or cold environment.

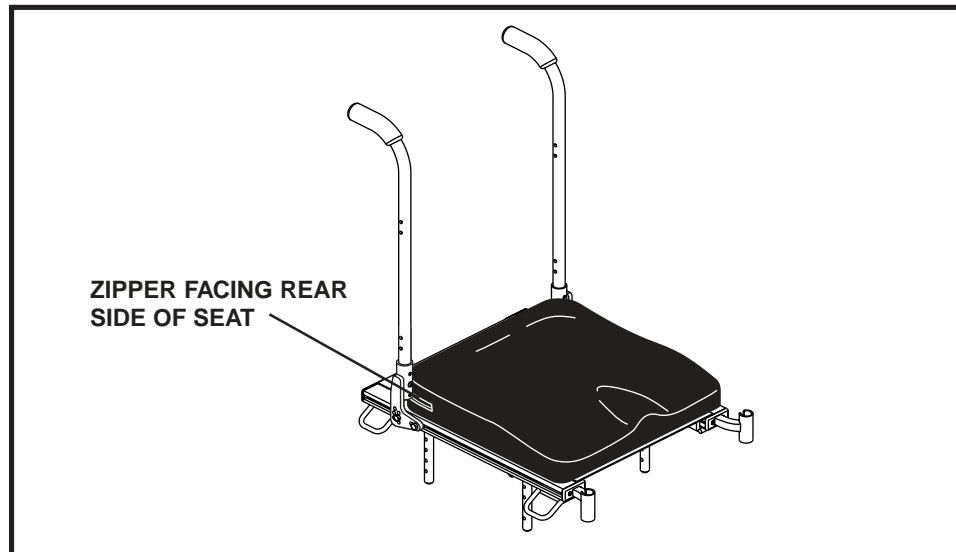

Figure 1. Cushion Placement

CLEANING

The Synergy Structure 2 can be easily cleaned.

To clean the Synergy Structure 2:

1. Locate the zipper on the rear side of the outer cover. See figure 2.
2. Unzip the outer cover and pull out the assembled inner cushion components.
3. Wash the outer cover in a washing machine on the COLD setting.



WARNING! To prevent damage to the seat cover, do not use bleach when cleaning the outer cover.

4. Spray the foam and fluid overlay, gel underlay, and optional components with a disinfectant, wipe clean, and air dry.



WARNING! Do not remove any positioning pieces during cleaning.

5. Allow the outer cover to air dry.



WARNING! To prevent shrinking of the outer cover, do not dry it in a clothes dryer.

6. Once the cover is dry, put the assembled inner cushion components back inside the cover. Zip the cover closed, and place the Synergy Structure 2 back onto the seat of your chair.

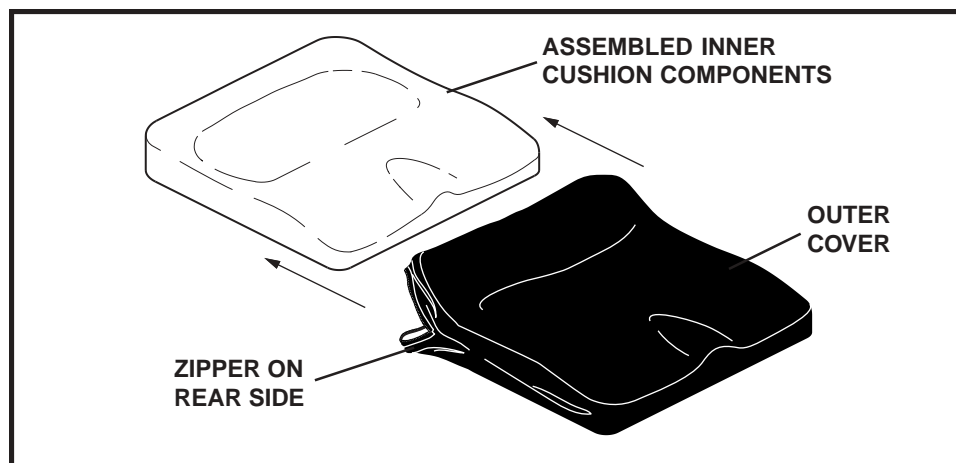

Figure 2. Synergy Structure 2

ASSEMBLING AND ADJUSTING THE POSITIONING COMPONENTS

The Synergy Structure 2 arrives assembled and optional kits that contain additional side, leg, and well positioning pieces are available. The positioning pieces are comprised of pads that “stick” to the base with reusable hook and loop fasteners and can be used in any combination to maximize the user’s comfort. The positioning pieces can be adjusted as needed.

To assemble the Synergy Structure 2:

1. Place any optional positioning pieces on the cushion base as needed for maximum therapeutic advantage. See figure 3.
2. Place the gel underlay on the cushion base as shown in figure 3.
3. Place the foam and fluid overlay on the cushion base as shown in figure 3.
4. Place the assembled cushion into the outer cover and zip the outer cover closed.

To adjust the positioning pieces:

1. Remove the outer cover.
2. Remove the foam and fluid overlay from the cushion base.
3. Remove the gel underlay from the cushion base.
4. Place or adjust the optional positioning pieces as needed.
5. Reassemble the cushion as described above.

NOTE: Pride highly recommends that the Synergy Structure 2 optional positioning components be assembled and adjusted by your healthcare professional only. These components are to be arranged by your healthcare professional before using your cushion. Do not attempt to adjust the positioning pieces while sitting on the cushion.

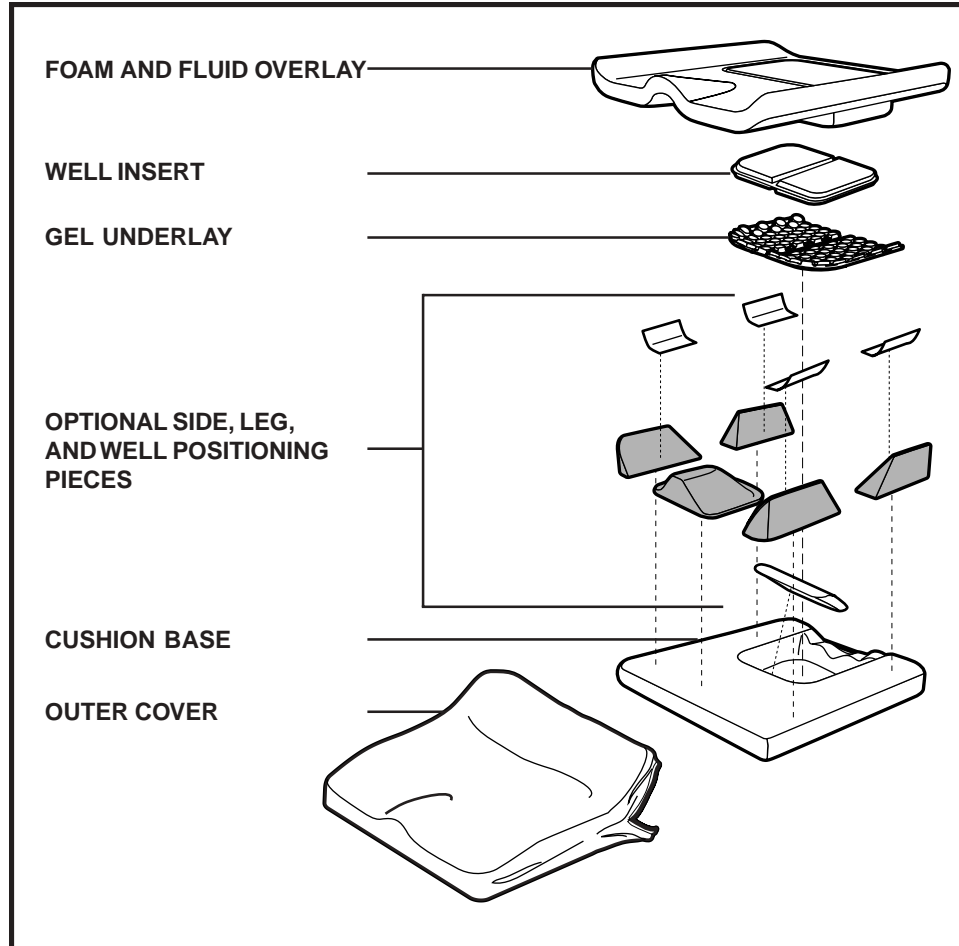

Figure 3. The Structure 2 Cushion, Disassembled

NOTE: Optional positioning pieces may include reuseable hook and loop fastener positioning stabilizers which provide enhanced stability when using the optional positioning pieces. Contact your Quantum Rehab Specialist if your optional positioning pieces require adjustment or repositioning.

CARE AND MAINTENANCE

Refer to your power chair owner's manual for proper disposal instructions.

Be aware of safety issues while smoking.



WARNING! Pride strongly recommends that you do not smoke cigarettes while seated in your seating system although the seating system has passed the necessary testing requirements for cigarette smoking. You must adhere to the following safety guidelines if you decide to smoke cigarettes while seated in your seating system.

- Do not leave lit cigarettes unattended.
- Keep ashtrays a safe distance from the seating system.
- Always make sure cigarettes are completely extinguished before disposal.

WARRANTY

The Synergy Structure 2 cushion is designed and produced to the highest of standards. Our Synergy cushion is guaranteed to be free of defects in material and workmanship for a period of 24 months. If any defect in material or workmanship is found, Pride Mobility Products will repair or replace, at our discretion, the Synergy cushion. This warranty does not apply to cushions abused or misused by the user and deemed such by Pride Mobility Products.

Claims and repairs should be processed through the nearest Quantum Rehab Specialist.

QUANTUM[®] **REHAB**

A Division of Pride Mobility Products[®] Corp.

Pride Mobility Products Corporation

182 Susquehanna Avenue
Exeter, PA 18643-2694
USA

Pride Mobility Products Company

380 Vansickle Road Unit 350
St. Catharines, Ontario L2R 6P7
Canada

Pride Mobility Products Ltd.

32 Wedgwood Road
Bicester, Oxon OX26 4UL
UK

Pride Mobility Products Australia Pty. Ltd.

21 Healey Road
Dandenong, 3175
Victoria, Australia

Pride Mobility Products Italia S.r.l.

Via del Progresso - ang. Via del Lavoro
Loc. Prato della Corte
00065-Fiano Romano (RM)

Pride Mobility Products Europe B.V.

Tijnmuiden 28
1046 AL Amsterdam
The Netherlands

Pride
Mobility Products Corp.

www.pridemobility.com

www.prideservice.com

www.quantumrehab.com

* I NFMANU3432 *