



PRIDE[®]
M O B I L I T Y

TRAVEL/SCOOTER COLLECTION

4-5

Go Go Elite Traveller® 2 Platinum / Victory® Platinum

...

6-7

Go Go Elite Traveller® 2

...

8-9

PX4

...

10-11

Pursuit 2

...

12-13

Zero Turn 10 / i-Go™

...

14-15

Go Go® Carbon / Go Go Elite Traveller®

...

16-17

Go Go® Sport / Go Go® Endurance Li

...

18-19

Go Go® Ultra X / Maxima

...

20-21

Revo® 2.0 / Victory® LX Sport

...

22-23

Victory® 10 / Victory® 10.2

...

24

Victory® 9



“

MY PRIDE SCOOTER HAS
BEEN A LIFESAVER
FOR ME. I COULD NOT
DO LIFE WITHOUT IT.

— Etta G.,
White Plains, NY

PROUDLY MADE IN
AMERICA
OF FOREIGN AND DOMESTIC PARTS



Go Go Elite Traveller® 2 Platinum

With premium features galore, the Go Go Elite Traveller® 2 Platinum is a next-generation mobility solution. EZ Turn technology, Charge360 magnetic charging, feather-touch disassembly, a convenient adjustable tiller mechanism, and much more define this luxurious, high-performing travel scooter that's made in the U.S.A.



Up To
13.8
Miles Per Charge at 220 lbs.

37"
Turning Radius

Up To
4.23mph
Maximum Speed

300lbs.
Weight Capacity

FDA Class II Medical Device¹

Matte Cardinal Red (included)

Matte Black (included)

Interchangeable Shrouds





PROUDLY MADE IN
AMERICA
OF FOREIGN AND DOMESTIC PARTS

Victory® Platinum

Proudly assembled in the U.S., the Victory® Platinum 4-wheel scooter offers a premium mobility experience. Patented EZ Turn technology helps you navigate tight spaces with 3-wheel precision. Exclusive Charge360 technology keeps you powered up with magnetic charging. With full front and rear suspension, take on uneven terrain with confidence.



FDA Class II Medical Device¹

Up To
15.5
Miles Per Charge

45.5"
Turning Radius

Up To
6mph
Maximum Speed

400lbs.
Weight Capacity



Cardinal Red (Matte)

Iceburg Blue (Matte)





GO GO
ELITE TRAVELLER® 2

Go Go Elite Traveller® 2

No four-wheel scooter can turn like the 4-wheel Go Go Elite Traveller® 2. Thanks to Pride's patented, intelligent-turning EZ Turn Technology, it boasts the tightest turning radius of any available 4-wheel scooter at just 37", which means you have 3-wheel scooter agility without compromising 4-wheel scooter stability.



FDA Class II Medical Device¹

Up To
13.8

Miles Per Charge
with 18Ah battery at 200 lbs.

37"
Turning Radius

Up To
4.2mph
Maximum Speed

300lbs.
Weight Capacity

Matte Cardinal Red (included)

Matte Black (included)

Interchangeable Shrouds

Additional shroud colors can be ordered separately. Ask your provider for details.



EZ Turn Technology provides unrivaled tight turning!



STABLE LIKE A 4-WHEEL
•
TURNS LIKE A 3-WHEEL



PX4

The PX4 features an impressive 500-lb. weight capacity, a top speed of 9.3 mph, water-resistant user interface, enhanced lighting package, and a remarkable 23.4 mile battery range.

The ignition system also offers an extra layer of security with its innovative NFC technology. Simply tap or place the NFC key fob near the receiver to start the scooter.



Up To
23.4
Miles per Charge

82.3"
Turning Radius

Up To
9.2mph
Maximum Speed

500lbs.
Weight Capacity

FDA Class II Medical Device¹

Forest Camo (Limited Edition)

Satin Aluminum

Dark Violet

Red

Peacock Blue

Sunflower

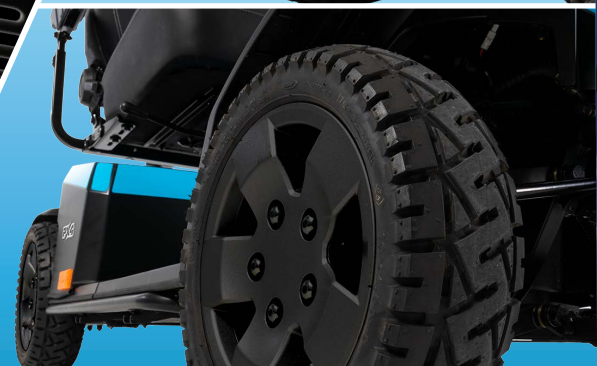

MORE ROOM TO ROAM



PURSUIT²

Pursuit 2

Built to thrill and designed to go the distance, the Pursuit 2 never backs down from an off-road detour or long-distance excursion. With a fast top cruising speed of 9.3 mph and the ability to make it 40 miles on a single charge, this agile unit offers swift, efficient transport and endurance you can count on.

You were born to roam. The Pursuit 2 was built to ride.



Up To
40
Miles Per Charge*

69.3"
Turning Radius

Up To
9.3mph
Maximum Speed

400lbs.
Weight Capacity

FDA Class II Medical Device¹

* Requires dual lithium battery upgrade

Grey (matte)

Orange

Black



INSERT YOURSELF: ANYWHERE





ZERO TURN10

Zero Turn 10

The Zero Turn 10 can traverse the most beautiful, out-of-reach places and move seamlessly through doors and hallways in your home. This scooter combines powerful dual motors and two-wheel drive with revolutionary turning technology. Let the Zero Turn 10 carry you to places unknown.



Up To
21.2
Miles Per Charge at 200 lbs.

43"
Turning Radius

Up To
7.3mph
Maximum Speed

400lbs.
Weight Capacity

FDA Class II Medical Device*

Candy Apple Red

Ocean Blue (Matte)

Pearl White



iGo™

Up To
9.3
Miles Per Charge at 220 lbs.

45.9"
Turning Radius

Up To
4mph
Maximum Speed

275lbs.
Weight Capacity



Non-Medical Device

i-Go™

The i-Go™ Folding Scooter supports you when you refuse to compromise. So, when you're dreaming of a cruise vacation, know that i-Go™ comes with the all-day power, speed and versatility to take you there and back again. When disassembled, the heaviest piece weighs less than 32 lbs. and has a height of less than 12" for easy storage.

Iceberg Blue (matte)

Sugar Plum (matte)

White (matte)

Black (matte)



FLIP-UP ARMRESTS
(OPTIONAL ACCESSORY)



PHONE HOLDER
(OPTIONAL ACCESSORY)



REMOVABLE
STORAGE
(STANDARD)



ACCESSORIES:

- Armrests
- Phone holder
- Cup holder
- Rearview mirror
- Spare battery
- Travel kit

GO GO[®]
CARBON

Go Go[®] Carbon

Harnessing the power of its full carbon fiber frame, the Go Go[®] Carbon offers exceptional portability in a four-wheel scooter. It weighs just **35 pounds** without its lithium battery, folds down in seconds for convenient transport and storage, and can be towed like luggage through airports and other environments.



Up To
10
Miles Per Charge

53"
Turning Radius

Up To
3.7 mph
Maximum Speed

300 lbs.
Weight Capacity

FDA Class II Medical Device¹

Black Carbon Fiber



GOGO
ELITE TRAVELLER®

Up To
10.5
Miles Per Charge

33"
Turning Radius

Up To
4mph
Maximum Speed

300lbs.
Weight Capacity



FDA Class II Medical Device¹

Go Go Elite Traveller®

Every day is a new adventure with the Go Go Elite Traveller®, an exceptionally stable and maneuverable travel scooter.

With easy disassembly and a convenient storage basket, the Go Go Elite Traveller keeps up with your active life!

Red

Blue

Interchangeable Shrouds





GO GO[®]
SPORT

Go Go[®] Sport

It's time to make your mark on this world! The Go Go[®] Sport offers simple disassembly and an ergonomic delta tiller, perfect for one-handed operation. Enjoy the versatility of this sporty scooter, as well as bright LED lighting.



Up To
12
Miles Per Charge

41.5"
Turning Radius

Up To
4.7 mph
Maximum Speed

325 lbs.
Weight Capacity

FDA Class II Medical Device¹

Also available in 3-wheel (EZ Turn only available on 4-wheel). Please see back of catalog for specifications.

Red

Blue



Up To
14.4
Miles Per Charge
(16AH* MAXX Battery Pack)

48.25"
Turning Radius

Up To
4.2mph
Maximum Speed

325lbs.
Weight Capacity

GO GO
ENDURANCE Li



Go Go® Endurance Li

With the Go Go® Endurance Li, traveling has never been easier! This 4-wheel scooter has everything you need for a safe and convenient trip. With the standard 8AH airline-compliant lithium battery pack, the Go Go Endurance is perfect for air travel. Feather-touch disassembly provides the portability you need.

*16 AH battery pack does not meet airline requirements.

FDA Class II Medical Device¹

Garnet Red (matte)

Euro Grey

Interchangeable Shrouds



GO GO®
ULTRA X

Go Go® Ultra X

Enjoy worry-free travel with the Go Go® Ultra X, an ultra-compact scooter that is simple to disassemble. Ride in comfort and style with the foldable swivel seat and keep your personal items handy with the front basket.



Up To
8.9
Miles Per Charge at 200 lbs.

52.25"
Turning Radius

Up To
4.1mph
Maximum Speed

300lbs.
Weight Capacity

FDA Class II Medical Device¹

Also available in 3-wheel. Please see back of catalog for specifications.

Black



MAXIMA

Up To
19.5
Miles Per Charge

53"
Turning Radius

Up To
5.8mph
Maximum Speed

500lbs.
Weight Capacity



Also available in 3-wheel. Please see back of catalog for specifications.

FDA Class II Medical Device¹

Maxima

Experience the comfort of a new high-back, depth adjustable limited recline seat that swivels for easier access.

The Maxima scooter comes standard with front and side bumpers, a USB charger and full LED lighting!

Garnet Red (Matte)

Ocean Blue (Matte)



REVO® 2.0

Revo® 2.0

Robustly rugged meets brilliant convenience. With the Revo® 2.0, there is nothing you can't handle! This tough and dependable scooter has powerful suspension for a smooth ride, yet easily disassembles for full portability.



Up To
17.8
Miles Per Charge at 200 lbs.

52"
Turning Radius

Up To
5.2mph
Maximum Speed

400lbs.
Weight Capacity

FDA Class II Medical Device¹

Also available in 3-wheel. Please see back of catalog for specifications.

Grey Street

True Blue



VICTORY® LX SPORT

Up To
19.7
Miles Per Charge at 200 lbs.

61.25"
Turning Radius

Up To
8.6mph
Maximum Speed

400lbs.
Weight Capacity



FDA Class II Medical Device¹

Victory® LX Sport

You're active and always on the go. You need a scooter that is up to the task! Appeal to your sporty side with the Victory® LX Sport. Enjoy premium suspension, bright lighting and other sophisticated features, all in one sporty package.

Candy Apple Red

True Blue

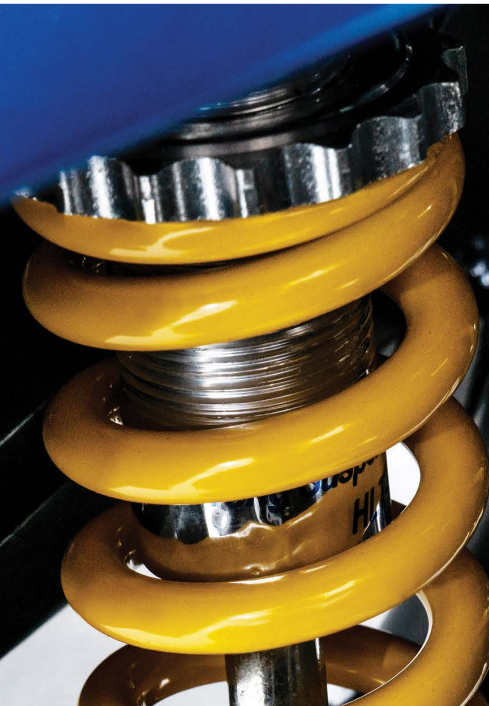
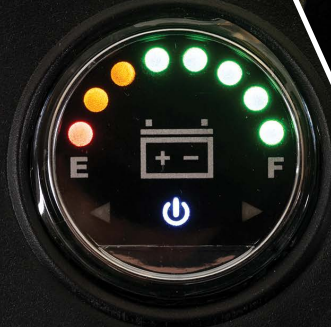
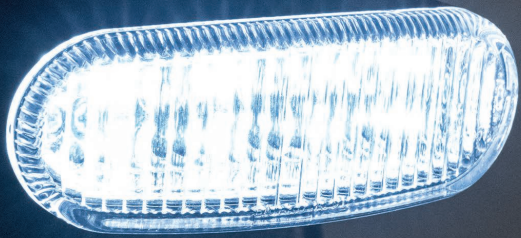



VICTORY 10

Victory® 10

Versatility knows no bounds with the Victory® 10. Enjoy simple disassembly with one hand and drive up to 16 miles on a single charge. You won't miss a beat with this scooter, which includes a bright LED headlight. Anything is possible with the Victory 10!



Up To
15.5
Miles Per Charge

24"
Turning Radius

Up To
5.3mph
Maximum Speed

400lbs.
Weight Capacity

FDA Class II Medical Device¹

Also available in 3-wheel (EZ Turn only available on 4-wheel). Please see back of catalog for specifications.

Candy Apple Red

Viper Blue



VICTORY 10.2

Up To
13
Miles Per Charge

45"
Turning Radius

Up To
5.2mph
Maximum Speed

400lbs.
Weight Capacity



Victory® 10.2

Embrace your potential! The Victory® 10.2 is fully loaded with style and advanced features, including frosted LED headlights and an integrated storage space with cup holder. Drive at speeds up to 5.2 mph and see what life has in store for you!

ONLY available in 3-wheel. Please see back of catalog for specifications.

FDA Class II Medical Device¹

Candy Apple Red



VICTORY® 9

Victory® 9

Sophisticated and stylish, the Victory® 9 is everything you could want in a scooter. The delta tiller lets you operate the scooter with a single hand. Enjoy easy disassembly and plenty of lighting with the LED headlight.



Up To
13
Miles Per Charge

51.5"
Turning Radius

Up To
5.3mph
Maximum Speed

300lbs.
Weight Capacity

FDA Class II Medical Device¹

Also available in 3-wheel. Please see back of catalog for specifications.

Candy Apple Red



ACCESSORIES

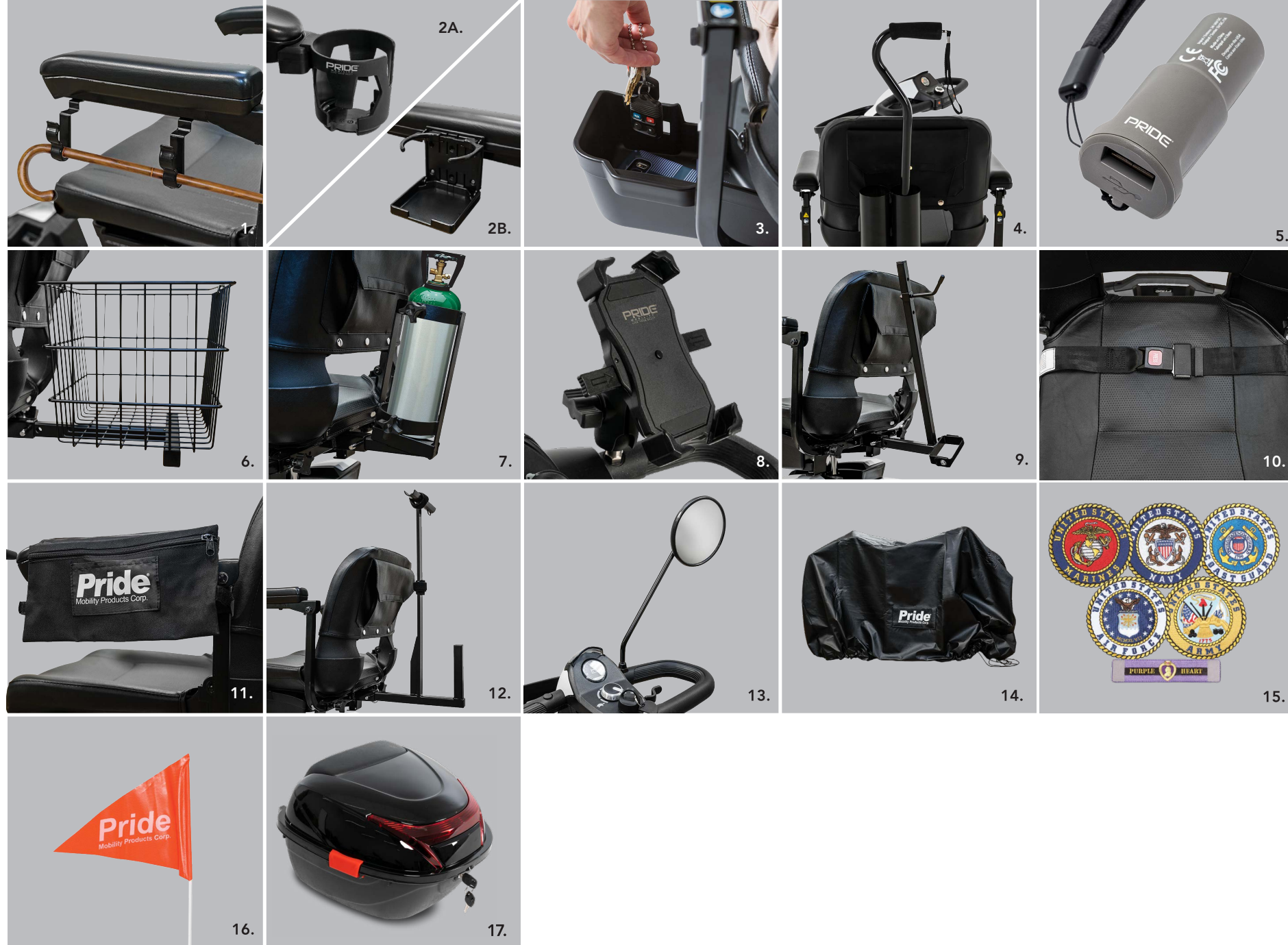

1. Cane Clip Attachment | 2A. Pride® Cup Holder | 2B. Cup Holder | 3. Under Seat Storage | 4. Single or Double Cane Holder
 5. XLR USB CHarger | 6. Rear Basket | 7. Oxygen Holder | 8. New Cell Phone Holder | 9. Wishbone Crutch Holder | 10. Lap Belt
 11. Saddlebag | 12. Walker Holder | 13. Rearview Mirror | 14. Weather Cover | 15. Military Patches | 16. Safety Flag | 17. Storage Pod

Note: Not all accessories are available for all products. Please speak with your Provider for details and availability.

MODEL NAME / NUMBER	VICTORY® PLATINUM SC710PLA	GO GO ELITE TRAVELLER® 2 PLATINUM SC442EMS	GO GO® CARBON SC25	GO GO ELITE TRAVELLER® 2 SC442E (4W)	PX4 SC134
WEIGHT CAPACITY	400 lbs.	300 lbs.	300 lbs.	300 lbs.	500 lbs.
MAXIMUM SPEED ²	Up to 6 mph	Up to 4.23 mph	Up to 3.7 mph	Up to 4.23 mph	Up to 9.2 mph
GROUND CLEARANCE ^{3,8,9}	2.75" at motor & transaxle	1.34" at motor 3.15" at mid-deck	1.5" at motor	1.34" at motor, 3.15" at mid-deck	3.5" at motor frame, 4.4" at mid-frame
TURNING RADIUS ³	45.5"	37"	53"	37"	82.3"
LENGTH / WIDTH ^{3,7}	47" / 24"	39.37" / 19.45"	40.3" / 17.5"	39.37" / 19.45"	56" / 27-27.8"
SEAT-TO-GROUND HEIGHT	23.5"-25"	18.25"-20.25"	21.75"	18.25"-20.25"	24.17-25.29"
SEAT-TO-DECK HEIGHT	17.5"-19"	16.38"-17.83"	16.14"	16.38"-17.83"	16.54-18.39"
FRONT WHEELS (TIRES)	3.5" x 10.4" solid	2" x 7" solid	7" solid	2" x 7" solid	13" pneumatic
REAR WHEELS (TIRES)	3.5" x 11" solid	2.5" x 8" solid	8" solid	2.5" x 8" solid	13" pneumatic
SUSPENSION	Front and Rear Suspension	N/A	N/A	N/A	Front & Rear
RANGE PER CHARGE ⁵	Up to 15.5 miles at 400 lbs.	12 Ah Battery Pack: Up to 6.6 miles at 300 lbs.; Up to 8.8 miles at 220 lbs. 18 Ah Battery Pack: Up to 10.4 miles at 300 lbs.; Up to 13.8 miles at 220 lbs.	Up to 10 miles	12 Ah Battery Pack: Up to 6.6 miles at 300 lbs.; Up to 8.8 miles at 220 lbs. 18 Ah Battery Pack: Up to 10.4 miles at 300 lbs.; Up to 13.8 miles at 220 lbs.	Up to 23.4 miles (220 lbs.) Up to 14 miles at (500 lbs.)
HEAVIEST PIECE ³	67 lbs. (front section)	39 lbs. (front section)	35 lbs. (unit does not disassemble)	35 lbs. (front section)	201.2 lbs. (base)
STANDARD SEATING	Type: Compact, folding Weight: 30.4 lbs. Material: Black Vinyl Dimensions: 18" (W) x 17" (D)	Type: Mesh Back Weight: 23 lbs. Material: Black Vinyl Dimensions: 17" (W) x 17" (D)	Type: Compact, folding Material: Molded plastic Dimensions: 14" (W) x 11.4" (D)	Type: Mesh Back Weight: 23 lbs. Material: Black Vinyl Dimensions: 17" (W) x 17" (D)	Limited Recline High Back Dimensions: 18" (W) x 18" (D)
BATTERIES ^{4,13}	(Two) 12-volt, sealed lead-acid, non-spillable deep cycle	(Two) 12-volt, sealed lead-acid, non-spillable deep cycle	24V, 12Ah lithium battery ¹³	(Two) 12-volt, sealed lead-acid, non-spillable deep-cycle	(2) 12V 75Ah (SLA/AGM)
BATTERY WEIGHT ^{5,6}	21.6 lbs. each	12 Ah: 19.5 lbs. (standard) 18 Ah: 29.6 lbs.	4 lbs.	12 Ah: 19.5 lbs. (standard) 18 Ah: 29.6 lbs.	48.8 lbs. each
BATTERY CHARGER	3.5 amp magnetic charger	Off-board, 2A	24V, 2A	Off-board, 2A	Off-board, 8A
HCPCS CODES	K0899*	K0899*	K0800 (Group 1, Standard)	K0800 (Group 1, Standard)	K0899*
WARRANTY	Lifetime Limited on Frame; 2-year limited on electronics; 2-year limited on drivetrain	Lifetime limited on frame; 2-year limited on Electronics; 2-year limited on Drivetrain	Frame: lifetime limited Drivetrain: 1-year Electronics: 1-year Battery: 1-year	Frame: Lifetime limited Drivetrain: 2-year limited Electronics: 2-year limited Batteries: 6-month limited	Frame: Lifetime limited Drivetrain: 2-year limited Electronics: 2-year limited Batteries: 6-month limited

MODEL NAME / NUMBER	PURSUIT 2 SC7132	ZERO TURN 10 S710ZT	i-GO™ SC20	GO GO ELITE TRAVELLER® SC40E (3W)	GO GO® ENDURANCE LI S54LXLIT
WEIGHT CAPACITY	400 lbs.	400 lbs.	275 lbs.	300 lbs.	325 lbs.
MAXIMUM SPEED ²	Up to 9.3 mph	Up to 7.3 mph	Up to 4 mph	Up to 4 mph	Up to 4.2 mph
GROUND CLEARANCE ^{3,8,9}	3.78" at transaxle, 4.6" at mid-frame	2" at motor 3" at mid-frame	4.2" at mid-frame	1.38" at motor, 0.75" at anti-tip, 2.25" at mid frame	1.5" at motor 3.23" at deck
TURNING RADIUS ³	69.3"	43"	45.9"	33"	48.25"
LENGTH / WIDTH ^{3,7}	57.5" / 29.7"	48" / 24.25"	44" / 20.3"	37"	42"/20.5"
SEAT-TO-GROUND HEIGHT	28.74"	23.25" - 24.75"	22.25"	18.25" -20.25"	21.25"-22.75"
SEAT-TO-DECK HEIGHT	176.9-20.9"	17.75"-19.25"	14.6"	15.75" -17.25"	16.25"-17.75"
FRONT WHEELS (TIRES)	13" pneumatic	9" solid	8" hub motor	2" x 8" solid	2" x 8" solid
REAR WHEELS (TIRES)	13" pneumatic	10.75" solid	9" perforated	2.5" x 8" solid	2" x 8" solid
SUSPENSION	Front & Rear	Front and rear (CTS)	N/A	N/A	Front and rear (CTS)
RANGE PER CHARGE ⁵	Single Battery: Up to 17.4 miles (220 lbs.) Up to 13.8 miles (400 lbs.) Dual Battery: Up to 34.8 miles (220 lbs.) Up to 30.9 miles (350 lbs.)	Up to 15.9 miles (at 400 lbs.) Up to 21.2 miles (at 200 lbs.)	Up to 7 miles at 275 lbs. Up to 9.3 miles at 220 lbs.	Up to 7.25 miles (12 AH) Up to 10.5 miles (18 AH)	8 AH: Up to 7.2 miles 16 AH: Up to 14.4 miles at 200 lbs.
HEAVIEST PIECE ³	163 lbs. (base)	75 lbs. (front section)	32.8 lbs. (rear base with seat back)	29.5 lbs. (front section)	40.75 lbs. (front section)
STANDARD SEATING	Limited Recline High Back with Sliders Dimensions: 18" (W) x 18" (D)	Type: Foldable, deluxe contour Weight: 34 lbs. or Foldable, compact Weight: 30 lbs. Material: Black vinyl Dimensions: 18" (W) x 17" (D)	Type: Compact, folding (back is removable) Material: Molded plastic Dimensions: 16" x 16"	Type: Compact, foldable Weight: 23 lbs. Material: Black vinyl Dimensions: Width: 17" , Depth: 17"	Type: Compact, mesh, foldable Weight: 23 lbs. Material: Black vinyl Dimensions: 17"x17" , 20"x18"
BATTERIES ^{4,13}	(1) or (2) 24V, 50Ah Lithium-ion	(2) 40 AH	(1) 25.2V 9.6 Ah Rechargeable Lithium-Ion	(2) 12 AH (standard) or (2) 18 AH (optional)	8 AH ¹³ lithium ion battery pack or 16 AH ¹² lithium ion battery pack (optional)
BATTERY WEIGHT ^{5,6}	23.8 lbs. each	30.25 lbs. each	4.8 lbs.	9 lbs. each (12 AH), 20 lbs. per battery pack 14 lbs. each (18 AH), 29.5 lbs. per battery pack	8 lbs. (8 AH); 12 lbs. (16 AH)
BATTERY CHARGER	Off-board, 8A	Off-board, 3.5A	Off-board, 3.5 amp (lithium-ion)	Off-board, 2 amp	Off-board, 3.5 amp (lithium ion) ¹³
HCPCS CODES	K0899*	K0899*	N/M (non-medical)	K0800 (Group 1, Standard)	K0899*
WARRANTY	Frame: Lifetime limited Drivetrain: 2-year limited Electronics: 2-year limited Batteries: 3-year limited	Frame: Lifetime limited Drive motors: 2-year limited Electronics: 2-year limited Batteries: 6-month limited	Frame: 3 years Electronics: 2 years (does not include charger) 1 year on motor, battery and charger	Frame: Lifetime limited Drivetrain: 2-year limited Electronics: 2-year limited Batteries: 6-month limited	Frame: Lifetime limited Drivetrain: 2-year limited Electronics: 2-year limited Batteries: 2-year limited

MODEL NAME / NUMBER	GO GO® SPORT S73 (3W), S74 (4W)	GO GO® ULTRA X¹ S39 (3W), S49 (4W)	REVO® 2.0¹ S66 (3W), S67 (4W)	VICTORY® LX SPORT¹ S710LXW
WEIGHT CAPACITY	325 lbs.	300 lbs.	400 lbs.	400 lbs.
MAXIMUM SPEED²	Up to 4.7 mph	3W: Up to 4.3 mph 4W: Up to 4.1 mph	Up to 5.2 mph	Up to 8.6 mph at 200 lbs.
GROUND CLEARANCE³,⁸,⁹	1.5" at motor, 0.75" at anti-tip	1.25" at motor 3.23" at deck	3W: 3.25" at side deck 4W: 3.5" at side deck	2.2" at motor 3.15" at mid-frame
TURNING RADIUS³	3W: 36" 4W: 41.5"	3W: 36.5" 4W: 52.25"	3W: 40" 4W: 52"	61.25"
LENGTH / WIDTH³,⁷	3W: 42" 4W: 43" / 22.25"	40.25" / 19.25"	3W: 46" 4W: 47" / 20.75"	47" / 25.5"
SEAT-TO-GROUND HEIGHT	20.5" - 22"	21.5 -23"	22" - 23.5"	23" - 25"
SEAT-TO-DECK HEIGHT	17" - 18"	16.5"-18"	15"-16.5"	16.5" -18.5"
FRONT WHEELS (TIRES)	3W: 3" x 8" (4W: 3" x 9") solid	2" x 8" solid	3W: 3" x 8" solid 4W: 3" x 9" solid	3.5" x 10" solid
REAR WHEELS (TIRES)	3" x 9" solid	2.5" x 8" solid	3" x 9" solid	3.5" x 10" solid
SUSPENSION	N/A	N/A	Front and rear (CTS)	Front and rear (CTS)
RANGE PER CHARGE⁵	3W: Up to 12.75 miles 4W: Up to 12 miles	3W: Up to 8 miles (200 lbs.) 3W: Up to 6.2 miles (300 lbs.) 4W: Up to 8.9 miles (200 lbs.) 4W: Up to 6.6 miles (300 lbs.)	3-Wheel: Up to 17.4 miles (at 200 lbs.) Up to 12.8 miles (at 400 lbs.) 4-Wheel: Up to 17.8 miles (200 lbs.) Up to 14.8 miles (at 400 lbs.)	Up to 19.7 miles (at 200 lbs.) Up to 13 miles (at 400 lbs.)
HEAVIEST PIECE³	3W: 35.75 lbs.(front section) 4W: 44 lbs. (front section)	3W: 29.5 lbs. (front section) 4W: 34.5 lbs. (front section)	3W: 48 lbs. (rear section) 4W: 57 lbs. (front section)	77 lbs. (front section)
STANDARD SEATING	Type: Compact, foldable Weight: 23 lbs. Material: Black vinyl Dimensions: Width: 17", Depth: 17"	Type: Compact, foldable Weight: 23 lbs. Material: Black vinyl Dimensions: 17" (W) x 17" (D)	Type: Compact, foldable Material: Black vinyl Dimensions: 20" (W) x 18" (D)	Type: Limited reclining high-back Weight: 43 lbs. Material: Black vinyl Dimensions: 18" (W) x 18" (D)
BATTERIES⁴	(2) 18 AH	(2) 12 AH	(2) U-1	(2) 50 AH
BATTERY WEIGHT⁵,⁶	14 lbs. each 29.5 lbs. per battery pack	9 lbs. each 20 lbs. per battery pack	25 lbs. each	30.2 lbs. each
BATTERY CHARGER	Off-board, 2 amp	Off-board, 2 amp	Off-board, 3.5-amp	Off-board, 5 amp
HCPCS CODES	K0801 (Group 1, Heavy Duty)	K0800 (Group 1, Standard)	K0899*	K0899*
WARRANTY	Frame: Lifetime limited Drivetrain: 2-year limited Electronics: 2-year limited Batteries: 6-month limited	Frame: Lifetime limited Drivetrain: 2-year limited Electronics: 2-year limited Batteries: 6-month limited	Frame: Lifetime limited Drivetrain: 2-year limited Electronics: 2-year limited Batteries: 6-months	Frame: Lifetime limited Drivetrain: 2-year limited Electronics: 2-year limited Batteries: 6-months

MODEL NAME / NUMBER	VICTORY® 10.2¹ S6102	VICTORY® 10¹ SC610 (3W), SC710 (4W)	VICTORY® 9¹ SC609 (3W), SC709 (4W)	MAXIMA¹ SC901 (3W), SC941 (4W)
WEIGHT CAPACITY	400 lbs.	400 lbs.	300 lbs.	500 lbs.
MAXIMUM SPEED ²	Up to 5.2 mph	Up to 5.3 mph	Up to 5.3 mph	Up to 5.8 mph
GROUND CLEARANCE ^{3,8,9}	2.4" at transaxle, 2.1" at anti-tip, 3" at side deck	3W: 2.2" at motor, 1.26" at anti-tip 4W: 2" at motor, 1.5" at anti-tip	3W: 1.8" at transaxle, 1.4" at anti-tip 4W: 1.8" at transaxle, 1.4" at anti-tip	3W: 2.5" at motor, 3" at mid-frame 4W: 2.25" at motor
TURNING RADIUS ³	42"	3W: 42" 4W: 24"	3W: 40.25" 4W: 51.5"	3W: 49" 4W: 53"
LENGTH / WIDTH ^{3,7}	45"	3W: 45.25" 4W: 47" / 22.5"	3W: 43.5" 4W: 45.5" / 22.5"	3W: 47.5" 4W: 47.5" / 27"
SEAT-TO-GROUND HEIGHT	22" – 24"	23.5"-25"	22.5"-24"	22.1" - 24.1" 22.32"-28.57" (with power elevating seat)
SEAT-TO-DECK HEIGHT	15.25" – 17.25"	17.5"-19"	17.25"-18.75"	17.13" - 19.13" 17.36"- 23.61" (with power elevating seat)
FRONT WHEELS (TIRES)	3.5" x 10" solid	3.5" x 10" solid	3W: 3" x 8" solid 4W: 3" x 9" solid	3W: 10.5"x 3.6" solid 4W: 10"x 3.6" solid
REAR WHEELS (TIRES)	3.5" x 10" solid	3.5" x 10" solid	3" x 9" solid	10.75"x 3.6" solid
SUSPENSION	N/A	N/A	N/A	N/A
RANGE PER CHARGE ⁵	Up to 11 miles (U-1) Up to 13 miles (40 AH)	Up to 15.5 miles	Up to 13 miles	3W: Up to 19.8 miles 4W: Up to 19.5 miles
HEAVIEST PIECE ³	3W: 56.5 lbs. (front section)	3W: 54 lbs. (front section) 4W: 63 lbs. (front section)	3W: 48.5 lbs. (front section) 4W: 59 lbs. (front section)	N/A (unit does not disassemble)
STANDARD SEATING	Type: Compact, foldable Weight: 28.5 lbs. Material: Black vinyl Dimensions: Width: 18", Depth: 17"	Type: Compact, foldable Weight: 28 lbs. Material: Black vinyl Dimensions: Width: 18", Depth: 17"	Type: Compact, foldable Weight: 28 lbs. Material: Black vinyl Dimensions: Width: 18", Depth: 17"	Type: Depth-adjustable, limited recline high back Weight: 53.2 lbs. Material: Black vinyl Dimensions: 22" x 18"-20"
BATTERIES ⁴	(2) U-1 (standard) (2) 40 AH (optional)	(2) U-1 (standard) (2) 40 AH (optional)	(2) U-1	(2) GEL, 58AH, NF-22
BATTERY WEIGHT ^{5,6}	24 lbs. each (standard) 32 lbs. each (optional)	24.5 lbs. each (standard) 32.5 lbs. each (optional)	24 lbs. each	36.5 lbs. each
BATTERY CHARGER	Off-board, 3.5 amp (U-1) Off-board, 5 amp (40 AH)	Off-board, 3.5 amp (U-1) Off-board, 5 amp (40 AH)	Off-board, 3.5 amp	Off-board, 5 amp
HCPSC CODES	K0801 (Group 1, Heavy Duty)	K0801 (Group 1, Heavy Duty)	K0800 (Group 1, Standard)	3W: K0802 (Group 1; Very Heavy Duty) 4W: K0808 (Group 2; Very Heavy Duty)
WARRANTY	Frame: Lifetime limited Drivetrain: 2-year limited Electronics: 2-year limited Batteries: 6-months	Frame: Lifetime limited Drivetrain: 2-year limited Electronics: 2-year limited Batteries: 6-months	Frame: Lifetime limited Drivetrain: 2-year limited Electronics: 2-year limited Batteries: 6-months	Frame: Lifetime limited Drivetrain: 2-year limited Electronics: 2-year limited Batteries: 6-months



(US) 800-800-8586 | (CAN) 888-570-1113 | pridemobility.com |      

1. Pride® FDA Class II Medical Devices are designed to aid individuals with mobility impairments.
2. Varies with user weight, terrain type, battery amp- hour (AH), battery charge, battery condition and tire condition. This specification can be subject to a variance of (+ or -) 10%.
3. Varies with user weight, terrain type, battery amp- hour (AH), battery charge, battery condition and tire condition. This specification can be subject to a variance of (+ or -) 10%.
4. Due to manufacturing tolerances and continual product improvement, this specification can be subject to variance of + or - 3%.
5. Deep cycle (AGM or gel cell type recommended).
6. Tested in accordance with ANSI/RESNA, WC Vol 2, Section 4 and ISO 7176-4 standards. Results derived from theoretical calculations based on battery specifications and drive system performance. Test conducted at maximum weight capacity.
7. Battery weight may vary based on manufacturer.
8. Width of base (not including seat).
9. Does not account for anti-tip clearance.
10. At midframe.
11. Product is available exclusively to Authorized Pride Brick & Mortar Providers. No internet sales are permitted. Available in store only. Other conditions apply.
12. Does not meet airline requirements.
13. Transport of this item on commercial aircraft is subject to federal regulations and airline policy. Please consult your airline prior to your flight to ensure your item and its lithium ion battery are permitted.

NOTE: All specifications subject to change without notice.

The information contained herein is correct at the time of publication; we reserve the right to alter specifications without prior notice. Speed and range vary with user weight, terrain type, battery charge, battery condition and tire pressure. Due to manufacturing tolerances and continual product improvement, length, width, turning radius and ground clearance can be subject to variance of + or - 3 %. Dimensions listed are for scooter only. Overall measurements will vary based on seating and accessory selections.

N/M: This product is not a medical device and is not intended to assist, treat, diagnose, or alleviate any medical condition or disability.

*K0899 – power mobility device, not coded by DME PDAC.

**Not all accessories are available for all products. Please speak with your Provider for details and availability.

HCPCS codes provided should not be considered as legal advice and do not guarantee reimbursement. DME providers are responsible for determining appropriate billing codes when submitting for insurance reimbursement.

