

JAZZY[®] SELECT 6 型



一、安全指南



警告！必须由Pride 授权供应商或合格技术人员执行本型电动轮椅的初始设置功能，并必须执行本手册中的全部程序。

在用户手册和电动轮椅上都使用了下列符号来标明警示信息和重要信息。您必须阅读并完全理解这些信息。



警告！表明具有潜在危害性的条件/ 状况。不遵守规定程序可能导致人身伤害、组件损坏或功能异常。在产品上，本图标表示为黑框黄三角和黑色感叹号。



强制！这些操作应当按照规定执行。未能执行强制性操作可能导致人身伤害及/ 或产品损害。在产品上，本图标表示为白框蓝色圆形和白色方框。



禁止！禁止进行这些操作。在任何时候或任何情况下均不得进行这些操作。执行被禁止的操作会导致人身伤害及/或设备损坏。在产品上，本图标表示为黑底红圈的禁止符号。

规定用途

Pride 移动产品设备的规定用途是为限于坐姿、具有操作电动轮椅能力的个人提供代步工具。

简要参考信息

Pride 授权供应商: _____
地址: _____
电话号码: _____
购买日期: _____

注意：本《用户手册》依据出版时可获取的最新产品规格和产品信息编制完成。我们保留在必要时修改本《用户手册》的权利。如果我们的产品发生任何更改，可能导致本《用户手册》中的插图和描述与您实际购买的产品略有不同。如欲查看本《用户手册》的最新/当前版本，请访问我们的网站。

注意：本产品符合国际电工委员会(IEC 60529) 评定的异物防护等级X4 级(IPX4) 标准。

注意：本产品符合WEEE, RoHS 和REACH 指令和要求。

注意：电动轮椅及其部件并非由天然胶乳制成。如有任何零件市场配件相关问题，请向制造商咨询。



目录

一、	安全指南.....	4
二、	安全需知.....	5
三	电动轮椅结构图.....	7
四、	组装方法.....	11
五、	舒适度调节.....	12
六、	电池和充电方法.....	18
七、	保养和维修.....	22
八、	其他说明	29

一、安全指南

安全

您购买的电动轮椅装配了最先进的部件，在设计之时同时考虑到了安全性、舒适性以及产品款式。我们坚信，这些设计特点定能在您开展日常活动时为您带来预期的方便性。一旦您明白如何安全地操作和保养您的电动轮椅，您便能享受多年的无故障操作和使用。

尝试第一次操作本产品之前，请阅读并遵守本手册内的所有说明、警告和注释。初次操作之前，您还须阅读随个人移动车辆提供的所有补充性指导小册子内的所有说明、警告和注释。您的安全取决于您自己，也取决于您的供应商、照顾者或医疗保健专家进行正确的判断。

如果本手册内有任何信息您不理解，或您需要关于设置或操作方面的额外援助，请联系您的授权供应商。如未能遵守本手册以及位于产品的说明、警告和注释，可导致人身伤害或产品损坏，也会使得产品保修失效。

采购协议书

确认收到此产品，即代表您承诺：不会改变、更改或改装本产品；不会卸除本产品的防护装置、防护物或其他安全设备，或致使它们不可操作或不安全；也不会不安装、拒绝安装或疏于安装您的供应商为增强或维持本产品的安全使用而不时提供的任何改装套件。

运送和交付

有的部件可能分开包装，因此，在使用个人移动车辆之前，请确保您已经收到完整的产品。如果您收到的产品不完整，请立即联系物品损坏，请联系负责的运送公司。

注意：如果您丢失本手册，请联系我们。我们很乐意立即为您补送一份。

二、安全需知

产品安全图标

下列图标用于在电动轮椅上标出警告信息、强制操作和禁止操作。您必须阅读并完全理解这些图标：

备注：在您的电动轮椅配送的用户安全指南中标出并解释了更多的警告图标。请熟练掌握安全指南中的所有警告和安全信息，并经常参考本手册内容。



阅读并遵循用户手册中的指示信息。



已锁定，处于行驶模式。

在从行驶模式转为自由控制模式或从自由控制模式转为行驶模式时，应将设备放于水平地面，并站在轮椅侧面。

未锁定，处于自由控制模式。



表示个人移动车辆上的系留点。

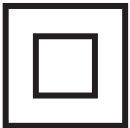

二类设备



制造厂



电动轮椅信息标签

二、安全需知

一般指南



强制！在首次操作您的新电动轮椅前，必须完全阅读理解本用户手册。

您的电动轮椅是设计用于代步和改善生活的最新科技设备。Pride 提供了多种系列产品以更好的满足电动轮椅用户的不同个人需求。请注意，最终选择和购买其所使用的电动轮椅型号的责任，应由电动轮椅用户、或有责任做出该决策的个人、以及用户的医疗专家（例如医生、理疗师等）承担。

本手册内容是针对已有一名移动设备专家正确的为用户安装了电动轮椅，并帮助医疗专家及/ 或Pride 授权供应商讲解产品使用方法的情况下制订的。

在某些特定条件，包括一些医疗条件下，电动轮椅用户需要在一名经过培训的护理人员的陪伴下练习操作电动轮椅。经过培训的护理人员可以是经过专门培训，帮助电动轮椅用户处理多种日常生活活动的家人或专业护理人员。

随着您开始在日常生活中使用电动轮椅，您可能会遇到一些需要反复练习的情况。请多花一些时间练习，您将很快可以完全掌握如何穿过门廊、上下电梯、上下坡和通过平缓的地形。

以下是一些可以帮助您熟悉如何安全使用电动轮椅的注意事项、技巧、以及其他安全方面的建议。

乘坐前安全检查

了解您的电动轮椅的状况和功能。Pride 建议您在每次使用前进行安全检查，以确保您的电动轮椅可以平稳安全运行。

在使用电动轮椅前应进行以下检查：

- 检查轮胎是否正确充气。如使用充气轮胎，应保证每个轮胎的气压达到并不超过其标称psi/bar/ 千帕压力值。
- 检查所有电线连接。确保接口紧固，没有被腐蚀。
- 检查动力基座的所有控制连接。确保所有连接得到了正确固定。
- 检查制动。参见第VII 章“保养和维护”。
- 检查电池充电情况。参见第VI 章“电池和充电”。
- 确保在乘坐轮椅前，手动自由控制杆处于驾驶模式。

备注：如果您发现问题，请联系Pride 授权供应商获得帮助。

三、电动轮椅结构图

JAZZY SELECT 系列电动轮椅

JAZZY SELECT 系列电动轮椅包含两大主要组件：座椅总成和动力基座总成。参见图1。通常来说，座椅总成包括扶手、椅背和座席。动力基座总成包含两组电机/制动组件、两个驱动轮、四个转向轮、两块电池以及电路线束。参见图1、2、3。



图1. Jazzy Select 6 型电动轮椅

三、电动轮椅结构图

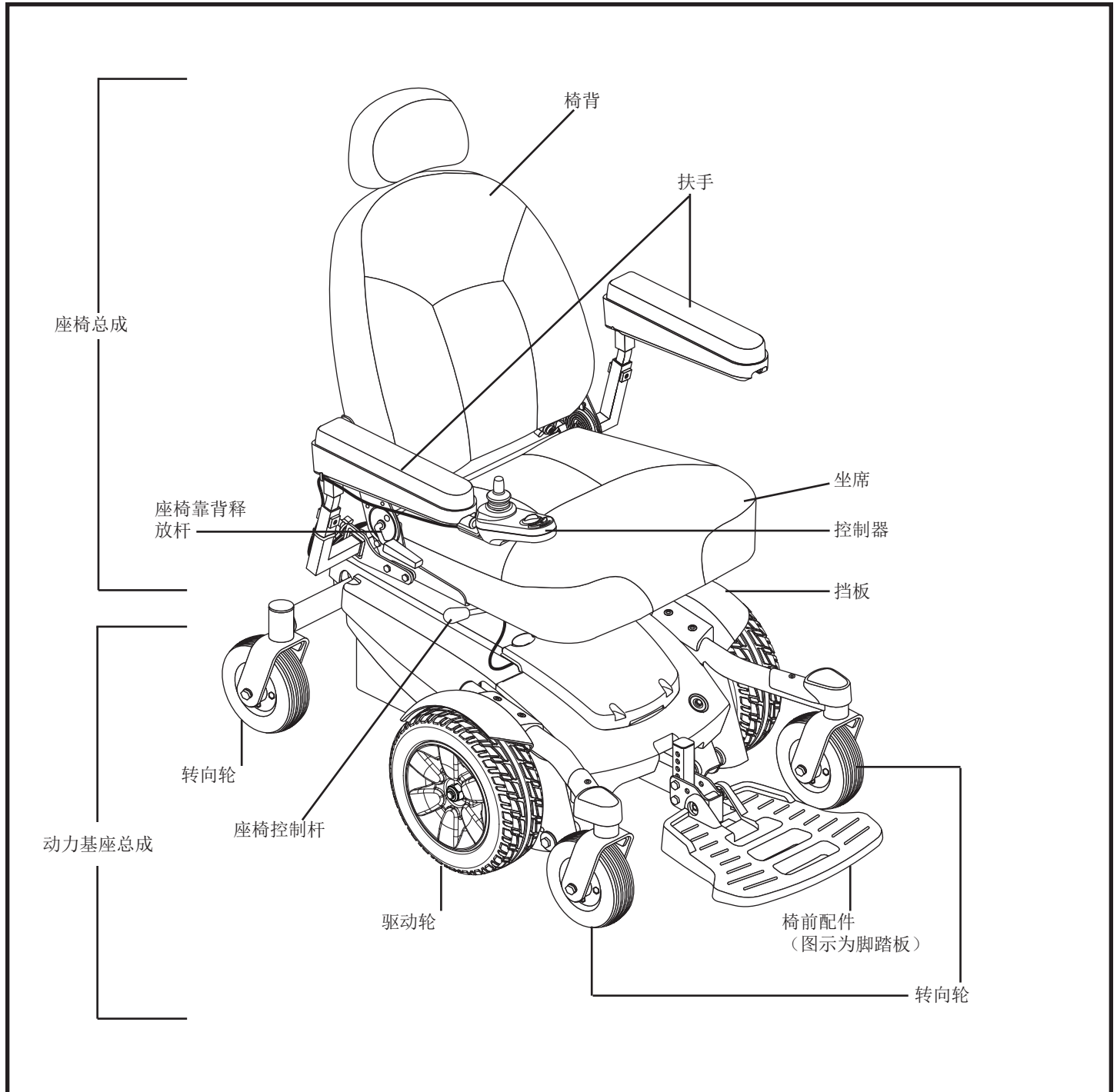

图2. Jazzy Select 6 型动力基座

电气组件

电气组件位于动力基座内部或外部。主断路器位于动力基座前部。电源模块位于前盖板下。见图6。

主断路器：主断路器是电动轮椅内置的安全特性。当电池和电机过度疲劳（例如负载过重）时，将触发主断路器跳闸以避免对电机和电子设备造成损害。如果电路跳闸，请让您的电动轮椅“休息”大约 1 分钟。之后，按下断路器按钮，启动控制器，然后继续正常操作。如果主断路器持续跳闸，请联系 Pride 授权供应商。

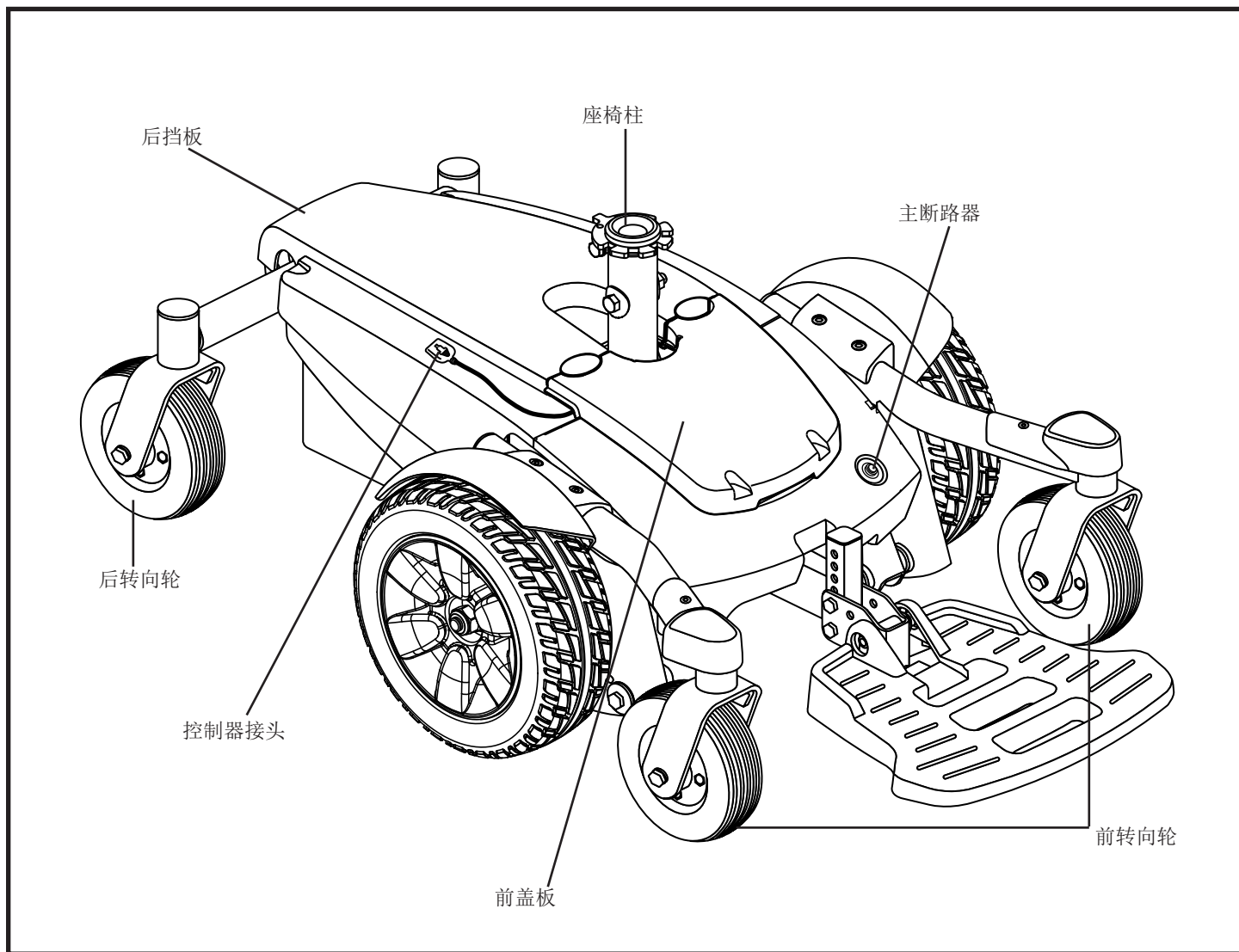
电源模块：提供控制杆模块和电机、电池和非车载充电器之间的连接。

三、电动轮椅结构图



图3. Jazzy Select 6 型电气组件

三、电动轮椅结构图

手动自由控制杆

在您的电动轮椅的每台电机上，都有一个手动自由控制杆。手动自由控制杆允许您将驱动电机和变速箱断开，手动操作轮椅。

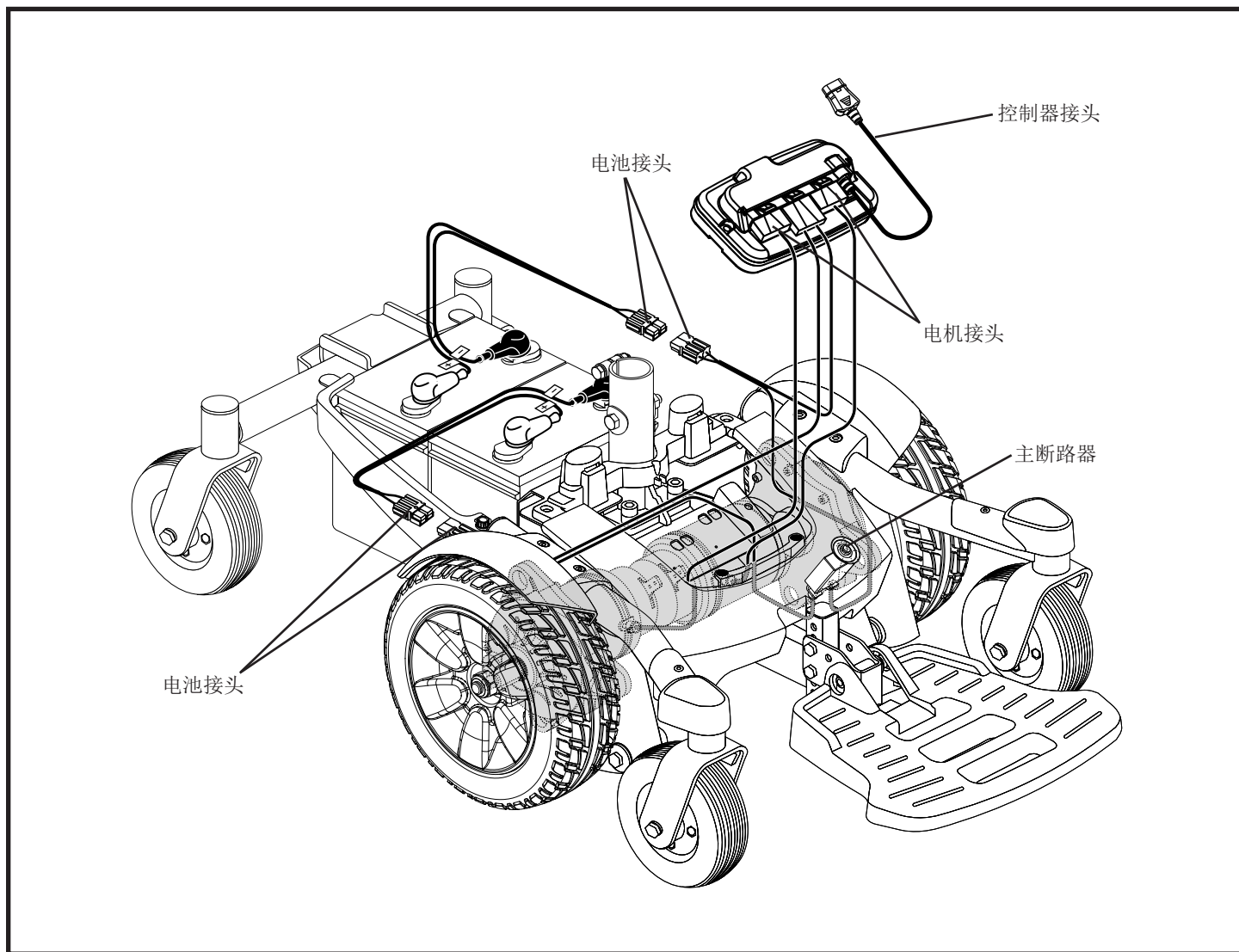

警告！不要在驱动电机断开时使用电动轮椅！不要在电动轮椅处于上坡或下坡时断开驱动电机，否则轮椅可能自行滑动。只能在水平地面上使用自由控制模式。



警告！必须记住，当您的电动轮椅处于自由控制模式时，制动系统同样处于断开状态。

如何接合或断开驱动电机：

1. 找到动力基座两侧的控制杆。
2. 将两根控制杆同时向上拉以接合驱动电机（行驶模式）。见图4。
3. 将两根控制杆同时向下拉以断开驱动电机（自由控制模式）。见图 5。

如果手柄向任何方向移动时出现困难，请将电动轮椅轻轻向前后摇动。之后手柄应该可以到达所需位置。

警告！避免对手动飞轮操纵杆施加过大的力。



警告！请勿用脚操作手动飞轮操纵杆。不要站在手动飞轮手柄上。对手动飞轮手柄施加过大的力可能会导致飞轮手柄，电机和制动器损坏。

警告！不要将自由控制操纵杆用做固定本产品的系留点。



图 4. 行驶模式（接合驱动电机）



图 5. 自由控制模式（断开驱动电机）

四、组装方法

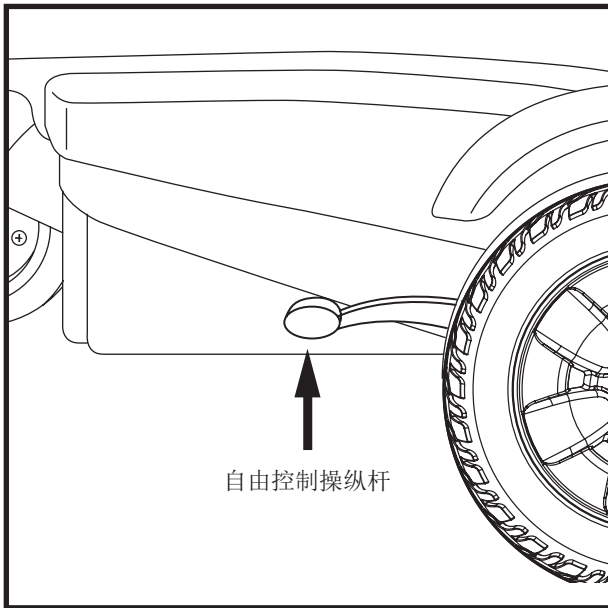
初始安装

在最初使用前，或在运输后，可能需要对您的电动轮椅进行组装。

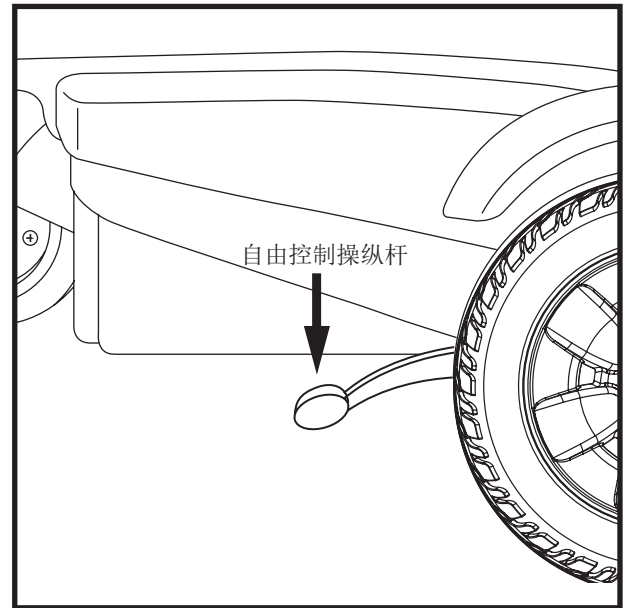
备注：在拆卸或调整电动轮椅时拆除的任何尼龙插入锁扣螺母都必须使用新的尼龙插入锁扣螺母替换。不能重复使用尼龙插入锁扣螺母，这样可能会对其造成损害，并导致固定不够紧密安全。替换用的尼龙插入锁扣螺母可以在当地五金店或Pride 授权供应商处获得。

座椅安装

可能有必要在最初使用前，或在运输后安装座椅。



警告！不要使用扶手拎起座椅，因为扶手可以自由转动，您可能会因此而无法控制座椅。

如何安装座椅：

1. 将座椅安装在动力基座上。见图 6.
2. 将控制器安装在任一扶手上。使用附带的六角扳手拧紧固定螺丝。
3. 将扶手抬起至竖直，然后布置控制器线束并使用电线扎带固定，如图6 所示。

备注：在使用电线扎带固定控制器线束前，必须将扶手抬起至竖直状态。



强制！预防控制器线束损坏！不要将控制器线束布置在扶手板外侧，将线束布置在扶手下或扶手板内侧。为控制器线束确定正确的固定点，以避免线束被卷入驱动轮、卡在座椅框架内、或在通过门廊时损坏。

4. 将控制器线束插入动力基座上的接头。见图 3.



图6. 座椅和控制器组装

五、舒适度调节

调节舒适度

在熟悉如何操作您的电动轮椅后，您可能需要对座椅高度、扶手角度、脚踏板高度和角度、以及控制器位置等方面进行一些调节，以使驾驶更加舒适。在调节舒适度前，请参阅下列信息。

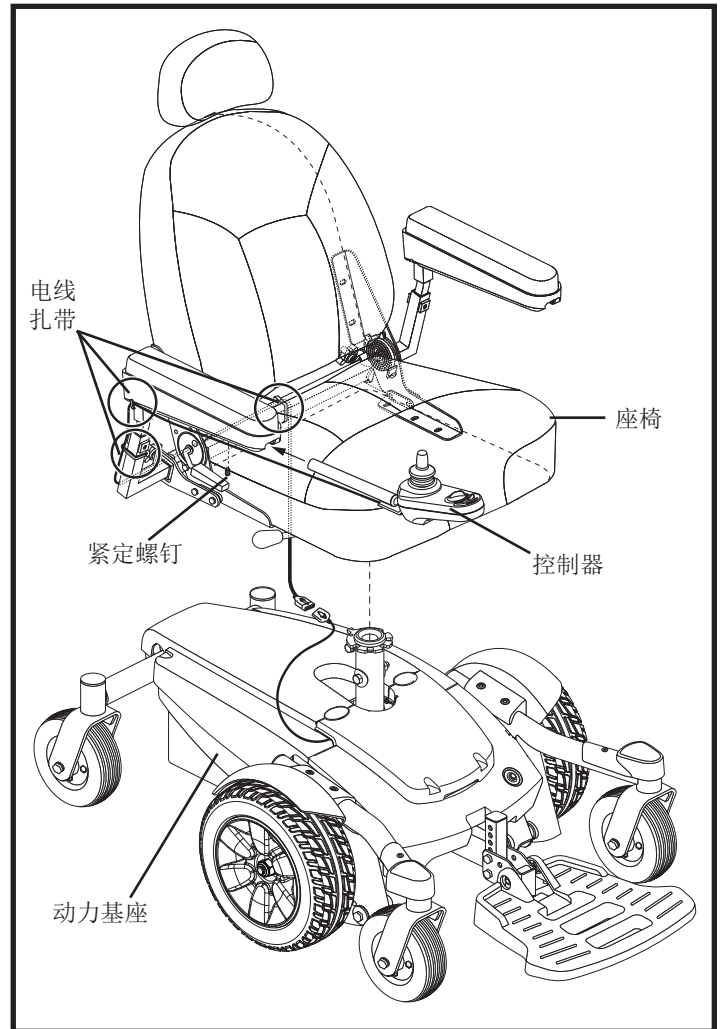
备注：如果您的电动轮椅配备了可选的座椅系统，请参考该系统手册所提供的信息。

警告！ 工厂将您的电动轮椅的重心默认设置在适合绝大多数用户需要的位置。Pride 授权供应商已经对您的电动轮椅进行了评估，并进行了必要调整以适应您的个人具体要求。在更改您的座椅配置前，必须首先联系Pride Mobility ProductsCorp. 或Pride 授权供应商。



警告！ 电动轮椅的部分配件相当沉重。您在抬起或搬运这些配件时可能需要帮助。在拆卸电动轮椅前，请参阅规格表以了解配件具体重量。

警告！ 在进行任何调整前，必须首先让乘员离开电动轮椅。

调节座椅高度

您可以选择三种座椅高度，每种高度间相差1英寸（2.5 厘米）。

如何调节座椅高度：

1. 关闭控制器电源。
2. 确保电动轮椅处于行驶模式。见图 4。
3. 将控制器接头与动力基座断开。见图 7。
4. 松开座椅控制杆。见图 7。
5. 握住控制杆，将座椅向左或向右旋转，之后将其向上提起，与动力基座分离。
6. 松开座椅柱后部的固定件。见图7。
7. 拆除座椅柱上的高度调节螺栓、垫片和螺母。见图7。
8. 将座椅柱上升或下降至所需位置。
9. 重新在座椅柱上安装座椅高度调节件。
10. 拧紧座椅柱后部的固定件。
11. 重新安装座椅。
12. 重新将控制器连接至动力基座。

备注：如需旋转座椅，请使用座椅下方的座椅控制杆。



图 7. 座椅高度调节

五、舒适度调节

注意：座椅调节硬件的最常见配置如图8所示。您的产品可能配备了其他配置。所有配置均以类似方式运行。

手动调节椅背后仰

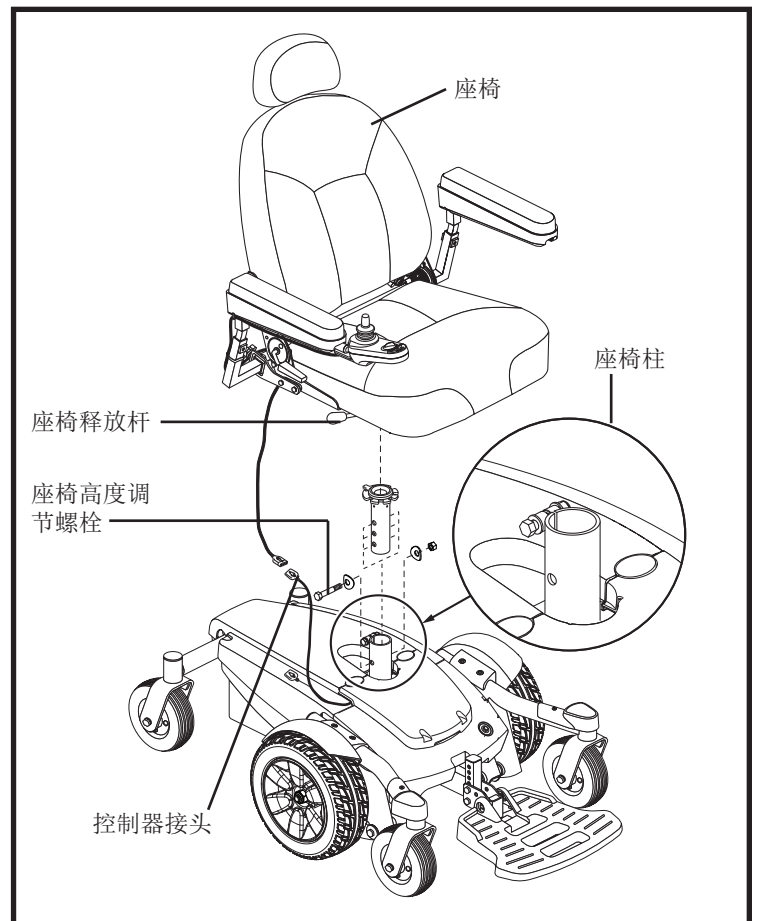
如果您的电动轮椅配备了可以手动放倒的椅背。您可以使用固定件或椅背控制杆调整椅背角度。见图 7。

如何使用椅背控制杆调整后仰角度：

1. 拉起椅背控制杆。
2. 将椅背向前倾或后倾至所需位置。
3. 松开控制杆。

椅背角度调节

如果您的电动轮椅配备的是有限调节椅背，您可以将其设为四（4）种不同的角度：90°、102°、105° 或107°。

如何使用固定件调整后仰角度：

1. 拆除两侧座椅铰链上的椅背角度调节螺栓。
2. 将椅背定位至所需角度。
3. 在两侧座椅铰链上重新安装椅背角度调节螺栓。

扶手宽度调节

您可以分别调节两个扶手的宽度。

备注：改变扶手宽度可能会增加您的电动轮椅的整体宽度。

如何改变扶手宽度：

1. 找到扶手固定架两侧的调节螺栓。见图 8。
2. 松开调节螺栓。
3. 将扶手滑入或滑出至所需宽度。
4. 拧紧调节螺栓。

调节扶手角度

如何调节扶手角度：

1. 将扶手抬起至竖直状态，使其与地面垂直。见图8。
2. 如配备了锁紧螺母，将其松开。
3. 旋转调节螺栓，以抬高或放低扶手前端位置。
4. 如配备了锁紧螺母，将其拧紧以固定调节螺栓。



图8. 扶手和椅背调节

五、舒适度调节

扶手高度调节

如需改变扶手高度：

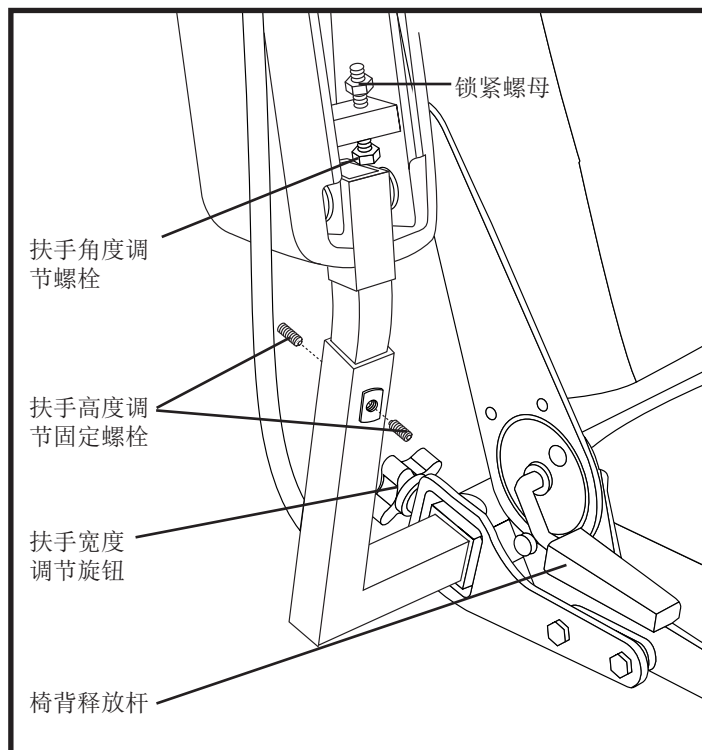
1. 松开扶手上的固定螺栓。见图 8。
2. 将扶手抬起或放低至所需高度。
3. 拧紧螺栓固定扶手。

控制器位置

您可以将控制器向扶手前端或后端移动，或改变控制器位置以便左手或右手操作。



警告！ 不要将控制器线束布置在可能会被座椅框架或动力基座框架所挤压的位置上。

如何调整控制器位置：

1. 将扶手上翻，使其与地面垂直。
2. 松开控制器支架上的固定螺栓。见图 9。
3. 将控制器向扶手前端或后端滑动至所需位置。
4. 拧紧螺栓固定控制器。

如何更改控制器位置：

1. 关闭控制器电源。
2. 将控制器接头与动力基座断开。
3. 剪开将控制器线束固定在扶手和座椅上的电线扎带。
4. 将两侧扶手上翻。
5. 松开两侧扶手底部的固定螺栓。见图 9。
6. 将控制器从扶手上滑出取下。
7. 将控制器放入另一扶手上。
8. 拧紧螺栓固定控制器。
9. 沿座椅框架布置控制器线束，并使用电线扎带固定。见图 6。
10. 将控制器接头插入动力基座。见图 3。



图9. 扶手底部

五、舒适度调节

调节脚踏板高度

脚踏板高度可以轻松的以0.5 英寸（1.27 厘米）进行调节。

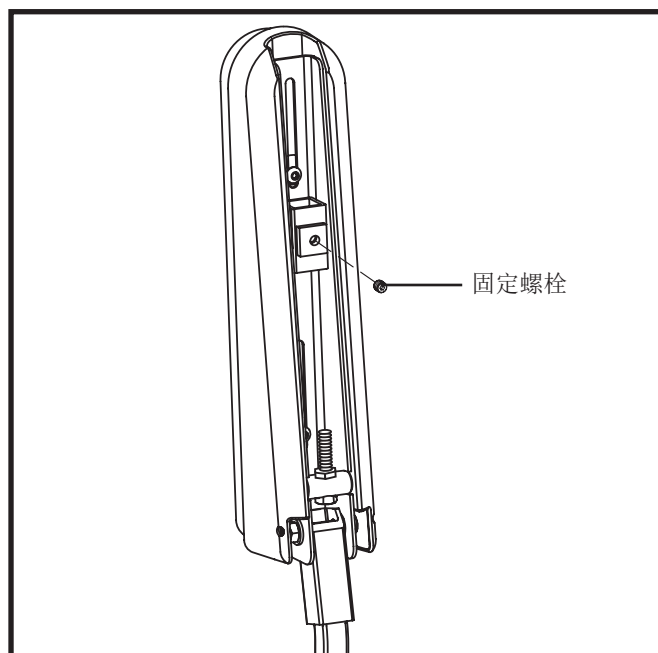
如何升高或降低脚踏板：

1. 从脚踏板支架上拆下固定件。见图 10。
2. 将脚踏板升高或降低至所需高度。
3. 在脚踏板支架上重新安装固定件并拧紧。

脚踏板深度调节

如何调节脚踏板深度：

1. 从脚踏板支架上拆下固定件。见图 10。
2. 将脚踏板向内或向外移动至所需深度。
3. 在脚踏板支架上重新安装固定件并拧紧。

调节脚踏板角度

您还可以调节脚踏板的角。见图10。

如何调节脚踏板角度：

1. 将脚踏板抬起并找到调节螺栓。
2. 转动调节螺栓以抬高或放低脚踏板前端位置。



图 10. 调节脚踏板

五、舒适度调节

翻转脚踏板

翻转脚踏板（SFR 踏板）允许您在乘上或离开电动轮椅前将脚踏板翻转到侧面。见图 11。

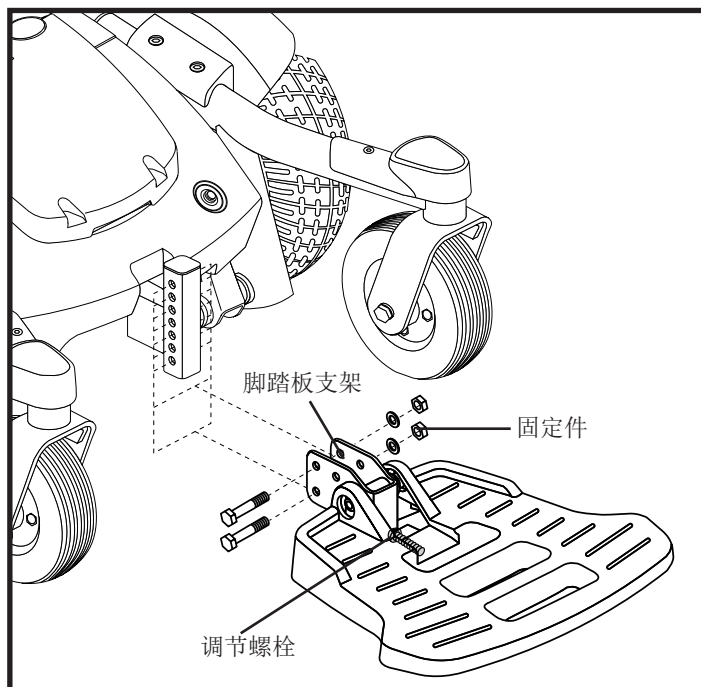
如何翻转SFR 踏板：

1. 将控制杆向内推。
2. 旋转 SFR 踏板。

如何调整SFR 踏板长度：

1. 从脚踏板延长杆上拆下调节螺栓。
2. 将脚踏板向上或向下滑动至所需位置。
3. 重新安装两侧调节。

升降式腿部支撑架

升降式腿部支撑架（ELR 支架）可以不受限制的调节腿部角度，并可以在12 到19 英寸（30.48-48.26 厘米）范围内调节脚踏板。见图 12。

如何旋转ELR 支架：

1. 将控制杆 A 向内推。
2. 旋转 ELR 支架。

如何调整ELR 支架角度：

1. 将控制杆 B 向下推。
2. 将支架调整至合适角度。

如何调整ELR 支架长度：

1. 拆除腿部支架延长杆两侧的调节螺栓。
2. 将腿部支架向上或向下滑动至所需长度。
3. 重新安装两侧的调节螺栓。



图 11. 翻转脚踏板



图 12. 升降式腿部支架

五、舒适度调节

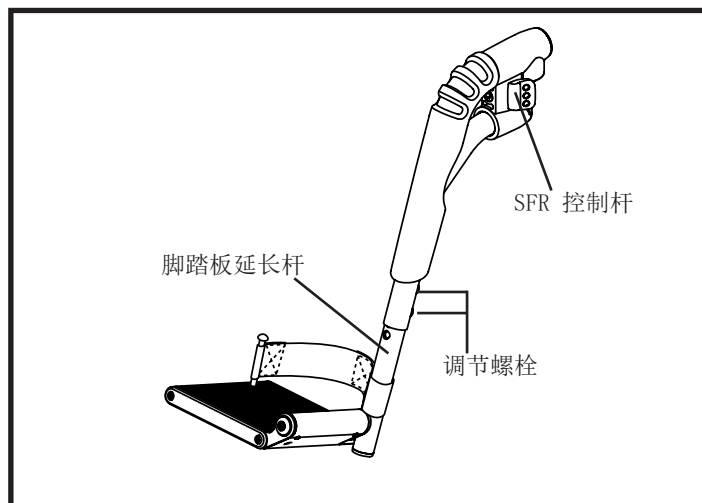
定位腰带

您的电动轮椅可能配备了可以调节的定位腰带。见图14。定位腰带设计用于为乘员提供支持，保证乘员不会在座椅上向前或向后滑动。定位腰带并非设计作为约束装置使用。

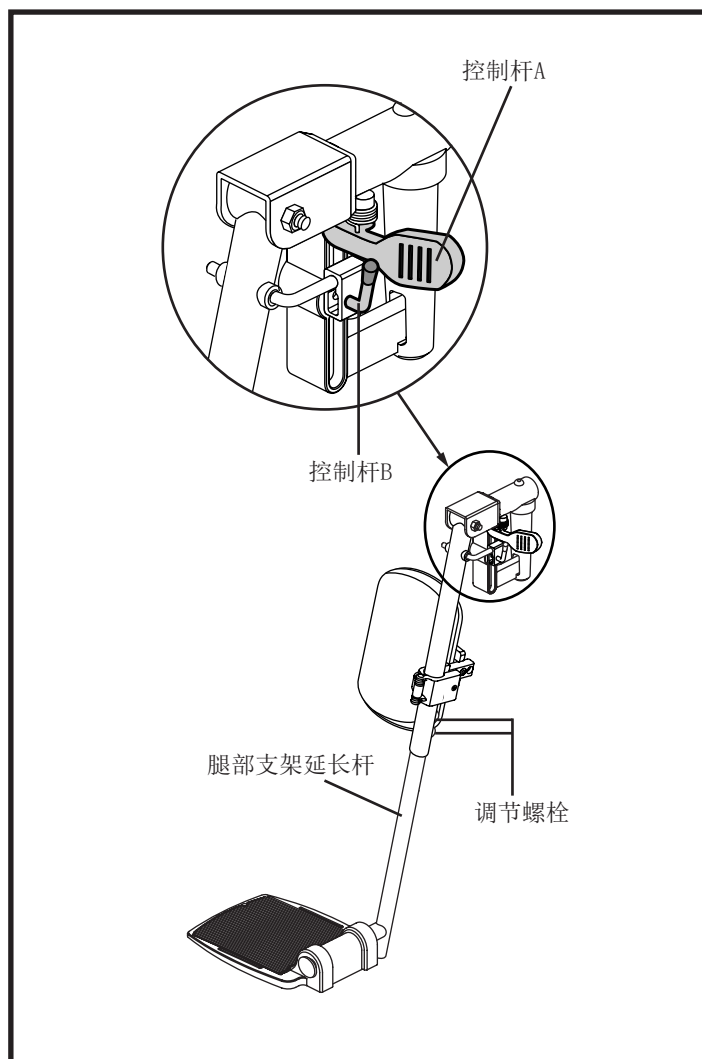

警告！定位带不适用于汽车的安全带。乘车旅行的任何人都应正确地系在汽车制造商认可的座椅上。您的电动座椅不适合在任何车辆中用作座椅，但以下情况除外：车辆必须配备根据捆绑制造商的说明安装的轮椅捆绑和乘员约束系统（WTORS），并符合ANSI/RESNA WC/Vol. 4, 第18/ISO 10542节标准，并且电动座椅必须具有符合ANSI/RESNA WC/Vol. 4, 第19/ISO 7176-19标准。必须使用完整的WTORS将电动座椅固定到车辆上，并为电动座椅乘员提供经过适当设计和测试的安全约束系统。必须同时使用带有骨盆带和上躯干安全带的约束系统，以保护电动座椅乘员，并在碰撞或突然制动期间将因接触车辆而造成伤害的可能性降至最低。

警告！定位腰带应当随时保持固定。不能让定位腰带悬置或在地板上拖动，否则可能会被缠住。



图 13. 调节定位腰带

如何安装定位腰带：

1. 拆除左右两侧座椅铰链上将座椅铰链固定在座椅底座上的最后侧的螺栓。
2. 使用螺栓和提供的垫片将定位腰带固定在电动座椅两侧的座椅底座上。
3. 拧紧两侧螺栓。

如何调节定位腰带：

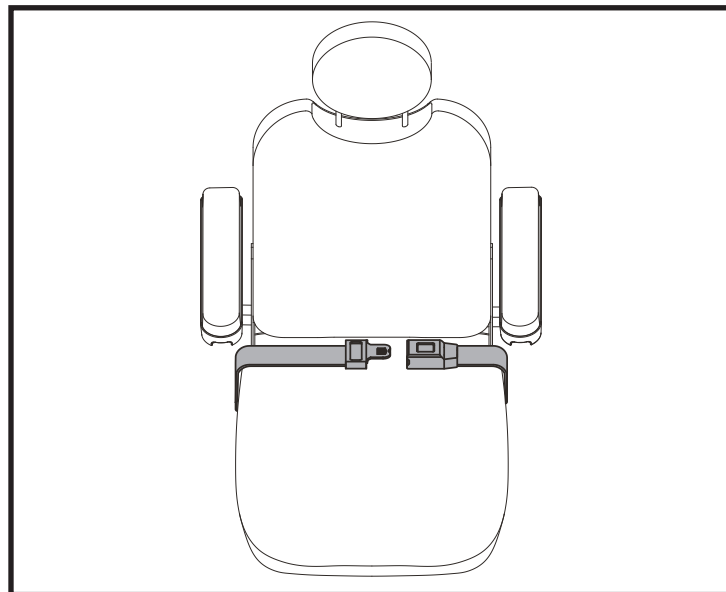
1. 在坐上轮椅后，将腰带一头的金属头插入另一头的塑料扣中，直到听到咔的一声。见图 13。
2. 拉动金属头上的延长带，直到腰带紧固，但不造成不适为止。

如何松开定位腰带：

1. 按下塑料扣上的按钮即可松开。



强制！在每次使用前一定要确保定位腰带已牢固的固定到电动轮椅上，并根据乘员舒适度进行了调节。

强制！在每次使用电动轮椅前必须检查定位腰带上是否存在松脱零件或损坏，包括撕裂、磨损点、金属件弯曲、锁定机制损坏、灰尘或碎屑等。如果您发现存在问题，请联系Pride 授权供应商进行维修。

六、电池和充电方法

电池和充电

您的电动轮椅使用两块长寿命12 伏深循环电池提供电力。这些电池完全密封并不需维护。由于电池密封，因此没有必要检查电解液深度。深循环电池设计用于处理更长时间和更深的放电情况。尽管这些电池看起来和汽车电池类似，但二者不能互换。汽车电池并非设计用于长时间深入放电，同时也不能安全用于电动轮椅。



强制！ 电池接线柱、端子和相关配件均含金属铅和铅化合物。在处理电池时请戴好护目镜和手套，并在完工后洗手。



禁止！ 必须使用两块相同类型、相同化学性质和相同安培小时（Ah）容量的电池。请参考本手册内和电池充电器附带手册内的规格表以确定推荐使用的电池类型和容量。



警告！ 如果您对电动轮椅中使用的电池存在任何疑问，请联系Pride 授权供应商。

为电池充电

电池充电器是保证您的电动轮椅电池长期使用所必不可少的设备。充电器设计用于通过安全、快速而轻松的充电来优化您的电动轮椅的性能。电池充电器只有在充电器电源线插入电源插座后才能使用。



禁止！ 拆除地线插头可能导致触电危险。如有必要，请在两孔电源插座上安装经过认证的3 孔转接器。



禁止！ 不得使用延长线连接您的电池充电器。必须直接将充电器插入正确布线，符合标准的电源插座。



禁止！ 在电池充电期间，不得允许儿童在没有监护的情况下在电动轮椅附近玩耍。Pride 建议您不要在轮椅有人乘坐的情况下为电池充电。



强制！ 在为电池充电前必须阅读本手册内和电池充电器附带手册内的说明。



警告！ 在为电池充电时，可能产生爆炸性气体。请将电动轮椅和电池充电器远离火焰或火花等火源，并在充电时提供适当的通风措施。

警告！ 您必须使用我们供应的非车载电池充电器为电动轮椅充电。不得使用汽车电池充电器进行充电。

警告！ 在每次使用前应检查电池充电器、接线和接头是否受损。如果发现损坏情况，请联系Pride 授权供应商。



警告！ 不得尝试开启电池充电器外壳。如果电池充电器似乎未能正常工作，请联系Pride 授权供应商。

警告！ 请注意电池充电器在充电时可能产生高温。应避免皮肤与其接触，并不得将其放置在可能受高温影响的表面上。

警告！ 如果电池充电器配备了冷却槽，不得尝试将物品插入冷却槽。



警告！ 如果您的电池充电器未经过户外使用的测试和审批，则不得将其暴露在负面或极端气候条件下。如果电池充电器暴露在了负面或极端气候条件下，则在室内使用前，必须先使其适应环境条件间存在的差异。请参考电池充电器附带的手册获得更多信息。

六、电池和充电方法

如何使用非车载充电器为电池充电：

1. 将电动轮椅面朝标准电源插座附近停靠。
2. 确定控制器电源已被关闭，并且自由控制杆处于结合位置。参见第III章“您的电动轮椅”。
3. 将非车载充电器插入控制器上的非车载充电器/编程插孔。见图 14。
4. 将非车载充电器插入电源插座。



警告！充电器上的LED 灯表明了充电器在不同时候的状态：充电器通电、充电中以及充电完成。如果LED 灯在24 小时内没有显示充电完成，请拔下充电器并联系Pride 授权供应商。请阅读充电器手册以获得指示灯的完整说明。

5. 电池充满后，从电源插座上拔下非车载充电器，然后从控制器上拔下充电器接头。



图 14. 电池充电

电池磨合

磨合新电池以达到最高效能：

1. 在首次使用新电池前，将其完全充满。这将使电池达到其最高性能水平的90% 左右。
2. 在室内和草坪上使用您的电动轮椅。开始慢慢移动，在您熟悉如何控制前不要前往过远的地方，消耗并磨合电池。
3. 再次使用至少 8 到14 小时为电池完全充电，并再次使用您的电动轮椅。现在电池应当能够达到其性能的90% 以上。
4. 在重复 4 到5 个充放电循环后，电池将达到100% 充电，并可以持续相当长的时间。

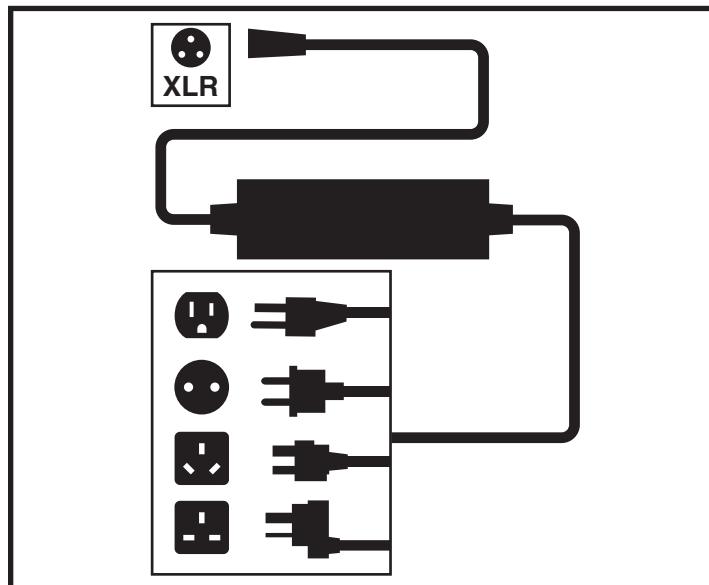
常见问题（FAQ）

充电器如何工作？

电池充电器使用标准的 交流电源插座并将其转化为24V 直流电。电动轮椅电池使用直流电驱动轮椅。当电池电压低时，充电器将全力为电池充电。随着电池电压接近充满时的电压，充电器将减少充电能力。当电池完全充电时，充电器的电流接近于零。这样充电器可以保证电池一直充电而不会过度充电。

我能否使用其他的电池充电器？

您应当使用和电动轮椅一同提供的充电器。这是最安全、最经济的电池充电工具。我们不建议您使用其他类型的充电器（例如汽车电池充电器）。

备注：如果电池被放电到接近电压为零的程度，那么您的电动轮椅充电器可能无法运作。在此情况下，请联系Pride 授权供应商以获得帮助。

我必须每隔多久为电池充电？

在确定电池充电频率时需要考虑很多要素。您可能会每天使用电动轮椅，也可能连续数周都不使用。

■ 日常使用

如果您每天使用电动轮椅，那么请在每天使用结束后立即为电池充电。这样您的电动轮椅可以在每天早上充电完成，满足您一天的活动需要。建议您在每天使用后至少为电池充电8 到14 小时。Pride建议您在电池充电器显示充电完成后继续充电4 小时。

六、电池和充电方法

■ 不经常使用

如果您不经常使用您的电动轮椅（每周一次或更少），那么您应当每周一次至少为电池充电24小时。

备注：您的电动轮椅可能配备了电池充电提示功能。如果您的电动轮椅已经运行了8 小时或更长时间、处于关机状态并且没有在充电，则在下次开机时，将会启动充电提示功能。

充电提示器会在电动轮椅再次关机时显示。电池状况表左侧的红色LED 指示灯将闪烁4 次，每次间隔0.5 秒。在每次关闭电动轮椅时都将出现这一提示，直至充电提示器因电池充电而重置为止。

备注：保证您的电池充满电量，并避免过度放电。请参考电池充电器附带的手册获取充电说明。Pride 建议您每月一次对电池进行至少连续48 小时充电，以改善电池性能和寿命。

我怎样能够在每次充电后都达到最大行程或距离？

通常情况下，您很少会遇到理想的驾驶环境，也就是没有风、山丘或弯道的光滑、水平、坚固的地面。很多时候您都需要面对山丘、坑洼的人行道、不平整的地面、弯道和风速。所有这些因素都会影响每次充电后的运行距离或时间。下列建议可以帮助您在每次充电后达到最大行程：

- 在旅行前一定要完全为电池充电。
- 计划好您的旅程，以尽量避免上坡。
- 将行李限制在必要物品之内。
- 保持匀速前进，不要反复启动- 停止。
- Pride 建议您每月一次对电池进行至少连续48 小时充电，以改善电池性能和寿命。

我应当使用哪种类型的电池？

我们建议您使用深循环免维护的电池。AGM 电池和胶体电池这两种深循环电池都具有类似的性能。



警告！电池中含有腐蚀性物质。请仅使用AGM 电池或胶体电池以降低泄露或爆炸风险。

为什么新电池看起来电力不足？

深循环电池使用与汽车电池、镍镉电池或其他常见类型电池大不相同的化学技术。深循环电池被专门设计用于提供电源、充分放电然后相对快速的充电。应当尽量频繁的为AGM 电池和胶体电池充电。它们不像镍镉电池那样具有记忆效应。

我们和电池供应商紧密合作以提供最适合您的电动轮椅具体要求的电池。Pride 定期收到新生产的电池，这些电池在发货前都已充满。但在运输途中，电池可能会遇到对初始性能产生影响的极端气候条件。高温会带走电池内的电量，而低位则会降低可用电能，同时延长电池充电所需时间（和汽车电池相同）。

电池可能需要数天时间稳定内部温度并适应新的环境温度。更重要的是，电池需要经过多个“充电循环”（部分放电然后完全充电）才能建立对电池达到最高性能和长寿命而言至关重要的化学平衡。您在正确磨合电池上所花的时间非常值得。

我怎样能确保电池达到最大寿命？

完全充电的深循环电池将提供可靠的性能和更长的电池寿命。在可能的情况下，尽量保持您的电动轮椅电池完全充满。经常性深度放电、不经常充电、或在未完全充电情况下储存的电池可能会受到永久损坏，导致电动轮椅运行不可靠以及电池寿命下降。

备注：电池的使用寿命通常反映了电池所受到的维护情况。

六、电池和充电方法

我应当如何存放我的电动轮椅和电池？

如果您不经常使用电动轮椅，我们建议您至少每周一次为电池充电，以保证电池性能。

如果您在较长时间内没有使用电动轮椅的计划，在储存电池前请将其完全充满。断开电池接线，并将电动轮椅储存在温暖干燥的环境内。避免其接触极端温度，例如结冰或高温条件，并且绝对不要尝试为结冰的电池充电。受冻或结冰的电池在重新充电前应当先放置在温暖的环境内数日。

能否搭乘公共运输？

AGM 电池和胶体电池设计用于电动轮椅和其他代步设备。我们建议您预先联系承运人的售票处，以确定承运人的具体要求。

怎样装运？

如果您希望通过货运公司将电动轮椅运输到您的最终目的地，请将您的电动轮椅装入原包装容器内，并使用单独的容器装运电池。

七、保养和维修

保养和维护

Jazzy 系列是相当复杂的电动轮椅。正如其他机动车辆一样，它也需要定期进行维修检查。您可以自行开展部分检查，但其他检查需要得到Pride 授权供应商帮助。预防性维护相当重要。如果您遵守了本章节内所述的定期维修检查规定，就可以确保您的电动轮椅为您提供多年无故障运行。如果您对电动轮椅的保养和运行存在任何疑问，请联系Pride 授权供应商。



警告！不要在电动轮椅有人乘坐的情况下对其进行维修。

正如大多数电子设备一样，您的电动轮椅容易受到环境带来的损害，避免接触任何类型的潮湿区域。



警告！直接接触或长期暴露在水分或潮湿环境下，可能导致电动轮椅的电气和机械功能出现故障。水会导致电子设备腐蚀，并导致轮椅框架生锈。应当定期检查电动轮椅因接触水分、体液或失禁而造成的腐蚀迹象。应当立即更换或处理受损组件。

如果您的电动轮椅接触到了水分：

1. 用毛巾尽可能的擦干您的电动轮椅。
2. 将您的电动轮椅放置在温暖干燥的环境下12 小时，使无法看见的水分蒸发。
3. 在再次使用电动轮椅前，检查操纵杆和制动装置运行情况。
4. 如果发现任何不稳定情况，请将您的电动轮椅送至Pride 授权供应商处。对于定期接触水分，例如失禁情况的电动轮椅，应当经常进行腐蚀检查，并可能需要定期更换电子元件。

温度

- 尽管您的电动椅可以承受-40° F (-40° C) 至149° F (65° C) 的短期存储温度，但建议长期存储温度在-13° F (-25° C) 和122° F (50° C) 。理想的存储条件是尽可能在68° F (20° C) 到70° F (21° C) 之间，但是我们意识到，由于不同的气候和环境，这种存储并不总是可行的。
- 在极端寒冷气候下，电池可能会结冰。具体结冰温度受多种因素制约，例如电池充电程度、使用情况和电池成分（例如AGM 电池或胶体电池）等。

一般指南

- 避免敲击或撞击控制器，特别是操纵杆。
- 避免将您的电动轮椅长期暴露在高温、低温或潮湿环境等极端条件下。
- 保持控制器清洁。
- 检查所有接头，确保接头紧固。
- 确保充气轮胎的气压达到轮胎上标出的psi/bar/千帕气压值。



警告！确保您的充气轮胎达到轮胎上标出的psi/bar/千帕气压值。不要过度充气或充气不足。气压过低可能导致丧失控制，过度充气则可能爆胎。轮胎过度充气可能导致爆炸。

警告！不得使用高压软管为轮胎充气。

- 在轮胎侧壁使用橡胶调节器以帮助保护轮胎。



警告！不得在轮胎胎面区域使用橡胶调节器，这样会导致轮胎和电动轮椅打滑。

- 所有椅轮轴承都已被预先润滑并密封，不需要后续润滑。
- 如果您的电动椅的主体罩具有光滑的表面，则该主体罩已喷涂有透明的密封剂涂层。您可以涂一层薄薄的汽车蜡，以帮助其保持高光泽外观。如果您的电动椅带有雾面的护罩，请仅使用专为雾面漆开发的产品。请勿使用蜡，细部喷雾剂，ArmorAll®或任何用于光面漆的产品。

七、保养和维修



警告！ 仔细选择正确的产品，以保护电动椅罩的光洁度。仅将为哑光漆开发的产品用于具有哑光效果的罩上。不遵循此警告可能会损坏导电罩的哑光漆面。

- 检查所有电源接头。保证接头紧固并未被腐蚀。电池必须必须在电池框体内保持水平，并且电池端子相对向内。请参考电池布线标签进行正确布线。



警告！ 尽管电动轮椅已经通过了液体进入的必要测试要求，但您还是应当使电源接头远离潮湿来源，包括不得直接暴露在水分或体液和失禁条件下。经常检查电气元件上是否存在腐蚀迹象并进行必要更换。

日常检查

- 在关闭控制器后，检查操纵杆。确保操纵杆没有弯曲或受损，并可在松手后返回中心位置。检查操纵杆底座周围的橡胶套是否受损。目测检查橡胶套，不要处理或尝试修理。如果存在问题，请联系Pride 授权供应商。
- 目测检查控制器线束。确保不存在磨损、切割或裸线情况。如果存在问题，请联系Pride 授权供应商。
- 检查实心轮胎上的磨平点。磨平点可能对稳定性造成不利影响。
- 检查座椅系统、扶手和椅前配件是否存在松脱元件、疲劳点或受损情况。如果存在问题，请联系Pride授权供应商。

每周检查

- 从动力基座上断开并检查控制器线束和充电器线束。检查腐蚀迹象。如有必要请联系Pride 授权供应商。
- 确保所有控制器系统零件都被牢固的固定在电动轮椅上。不要过度拧紧螺栓。
- 检查轮胎是否正确充气。充气轮胎压力应达到但不超过每个轮胎上标明的压力值。如果轮胎漏气，请联系Pride 授权供应商更换。
- 检查制动。本测试应在水平地面上进行，并保证电动轮椅周围至少1 米（3 英尺）范围内没有障碍。

如何检查制动：

1. 打开控制器并调低电动轮椅速度。
2. 在一秒后，检查电池状况表。确保其处于开启状态。
3. 缓慢的向前推操纵杆，直到听到电动刹车咔的一声。立即松开操纵杆。您应该可以在操纵杆移动几秒内听到每个方向的电动刹车运行的声音。将操纵杆向后、向左然后向右推，重复测试三次。

每月检查

- 检查驱动轮的磨损情况。联系Pride 授权供应商进行维修。
- 检查转向轮的磨损情况。根据需要进行更换。
- 检查转向叉是否受损或松动，这表明它们可能需要调整或更换轴承。联系Pride 授权供应商进行维修。
- 检查整个电动轮椅中是否存在松动元件，并且确定轮椅功能或性能是否出现变化。联系Pride 授权供应商进行服务或维修。
- 保持电动轮椅清洁而没有泥土、灰尘、头发、食物、饮料等异物存在。

每年检查

您应当将电动轮椅带往Pride 授权供应商处进行年度维修，特别是在您每天使用电动轮椅的情况下。这将帮助您确保电动轮椅正常运作，并避免未来出现问题。

七、保养和维修

储存

您应当将电动轮椅储存在干燥并不受极端温度影响的环境下。在储存时，应将电池与电动轮椅断开。参见第VI章“电池和充电”。



警告！如果您未能正确储存，轮椅框架可能生锈，电子元件也可能受损。

经常性深度放电、不经常充电、或在未完全充电情况下储存的电池可能会受到永久损坏，导致电动轮椅运行不可靠以及电池寿命下降。建议您在长期储存电池时，定期对其进行充电，以确保其性能正常。

在长期储存电动轮椅时，您可能会希望在其框架下放置多块木板用于支撑，这样可以使轮胎不必承受车体重量，减少轮胎接触地面区域出现磨平点的可能性。

处理您的电动轮椅

您必须根据适用的当地和国家法律法规处理电动轮椅。请联系您当地的垃圾处理机构或Pride 授权供应商获取正确处理电动轮椅包装材料、金属框架组件、塑料组件、电子设备、电池、氯丁橡胶、硅树脂以及聚氨酯材料的有关信息。



警告！ 塑料袋有窒息危险。 正确处理塑料袋，不要让儿童玩耍。

清理和消毒

- 使用湿布和温和的非研磨性清洁剂清理电动轮椅的塑料和金属零件。避免使用可能划伤电动轮椅表面的产品。
- 如有必要，使用经过批准的消毒剂清理您的产品。在使用前请确保消毒剂可以安全的用于您的产品。

警告！ 在产品上使用消毒剂及/或清洁剂前，必须遵守所有正确使用的安全说明。未能遵守说明可能导致皮肤刺激、电动轮椅内饰及/或外观过早老化。



警告！不得用水管直接冲洗电动轮椅或使其与水直接接触。您的电动轮椅使用了经涂装的ABS 塑料外壳，可以简单的使用湿布清洁。

警告！不得使用任何化学药品清洁乙烯基座椅，它们可能导致座椅变滑或干燥裂开。使用肥皂水清洁并保证座椅彻底干燥。

更换椅轮

如果您使用充气轮胎并且椅轮变平，请更换内胎。如果您的轮椅配备了实心轮胎内容物，则必须更换整个椅轮组件。您可以随时通过Pride 授权供应商获得备用轮胎、内胎和椅轮组件。

警告！电动轮椅的椅轮只能由Pride 授权供应商或合格技术人员进行维护或更换。



警告！在进行本程序前，请确保控制器电源已关闭，并且电动轮椅不处在自由控制模式下。

警告！在更换轮胎时，只需拆下中心螺母和垫片，然后拆下椅轮。如果需要进一步拆卸，则应首先将椅轮完全放气，否则可能存在爆炸危险。

遵照下列简单步骤对充气 and 实心轮胎进行快速安全的修理：

1. 关闭控制器电源。
2. 确保电动轮椅处于行驶模式。见图 4。
3. 抬起并支撑动力基座，使椅轮离地至少1 英寸（2.5 厘米）。
4. 如果您需要更换充气轮胎，在拆卸轮胎前应将其完全放气。
5. 如有轮毂盖，先将其拆下。见图 15。
6. 从轮轴上拆下驱动轮螺母和垫片。见图 15。
7. 从轮轴上拆下驱动轮。确保您保管好了锁钥。

七、保养和维修

8. 拆下固定两个半轮辋的螺母。
9. 从充气轮胎中拆下旧内胎并更换新内胎；如果是实心轮胎，则更换整个椅轮。
10. 重新组装两个半轮辋。
11. 将车轮重新装上轮轴，确保锁钥位于轮轴槽内。



警告！确保在安装车轮时将轮轴锁钥正确的安装在轮轴槽内。如果没有正确安装，则制动系统将处于断开状态，可能导致人身伤害及/或产品损坏。

12. 重新安装驱动轮螺母并拧紧。见图 15。



警告！确保重新安装并正确拧紧螺母和垫片。

13. 如有轮毂盖，将其重新安装。
14. 将充气轮胎充至每个轮胎上标明的psi/bar/千帕气压为止。
15. 将电动轮椅从底部支撑物上取下。



图 15. 拆卸驱动轮

七、保养和维修

更换电池

在动力基座的一个贴纸上印出了电池布线图。正确的电池规格参见第VI 章“电池和充电”。

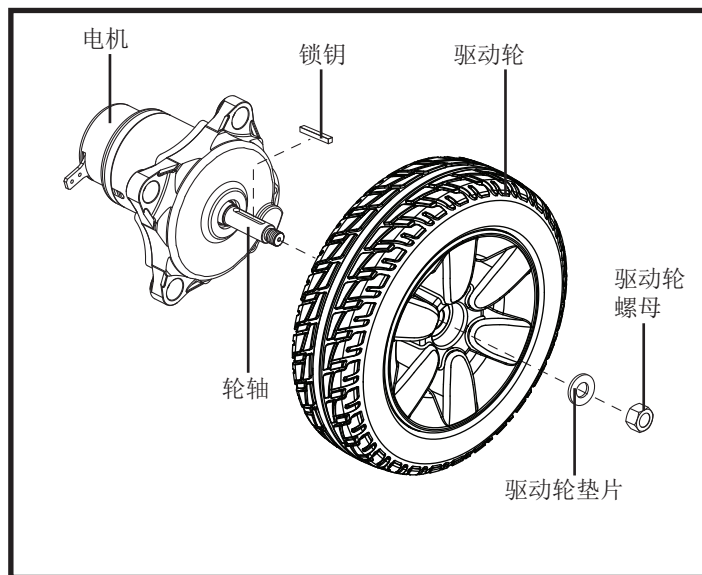

强制！ 电池接线柱、端子和相关配件均含金属铅和铅化合物。在处理电池时请戴好护目镜和手套，并在完工后洗手。

警告！ 电动轮椅内的电池只能由Pride 授权供应商或合格技术人员进行维护或更换。

警告！ 不得在轮椅有人乘坐时更换电池。



警告！ 电动轮椅电池相当沉重。参见规格表。如果您无法举起该重量，请一定要寻找他人帮助。使用正确的技巧，避免举起超过您能力范围的重量。

警告！ 不要混合使用新旧电池。一定要同时更换两块电池。



禁止！ 保证工具和其他金属物品远离电池接线柱。接触工具可能导致触电。

您可能需要下列设备更换电池：

- 公制/ 标准插座组和棘轮
- 可调扳手

如何更换电池：

1. 关闭控制器电源。
2. 确保电动轮椅处于行驶模式。见图 4。
3. 拆下后挡板。见图 16。
4. 松开黄色翼形螺钉并拆下侧面挡板。
5. 将后方电池线束与动力基座断开。见图 16。
6. 将后方电池从动力基座中滑出。
7. 将前方电池向后滑动。
8. 将前方电池线束与动力基座断开。见图 16。
9. 将前方电池从动力基座中滑出。
10. 从旧电池上拆下电池线束，并将其安装到新电池上。确保接线设备朝向正确方向。见图 16。



警告！ 确定拧紧所有紧固件，保证连接稳固。

11. 将前方电池放入动力基座。确保接线柱面朝动力基座前方。见图 16。
12. 将前方电池线束与动力基座相连。
13. 将前方电池向前滑动。
14. 将后方电池放入动力基座。确保接线柱面朝动力基座前方。见图 16。
15. 将后方电池线束与动力基座相连。
16. 重新安装侧面挡板。
17. 重新安装后挡板。

备注：在安装后挡板时，确定控制器和电动座椅线束均通过前盖板右侧缺口布线。

18. 为电池充电。参见第VI 章“电池和充电”。

七、保养和维修



图16. 电池安装（去除了座椅以便更清楚的显示）

七、保养和维修

何时应联系Pride 授权供应商进行维护

以下现象可能表明您的电动轮椅出现了严重问题。如有必要，请联系Pride 授权供应商。在联系时，应说明型号、序列号、问题性质以及可用的错误代码。

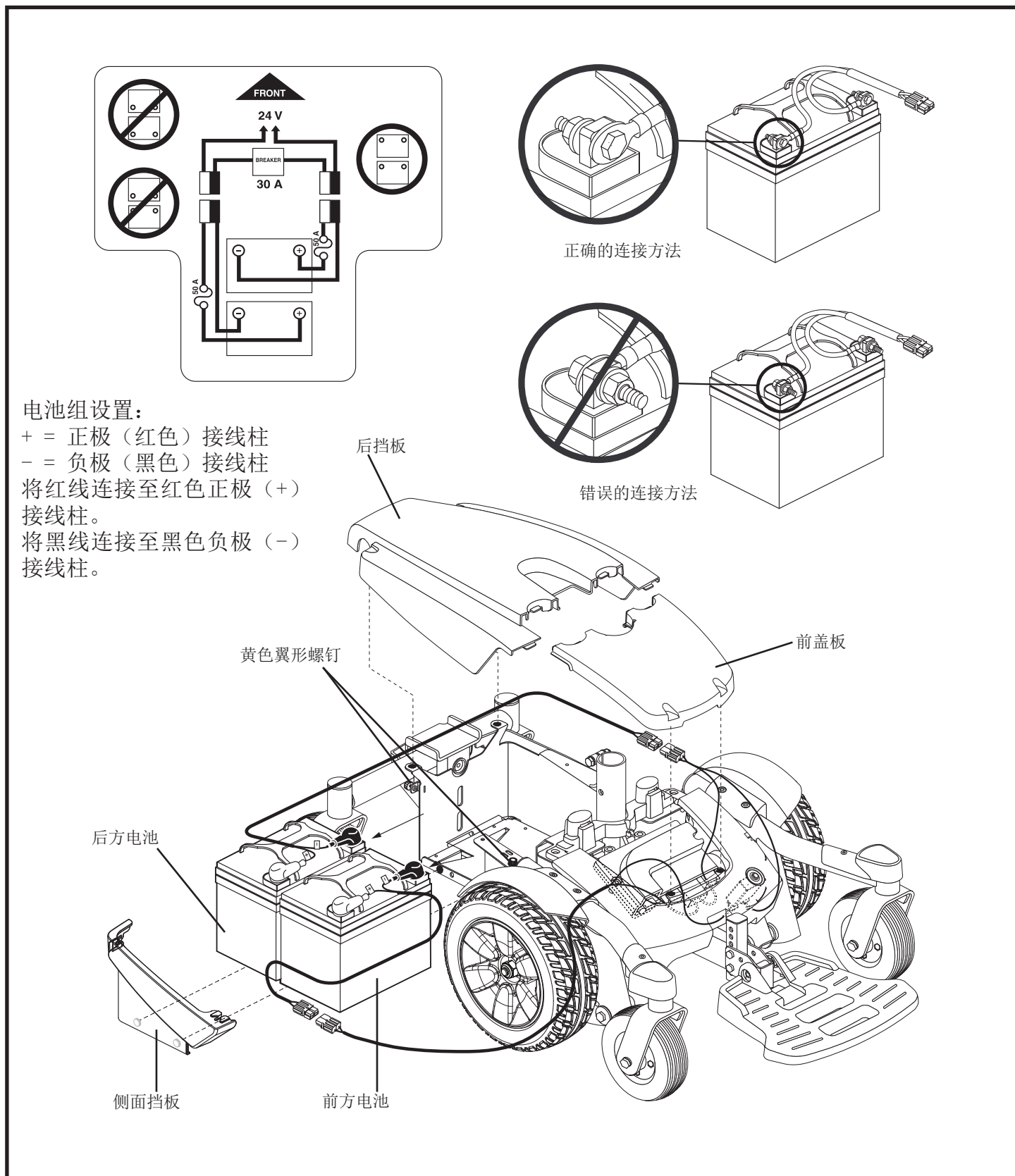
- 发动机噪音
- 线束磨损
- 接头破损或损坏
- 任何轮胎出现不平均的磨损
- 移动生涩
- 向一侧跑偏
- 椅轮组件弯曲或损坏
- 无法启动
- 可以启动，但无法移动
- 座椅或座椅组件松动

纠正性维护

如果您打开电源时，电池状况表未能亮起：

- 检查线束连接。确保接头紧固。
- 检查断路器。必要时将其重置。
- 检查电池接线。

如果上述条件正常，您可以使用电池负载测试器检测电池负载。这些测试器可以在汽车配件店内买到。在进行负载测试前应断开两块电池的连线，并遵循负载测试器附带的说明。如果任何一块电池未能通过负载测试，则应同时更换两块电池。如果您的电动轮椅仍未能启动，请联系Pride 授权供应商。

八、其他说明

建议：使用本公司自己认可的部件。

适用范围：供行动有困难的残疾人和年老体弱者短距离出行代步用。

生产商可向认可的维修单位提供维修技术资料。

生产日期：

产品使用有效期：5 年

电动轮椅车的附件及废弃物禁止随意丢弃，具体处理方式参见第25 页。

充电器应符合“GB 9706.1-2007 的要求”

电动轮椅车的外形尺寸应符合表1 的规定

表1 电动轮椅车外形尺寸（单位：毫米）

项目	室外型
总长L	1080
总宽B	620
总高H	1022

电动轮椅车的总质量应为68kg，误差±10%。

电动轮椅车的性能要求应符合表2 的规定

表2 电动轮椅车性能要求

项目内容		标准要求
		室外型
最大速度		≤6km/h
行驶制动性能	水平路面制动	≤1.5m
	最大安全坡度制动	≤3.6m(6°)
驻坡性能		9°
静态稳定性		≥9°
动态稳定性		≥6°
越障高度		≥40mm
越障高度		100mm
爬坡能力		≥6°
最小回转半径		1200mm
理论行驶距离		≥20km

八、其他说明

基本参数及电气参数见表3 和表4:

表 3 基本参数

编号	项目		型号	误差范围
			Jazzy Select 6	
1	总长/mm		1080	±10%
2	总宽/mm		620	
3	总高/mm		1022	
4	座位宽度/mm		460	
5	座位离地高(前端)/mm		457	
6	扶手高度/mm		102	
7	靠背高度/mm		508	
8	质量/kg		67	
9	最大使用者质量/kg		100	
10	前后轮规格/mm	驱动轮直径	254	
		方向轮直径	153	

表4 电气参数

组件	项目	型号
		Jazzy Select 6
电动机	额定电压/V	24
	额定功率/W	80
电池(组)	额定容量/Ah	33
	额定电压/V	12
	配备数量/个	2
充电器	电源/V, Hz	100-240V, 50-60Hz
	最大输出电流/A	3.5
控制器	最大输出电流/A	40

八、其他说明

附录A 安全特性

- A. 1.1 按防电击类型分类：内部电源
- A. 1.2 按防电击程度分类：B 型应用部分
- A. 1.3 按对进液的防护程度分类：IPX4
- A. 1.4 按在与空气混合的易燃麻醉气或与氧或氧化亚氮混合的易燃麻醉气情况下使用时的安全程度分类：非AP/APG 型。
- A. 1.5 按运行模式分类：连续运行。
- A. 1.6 额定电压：DC 24V。
- A. 1.7 不具有对除颤放电效应防护的应用部分
- A. 1.9 不具有信号输出或输入部分。
- A. 1.10 为非永久性安装设备。

医疗器械注册证编号：国械注进20162562455

产品技术要求编号：

生产商：PRIDE MOBILITY PRODUCTS CORP.

生产商地址：401 York Avenue, Duryea, PA 18642

电话：800-8008586-1381

中国区服务机构：普拉德机动产品商贸（上海）有限公司

中国区服务机构地址：上海浦东新区建韵路500 号4 幢508 室

代理人名称：普拉德机动产品商贸（上海）有限公司

代理人住所：上海浦东新区建韵路500 号4 幢508 室

代理人联系方式：+86-021-5192-3035

笔记

JAZZY[®] SELECT 6



SAFETY GUIDELINES



WARNING! An authorized Pride Provider or a qualified technician must perform the initial setup of this power chair and must perform all of the procedures in this manual.

The symbols below are used throughout this owner's manual and on the power chair to identify warnings and important information. It is very important for you to read them and understand them completely.



WARNING! Indicates a potentially hazardous condition/situation. Failure to follow designated procedures can cause either personal injury, component damage, or malfunction. On the product, this icon is represented as a black symbol on a yellow triangle with a black border.



MANDATORY! These actions should be performed as specified. Failure to perform mandatory actions can cause personal injury and/or equipment damage. On the product, this icon is represented as a white symbol on a blue dot with a white border.



PROHIBITED! These actions are prohibited. These actions should not be performed at any time or in any circumstances. Performing a prohibited action can cause personal injury and/or equipment damage. On the product, this icon is represented as a black symbol with a red circle and red slash.

INTENDED USE

The intended use of the Pride Mobility Products device is to provide mobility to persons limited to a seated position that have the capacity of operating a powered wheelchair.

Quick Reference Information

Authorized Pride Provider: _____

Address: _____

Telephone: _____

Purchase Date: _____

NOTE: This owner's manual is compiled from the latest specifications and product information available at the time of publication. We reserve the right to make changes as they become necessary. Any changes to our products may cause slight variations between the illustrations and explanations in this manual and the product you have purchased. The latest/current version of this manual is available on our website.

NOTE: This product is compliant with WEEE, RoHS, and REACH directives and requirements.

NOTE: This product meets IPX4 classification (IEC 60529).

NOTE: This product and its components are not made with natural rubber latex. Consult with the manufacturer regarding any after-market accessories.

CONTENTS

I. INTRODUCTION	36
II. SAFETY	37
III. YOUR POWER CHAIR	39
IV. ASSEMBLY	43
V. COMFORT ADJUSTMENTS	44
VI. BATTERIES AND CHARGING	50
VII. CARE AND MAINTENANCE	54
VIII. OTHER INSTRUCTIONS	61

I. INTRODUCTION

SAFETY

WELCOME to Pride Mobility Products (Pride). The power chair you have purchased combines state-of-the-art components with **safety**, comfort, and styling in mind. We are confident that these design features will provide you with the conveniences you expect during your daily activities. Once you understand how to **safely** operate and care for your power chair, it should give you years of trouble-free operation and service.

Read and follow all instructions, warnings, and notes in this manual before attempting to operate your power chair for the first time. You must also read all instructions, warnings, and notes contained in any supplemental instructional booklets for the controller, front riggings, and/or seating system that accompanied your power chair before initial operation. Your **safety** depends upon you, as well as your provider, caretaker, or healthcare professional in using good judgement.

If there is any information in this manual which you do not understand, or if you require additional assistance for setup or operation, please contact your authorized Pride Provider. **Failure to follow the instructions in this manual and those located on your power chair can lead to personal injury and/or damage to the power chair, and may void the warranty.**

PURCHASER'S AGREEMENT

By accepting delivery of this product, you promise that you will not change, alter, or modify this product or remove or render inoperable or unsafe any guards, shields, or other safety features of this product; fail, refuse, or neglect to install any retrofit kits from time to time provided by Pride to enhance or preserve the safe use of this product.

SHIPPING AND DELIVERY

Before using your power chair, make sure your delivery is complete as some components may be individually packaged. If you do not receive a complete delivery, please contact your authorized Pride Provider immediately. Where damage has occurred during transport, either to the packaging or content, please contact the delivery company responsible.

NOTE: If you ever lose or misplace your copy of this manual, contact us and we will be glad to send you a new one immediately.

II. SAFETY

PRODUCT SAFETY SYMBOLS

The symbols below are used on the power chair to identify warnings, mandatory actions, and prohibited actions. It is very important for you to read and understand them completely.

NOTE: *There are more warnings identified and explained in the Consumer Safety Guide that is included with your power chair. Please become familiar with all the warnings and safety information found in the Consumer Safety Guide and refer to this resource often.*



Read and follow the information in the owner's manual.



Locked and in drive mode

Place unit on level ground and stand to one side when changing from drive mode to freewheel mode or freewheel mode to drive mode.

Unlocked and in freewheel mode



Indicates power chair securement points.



Class II Equipment



Manufactured in



Power Chair information label

II. SAFETY

GENERAL GUIDELINES



MANDATORY! Do not operate your new power chair for the first time without completely reading and understanding this owner's manual.

Your power chair is a state-of-the-art life-enhancement device designed to increase mobility. Pride provides an extensive variety of products to best fit the individual needs of the power chair user. Please be aware that the final selection and purchasing decision regarding the type of power chair to be used is the responsibility of the power chair user, who is capable of making such a decision, and his/her healthcare professional (i.e., medical doctor, physical therapist, etc.).

The contents of this manual are based on the expectation that a mobility device expert has properly fitted the power chair to the user and has assisted the prescribing healthcare professional and/or the authorized Pride Provider in the instruction process for the use of the product.

There are certain situations, including some medical conditions, where the power chair user will need to practice operating the power chair in the presence of a trained attendant. A trained attendant can be defined as a family member or care professional specially trained in assisting a power chair user in various daily living activities.

As you begin using your power chair during daily activities, you will probably encounter situations in which you will need some practice. Simply take your time and you will soon be in full and confident control as you maneuver through doorways, on and off of elevators, up and down ramps, and over moderate terrain.

Below are some precautions, tips, and other safety considerations that will help you become accustomed to operating your power chair safely.

Pre-Ride Safety Check

Get to know the feel of your power chair and its capabilities. Pride recommends that you perform a safety check before each use to make sure your power chair operates smoothly and safely.

Perform the following inspections prior to using your power chair:

- Check for proper tire inflation. Maintain but do not exceed the psi/bar/kPa air pressure rating indicated on each tire if equipped with pneumatic tires.
- Check all electrical connections. Make sure they are tight and not corroded.
- Check all controller connections to the power base. Make sure they are secured properly.
- Check the brakes. See VII. "Care and Maintenance."
- Check battery charge. See VI. "Batteries and Charging."
- Ensure the manual freewheel levers are in drive mode before sitting on the power chair.

NOTE: If you discover a problem, contact your authorized Pride Provider for assistance.

III. YOUR POWER CHAIR

THE JAZZY® SELECT 6 POWER CHAIR

The Jazzy® Select 6 Power Chair has two main assemblies: the seat assembly and the power base assembly. See **figure 1**. Typically, the seat assembly includes the armrests, seatback, and seat base. The power base assembly includes two motor/brake assemblies, two drive wheels, four caster wheels, two batteries, and wiring harnesses. See **figures 1, 2, and 3**.

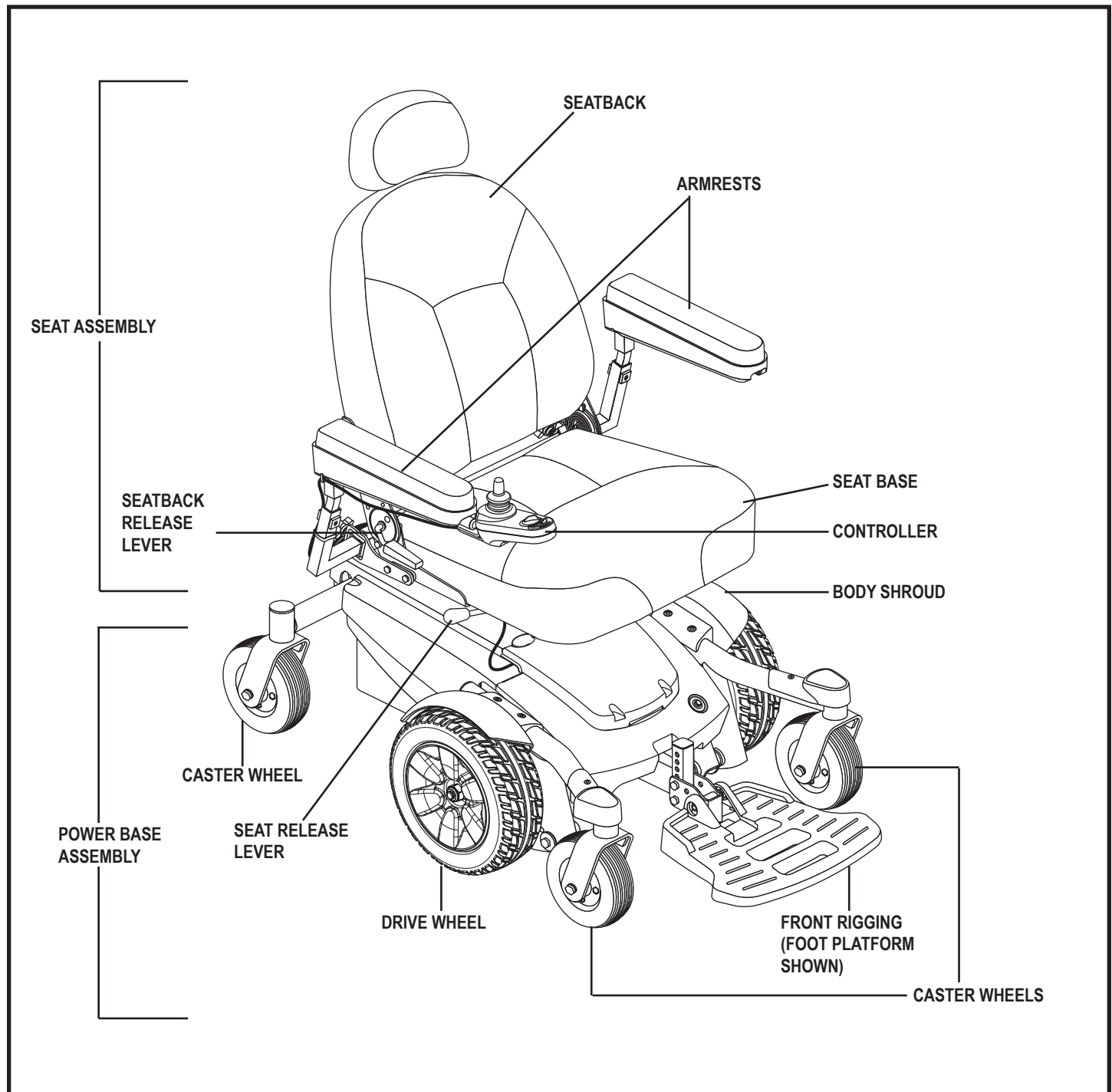

Figure 1. The Jazzy® Select 6 Power Chair

III. YOUR POWER CHAIR

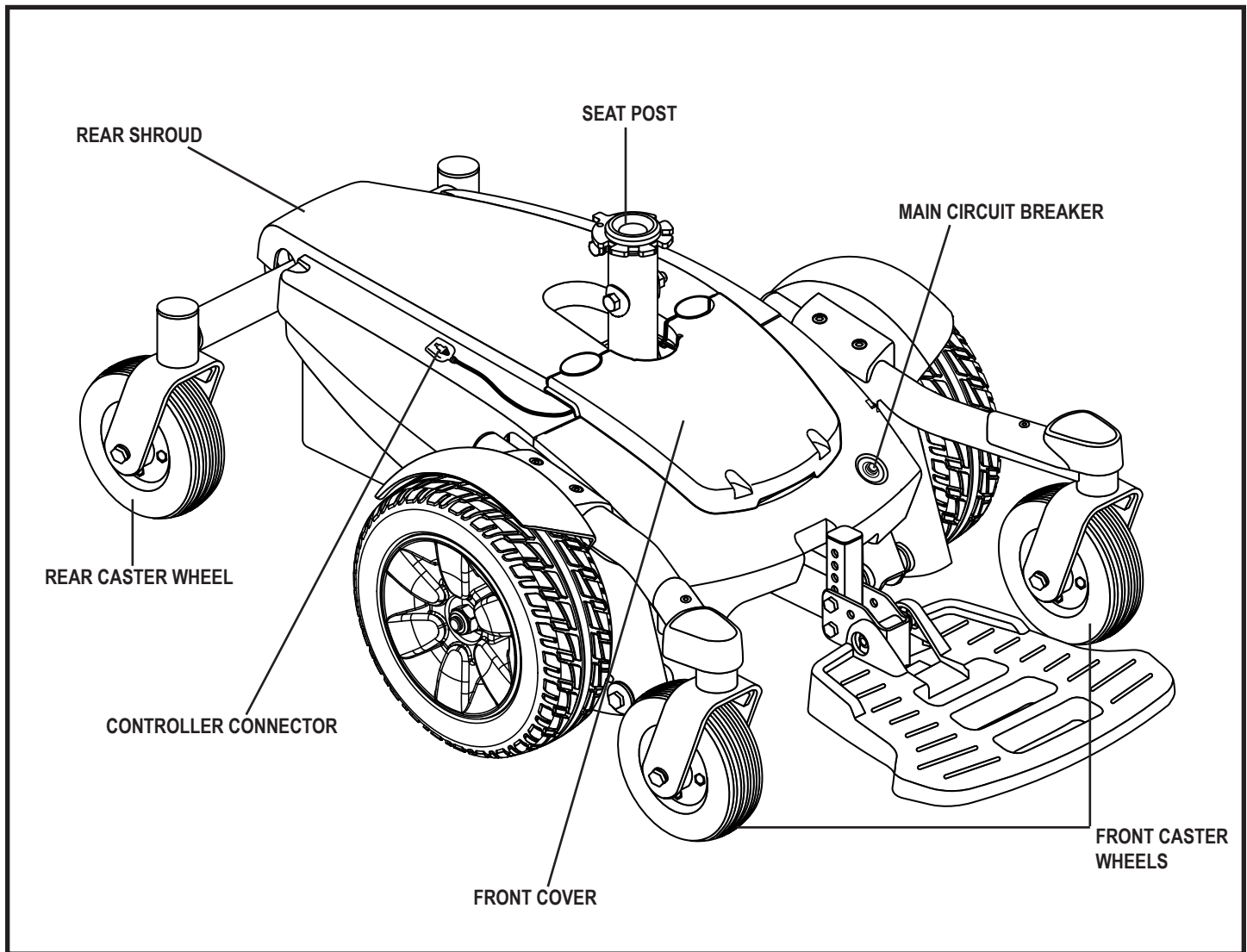

Figure 2. The Jazzy Select 6 Power Base

Electrical Components

The electrical components are located either on or inside the power base. The main circuit breaker is located on the side of the power base. The power module is located under the front cover. See figure 6.

Main Circuit Breaker: The main circuit breaker is a safety feature built into your power chair. When the batteries and the motors are heavily strained (e.g., from excessive loads), the main circuit breaker trips to prevent damage to the motors and the electronics. If the circuit trips, allow your power chair to “rest” for approximately one minute. Next, push in the circuit breaker button, turn on the controller, and continue normal operation. If the main circuit breaker continues to trip repeatedly, contact your authorized Pride Provider.

Power Module: Provides connection between the joystick module and the motors, batteries, and off-board charger.

III. YOUR POWER CHAIR

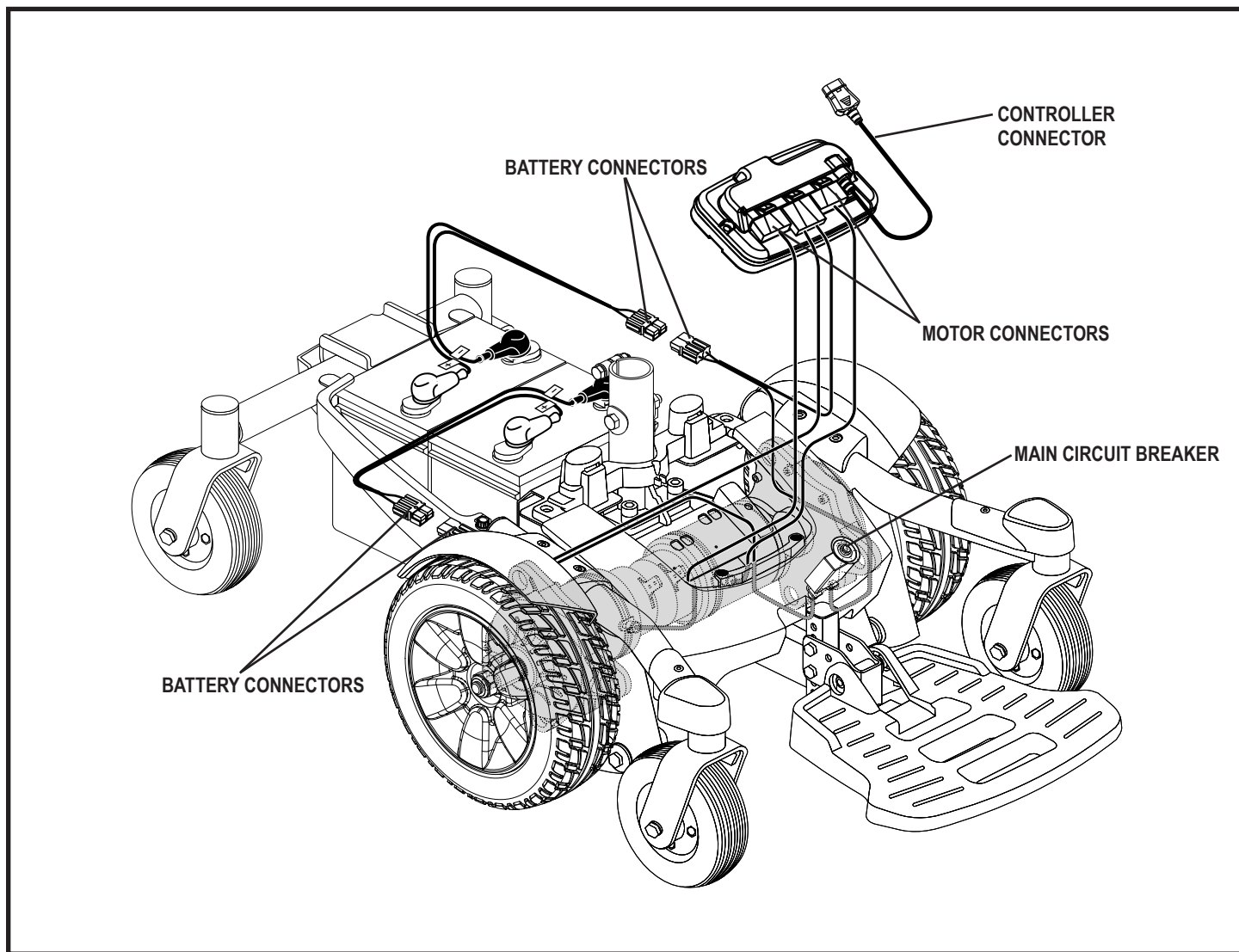

Figure 3. Jazzy® Select 6 Electrical Components

III. YOUR POWER CHAIR

Manual Freewheel Levers

Your power chair has a manual freewheel lever on each motor. Manual freewheel levers enable you to disengage the drive motors from the gearboxes and maneuver the chair manually.



WARNING! Do not use the power chair while the drive motors are disengaged! Do not disengage the drive motors when the power chair is on an incline or decline, as the unit could roll on its own. Only engage the freewheel mode when on a level surface.



WARNING! It is important to remember that when your power chair is in freewheel mode, the braking system is disengaged.

To engage or disengage the drive motors:

1. Locate the lever on each side of the power base.
2. Pull both levers upward to engage the drive motors (drive mode). See figure 4.
3. Push both levers downward to disengage the drive motors (freewheel mode). See figure 5.

If a lever is difficult to move in either direction, slightly rock the power chair back and forth. The lever should then move to the desired position.

WARNING! Avoid applying excessive force to the manual freewheel levers.



WARNING! Do not use your foot to operate the manual freewheel levers. Do not stand on the manual freewheel levers. Applying excessive force to the manual freewheel levers may result in damage to the freewheel levers, motors, and brakes.

WARNING! Do not use the freewheel lever handles as tie-down points to secure this product.

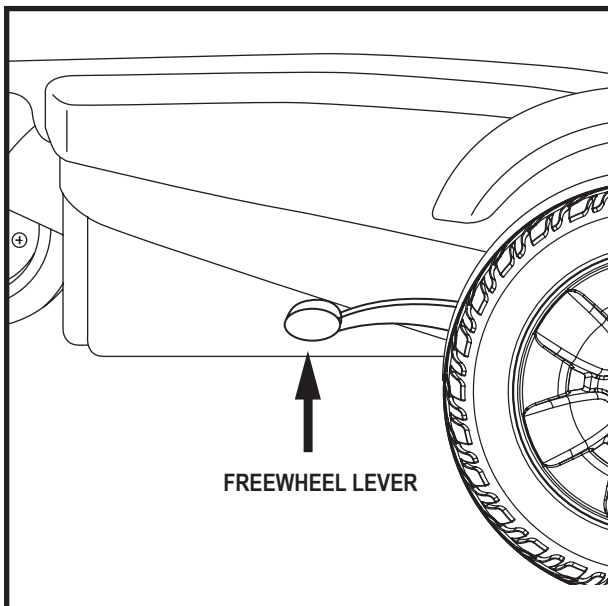

Figure 4. Drive Mode (Drive Engaged)

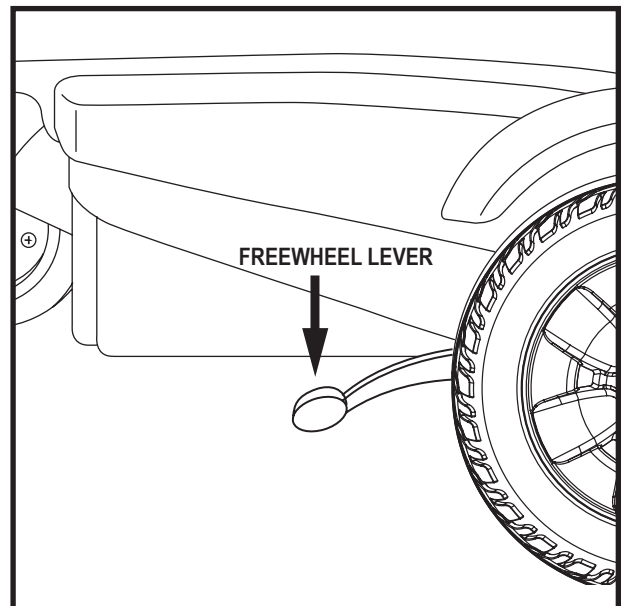

Figure 5. Freewheel Mode (Drive Disengaged)

IV. ASSEMBLY

INITIAL ASSEMBLY

Your power chair may require some assembly either before initial use or after transportation.

NOTE: Any nylon insert lock nut removed during the disassembly or adjustment of the power chair must be replaced with a new nylon insert lock nut. Nylon insert lock nuts should not be reused as it may cause damage to the nylon insert, resulting in a less secure fit. Replacement nylon insert lock nuts are available at local hardware stores or through your authorized Pride Provider.

Seat Installation

It may be necessary to install the seat either prior to initial operation or after transporting your power chair.



WARNING! Do not pick up the seat frame by the armrests. They are free to pivot, and you may lose control of the seat if they do so.

To install the seat:

1. Slide the seat down onto the power base. See figure 6.
2. Install the controller into one of the armrests. Tighten the setscrew with the supplied hex key. See figure 6.
3. Lift the armrest straight up, then route the controller harness and secure with wire ties as shown in figure 6.

NOTE: It is important that the armrest be lifted straight up prior to securing the controller harness with wire ties.



MANDATORY! Prevent controller harness damage! Avoid routing the controller harness on the outside of the armrest pad. Route the harness under the armrest or toward the inside of the armrest pad. Use correct tie-down points for the controller harness to prevent the harness from getting caught in the drive tires, pinched in the seat frame, or damaged when passing through doorways.

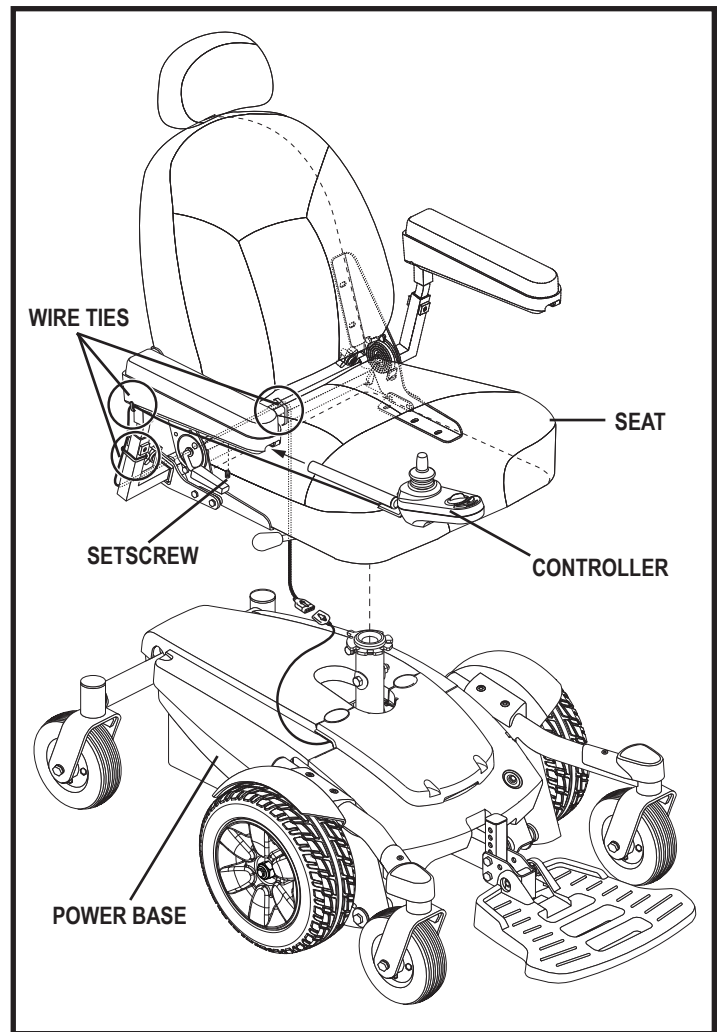

Figure 6. Seat and Controller Assembly

4. Plug the controller harness into the connector on the power base. See figure 3.

V. COMFORT ADJUSTMENTS

COMFORT ADJUSTMENTS

After becoming familiar with your power chair's operation, you may find the need to make some adjustments to increase your comfort, such as seat height, armrest angle, foot platform height and angle, and controller position. Refer to the following information before making comfort adjustments.

NOTE: *If your power chair is equipped with an optional seating system, please refer to the information provided in separate manuals.*

WARNING! The center of gravity of your power chair was factory set to a position that meets the needs of the demographic majority of users. Your authorized Pride Provider has evaluated your power chair and made any necessary adjustments to suit your specific requirements. Do not change your seating configuration without first contacting Pride Mobility Products or your authorized Pride Provider.



WARNING! Some power chair components are heavy. You may need assistance to lift or carry them. Please refer to the specifications table for specific component weights before you disassemble the power chair.

WARNING! Remove the occupant from the power chair before making any adjustments.

Seat Height Adjustment

You can change the seat height to one of three positions in 1-in. (2.5-cm) increments.

To change the seat height:

1. Turn off the power to the controller.
2. Ensure the power chair is in drive mode. See figure 4.
3. Disconnect the controller connector from the power base. See figure 7.
4. Disengage the seat release lever. See figure 7.
5. While holding the lever, swivel the seat left or right and then pull it up and off of the power base.
6. Loosen the hardware at the rear of the seat post. See figure 7.
7. Remove the seat height adjustment bolt, washers, and nut from the seat post. See figure 7.
8. Raise or lower the seat post to the desired position.
9. Reinstall the seat height adjustment hardware to the seat post.
10. Tighten the hardware at the rear of the seat post.
11. Reinstall the seat.
12. Reconnect the controller to the power base.

NOTE: *To rotate the seat, use the seat release lever located under the seat.*

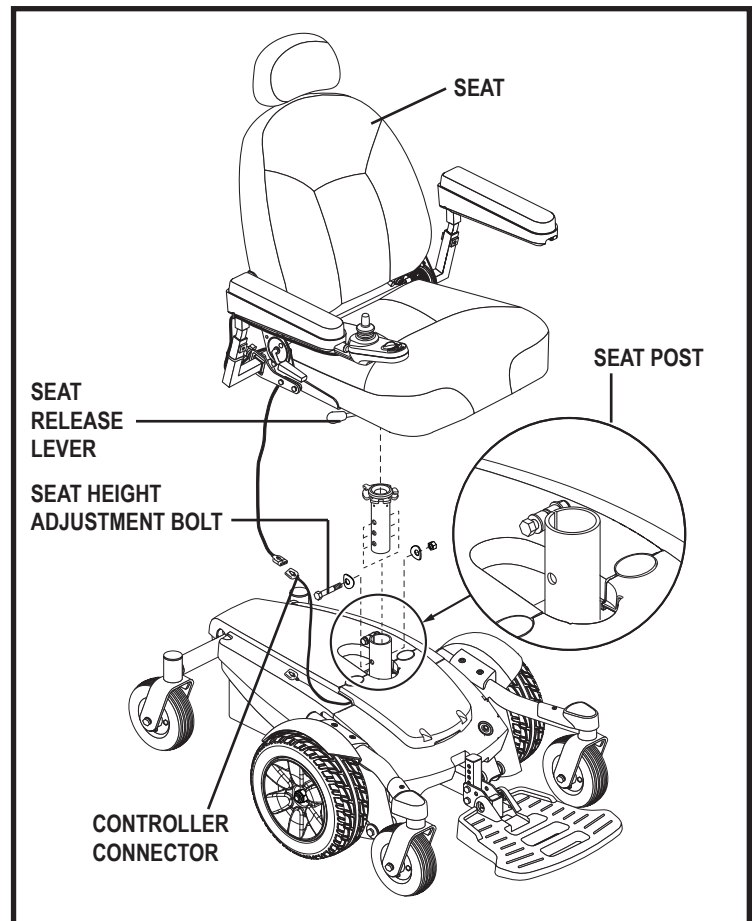

Figure 7. Seat Height Adjustment

V. COMFORT ADJUSTMENTS

NOTE: The most common configuration of the seat adjustment hardware is shown in figure 8. Your product may be equipped with a different configuration. All configurations operate in a similar manner.

Manual Recline Seatback Adjustment

If your power chair is equipped with a manual recline seatback, you can adjust the seatback angle with the seatback release lever. The lever is located on the right side of the seat base. See figure 7.

To adjust the recline angle:

1. Pull up on the seatback release lever.
2. Lean forward or backward to the desired position.
3. Release the lever.

Seatback Angle Adjustment

If your power chair is equipped with a limited-recline seatback, you can adjust it to four (4) different angles: 90°, 102°, 105°, or 107°.

To adjust the seatback angle:

1. Remove the adjusting screws from each seat hinge. See figure 8.
2. Set the seatback at the desired angle.
3. Reinstall the adjusting screws to each seat hinge and tighten.

Armrest Width Adjustment

You can change each armrest's width independently of the other.

NOTE: Changing the armrest width may increase the overall width of your power chair.

To change the armrest width:

1. Locate the adjustment hardware on each side of the armrest receiver bracket. See figure 8.
2. Loosen the adjustment hardware.
3. Slide the armrests in or out to the desired width.
4. Tighten the adjustment hardware.

Armrest Angle Adjustment

To change the armrest angle:

1. Lift the armrest straight up so that it is perpendicular to the floor.
2. Loosen the jam nut. See figure 8.
3. Turn the adjusting screw to raise or lower the front of the armrest.
4. Tighten the jam nut to lock the adjusting screw into place.

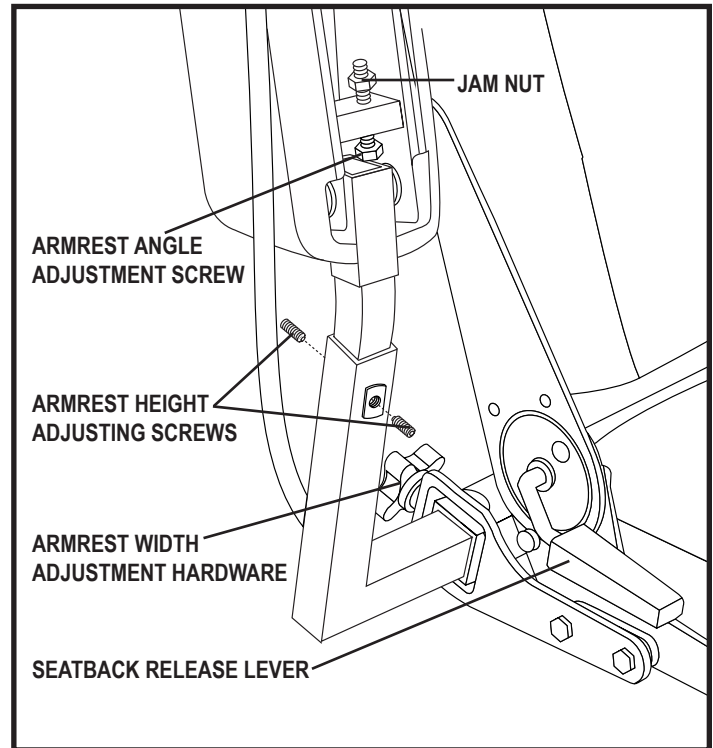

Figure 8. Armrest and Seatback Adjustments

V. COMFORT ADJUSTMENTS

Armrest Height Adjustment

To change the armrest height:

1. Loosen the setscrews on the armrest. See figure 8.
2. Raise or lower the armrest to the desired height.
3. Tighten the setscrews to secure the armrest.

Controller Position

You can move the controller in toward or out away from the armrest, or change the position of the controller for either left-hand or right-hand use.



WARNING! Do not place the controller harness so that it can be pinched in the seat frame or the power base frame.

To extend the controller:

1. Flip up the armrest so it is perpendicular to the floor.
2. Loosen the setscrew on the controller bracket. See figure 9.
3. Slide the controller into or out of the armrest to the desired position.
4. Tighten the setscrew to secure the controller.

To change the controller position:

1. Turn off the power to the controller.
2. Unplug the controller harness from the power base.
3. Cut the wire tie(s) that secure the controller harness to the armrest and seat.
4. Flip up the armrests.
5. Loosen the setscrew on the underside of each armrest. See figure 9.
6. Slide the controller out of the armrest.
7. Place the controller into the other armrest.
8. Tighten the setscrew to secure the controller.
9. Route the controller harness along the seat frame and secure with wire ties. See figure 6.
10. Plug the controller into the power base. See figure 3.

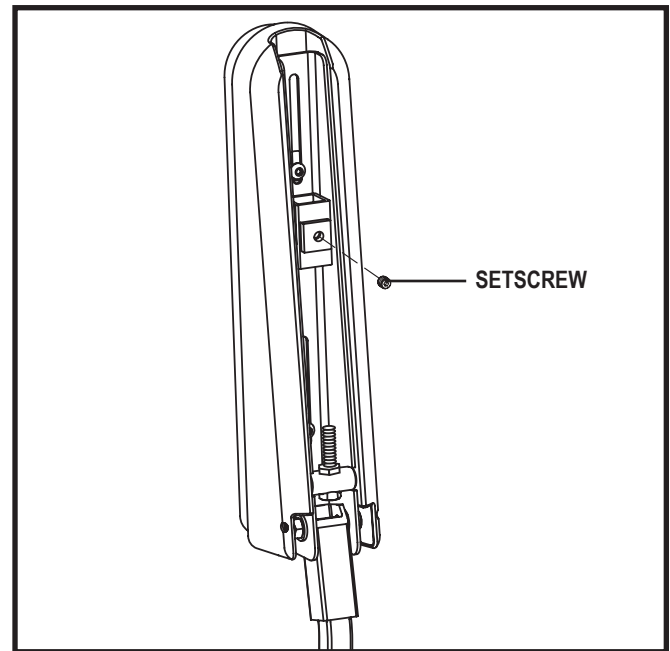

Figure 9. Underside of Armrest

V. COMFORT ADJUSTMENTS

Foot Platform Height Adjustment

The foot platform height is easily adjusted to different heights in 0.5-in. (1.27-cm) increments.

To raise or lower the foot platform:

1. Remove the hardware from the foot platform bracket. **See figure 10.**
2. Raise or lower the foot platform to the desired height.
3. Reinstall the hardware into the foot platform bracket and tighten.

Foot Platform Depth Adjustment

To adjust the foot platform depth:

1. Remove the hardware from the foot platform bracket. **See figure 10.**
2. Move the foot platform in or out to the desired depth.
3. Reinstall the hardware into the foot platform bracket and tighten.

Foot Platform Angle Adjustment

You can adjust the angle of the foot platform. **See figure 10.**

To adjust the foot platform angle:

1. Flip up the foot platform and locate the adjustment screw.
2. Turn the adjustment screw to raise or lower the front of the foot platform.

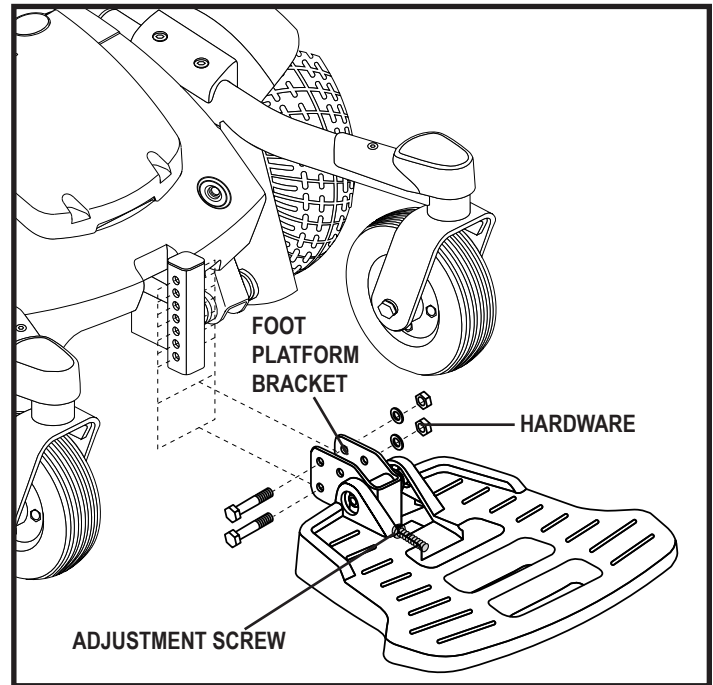

Figure 10. Seat Foot Platform Adjustment

V. COMFORT ADJUSTMENTS

Swing-away Footrests

Swing-away Footrests (SFRs) enable you to rotate the footrests to the side before you transfer onto or off of your power chair. See figure 11.

To rotate the SFRs:

1. Push in the release lever.
2. Rotate the SFRs.

To adjust the SFR length:

1. Remove the adjustment screws from the footrest extension.
2. Slide the footrest up or down to the desired length.
3. Reinstall the two adjustment screws.

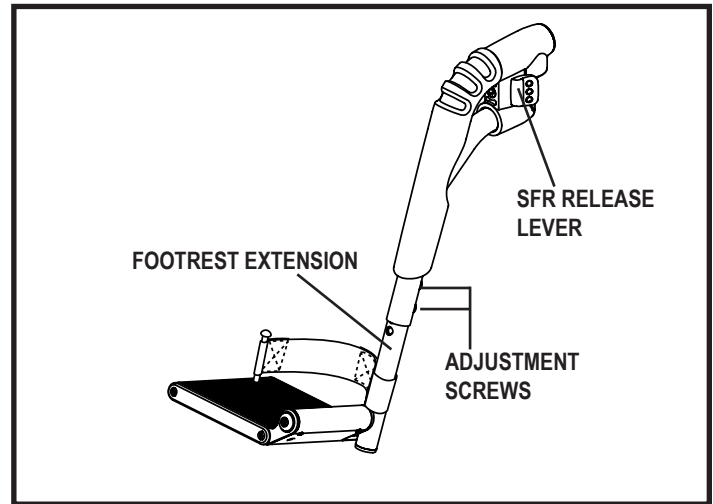

Figure 11. Swing-Away Footrests

Elevating Leg Rests

Elevating Leg Rests (ELRs) offer an infinite range of adjustment for the leg angle and a footrest adjustment range of 12-19 in. (30.48-48.26 cm). See figure 12.

To rotate the ELRs:

1. Push in release lever A.
2. Rotate the ELRs.

To adjust the ELR angle:

1. Push down release lever B.
2. Move the leg rest to the desired angle.

To adjust the ELR length:

1. Remove the two adjustment screws from the side of each leg rest extension.
2. Slide the leg rest up or down to the desired length.
3. Reinstall the two adjustment screws.

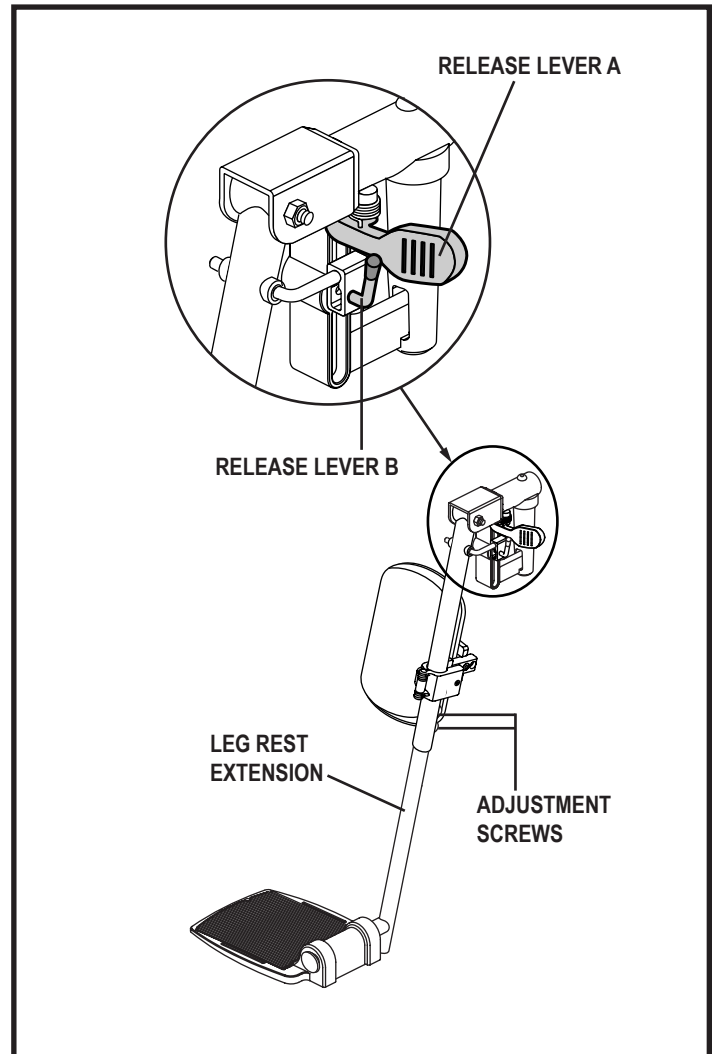

Figure 12. Elevating Leg Rests

V. COMFORT ADJUSTMENTS

Positioning Belt

Your power chair may be equipped with a positioning belt that can be adjusted for operator comfort. See **figure 13**. The positioning belt is designed to support the operator so that he/she does not slide down or forward in the seat. The positioning belt is not designed for use as a restraining device.



WARNING! The positioning belt is not designed for use as a seat belt in a motor vehicle. Anyone traveling in a vehicle should be properly belted into seats approved by the vehicle manufacturer. Your power chair is not suitable for use as a seat in any vehicle with the following exception: The vehicle must be equipped with a Wheelchair Tie-down and Occupant Restraint System (WTORS) that has been installed in accordance with the tie-down manufacturer's instructions, and is compliant with ANSI/RESNA WC/Vol. 4, Section 18/ISO 10542 standards, and the power chair must have a transit securement system conforming to ANSI/RESNA WC/Vol. 4, Section 19/ISO 7176-19 standards. It is essential to use a complete WTORS to secure the power chair to the vehicle and to provide the power chair occupant with a properly designed and tested safety restraint system. A restraint system with both pelvic and upper-torso belts must be used to protect the power chair occupant and minimize the likelihood of injury caused by contact with the vehicle during a crash or sudden braking.

WARNING! The positioning belt should be secured at all times. Never allow the positioning belt to hang or drag on the floor as it may become entangled.

To install the positioning belt:

1. Remove the rearmost screw that holds the seat hinge to the seat base on both the left and right seat hinges.
2. Insert the screw through the supplied washer, through the positioning belt, and into the seat base for each side of the power chair seat.
3. Tighten both screws.

To adjust the positioning belt for operator comfort:

1. Once seated, insert the metal tab on one side of the belt into the plastic housing on the opposite side until you hear a click. See **figure 13**.
2. Pull the excess strap attached to the metal tab until it is secure, but not so tight as to cause discomfort.

To release the positioning belt:

1. Press the push button mechanism on the plastic housing.



MANDATORY! Make sure the positioning belt is properly secured to the power chair and is adjusted for operator comfort before each use.

MANDATORY! Inspect the positioning belt for loose parts or damage, including tears, worn spots, bent hardware, damaged latch mechanisms, dirt or debris, before each use of the power chair. If you discover a problem, contact your authorized Pride Provider for maintenance and repair.

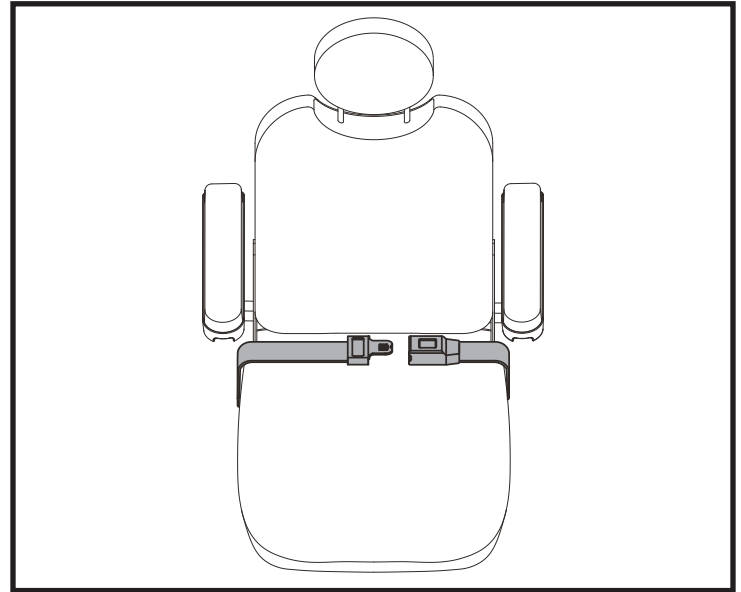

Figure 13. Positioning Belt Adjustment

VI. BATTERIES AND CHARGING

BATTERIES AND CHARGING

Your power chair uses two long-lasting, 12-volt, deep-cycle batteries. These batteries are sealed and maintenance free. Since they are sealed, there is no need to check the electrolyte (fluid) level. Deep-cycle batteries are designed to handle a longer and deeper discharge. Though they are similar in appearance to automotive batteries, they are not interchangeable. Automotive batteries are not designed to handle a long, deep discharge, and also are unsafe for use in power chairs.



MANDATORY! Battery posts, terminals, and related accessories contain lead and lead compounds. Wear goggles and gloves when handling batteries and wash hands after handling.



PROHIBITED! Always use two batteries of the exact same type, chemistry, and amp-hour (Ah) capacity. Refer to the specifications table in this manual and in the manual supplied with the battery charger for recommended type and capacities.



WARNING! Contact your authorized Pride Provider if you have any questions regarding the batteries in your power chair.

Charging the Batteries

The battery charger is essential in providing long life for your power chair batteries. It is designed to optimize your power chair's performance by charging the batteries safely, quickly, and easily. The battery charger is only functional when the charger power cord is plugged into an electrical outlet.



PROHIBITED! Removal of grounding prong can create electrical hazard. If necessary, properly install an approved 3-pronged adapter to an electrical outlet having 2-pronged plug access.



PROHIBITED! Never use an extension cord to plug in your battery charger. Plug the charger directly into a properly wired standard electrical outlet.



PROHIBITED! Do not allow unsupervised children to play near the power chair while the batteries are charging. Pride recommends that you do not charge the batteries while the power chair is occupied.



MANDATORY! Read the battery charging instructions in this manual and in the manual supplied with the battery charger before charging the batteries.



WARNING! Explosive gases may be generated while charging the batteries. Keep the power chair and battery charger away from sources of ignition such as flames or sparks and provide adequate ventilation when charging the batteries.

WARNING! You must recharge your power chair's batteries with the supplied off-board battery charger. Do not use an automotive-type battery charger.

WARNING! Inspect the battery charger, wiring, and connectors for damage before each use. Contact your authorized Pride Provider if damage is found.



WARNING! Do not attempt to open the battery charger case. If the battery charger does not appear to be working correctly, contact your authorized Pride Provider.

WARNING! Be aware that the battery charger case may become hot during charging. Avoid skin contact and do not place on surfaces that may be affected by heat.

WARNING! If the battery charger is equipped with cooling slots, then do not attempt to insert objects through these slots.



WARNING! If your battery charger has not been tested and approved for outdoor use, then do not expose it to adverse or extreme weather conditions. If the battery charger is exposed to adverse or extreme weather conditions, then it must be allowed to adjust to the difference in environmental conditions before use indoors.

VI. BATTERIES AND CHARGING

To charge the batteries using the off-board charger:

1. Position the front of your power chair next to a standard electrical outlet.
2. Be certain the controller power is turned off and the freewheel levers are in the engaged position. See III. “Your Power Chair.”
3. Plug the off-board charger into the off-board charger/programming socket on the controller. See figure 14.
4. Plug the off-board charger into the electrical outlet.



WARNING! The LED lights on the charger indicate different charger conditions at various times: charger power on, charging in progress, and charging complete. Refer to the manual supplied with the charger for a complete explanation of these indicators.

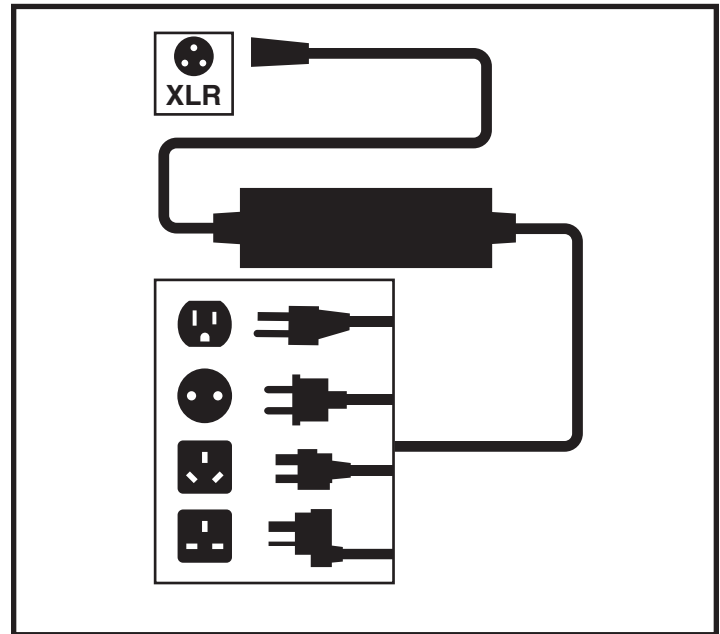

Figure 14. Battery Charging

5. When the batteries are fully charged, unplug the off-board charger from the electrical outlet and then from the controller.

Battery Break-in

To break in new batteries for maximum efficiency:

1. Fully recharge any new battery prior to its initial use. This brings the battery up to about 90% of its peak performance level.
2. Operate your power chair throughout the house and yard. Move slowly at first, and do not travel too far until you become accustomed to the controls and break in the batteries.
3. Give the batteries another full charge of 8 to 14 hours and operate your power chair again. The batteries will now perform at over 90% of their potential.
4. After four or five charging cycles, the batteries will top off at 100% charge and last for an extended period.

Frequently Asked Questions (FAQs)

How does the charger work?

The battery charger takes the standard electrical outlet voltage (alternating current) and converts it to 24V DC (direct current). The power chair batteries use direct current to run your power chair. When the battery voltage is low, the charger works harder to charge the battery. As the battery voltage approaches full charge, the charger doesn't work as hard to complete the charging cycle. When the battery is fully charged, the amperage from the charger is nearly at zero. This is how the charger maintains a charge but does not overcharge the battery.

Can I use a different battery charger?

You should use the charger supplied with the power chair. It is the safest, most efficient tool to charge the batteries. We do not recommend using other types of chargers (e.g., an automotive battery charger).

NOTE: Your power chair's charger will not operate after the batteries have been discharged to nearly zero voltage. If this happens, call your authorized Pride Provider for assistance.

VI. BATTERIES AND CHARGING

How often must I charge the batteries?

Many factors come into play when deciding how often to charge the batteries. You may use your power chair all day on a daily basis or you may not use it for weeks at a time.

■ Daily Use

If you use your power chair on a daily basis, charge the batteries as soon as you are finished using your power chair. Your power chair will be ready each morning to give you a full day's service. It is recommended that you charge the batteries at least 8 to 14 hours after daily use. Pride recommends that you charge the batteries for an additional 4 hours after the battery charger indicates the charging is complete.

■ Infrequent Use

If you use your power chair infrequently (once a week or less), you should charge the batteries at least once per week for at least 24 hours.

NOTE: *Your power chair may be equipped with a battery charge reminder feature. If your power chair is driven for 8 hours or more, powered off and not charged, then the charge reminder feature becomes activated when the power chair is powered back on.*

The charge reminder is displayed when the power chair is powered off again. The left red LED on the battery condition meter will flash 4 times in 0.5-second intervals. This will happen every time the power chair is powered off until the charge reminder is reset by charging the batteries.

NOTE: *Keep your batteries fully charged and avoid deeply discharging your batteries. Refer to the manual supplied with the battery charger for charging instructions. Pride recommends charging your batteries for at least 48 continuous hours once a month to improve battery performance and battery life.*

How can I get maximum range or distance per charge?

Rarely do you have an ideal driving situation such as smooth, flat, hard terrain with no wind, hills, or curves. More often you are presented with hills, sidewalk cracks, uneven and loosely packed surfaces, curves, and wind. All of these factors will affect the distance or running time per battery charge. Below are a few suggestions for obtaining the maximum range per charge:

- Always charge the batteries fully prior to your trip.
- Plan your trip in advance to avoid inclines if possible.
- Limit baggage weight to essential items.
- Try to maintain an even speed and avoid stop-and-go driving.
- Pride recommends charging your batteries for at least 48 continuous hours once per month to improve battery performance and battery life.

What type of batteries should I use?

We recommend deep-cycle batteries that are sealed and maintenance free. Both AGM and Gel-Cell are deep-cycle batteries that are similar in performance.



WARNING! Corrosive chemicals contained in batteries. Use only AGM or Gel-Cell batteries to reduce the risk of leakage or explosive conditions.

Why do my new batteries seem weak?

Deep-cycle batteries employ a much different chemical technology than that used in car batteries, nickel-cadmium (nicads), or in other common battery types. Deep-cycle batteries are specifically designed to provide power, drain down their charge, and then accept a relatively quick recharge. AGM and Gel-Cell batteries should be charged as often as possible. They do not have a “memory” like nickel-cadmium batteries.

VI. BATTERIES AND CHARGING

We work closely with our battery manufacturer to provide a battery that best suits your power chair's specific demands. Fresh batteries arrive regularly at Pride and are promptly shipped with a full charge. During shipping, the batteries encounter temperature extremes that may influence initial performance. Heat robs the charge from the battery, and cold slows the power available and extends the time needed to recharge the battery (just as with a car battery).

It might take a few days for the temperature of the battery to stabilize and adjust to its new ambient temperature. More importantly, it will take a few "charging cycles" (a partial drain — then a full recharge) to establish the critical chemical balance that is essential to the battery's peak performance and long life. It will be well worth it to take the time to break in your battery properly.

How can I ensure maximum battery life?

A fully charged deep-cycle battery will provide reliable performance and extended battery life. Keep your power chair's batteries fully charged whenever possible. Batteries that are regularly and deeply discharged, infrequently charged, or stored without a full charge may be permanently damaged, causing unreliable power chair operation and limited battery life.

***NOTE:** The useful life of a battery is quite often a reflection of the care it receives.*

How should I store my power chair and its batteries?

If you do not use your power chair regularly, we recommend maintaining battery vitality by charging the batteries at least once per week.

If you do not plan on using your power chair for an extended period, fully charge the batteries prior to storage. Disconnect the battery harnesses and store the power chair in a warm, dry environment. Avoid temperature extremes, such as freezing and excessively hot conditions, and never attempt to charge a frozen battery. A cold or frozen battery should be warmed for several days prior to recharging.

What about public transportation?

AGM and Gel-Cell batteries are designed for application in power chairs and other mobility vehicles. These batteries are Federal Aviation Administration (FAA) approved, allowing safe transportation on aircraft, buses, and trains, as there is no danger of spillage or leakage. We suggest you contact the carrier's ticket counter in advance to determine that carrier's specific requirements.

What about shipping?

If you wish to use a freight company to ship your power chair to your final destination, repack your power chair in the original shipping container, if possible, and ship the batteries in separate boxes.

VII. CARE AND MAINTENANCE

CARE AND MAINTENANCE

Your Jazzy® is a sophisticated power chair. Like any motorized vehicle, it requires routine maintenance checks. You can perform some of these checks, but others require assistance from your authorized Pride Provider. Preventive maintenance is very important. If you follow the maintenance checks in this section as scheduled, you can help ensure that your power chair gives you years of trouble-free operation. If you have any doubt as to your power chair's care or operation, contact your authorized Pride Provider.



WARNING! Do not service the power chair when the seat is occupied.

Your power chair, like most electrical equipment, is susceptible to damage from the elements. Avoid damp areas of any kind.



WARNING! Direct or prolonged exposure to water or dampness could cause the power chair to malfunction electronically and mechanically. Water can cause electrical components to corrode and the chair's frame to rust. Power chairs should be examined periodically for signs of corrosion caused by water exposure, bodily fluids exposure, or incontinence. Damaged components should be replaced or treated immediately.

Should your power chair come in contact with water:

1. Dry your power chair as thoroughly as possible with a towel.
2. Allow your power chair to sit in a warm, dry place for 12 hours to allow unseen water to evaporate.
3. Check the joystick operation and the brakes before using your power chair again.
4. If any inconsistencies are found, take your power chair to your authorized Pride Provider. Power chairs that are frequently exposed to sources of water, such as incontinence, should be inspected often for corrosion and electronic components may need to be replaced frequently.

Temperature

- Some of the parts of your power chair are susceptible to extreme changes in temperature. Always keep your power chair between the temperatures of -8°C (18°F) and 50°C (122°F).
- In extremely cold temperatures the batteries may freeze. The specific temperature at which they freeze depends on a number of factors, such as battery charge, usage, and composition of the batteries (e.g., AGM or Gel-Cell).
- Temperatures above 50°C (122°F) may cause your power chair to operate at a reduced speed. This reduced speed is a safety feature built into the controller that helps prevent damage to the motor and other electrical components.

General Guidelines

- Avoid knocking or bumping the controller, especially the joystick.
- Avoid prolonged exposure of your power chair to extreme conditions, such as heat, cold, or moisture.
- Keep the controller clean.
- Check all connectors to ensure that they are all tight and secured properly.
- Make sure pneumatic tires are inflated to the psi/bar/kPa air pressure rating indicated on the tire.



WARNING! Make sure your tires are inflated to the psi/bar/kPa air pressure rating indicated on the tire for pneumatic tires. Do not underinflate or overinflate your tires. Low pressure may result in loss of control, and overinflated tires may burst. Overinflating tires can cause them to explode.

WARNING! Do not use a high pressure hose to inflate your tires.

- Use a rubber conditioner on the tire sidewalls to help preserve them.



WARNING! Never use a rubber conditioner on the tread area of the tires; doing so may make the tires slippery and cause your power chair to skid.

VII. CARE AND MAINTENANCE

- All wheel bearings are prelubricated and sealed. They require no subsequent lubrication.
- If your power chair has a body shroud with a **glossy finish**, the body shroud has been sprayed with a clear sealant coating. You can apply a light coat of car wax to help it retain its high-gloss appearance. If your power chair has a body shroud with a **matte finish**, use **ONLY** products developed for matte-finish paint. Do not use wax, detail spray, ArmorAll®, or any product made for glossy paint.



WARNING! Carefully choose the correct product to protect the finish of your power chair's shroud(s). ONLY products developed for matte-finish paint should be used on shrouds with a matte finish. Failure to follow this warning may result in damage to the shroud's matte paint finish.

- Check all electrical connections. Make sure they are tight and are not corroded. Batteries must sit flat within the battery well frame with the battery terminals facing inward toward each other. Refer to the battery wiring label for the correct wiring layout.



WARNING! Even though the power chair has passed the necessary testing requirements for ingress of liquids, you should keep electrical connections away from sources of dampness, including direct exposure to water or bodily fluids and incontinence. Check electrical components frequently for signs of corrosion and replace as necessary.

Daily Checks

- With the controller turned off, check the joystick. Make sure it is not bent or damaged and that it returns to the neutral position when you release it. Check the rubber boot around the base of the joystick for damage. Visually inspect the boot. Do not handle or try to repair it. See your authorized Pride Provider if there is a problem.
- Visually inspect the controller harness. Make sure that it is not frayed, cut, or has any wires exposed. See your authorized Pride Provider if there is a problem.
- Check for flat spots on solid tires. Flat spots could adversely affect stability.
- Inspect the seating system, armrests, and front riggings for loose hardware, stress points, or damage. See your authorized Pride Provider if there is a problem.

Weekly Checks

- Disconnect and inspect the controller harness and the charger harness from the power base. Look for corrosion. Contact your authorized Pride Provider if necessary.
- Ensure that all parts of the controller system are securely fastened to your power chair. Do not overtighten any screws.
- Check for proper tire inflation. Maintain but do not exceed the psi/bar/kPa air pressure rating indicated on each tire for pneumatic tires. If a tire does not hold air, see an authorized Pride Provider for replacement of the tube.
- Check the brakes. This test should be carried out on a level surface with at least 3 feet (1 meter) of clearance around your power chair.

To check the brakes:

1. Turn on the controller and turn down the speed level of your power chair.
2. After one second, check the battery condition meter. Make sure that it remains on.
3. Slowly push the joystick forward until you hear the electric brakes click. Immediately release the joystick. You must be able to hear each electrical brake operating within a few seconds of joystick movement. Repeat this test three times, pushing the joystick backward, then left, and then right.

VII. CARE AND MAINTENANCE

Monthly Checks

- Check for drive tire wear. See your authorized Pride Provider for repair.
- Check the caster wheels for wear. Replace them as necessary.
- Check the caster forks for damage or fluttering which indicates that they may need to be adjusted or have the bearings replaced. See your authorized Pride Provider for repair.
- Check the entire power chair for loose hardware and changes in the function or performance of the power chair. See your authorized Pride Provider for service or repair.
- Keep your power chair clean and free of foreign material, such as mud, dirt, hair, food, drink, etc.

Yearly Checks

Take your power chair to your authorized Pride Provider for yearly maintenance, especially if you use your power chair on a daily basis. This helps ensure that your power chair is functioning properly and helps prevent future complications.

Storage

Your power chair should be stored in a dry place, free from temperature extremes. When storing, disconnect the batteries from the power chair. See VI. "Batteries and Charging."



WARNING! If you fail to store the unit properly, the frame can rust and the electronics can be damaged.

Batteries that are regularly and deeply discharged, infrequently charged, stored in extreme temperatures, or stored without a full charge may be permanently damaged, causing unreliable performance and limited service life. It is recommended that you charge the batteries periodically throughout periods of prolonged storage to ensure proper performance.

You may wish to place several boards under the frame of your power chair to raise it off of the ground during periods of prolonged storage. This takes the weight off the tires and reduces the possibility of flat spots developing on the areas of the tires contacting the ground.

Disposal of Your Power Chair

Your power chair must be disposed of according to applicable local and national statutory regulations. Contact your local waste disposal agency or authorized Pride Provider for information on proper disposal of power chair packaging, metal frame components, plastic components, electronics, batteries, neoprene, silicone, and polyurethane materials.

Cleaning and Disinfection

- Use a damp cloth and mild, non-abrasive cleanser to clean the plastic and metal parts of your power chair. Avoid using products that may scratch the surface of your power chair.
- If necessary, clean your product with an approved disinfectant. Make sure the disinfectant is safe for use on your product before application.

WARNING! Follow all safety instructions for the proper use of the disinfectant and/or cleaning agent before applying it to your product. Failure to comply may result in skin irritation or premature deterioration of upholstery and/or power chair finishes.



WARNING! Never hose off your power chair or place it in direct contact with water. Your power chair has a painted, ABS plastic body shroud that allows it to be easily wiped clean with a damp cloth.

WARNING! Never use any chemicals to clean a vinyl seat, as they may cause the seat to become slippery or dry out and crack. Use soapy water and dry the seat thoroughly.

VII. CARE AND MAINTENANCE

Wheel Replacement

If you have pneumatic tires and you have a flat tire, replace the tube. If your chair is equipped with a solid tire insert, then you must replace the whole wheel assembly. Replacement tires, tubes, and wheel assemblies are readily available through your authorized Pride Provider.

WARNING! The wheels on your power chair should only be serviced or replaced by an authorized Pride Provider or a qualified technician.



WARNING! Be sure that the power to the controller is turned off and the power chair is not in freewheel mode before performing this procedure.

WARNING! When changing a tire, remove only the center lug nut and washer, then remove the wheel. If any further disassembly is required, deflate the tire completely or it may explode.

Follow these easy steps for a quick and safe repair for both pneumatic and solid tires:

1. Turn off the power to the controller.
2. Make sure that the power chair is in drive mode. See figure 4.
3. Raise and support the power base so that the wheel is at least 1 in. (2.5 cm) off of the ground.
4. If you are changing a pneumatic tire, completely deflate it before removing the wheel.
5. Remove the hub cap, if equipped. See figure 15.
6. Remove the drive wheel nut and washer from the axle. See figure 15.
7. Remove the drive wheel from the axle. Make sure that you keep the key.
8. Remove the acorn nuts that fasten the two rim halves together.
9. Remove the old tube from the pneumatic tire and replace it with a new tube or replace the entire assembly if it is a solid tire.
10. Reassemble the two rim halves.
11. Slide the wheel back onto the axle. Make sure that the key is in the axle slot.

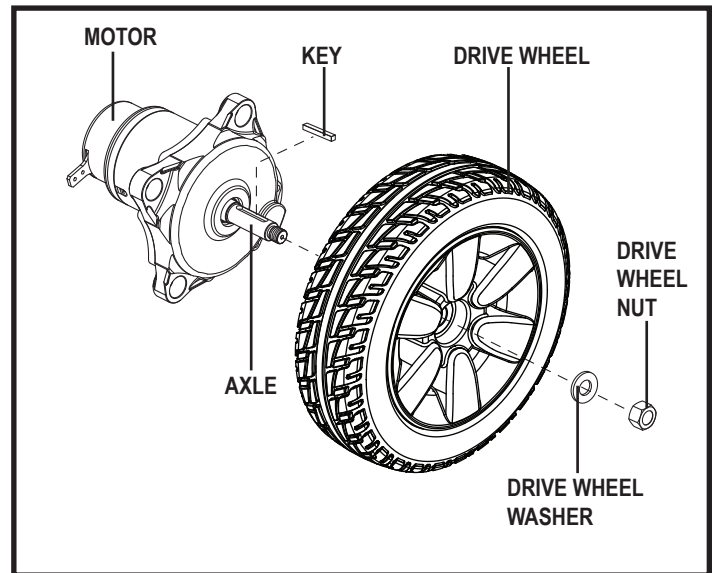

Figure 15. Jazzy Select 6 Drive Wheel Removal



WARNING! Failure to ensure that the axle key is properly installed into the axle slot when mounting the wheel can result in electronic brake failure, personal injury, and/or product damage.

12. Reinstall the drive wheel nut and washer onto the axle and tighten. See figure 15.



WARNING! Make sure both the nut and washer are reinstalled and tightened properly.

13. Reinstall the hub cap, if equipped.
14. Inflate the pneumatic tire to the psi/bar/kPa air pressure rating indicated on each tire.
15. Remove the power chair from the base support.

VII. CARE AND MAINTENANCE

Battery Replacement

A battery wiring diagram is printed on a decal located on the power base. See VI. "Batteries and Charging" for correct battery specifications.



MANDATORY! Battery posts, terminals, and related accessories contain lead and lead compounds. Wear goggles and gloves when handling batteries and wash hands after handling.

WARNING! The batteries in your power chair should only be serviced or replaced by an authorized Pride Provider or a qualified technician.

WARNING! Do not replace batteries when seat is occupied.



WARNING! Power chair batteries are heavy. See specifications table. If you are unable to lift that much weight, be sure to get help. Use proper lifting techniques and avoid lifting beyond your capacity.

WARNING! Do not mix old and new batteries. Always replace both batteries at the same time.



PROHIBITED! Keep tools and other metal objects away from the battery terminals. Contact with tools can cause electrical shock.

You may need the following to replace your batteries:

- metric/standard socket set and ratchet
- adjustable wrench

To replace the batteries:

1. Turn off power to the controller.
2. Make sure that the power chair is in drive mode. See figure 4.
3. Remove the rear shroud. See figure 16.
4. Loosen the yellow thumbscrews and remove the side cover.
5. Disconnect the rear battery harness from the power base. See figure 16.
6. Slide the rear battery out of the power base.
7. Slide the front battery rearward.
8. Disconnect the front battery harness from the power base. See figure 16.
9. Slide the front battery out of the power base.
10. Remove the battery harnesses from the old batteries and install them onto the new batteries. Make sure that the hardware is facing the correct direction. See figure 16.



WARNING! Make sure you tighten the fasteners so that the connections are secure.

11. Place the front battery into the power base. Make sure that the terminals are facing the front of the power base. See figure 16.
12. Connect the front battery harness to the power base.
13. Slide the front battery forward.
14. Place the rear battery onto the power base. Make sure that the terminals are facing the front of the power base. See figure 16.
15. Connect the rear battery harness to the power base.
16. Reinstall the side cover.
17. Reinstall the rear shroud.

NOTE: When installing the rear shroud, make sure that the controller and power seat harnesses are routed through the notch in the right side of the front cover.

18. Change the batteries. See VI. "Batteries and Charging."

VII. CARE AND MAINTENANCE

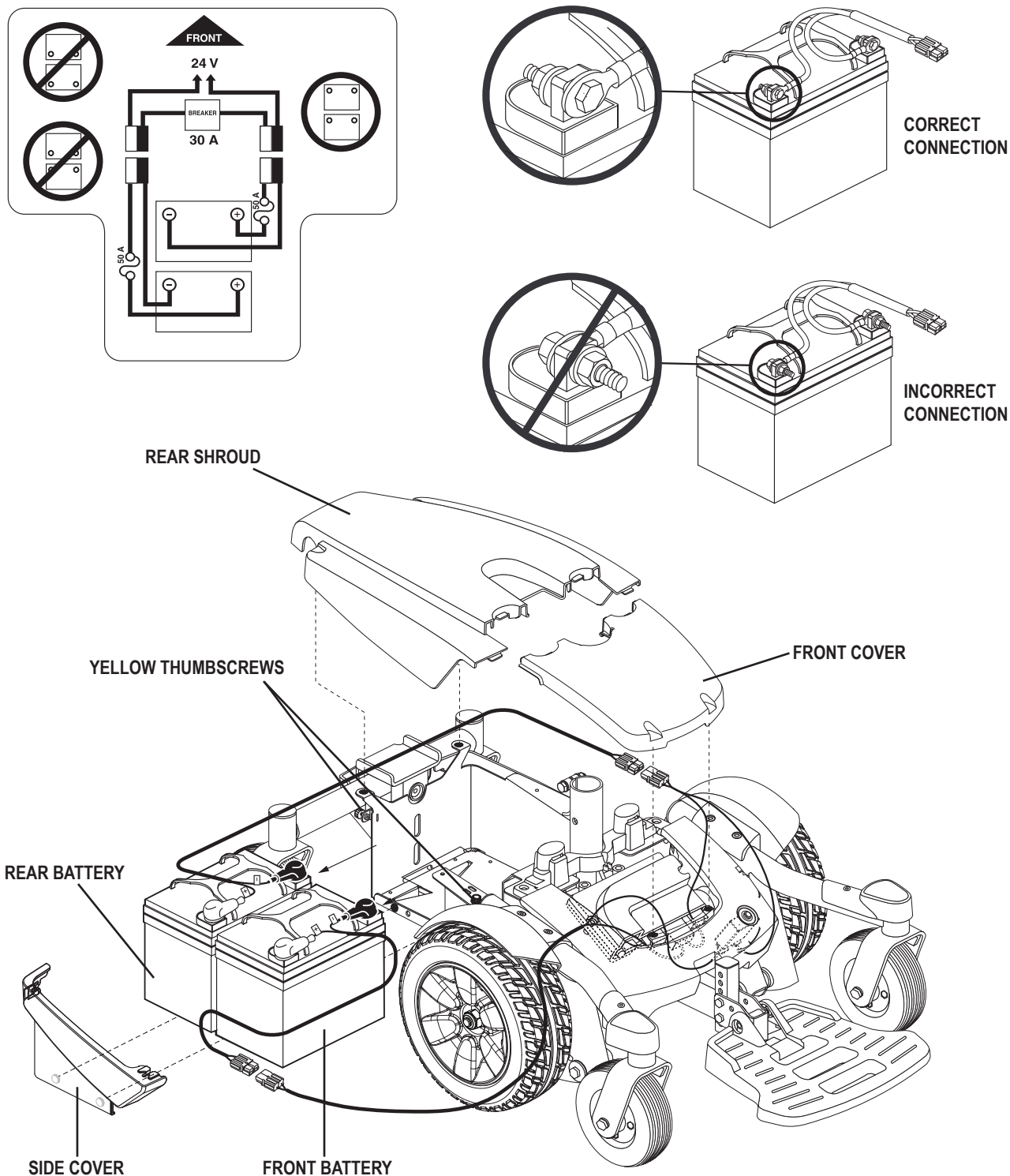

Figure 16. Battery Installation (Seat Removed for Clarity)

VII. CARE AND MAINTENANCE

When to See Your Authorized Pride Provider for Service

The following symptoms could indicate a serious problem with your power chair. If necessary, contact your authorized Pride Provider. When calling, have the model number, serial number, nature of the problem, and the error code if available.

- Motor noise
- Frayed harnesses
- Cracked or broken connectors
- Uneven wear on any of the tires
- Jerky motion
- Pulling to one side
- Bent or broken wheel assemblies
- Does not power up
- Powers up, but does not move
- Loose seat or seating components

Corrective Maintenance

If the battery condition meter does not light up when you turn on the power:

- Check the harness connections. Make sure they are tight.
- Check the circuit breaker. Reset it if necessary.
- Check the battery connections.

If the above conditions prove normal, you can load test the batteries with a battery load tester. These testers are available at automotive parts stores. Disconnect both batteries before load testing and follow the directions that come with the load tester. If either one of the batteries fails the load test, replace both of them. If your power chair still does not power up, contact your authorized Pride Provider.

VIII. OTHER INSTRUCTIONS

Recommendation: Use parts approved by our company.

Scope of application: It is used for short-distance travel for the disabled and the elderly and infirm with mobility difficulties.

The manufacturer can provide maintenance technical information to the approved maintenance organization.

Production Date:

Product validity period: 5 years

The accessories and wastes of electric wheelchairs are not allowed to be discarded at will. Please refer to page 25 for specific treatment methods.

The charger should meet the requirements of "GB 9706.1-2007"

The external dimensions of the electric wheelchair should meet the requirements of Table 1

Table 1 Dimensions of electric wheelchairs (unit: mm)

Item	Outdoor Type
Total Length L	1080
Overall Width B	620
Total Height H	1022

The total mass of the electric wheelchair should be 68kg, with an error of $\pm 10\%$.

The performance requirements of electric wheelchairs should meet the requirements of Table 2

Table 2 Performance requirements for electric wheelchairs

Project Description		Standard Requirement
		Outdoor type
Maximum Speed		$\leq 6\text{km/h}$
Driving Braking Performance	Horizontal Road Braking	$\leq 1.5\text{m}$
	Maximum Safe Slope Braking	$\leq 3.6\text{m}(6^\circ)$
Standing Performance		9°
Static Stability		$\geq 9^\circ$
Dynamic Stability		$\geq 6^\circ$
Obstacle Height		$\geq 40\text{mm}$
Obstacle Height		100mm
Gradeability		$\geq 6^\circ$
Minimum Turning Radius		1200mm
Theoretical Driving Distance		$\geq 20\text{km}$

VIII. OTHER INSTRUCTIONS

The basic parameters and electrical parameters are shown in Table 3 and Table 4:

Table 3 Basic parameters

Numbering	Project		Model	Tolerance Scope
			Jazzy Select 6	
1	Total Length/mm		1080	±10%
2	Total Width/mm		620	
3	Total Height/mm		1022	
4	Seat Width/mm		460	
5	Seat Height Above Ground (front)/mm		457	
6	Armrest Height/mm		102	
7	Backrest Height/mm		508	
8	Mass/kg		67	
9	Maximum User Mass/kg		100	
10	Front and Rear tires /mm	Drive Wheel Diameter	254	
		Steering Wheel Diameter	153	

Table 4 Electrical parameters

Components	Project	Model
		Jazzy Select 6
Electric motor	Rated voltage/V	24
	Rated power/W	80
Battery	Rated capacity/Ah	33
	Rated voltage/V	12
	Equipped with quantity/piece	2
Charger	Power/V, Hz	100-240V,50-60Hz
	Maximum output current/A	3.5
Controller	Maximum output current/A	40

VIII. OTHER INSTRUCTIONS

Appendix A Security Features

- A.1.1 Classified by type of protection against electric shock: internal power supply
- A.1.2 Classification by degree of protection against electric shock: Type B applied part
- A.1.3 Classification according to the degree of protection against ingress of liquid: IPX4
- A.1.4 Press in the case of flammable anesthetic gas mixed with air or flammable anesthetic gas mixed with oxygen or nitrous oxide
- Classification of safety level when in use: non-AP/APG type.
- A.1.5 Classification by operation mode: continuous operation.
- A.1.6 Rated voltage: DC 24V.
- A.1.7 Application parts that do not have protection against defibrillation discharge effects
- A.1.9 has no signal output or input part.
- A.1.10 is non-permanent installation equipment.

Medical device registration certificate number: National Machinery Injection 20162562455

Product technical requirement number:

Manufacturer: PRIDE MOBILITY PRODUCTS CORP.

Manufacturer Address: 401 York Avenue, Duryea, PA 18642

Phone: 800-8008586-1381

Service agency in China: Prader Motor Products Trading (Shanghai) Co., Ltd.

China Service Agency Address: Room 508, Building 4, No. 500 Jianyun Road, Pudong New Area, Shanghai

Agent name: Prader Motor Products Trading (Shanghai) Co., Ltd.

Agent residence: Room 508, Building 4, No. 500 Jianyun Road, Pudong New Area, Shanghai

Agent contact information: +86-021-5192-3035

NOTES

NOTES

NOTES

PRIDE[®]

M O B I L I T Y

USA
401 York Avenue
Duryea, PA 18642
www.pridemobility.com

Canada
5096 South Service Road
Beamsville, Ontario L0R 1B3
www.pridemobility.com

Australia
20-24 Apollo Drive
Hallam, Victoria 3803
www.pridemobility.com.au

New Zealand
38 Lansford Crescent
Avondale, Auckland 0600
www.pridemobility.co.nz

UK
32 Wedgwood Road
Bicester, Oxfordshire OX26 4UL
www.pride-mobility.co.uk

Netherlands
(Authorised EU Representative)
De Zwaan 3
1601 MS Enkhuizen
www.pride-mobility.nl

Italy
Via del Progresso-ang. Via del Lavoro
Loc. Prato della Corte
00065 Fiano Romano (RM)
www.pride-italia.it

France
26 Rue Monseigneur Ancel
69800 Saint-Priest
www.pridemobility.fr

Spain
Calle Las Minas Número 67
Polígono Industrial Urtinsa II, de Alcorcón
28923 Madrid
www.pridemobility.es

Germany
Hövelrieger Str. 28
33161 Hövelhof
www.pridemobility.de

China
普拉德机动产品商贸（上海）有限公司
上海市浦东新区建韵路500号天纳商汇4幢508室

