



Stealth Products
BEYOND EXPECTATIONS

Quick Reference



Quick Release Mounting Hardware

For All Aluminum & Carbon Series Back Supports

Stealth Products strives for 100% customer satisfaction. Your complete satisfaction is important. Please contact us with feedback or suggested changes that will help improve the quality and usability of these products. You may reach us at:

104 John Kelly Drive, Burnet, TX 78611

Phone: (512) 715-9995 Toll Free: 1 (800) 965-9229

Fax: (512) 715-9954 Toll Free: 1 (800) 806-1225

info@stealthproducts.com www.stealthproducts.com

General

Read and understand all instructions prior to the use of the product. Failure to adhere to instructions and warnings in this document may result in property damage, injury, or death. Product misuse due to failure of the following instructions will void the warranty.

Immediately discontinue use if any function is compromised, parts are missing, loose, or shows signs of excessive wear. Consult with your supplier for repair, adjustment, or replacement.

If this document contains information you do not understand, or there are concerns about safety or operation, contact your supplier.

Important Information!

All persons responsible for fitting, adjustment, and daily use of the devices discussed in these instructions must be familiar with and understand all safety aspects of the devices mentioned. In order for our products to be used successfully, you must:

- Read and understand all instructions and warnings.
- Maintain our products according to our instructions on care and maintenance.
- Devices should be installed and adjusted by a trained technician.

Ordering Documentation

You can download additional copies of this User & Installation Manual on the Stealth website: www.stealthproducts.com

REF

P116D228R1

Document #228 Revision 1
Monday, November 23, 2015

Copyright © Stealth Products, LLC
All rights reserved.
Published by Stealth Products, LLC

Installation Date: _____

Dealer: _____

Dealer Stamp:

Serial Number:

For UK warranty claims, please contact:



MDSS GmbH
Schiffgraben 41
30175 Hannover, Germany



The ADI Backs are designed and produced to the highest of standards. Our ADI Back is guaranteed to be free of defects in material and workmanship for a period of 24 months. If any defect in material or workmanship is found, Stealth Products will repair or replace, at our discretion, the ADI Back. This warranty does not apply to backs abused or misused by the user and deemed such by Stealth Products, LLC.

Claims and repairs should be processed through the nearest Stealth Products Provider.

4.1 Warranty Exclusions

This warranty does not extend to those items which may require replacement due to normal wear and tear:

- Outer covers
- Inner covers
- Circumstances beyond the control of Stealth
- Labor, service calls, shipping, and other charges incurred for repair of the product, unless specifically authorized, IN ADVANCE, by Stealth Products, LLC.
- Repairs and/or modifications made to any part without specific consent from Stealth.

Exclusions also include components with damage caused by:

- Exposure to moisture



NOTICE

Any substitutions of supplied hardware void the warranty. Misuse of items and "acts of nature" (ex. Flood, tornado, etc.) are not covered by the warranty.

1.0 Customer Satisfaction.....	i
2.0 Important Information.....	ii
3.0 Introduction.....	iii
4.0 Warranty.....	iv
4.1 Warranty Exclusions.....	iv
5.0 Table of Contents.....	v
6.0 Warning Labels.....	vi
6.1 Warning Labels.....	vi
6.2 Limited Liability.....	vi
6.3 Testing.....	vi
7.0 Parts and Accessories.....	vii
7.1 Tools Required for Installation & Adjustment.....	vii
7.2 Parts Required.....	vii
8.0 Positioning.....	1
8.1 Torque Specification.....	1
9.0 Installation Instructions.....	2
9.1 Step 1.....	2
9.2 Step 2.....	3
9.3 Step 3.....	4
9.4 Step 4.....	5
9.5 Step 5.....	6
9.6 Step 6.....	7
10.0 First Time Use.....	8
10.1 Dealer Assistance.....	8
10.2 User Testing.....	8
10.3 Conditions of Use.....	8
11.0 Maintenance.....	9
11.1 Cleaning.....	9
11.2 Disinfection.....	9

6.1 Warning Labels

Warnings are included for the safety of the user, client, operator and property. Please read and understand what the signal words **SAFETY**, **NOTICE**, **CAUTION**, **WARNING** and **DANGER** mean, how they could affect the user, those around the user, and property.

 DANGER	Identifies an imminent situation which (if not avoided) will result in severe injury, death, and property damage .
 WARNING	Identifies a potential situation which (if not avoided) will result in severe injury, death, and property damage .
 CAUTION	Identifies a potential situation which (if not avoided) will result in minor to moderate injury, and property damage .
NOTICE	Identifies important information not related to injury, but possible property damage .
SAFETY	Indicates steps or instructions for safe practices, reminders of safe procedures, or important safety equipment that may be necessary.

6.2 Limited Liability

Stealth Products, LLC accepts no liability for personal injury or damage to property that may arise from the failure of the user or other persons to follow the recommendations, warnings, and instructions in this manual.

6.3 Testing

Initial setup and driving should be done in an open area free of obstacles until the user is fully capable of driving safely.

The product should always be tested without any person sitting in the wheelchair until every alteration of the physical installation or adjustment is complete.

7.1 Tools Required for Installation & Adjustment

- 4mm allen wrench
- 10mm wrench

7.2 Parts Required

- Back Support Shell, 1 each (A)
- U-Block Assembly, 2 each, attached to back (BR1104)(B)
- Quick Release Back Post Clamp, 2 each (BR1100)(C)
- Quick Release Latch Assembly, 2 each (BR1101)(D)

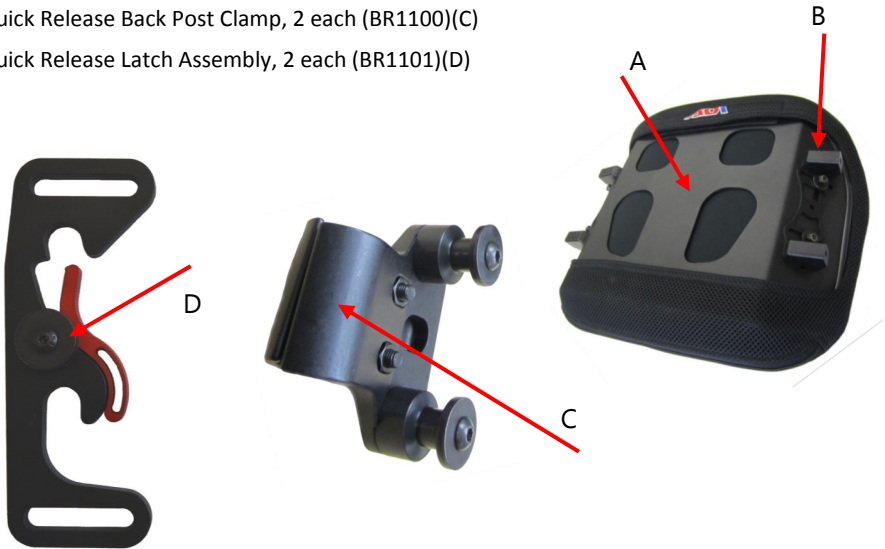

Assembly #: BR1101

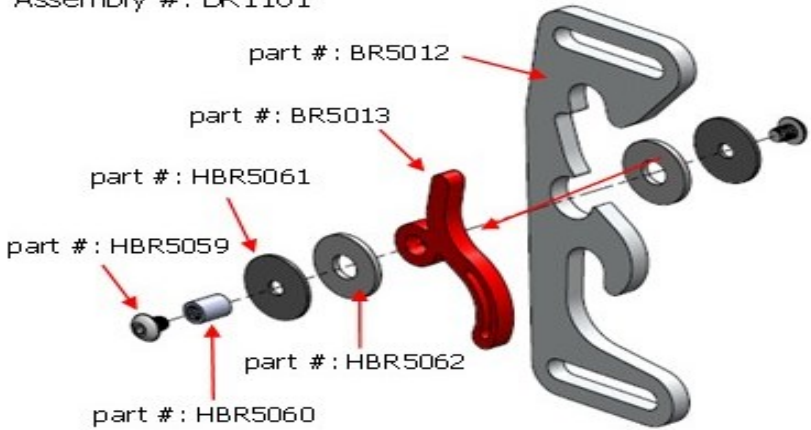

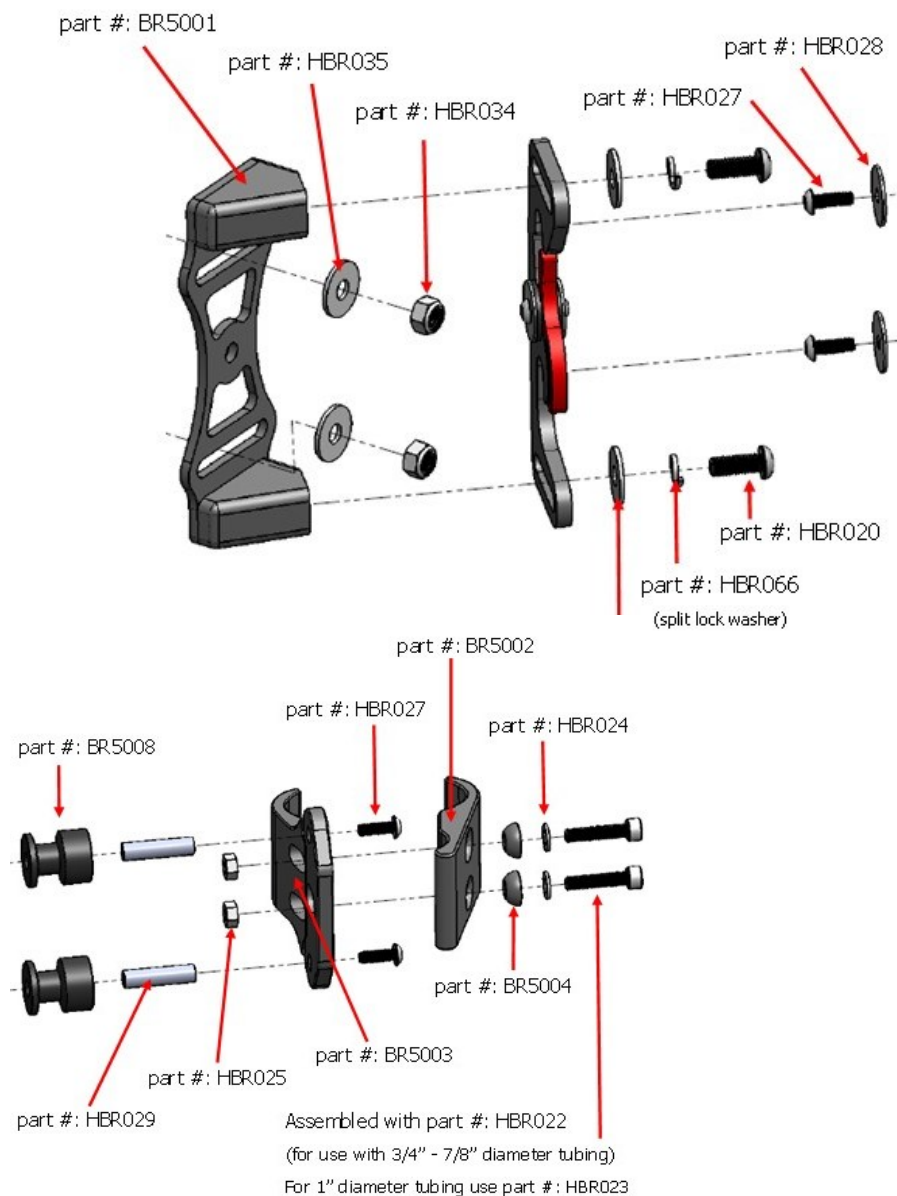

NOTICE

Only use the hardware supplied with the ADI back on the ADI back; do not substitute any other screws, brackets, or clamps. Use of alternative hardware of mounting brackets voids all warranty.

8.1 Torque Specification

Part Number: HBR027
10-32 x .5" button head, 18-8S/S
Use: 1/8" Drive allen wrench
Torque Spec: 31.7 in-lbs/3.6 N-m

Part Number: HBR022 (for 3/4" or 7/8" tubing)
M5-.8 x 22mm socket C/S
Use: 4mm Drive allen wrench
Torque Spec: 45.1 in-lbs/5.1 N-m

Part Number: HBR023 (for 7/8" & 1" tubing)
M5-.8 x 25mm socket C/S
Use: 4mm Drive allen wrench
Torque Spec: 45.1 in-lbs/5.1 N-m

Part Number: HBR059
8-32 x 3/16" Button Head Screw Cap
Use: 3/32" Drive allen wrench
Torque Spec: 19.8 in-lbs/2.3 N-m

Part Number: HBR020
M6 x 20mm Button Head SS
Use: 4mm Drive allen wrench
Torque Spec: 77.0 in-lbs/8.7 N-m

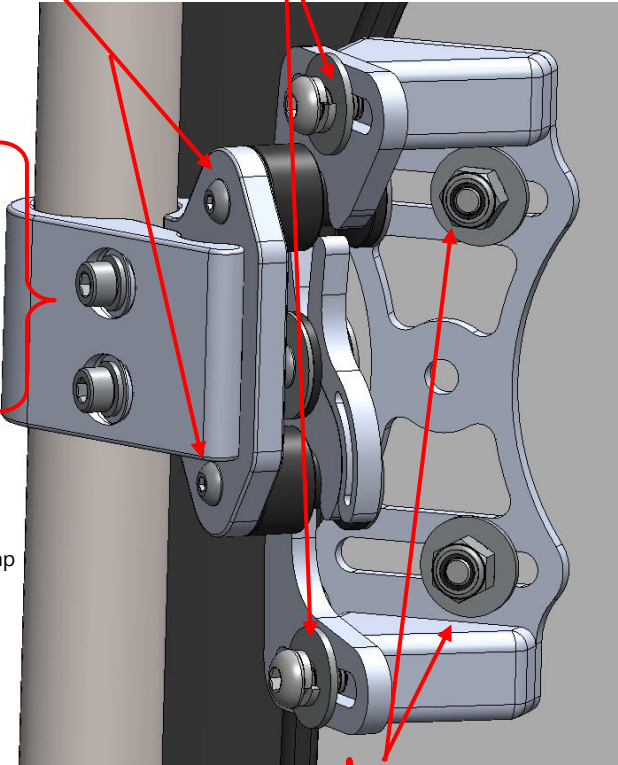

AL Series Backs
Part Number" BR5001
Stud Plate
Use: 10mm hex socket or wrench
Torque Spec: 117 in-lbs/13.2 N-m

CF Series Backs
Part Number: HBR036
M6 x 16mm Button Head SS
Use: 4mm Drive allen wrench
10mm hex socket or wrench (outside)
Torque Spec: 77 in-lbs/8.7 N-m



9.1 Step 1

Fasten Quick Release Latch Assembly to U-Block

NOTICE

It is essential that the included split lock washers (HBR066/4 each) be used at all four attachment points to maintain desired angle and depth adjustment of back.

4mm allen wrench Required

1. Insert m6 screw (x2) into lock washer and attach latch assembly to left and right side U-block. Before tightening m6 screw, slide latch to forward position (as shown).
2. With a 4mm allen wrench, slightly tighten m6.



CAUTION

During installation of latch assembly, slide to forward position as shown.

9.2 Step 2

Fasten Quick Release Clamp Assembly to Wheelchair Back Post

4mm allen wrench Required

1. Remove existing wheelchair back according to the original manufacturer's instructions.
2. Visually determine the desired height of your new ADI back support. Mark on each back post the needed location to attach clamp assemblies.
3. Slide clamp assembly over top of back post (receiving post facing inward) and slightly tighten each m5 screw with a 4mm allen wrench at the needed height location on wheelchair back post. Align clamp assembly parallel to the wheelchair seat base.

NOTICE

The mounting hardware should be installed at equal heights on the left and right sides, and parallel to the seat frame.

NOTICE

Tighten clamp screws, but allow for movement so you can adjust the receiving posts.



9.3 Step 3

Mounting Hardware Alignment

NOTICE

For ease of installation & removal, make sure both the clamp and latch assembly are aligned properly.

Clamp Alignment:

Align clamp assembly parallel to the seat frame by rotating as needed.

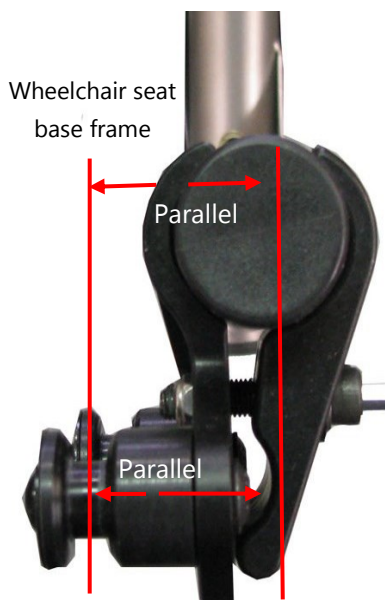

Latch Assembly Alignment:

Make sure the receiving hooks of the latch assembly are centered within the valley of the posts and parallel to the back post of the wheelchair.

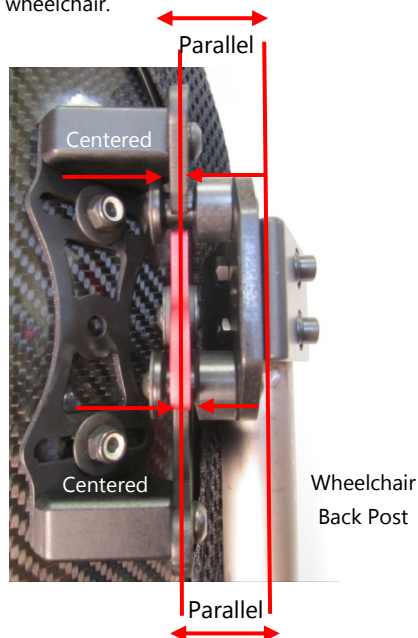

- Latch centering may require width adjustment. See “Width Adjustment” (pg. 6) for instructions.
- You will need to test initial mounting hardware placement by inserting and removing the backrest several times.
- If the quick release hardware sticks or is not smooth, you may need to re-align the mounting hardware receiving points on the back posts. To achieve proper alignment, slightly move the mounting hardware in or out and/or up or down. Make adjustments until the backrest smoothly inserts and removes from the top and bottom receiving posts.
- After final adjustment is complete, tighten all screws to the proper torque specification. This will ensure secure placement and safe operation.

9.4 Step 4

Attaching Quick Release Back to Mounting Clamps



1. With back tilted slightly forward, lower the left and right bottom hooks onto the bottom receiving posts.



2. After bottom hooks are in position, tilt back support rearward until top hooks are fully engaged onto top receiving posts.



3. After each receiving post is fully seated in the top & bottom hooks, manually press left and right, locking levers to the lock/down position.

NOTICE

Before use, confirm locking levers are in the locked position.

9.5 Step 5

Height Adjustment CF Series:

- With a 4mm allen wrench, loosen left and right clamp assembly screws and slide clamp up or down.

Height Adjustment AL Series:

- Repeat steps above, or loosen 10mm hex nuts and slide back up or down to achieve desired height.

Width Adjustment

1. Remove fabric cover from back support. (Only required on CF Series Backs)
2. On each side of the hardware, loosen the top and bottom screws (as shown), using a 10mm wrench.
3. Adjust hardware inward or outward to achieve required chair width.

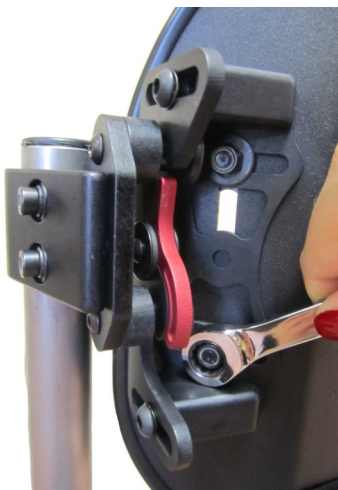

NOTICE

On CF series, you will need to use a 4mm allen wrench on inside screws.

4. After final adjustments are complete, tighten all screws to the proper torque specification.

NOTICE

+/-1" width adjustment.

Angle Adjustment

1. On each side of the hardware, loosen the top and bottom screws with a 4mm allen wrench.
2. Adjust back support to achieve desired user angle.
3. After final adjustments are complete, tighten all screws to the proper torque specification.



Depth Adjustment

1. On each side of the hardware, loosen the top and bottom screws with a 4mm Allen Wrench.
2. Slide back support forward or aft to achieve desired users depth.
3. After final adjustments are complete, tighten all screws to the proper torque specification.



CAUTION

ADI backs may not fit every chair; please consult your clinician or supplier providing your equipment.

9.6 Step 6

Quick Release Removal of Back Support

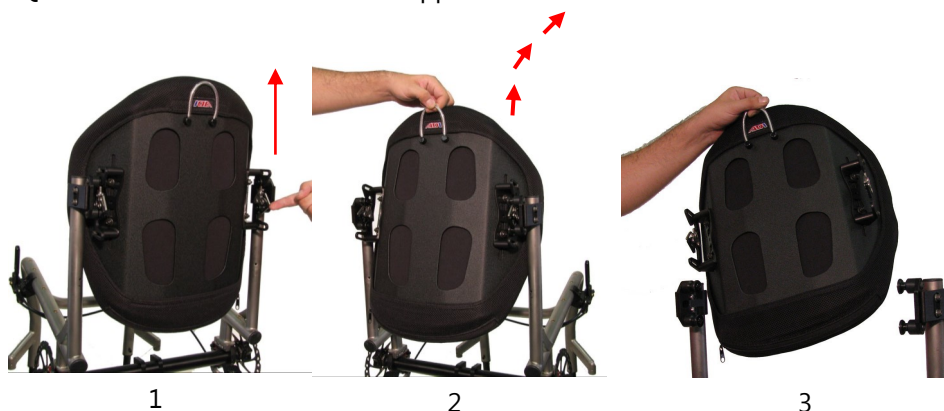

1. Lift both right and left locking levers to the “Up” unlocked position.
2. Lift back support UP and OUT at a slight angle.
3. After back support is clear of mounting hardware, remove from wheelchair back post.

CAUTION

Protect all backs from blunt forces that may cause damage and/or breakage.

CAUTION

If you are able to fold the back canes, the back should be in the folded position when transporting the wheelchair, especially before loading for air travel.

CAUTION

When positioning an ADI back, the interior portion of the back support should be positioned to make contact at the PSIS to provide optimal pelvic support and trunk control.

10.1 Dealer Assistance

During first time use by the client, it is advised that the dealer or service technician assists and explains the set-up to the customer (the user and/or the attendant). If needed, the dealer can make final adjustments.

⚠ CAUTION Do not attach the back with the user in the chair.

SAFETY

Do not attach the ADI backs with the user in the chair or use them during transportation.

10.2 User Testing

It is important that the customer is fully aware of the installation, how to use it, and what can be adjusted in order to gain as much mobility as possible. As a dealer, proceed as follows:

- Explain and show the customer how you have executed the installation, and explain the function of the hardware.
- If needed, adjust the hardware to the proper position.
- Explain to the customer possible problems and how to address them.

⚠ CAUTION Do not use the backs during vehicle transportation.

10.3 Conditions of Use

The ADI hardware is intended for use as installed by the dealer, in accordance to the installation instructions in this manual.

- The foreseen conditions of use are communicated by the dealer or service technician to the user and/or attendant during the first time use.
- If the usage conditions change significantly, please contact your dealer or a qualified service technician to avoid excessive wear and tear or unintended damage.
- The CF back may not fit every chair. Please consult your clinician or supplier providing your equipment.

11.1 Cleaning

- Use a soft cloth to clean back shell.
- Hand wash foam pad cover with mild, soapy water or detergent, and let dry.
- Foam pad should not get wet.

⚠ WARNING Do not hand wash in water temperatures above 160°F (70°C).

SAFETY

Institutions **MUST** clean and disinfect product between multiple patient uses.

⚠ WARNING Do not wash or machine dry.

11.2 Disinfection

- Wipe gently with a cloth dampened with a household disinfectant.
- Allow foam to air dry thoroughly.

⚠ WARNING Do not immerse the foam in water.

SAFETY

Always check all mounting hardware, making sure each fastener is properly tightened before using the back.

⚠ CAUTION 250lbs (113.40 kg) user weight limit.

NOTICE

Altering an ADI back in any way and/or improper installation will void warranty.



Stealth Products, LLC. • info@stealthproducts.com • www.stealthproducts.com
+1(800) 965-9229 | +1(512) 715-9995 | 104 John Kelly Drive, Burnet TX 78611

Revision Date 2016-01-05