

Rally

Owner's Manual



The Ultimate In Style & Performance[®]

Pride
Mobility Products Australia Pty. Ltd.

21 Healey Road

Dandenong, 3175

Victoria, Australia

ACN # 088 609 661

www.pridemobility.com

SAFETY GUIDELINES

Please read and follow all instructions in this owner's manual before attempting to operate your Scooter for the first time. If there is anything in this manual you do not understand, or if you require additional assistance for set-up, contact your local authorized Pride provider.

Using your Pride product safely depends upon your diligence in following the warnings, cautions, and instructions in this owner's manual. Using your Pride product safely also depends upon your own good judgement and/or common sense, as well as that of your provider, caregiver, and/or healthcare professional. Pride is not responsible for injuries and/or damage resulting from any person's failure to follow the warnings, cautions, and instructions in this owner's manual. Pride is not responsible for injuries and/or damage resulting from any person's failure to exercise good judgement and/or common sense.

The symbols below are used throughout this owner's manual to identify warnings and cautions. It is very important for you to read and understand them completely.



WARNING! Failure to heed the warnings in this owner's manual may result in personal injury.



CAUTION! Failure to heed the cautions in this owner's manual may result in damage to your Scooter.

CONTENTS

I. INTRODUCTION	4
II. SAFETY	6
III. SPECIFICATIONS	9
IV. DESCRIPTION	11
V. BATTERIES AND CHARGING	16
VI. OPERATION	20
VII. COMFORT ADJUSTMENTS	22
VIII. DISASSEMBLY AND ASSEMBLY	24
IX. TROUBLESHOOTING	26
X. CARE AND MAINTENANCE	27
XI. WARRANTY	28

I . I N T R O D U C T I O N

Welcome to Pride Mobility Products Australia Pty. Ltd. (Pride). Congratulations on the purchase of your new Pride Scooter. Your Scooter design combines the most advanced state-of-the-art components with modern, attractive styling. We are certain that the design features and trouble-free operation will add convenience to your daily living and ensure complete satisfaction.

At Pride, your safety is important to us. **Please read and follow all of the instructions in this manual before you attempt to operate your Scooter for the first time.** These instructions were produced for your benefit. Your understanding of these instructions is essential for the safe operation of your new Pride Scooter.

Pride is not liable for damage to property or personal injury arising out of unsafe use of a Pride Scooter. Pride is also not liable for any property damage or personal injury arising out of the failure of any person and or/user to following the instructions and recommendations set forth in this manual or any other instructions or recommendations contained in other Scooter related literature issued by Pride or contained on the Pride Scooter itself.

This owner's manual is compiled from the latest specifications and product information available at the time of publication. We reserve the right to make changes as they become necessary. Any changes to our products may cause slight variations between the illustrations and explanations in this manual and the product you had purchased.

If you experience any problems with your Scooter that your are unable to solve, or if you do not feel capable of safely following any of the instructions and/or recommendations as contained in this manual, please contact your authorized Pride provider for assistance.

Once you understand how to operate and take care of your Scooter, we are certain that it will give you years of trouble-free service and enjoyment.

Information Exchange

We want to hear your questions, comments, and suggestions about this manual. We would also like to hear about the safety and reliability of your new Pride Scooter, and about the service you received from your authorized Pride provider.

Please notify us of any change of address, so we can keep you apprised of important information about safety, new products, and new options that can increase your ability to use and enjoy your Pride Scooter. Please feel free to write us at the address below:

Pride Mobility Products Australia Pty. Ltd.
21 Healey Road
Dandenong 3175
Victoria, Australia

I . I N T R O D U C T I O N

My Authorized Pride Provider is:

Name: _____

Address: _____

Phone Number: _____

Quick Reference Information:

Scooter Model: _____

Serial Number: _____

Purchase Date: _____

NOTE: If you ever lose or misplace your warranty card or your copy of this manual, call or write to us and we will be glad to send you a new one immediately.

II. SAFETY

As you begin to use your Rally during your daily activities, you will encounter situations that, at first, may require some practice to negotiate on your Scooter. Simply take your time as you operate your Rally and you will soon be in full and confident control as you maneuver through doorways, on and off of elevators, up and down ramps, and over moderate terrain.

DOORS

- Determine if the door opens toward or away from you.
- Use your hand to turn the knob or push the handle or push-bar.
- Drive your Rally gently and slowly forward to push the door open or drive your Rally gently and slowly backwards to pull the door open.

ELEVATORS

Modern elevators have a door-edge safety mechanism that, when pushed, reopens the elevator door(s).

- If you are in the doorway of an elevator when the door(s) begin to close, push on the rubber door edge or allow the rubber door edge to contact your Scooter and the door will reopen.
- Use care that pocketbooks, packages, or Rally accessories do not become caught in the elevator door(s).

RAMPS AND OTHER INCLINES

More and more buildings have ramps with specified degrees of inclination. These ramps are designed for easy and safe Scooter access. Some ramps may have turning switchbacks that require that you have good cornering skills on your Rally.

- Take wide swings with your Rally's front wheel around any tight corners. If you do that, the Rally's rear wheels will follow a wide arc, not cut the corner short, and not bump into or get hung up on any railing corners.
- When driving down a ramp, keep the Rally's speed adjustment dial (see IV. "Description") set to the tortoise (slowest speed setting) to ensure a safely controlled descent.
- Never drive your Rally across the side of an incline or diagonally up or down an incline, and do not stop, if possible, while driving up or down an incline.
- Avoid sudden stops and starts.

Other inclines may be natural or, if man-made, not designed specifically for Scooters. Figure 1 illustrates your Rally's stability and its ability to climb grades under various weight loads.

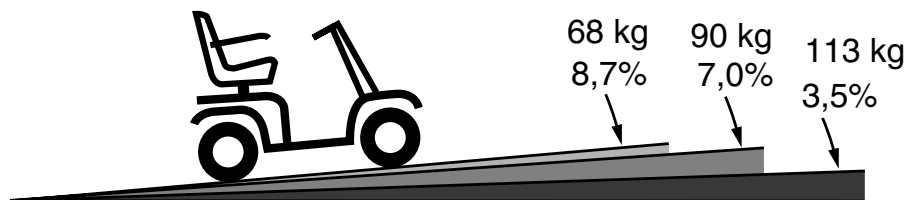

Figure 1. Maximum Recommended Incline Angle

II. SAFETY

These tests were conducted with the Rally's seat in the highest position and adjusted backward on the seat base to its farthest rearward position. Use this information as a guideline. Your Rally's ability to travel up inclines is affected by your weight, your Scooter's speed, your angle of approach to the incline, and your Scooter setup.

- When you approach an incline, it is best to lean forward. See figures 2 and 3. This action will shift the center of gravity of you and your Rally toward the front of your Scooter for improved stability.



WARNING! Do not exceed the incline guidelines or any other specifications presented in this manual.



Figure 2. Normal Driving Position

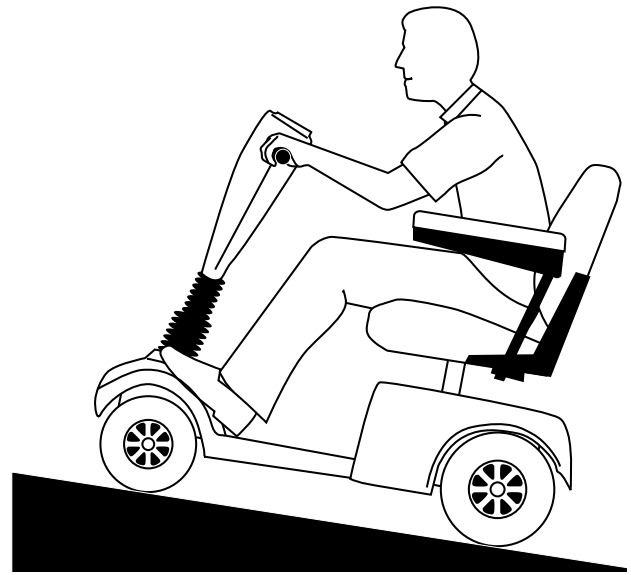

Figure 3. Increased Stability Driving Position

DRIVING SURFACES

Your Rally was designed to provide optimum stability under normal driving conditions; dry, level surfaces composed of concrete or asphalt. However, Pride recognizes the fact that there will be times when you will operate your Rally on surfaces other than concrete or asphalt. So we have also designed your Rally to perform admirably on packed soil, grass, and gravel.

- Feel free to use your Rally safely on lawns and in park areas.
- Avoid tall grass that can entangle the running gear.
- Packed soil and gravel, such as driveways or roads, will not present a problem for your Rally.
- Avoid loosely packed gravel and sand.
- If you feel unsure about a driving surface, avoid that surface.

II. SAFETY

SAFETY PRECAUTIONS

- Do not operate your new Rally for the first time without completely reading and understanding this owner's manual.
- Do not carry passengers on your Rally.
- Do not leave the key in the key switch when your Rally is unattended.
- Make certain that the seat is locked into place and that the key is removed from the key switch before getting on or off of your Rally, and make certain that the seat is in a locked position when you are operating your Scooter.
- Reduce your Rally's speed when you are operating it on uneven terrain and soft surfaces.
- Reduce your Rally's speed when you are driving it around a corner.
- Never drive your Rally across the side of an incline or diagonally up or down an incline, and do not stop, if possible, while driving up or down an incline.
- Proceed with extreme caution as you approach the downgrade of a ramp or other incline, and when driving near a raised surface, unprotected ledges and drop offs (kerbs, porches, stairs, etc.).
- Never remove your Rally's anti-tip wheels or modify the Rally in any way that is not authorized by Pride.
- Use extreme caution when operating your Rally on busy streets and in parking lots or shopping malls. Never ride your Rally where you cannot safely and legally walk. Consult local municipal or state agencies with regard to operating your Scooter on public roadways.
- Do not operate your Rally while you are under the influence of alcohol.
- Check with your physician if you are taking any medications that may affect your ability to operate your Rally safely.
- Keep your hands on the tiller and your feet on the floorboard when you are operating your Rally.
- Make certain that the tyres are properly inflated (30 pounds per square inch).
- Never use your Scooter as a seat in a moving vehicle.
- Make certain that the Rally's batteries are properly secured when you are transporting your Scooter in another vehicle.
- Disconnect your Rally's batteries if you will not be using your Scooter for more than 48 hours.
- Battery posts, terminals and related accessories contain lead and lead compounds. Wash hands after handling.

WARNING! Do not expose the electronics to any type of moisture at any time (rain, snow, mist, or wash). Such exposure can damage the electronics. Never attempt to ride a Scooter that has been exposed to moisture until it has dried thoroughly.



Do not operate or store your Scooter where it may be exposed to inclement weather conditions such as rain, snow, mist, and below-freezing temperatures (such as storage on an outside car/van potentially result in loss of control.

Do not operate your Scooter in icy or slippery conditions or on salted surfaces (i.e., footpaths or roads). Such use may result in an accident, personal injury, or adversely affect the performance and/or safety of your Scooter.

Always protect batteries from freezing temperatures and never charge a frozen battery. This will damage the battery and may cause personal injury. Attempting to charge a battery in freezing conditions does not prevent the battery from freezing.

III. SPECIFICATIONS

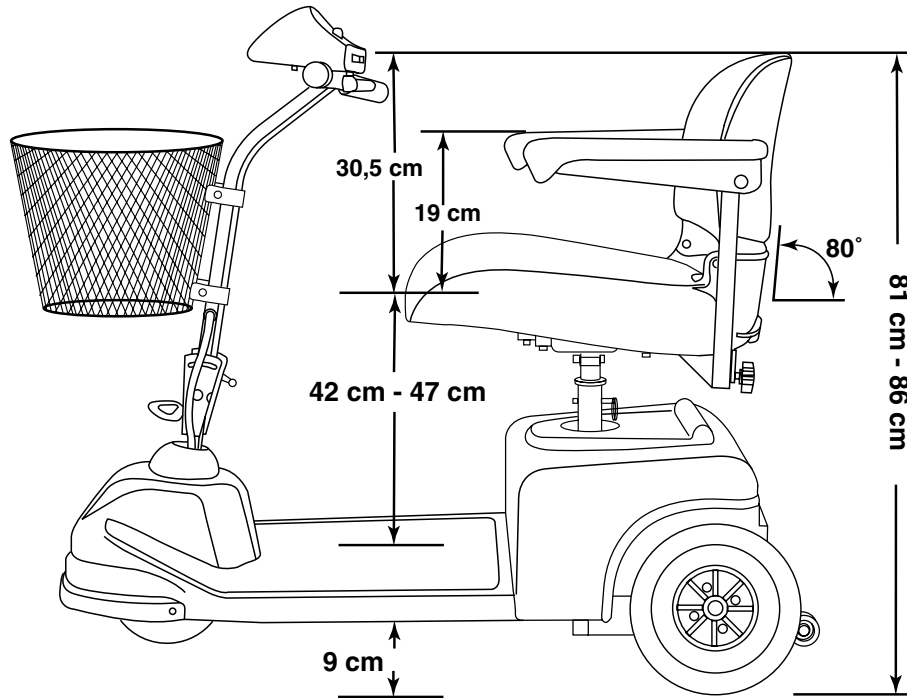
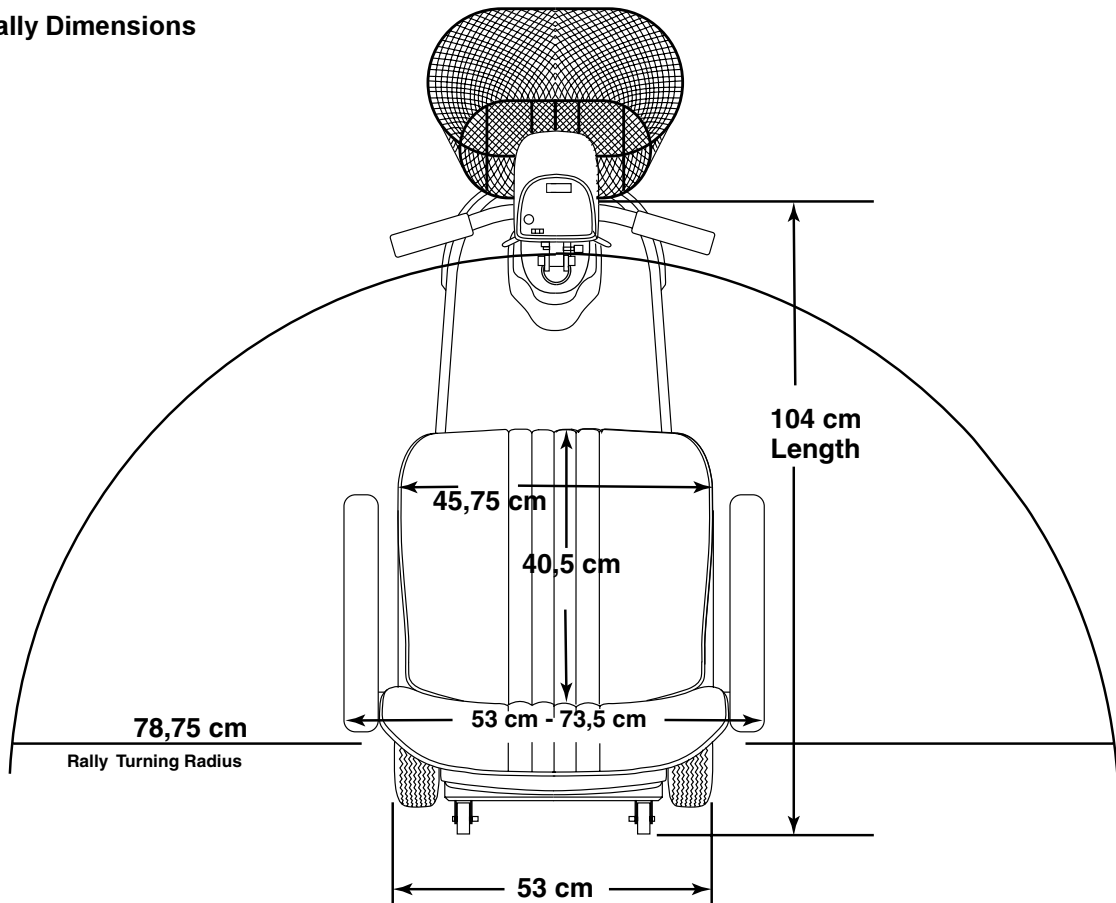

Figure 4. Rally Dimensions



III. SPECIFICATIONS

Length:	104 cm
Width:	53 cm
Tyres:	Type: Pneumatic Front: 5 cm X 20 cm , Rear: 7,5 cm X 23 cm
Weight Capacity:	113 kg Maximum
Battery Type (batteries not included):	Two 12V, 17 AH, SLA (sealed lead-acid) or Two 12V, 32 AH, SLA
Horsepower:	1,0 hp (peak)
Charger:	Onboard 2,5-Amp Charger
Speed (maximum):	Variable up to 6,8 km/h
Maximum Grade:	See figure1 for incline stability diagram
Range:	19 - 24 km with 17 AH batteries, 24 - 32 km with 32 AH batteries
Turning Radius:	78,75 cm
Body Colours:	Painted: Apple Red
Seating:	Style: Foldable molded plastic; removable seat covers with foam inserts are attached to seat. Dimensions: 45,75 cm width (useable) x 30,5 cm height (useable) x 40,5 cm depth Seat cover material: Gray fabric Armrests: gray molded rubber User-adjustable seat height, from ground: 53, 56, 58,5 cm User-adjustable seat height, from scooter deck: 42; 44,5; 47 cm
Included Features:	Adjustable seat height and positioning, easily accessible battery-charger A/C plug receptacle, external freewheel release lever, external circuit breaker reset button, removable floormat, front basket
Brakes:	Electronic regenerative braking and electromechanical disc brake
Rear Wheel Drive:	Transaxle, 24 V
Wheels:	Aluminum alloy wheels (rear wheels only), color matches shrouds
Tiller Type:	Adjustable
Freewheeling Mechanism Availability:	External freewheel release lever located on upper left portion of rear shroud
Weight:	Total Weight of Rally With two 12V 17 AH batteries: 53 kg With two 12V 32 AH batteries: 63 kg Component breakdown: Front section: 11.3 kg Rear section (without batteries or rear shroud): 18,4 kg Rear plastic shroud: 1,2 kg Seat: 8,8 kg Batteries: 12V, 17 AH: 6,3 kg; 12V, 32 AH: 11,3 kg (NOTE: two batteries are required per scooter) Basket: 0,7kg
Front-To-Rear Lockup:	Lever lock system
Ground Clearance:	9 cm
Optional Accessories:	Rear basket, headlight, taillight, safety flag, single crutch holder, double crutch holder, oxygen holder, walker holder, cane/crutch holder (bracket mount), cane crutch holder (armrest mount), rearview mirror, cup holder

IV. DESCRIPTION

Your Rally is a motorized electric Scooter designed to enhance your personal mobility. Your Rally is an indoor/outdoor Scooter that was designed to travel primarily on smooth surfaces, such as footpaths, roads, parking lots, floors, and driveways. For easy transportation or storage, you can disassemble your Rally into seven components. See figure 5.



Figure 5. Seven Rally Components

CONTROL CONSOLE ASSEMBLY

The control console assembly houses all of the controls you need to drive your Rally; including, the key switch, the speed adjustment dial, the throttle control lever, the battery condition meter, the horn button, and the light switch (optional). See figure 6.



WARNING! Do not expose the control console assembly to moisture. In the event that the console does become exposed to moisture, do not attempt to operate your Rally until the control console assembly has thoroughly dried.

Key Switch

- Fully insert the key into the key switch to power up (turn on) your Rally.
- Pull the key out to power down (turn off) your Rally.



WARNING! If the key is removed from the key switch while your Rally is in motion, the electronic brakes engage and your Rally comes to an abrupt stop!

Speed Adjustment Dial

This control dial allows you to preselect and limit your Rally's top speed.

- The image of the tortoise represents the slowest speed setting.
- The image of the hare represents the fastest speed setting.

IV. DESCRIPTION

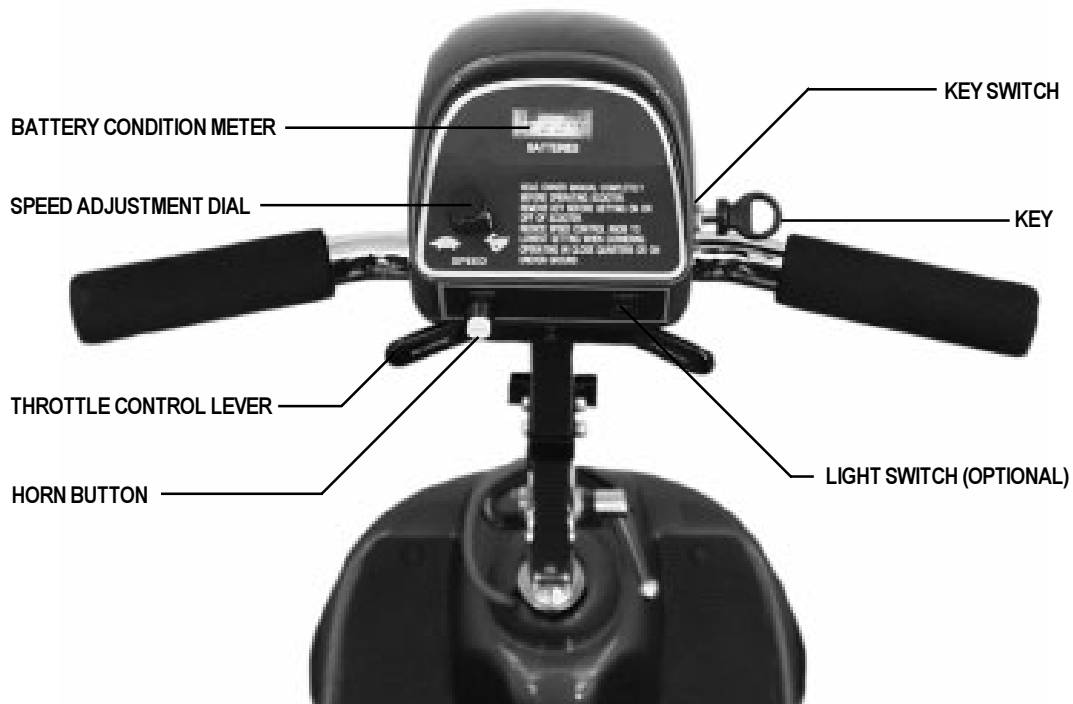

Figure 6. Control Console Assembly

Throttle Control Lever

This lever allows you to control the forward and the reverse speed of your Rally up to the maximum speed preset by the speed adjustment dial.

- Place your right hand on the right handgrip and your left hand on the left handgrip.
- Use your right thumb to push the right side of the throttle control lever to disengage your Rally's brake and move forward.
- Release the throttle control lever and allow your Rally to come to a complete stop before pushing the other side of the lever to move in reverse.
- When the throttle control lever is completely released, it automatically returns to the center "stop" position and engages your Rally's brake.

Battery Condition Meter

Whenever you have the key fully inserted, this meter gives an approximate reading of your Rally's battery voltage.

NOTE: To ensure the highest accuracy, the battery condition meter should be checked while operating your scooter at full speed on a level surface.

Horn Button

- The key must be fully inserted into the key switch for the horn to be operational.
- This button activates a warning horn.
- Do not hesitate to use the warning horn when its use could prevent accident or injury.

Light Switch (Optional)

This switch controls your Rally's headlight system.

- Press this switch once to turn on the lights.
- Press it again to turn off the lights.

IV. DESCRIPTION

REAR SECTION

The onboard battery charger, the charger power cord receptacle, the battery charger fuse, the batteries, the electronic controller assembly, the main circuit breaker, the manual freewheel lever, and the motor/transaxle assembly are located on the rear section of your Rally. See VIII “Disassembly and Assembly” for instructions on removing the rear shroud. The anti-tip wheels are at the rearmost part of your Rally. See figure 7.

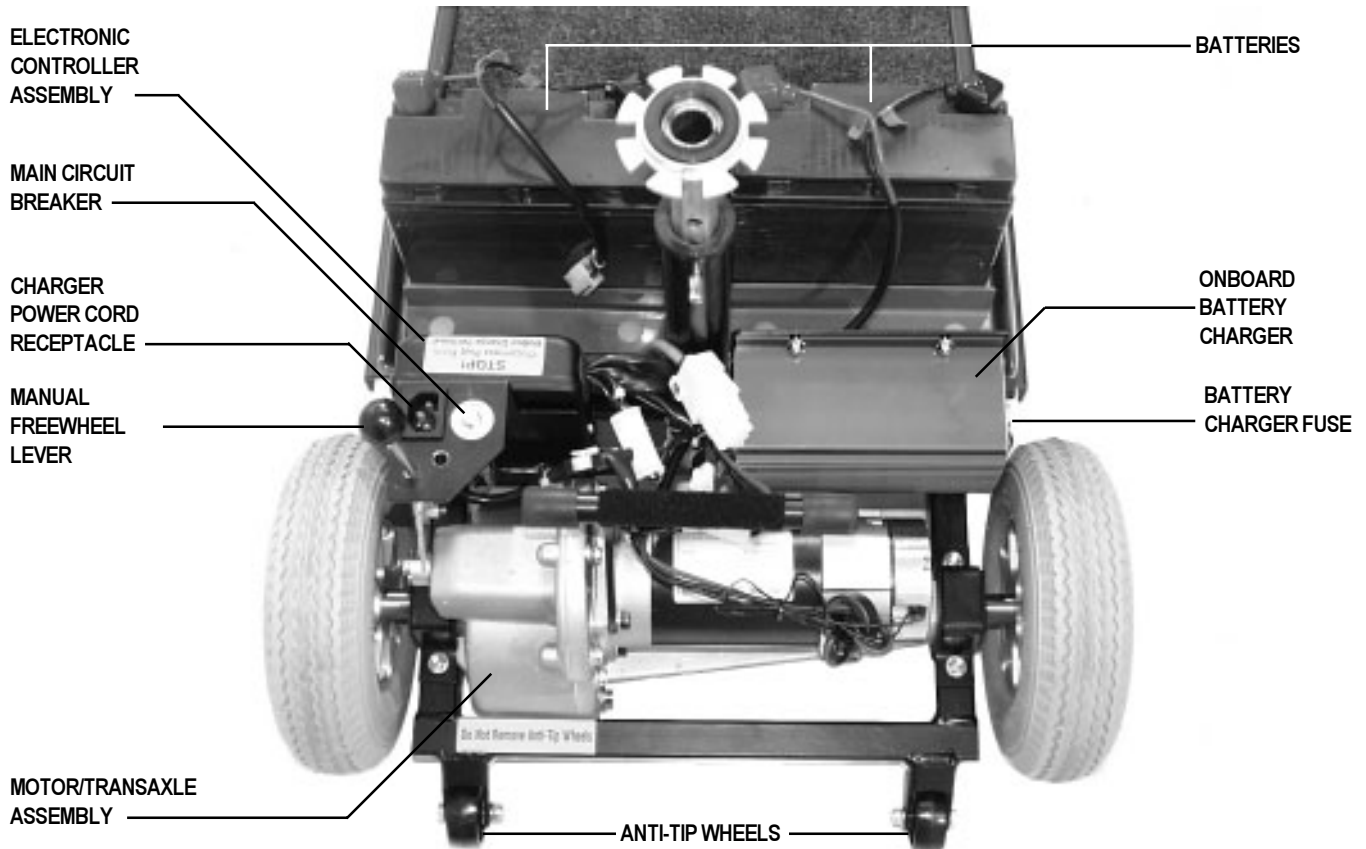

Figure 7. Rear Section

Onboard Battery Charger

The onboard battery charger converts household alternating current (AC) to direct current (DC) and charges the batteries of your Rally. See V. “Batteries and Charging.”

- The charger is located behind the batteries and at the forward right corner of the rear section.
- The charger is a box with cooling fins on the exterior of its case.
- The charger power cord plugs into the battery charger by means of a receptacle located on the rear section of your Rally, near the manual freewheel lever and the main circuit breaker reset button. See figure 7.

Battery Charger Fuse

The fuse has been incorporated into your charger to protect it from damage in the event of an electrical problem.

If your charger fuse repeatedly blows, try plugging your Rally’s power charger cord into an outlet on a different circuit.

IV. DESCRIPTION

- The fuse is located under a cap on the outside of the battery charger.
- The cap unscrews to allow access to the fuse.
- Unscrew the cap and replace the fuse if it has blown.



CAUTION! The replacement fuse must exactly match the rating of the new fuse. If you install a fuse with an incorrect rating, you may damage the charger. Contact your authorized Pride provider for fuse rating information.

Batteries

The batteries store the electrical energy that powers your Rally. See V. “Batteries and Charging.”

Electronic Controller Assembly

The electronic controller assembly is located behind the batteries and at the forward left corner of the Rally’s rear section. This assembly receives electrical signals from the console controls and sends power to the motor, the brakes, and the optional lighting system.

Main Circuit Breaker

When the voltage in your Rally’s batteries becomes low or your Rally is heavily strained because of excessive loads or steep inclines, the main circuit breaker may trip to protect your Rally’s motor and electronics from damage.

- The main circuit breaker is mounted on the rear section of the Rally, near the manual freewheel lever. See figure 7.
- The main circuit breaker reset button pops out when the breaker trips.
- When the breaker trips, the entire electrical system of your Rally is shut down.
- Allow a minute or so for your Rally’s electronics to “rest.”
- Push in the reset button to reset the breaker.
- If the breaker trips frequently, you may need to charge your batteries more often. You may also need to have your Pride provider perform a load test on your Rally’s batteries.
- If the main circuit breaker trips repeatedly, see your authorized Pride provider for service.

Manual Freewheel Lever

Whenever you need or want to push your Rally for short distances, you can put it in manual freewheel mode.



WARNING! Before placing your Rally into or taking it out of freewheel mode, make certain that the key is removed from the key switch. Even though the motor of your Rally is disengaged from the drive system when your Scooter is put in manual freewheel mode, the motor can still run if the throttle lever is pushed. Never sit on a Scooter when it is in freewheel mode. Never put a Scooter in freewheel mode on an incline.

- The manual freewheel lever is located on the end of the motor/transaxle assembly at the left rear of the Rally, and extends through the rear shroud. See figure 7.
- Pull up on the manual freewheel lever to disable the drive system and the brake system.
- You will then be able to push your Rally.
- Push down on the manual freewheel lever to reengage the drive system and the brake system and to take your Rally out of freewheel mode.

IV. DESCRIPTION

Motor/Transaxle Assembly

The motor/transaxle assembly consists of a geared transmission and differential. This one piece, direct drive, fully sealed assembly provides quiet operation with maximum power and long life. See figure 7.

Anti-Tip Wheels

The anti-tip wheels are an integral and important safety feature of your Rally. Do not, under any circumstances, remove the anti-tip wheels from your Rally. See figure 7.

OPTIONAL ACCESSORIES

For information concerning these optional accessories, see your authorized Pride provider.



Headlight



Taillight



Safety Flag



Rear Basket



Oxygen Holder

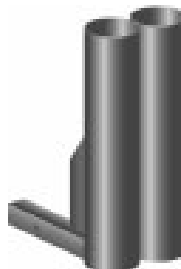

Double Crutch Holder

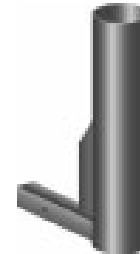

Single Crutch Holder



Cane/Crutch Holder
(Armrest Mount)



Cane/Crutch Holder
(Bracket Mount)



Walker Holder

V. BATTERIES AND CHARGING

You have the option to use either 32 AH or 17 AH batteries for your Rally. Your Rally was preset to use 32 AH batteries. If you decide to use 17 AH batteries, you must install the two provided battery spacer brackets.

Follow these easy steps to install the battery spacer brackets:

1. Position the spacer bracket in the battery well. See figure 8.
2. Align the holes in the spacer bracket with the holes in the battery well.
3. Install the Christmas tree clips. See figure 9.
4. Repeat steps 1-3 for the second spacer bracket.



Figure 8. Positioning the Spacer Bracket



Figure 9. Installing the Christmas Tree Clips

Your Rally requires two long-lasting, 12-volt, deep-cycle batteries that are sealed and maintenance free. They are recharged by an onboard 2,5-amp charging system designed for ease of use and convenience. See figure 7.

- Charge your Rally's batteries prior to using it for the first time.
- Keep your batteries fully charged to keep your Rally running trouble free.

Follow these easy steps to charge your batteries safely:

1. Position your Rally close to a standard wall outlet.
2. Remove the key from the key switch.
3. Make certain that the freewheel lever is in the down (drive) position and not in the up (freewheel) position.
4. Plug the charger power cord into the charger power cord receptacle at the rear of your Rally. See figure 7.
5. Extend the charger power cord and plug it into the wall outlet.



WARNING! Never use an extension lead to plug in your battery charger. Plug the charger directly into a properly wired standard wall outlet.

6. We recommend that you charge your Rally's batteries for 8 to 14 hours.
7. You can, if you wish, periodically check the battery condition meter by inserting the key in the key switch, examining the battery condition meter, and then removing the key. See figure 6. As the batteries charge, the battery condition meter approaches the 100% reading.
8. When the batteries are fully charged, unplug the charger power cord from the wall outlet and then from the charger power cord receptacle at the rear of your Rally.
9. Place the charger power cord in a safe place for future use.

V. BATTERIES AND CHARGING

FREQUENTLY ASKED QUESTIONS (FAQS)

How does the charger work?

When your Rally's battery voltage is low, the charger works extra and sends more electrical current to the batteries to bring up their charge. As the battery voltage approaches a full charge, the charger sends less and less electrical current to the batteries. When the batteries are fully charged, the current sent to them from the charger is at nearly zero amperage. Therefore, when the charger is plugged in, it maintains the charge on your Rally's batteries, but it does not overcharge them. Even though that charging maintenance feature is built into your Rally's onboard charger, we do not recommend that you charge your Rally's batteries for more than 24 consecutive hours.

Can I use a different charger?

For the safest, most efficient, and balanced charging of your Rally's batteries, we prefer and highly recommend the simultaneous charging of both batteries by use of the onboard battery charger.

How often must I charge the batteries?

Two major factors must be considered when deciding how often to charge your Rally's batteries.

- All day Scooter use on a daily basis.
- Infrequent or sporadic Scooter use.

With these considerations in mind, you can determine just how often and for how long you should charge your Rally's batteries. We designed the onboard charger so that it does not overcharge your Scooter's batteries (do not charge them for more than 24 consecutive hours). However, you may encounter some problems if you do not charge your batteries often enough and if you do not charge them on a regular basis. Following the five guidelines below provides safe and reliable battery operation and charging.

- If you use your Rally daily, charge its batteries as soon as you finish using it for the day. Your Rally will be ready each morning to give you a "full day" of service. We recommend that you charge your Rally's batteries for 8 to 14 hours after daily use.
- If you use your Rally once a week or less, charge its batteries at least once a week for 12 to 14 hours at a time.
- Keep your Rally's batteries fully charged.
- Avoid deeply discharging your Rally's batteries.
- Do not charge your Rally's batteries for more than 24 consecutive hours.

How can I get maximum range or distance per charge?

Rarely will you have ideal driving conditions—smooth, flat, hard driving surfaces with no wind or curves. You will often face hills, footpaths cracks, uneven and loosely packed surfaces, curves, and wind. All of these driving conditions affect the distance or running time per battery charge. The following are a few suggestions for obtaining the maximum range per battery charge.

- Always fully charge your Rally's batteries prior to your daily use.
- Maintain 30 psi (pounds per square inch) in all of your Rally's tyres.
- Plan your route ahead to avoid as many hills, cracked, broken, or soft surfaces as possible.
- Limit your baggage weight to essential items.
- Try to maintain an even speed while your Rally is in motion.
- Avoid stop-and-go driving.

V. BATTERIES AND CHARGING

What type and size of battery should I use?

We recommend deep-cycle batteries that are sealed and maintenance free. Both sealed lead-acid (SLA) and gel cell are deep-cycle batteries that are similar in performance in your Rally. Do not use wet-cell batteries, which have removable caps.



CAUTION! Do not remove the caps from sealed batteries. Water cannot be added to sealed batteries. Cap removal voids the battery warranty and may cause damage to the batteries and to your Rally.

Use these specifications to reorder deep-cycle batteries:

Battery Specifications	
Type:	Deep-cycle (sealed lead-acid, or gel cell)
Size:	U-1 (32AH only)
Voltage:	12 volts each
Amperage:	32 AH (amp hours) or 17 AH (amp hours)

To change a battery in your Rally:

1. Remove the seat and the rear shroud. See VIII. “Disassembly and Assembly.”
2. Disconnect the battery tie-down strap.
3. Disconnect the battery cables from the electronic controller assembly.
4. Disconnect the battery cables from the battery terminals.
5. Remove the old battery.
6. Place a new battery in the battery well.
7. Connect the red battery cable to the positive (+) battery terminal.
8. Connect the black battery cable to the negative (-) battery terminal.
9. Reconnect the battery cables to the electronic controller assembly.
10. Reconnect the battery tie-down straps.
11. Reinstall the rear shroud and the seat.



WARNING! Battery posts, terminals, and related accessories contain lead and lead compounds. Wash hands after handling.

Why do my new batteries seem weak?

Deep-cycle batteries employ a different chemical technology than is used in car batteries, nickel-cadmium batteries (nicads), or in other common battery types. Deep-cycle batteries are specifically designed to provide power, drain down their charge, and then accept a relatively quick recharge.

We work closely with our battery manufacturer to provide batteries that best suit your Rally’s specific electrical demands. Fresh batteries arrive daily at Pride and are shipped fully charged to our customers. During shipping, the batteries may encounter temperature extremes that may influence their initial performance. Heat diminishes the charge on the battery; cold slows the available power and extends the time needed to recharge the battery.

V. BATTERIES AND CHARGING

It may take a few days for the temperature of your Rally's batteries to stabilize and adjust to their new room or ambient temperature. More importantly, it will take a few charging cycles (a partial drain followed by a full recharge) to establish the critical chemical balance that is essential to a deep-cycle battery's peak performance and long life.

Follow these steps to break in your Rally's new batteries for maximum efficiency and life.

1. Fully recharge any new battery prior to its initial use. This charging cycle brings the battery up to about 88% of its peak performance level.
2. Operate your new Rally in familiar and safe areas. Drive slowly at first, and do not travel too far from your home or familiar surroundings until you have become accustomed to your Rally's controls and have properly broken in the batteries.
3. Fully recharge the batteries; they should be at about 90% of their peak performance level.
4. Operate your Rally again.
5. Fully recharge the batteries again.
6. After four or five charging cycles, the batteries are able to receive a charge of 100% of their peak performance level and will last for an extended period of time.

How can I ensure maximum battery life?

Fully charged deep-cycle batteries provide reliable performance and extended battery life. Keep your Rally's batteries fully charged whenever possible. Batteries that are regularly and deeply discharged, infrequently charged, or stored without a full charge may be permanently damaged, causing unreliable performance and limited life.

How should I store my Rally and its batteries?

If you plan on not using your Rally for an extended period of time, it is best to:

- Fully charge its batteries prior to storage.
- Disconnect the battery harnesses from the electronic controller assembly.
- Store your Rally in a warm, dry environment.
- Avoid storing your Rally where it will be exposed to temperature extremes.



CAUTION! If your Rally's batteries do become frozen, do not attempt to charge them. Cold or frozen batteries should be allowed to warm up for several days prior to recharging.

For prolonged storage, you may wish to place several boards under the frame of your Rally to raise your Scooter off of the ground. This takes the weight off of the tyres and prevents the possibility of flat spots developing on the areas of the tyres that contact the ground.

What about public transportation?

If you intend to use public transportation while using your Scooter, you must contact in advance the transportation provider to determine their specific requirements.

VI. OPERATION

Follow the checklist below. Familiarize yourself with this checklist, since some of the checks must be performed before you get on your Rally.

PRE-RIDE ADJUSTMENTS AND CHECKS

- Have you fully charged the batteries? See V. “Batteries and Charging.”
- Is the manual freewheel lever in the drive (down) position? Never leave the manual freewheel lever pulled up unless you are manually pushing your Rally.
- Is your proposed path clear of people, pets, and obstacles?
- Have you planned your route to avoid adverse terrain and as many inclines as possible?
- Are you positioned comfortably in the seat? See “Operating Your Scooter” below.
- Is the seat at the proper height? See VII. “Comfort Adjustments.”
- Is the seat locked securely in place? See VII. “Comfort Adjustments.”
- Is the tiller handle at a comfortable setting and locked securely in place? See VII. “Comfort Adjustments.”
- Is the key fully inserted into the key switch? See IV. “Description.”
- Is the speed adjustment dial set to a slow setting? See IV. “Description.”
- Are you grasping the handgrips with a thumb resting on each side of the throttle lever? See IV. “Description.”
- Does your Rally’s horn work properly?

GETTING ON YOUR SCOOTER

1. Make certain that the key is removed from the key switch.
2. Stand at the side of your Scooter.
3. Pull up on the seat lock lever and rotate the seat until it is facing you.
4. Make certain that the seat is locked securely in position.
5. Position yourself comfortably and securely in the seat.
6. Pull up on the seat lock lever and rotate the seat until you are facing forward.
7. Make certain that the seat is locked securely in position.
8. Make certain that your feet are safely on the floorboard.

OPERATING YOUR SCOOTER

After planning your route:

- Adjust the speed adjustment dial on the control console assembly to your desired speed.
- Press your thumb against the appropriate side of the throttle control lever.
- The electric brake automatically disengages and your Scooter accelerates smoothly to the speed preselected at the speed adjustment dial.

Whether you are driving forward or in reverse:

- Pull on the left handgrip to steer your Scooter to the left.
- Pull on the right handgrip to steer your Scooter to the right.
- Move the tiller to the center position to drive straight ahead.
- Release the throttle control lever to decelerate and come to a complete stop.
- The electric brake automatically engages when your Scooter comes to a stop.

NOTE: The rear wheel drive transaxle gives your Rally maximum traction with minimal steering effort on your part.

V I . O P E R A T I O N

GETTING OFF OF YOUR SCOOTER

1. Bring your Scooter to a complete stop.
2. Make certain that the key is removed from the key switch.
3. Pull up on the seat lock lever and rotate the seat until you are facing toward the side of your Scooter.
4. Make certain that the seat is locked securely in position.
5. Carefully and safely get out of the seat and stand to the side of your Scooter.
6. You may, if you wish, leave the seat facing to the side to facilitate getting on your Scooter the next time you operate it.

VII. COMFORT ADJUSTMENTS



WARNING! Remove the key before adjusting the tiller or the seat. Never attempt to adjust the tiller or the seat while the Scooter is in motion.

TILLER ANGLE ADJUSTMENT

You can adjust the tiller to many positions. The tiller adjustment lever locks the tiller in place. It has a spring-loaded mechanism that enables you to rotate it and change its position.

1. Turn the tiller adjustment lever counterclockwise until it is loose. If the tiller adjustment lever comes in contact with the tiller basket, pull it outward, turn it clockwise, and release it. Continue to loosen until the tiller is able to move. See figure 10.
2. Move the tiller to a comfortable position.
3. Turn the tiller adjustment lever clockwise until it is tight. If the tiller adjustment lever comes in contact with the tiller basket, pull it outward, turn it counterclockwise, and release it. Continue to turn the lever until it is tight. The tiller may be lowered to the center of the floorboard and locked in place for storage. See VIII. "Disassembly and Assembly."

SEAT HEIGHT ADJUSTMENT

The seat can be repositioned to one of three different heights. See figure 11.

1. Remove the seat from your Rally. See VIII. "Disassembly and Assembly."
2. Use the attached ring to pull and remove the ball detent pin from the lower seat post.
3. Raise or lower the upper seat post to the desired seat height.
4. While holding the upper seat post at that height, match up the holes in the upper seat post and in the seat post tower.
5. Fully insert the ball detent pin.
6. Replace the seat.

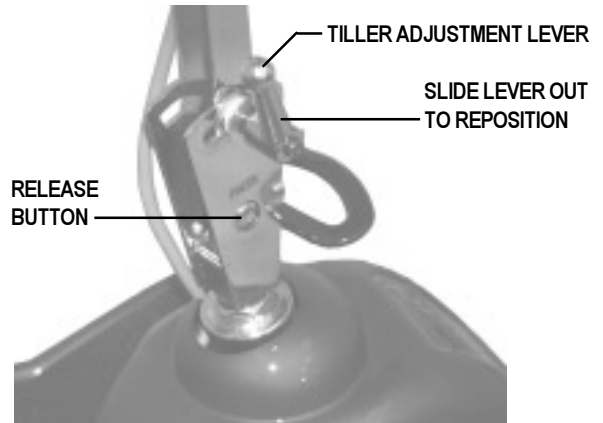

Figure 10. Adjusting the Tiller Angle

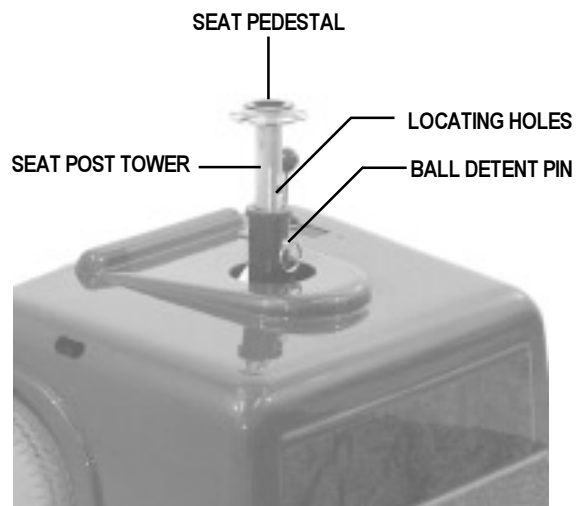

Figure 11. Seat Height Adjustment

VII. COMFORT ADJUSTMENTS

FRONT-TO-BACK SEAT ADJUSTMENT

You can reposition the Rally's seat forward or rearward to one of three settings to adjust the distance between the seat and the tiller. See figure 12.

1. Remove the seat from your Rally. See VIII. "Disassembly and Assembly." See figure 15.
2. Remove the four bolts that fasten the seat to the seat platform. See figure 12.
3. Align the seat platform with the desired set of holes on the seat.
4. Install the four bolts securely.

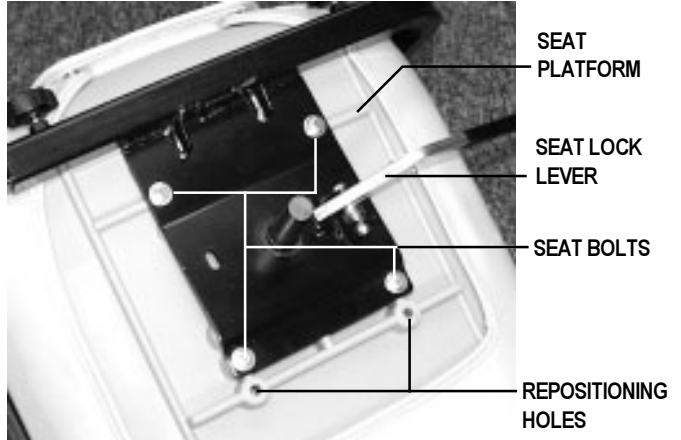

Figure 12. Front-to-Back Seat Adjustment

ARMREST WIDTH ADJUSTMENT

The armrest width of your Rally can be adjusted inward or outward. See figure 13.

1. Loosen the adjustment knobs at the back of the seat frame.
2. Slide the armrests in or out to the desired width.
3. Tighten the adjustment knobs.

NOTE: The armrests also swivel up to make getting on and off of your Rally easier.

SEAT ROTATION

The seat lock lever locks the seat in one of eight positions. See figure 14.

1. Pull up on the seat lock lever to unlock the seat.
2. Rotate the seat to the desired position.
3. Release the seat lock lever to lock the seat securely in place.

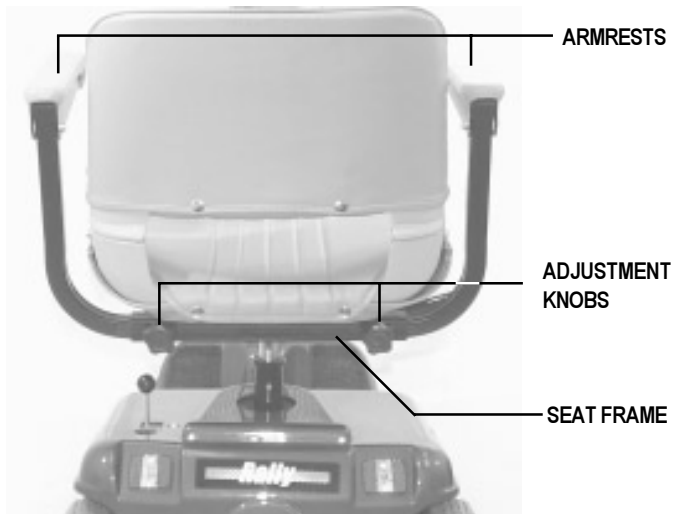

Figure 13. Armrest Width Adjustment



Figure 14. Seat Lock Lever



Figure 15. Seat Disassembly and Assembly

VIII. DISASSEMBLY AND ASSEMBLY

Always disassemble or assemble your Rally on a level, dry surface with sufficient room for you to work and move around your Scooter. Keep in mind that the disassembled sections of the Rally take up more floor space than the assembled Rally.

DISASSEMBLY

1. Remove the key from the key switch. See IV. "Description."
2. Pull up on the manual freewheel lever. See IV. "Description." Putting your Rally in freewheel mode makes it easier for you to maneuver the rear section because the drive wheels are free to turn.
3. Lift the seat up and off of your Rally. See figure 15.
4. Gently lift the rear shroud off of your Rally. The rear shroud is held in place with reusable fasteners. See figure 16.
5. Unplug both battery harness connectors. See figure 17.
6. Lift both batteries from the battery wells.
7. Unplug the large, white, 9-pin front-to-rear connector that connects the front control console assembly harness to the electronic controller assembly harness. See figure 17.



CAUTION! Failing to unplug both battery harness connectors and the front-to-rear connector prior to further disassembly could result in permanent damage to your Rally.

8. Lower the Rally's tiller to the center of the floorboard by turning the tiller adjustment lever until it is loose. Press the tiller release button and lower the tiller to the center of the floorboard. Tighten the tiller adjustment lever.
9. Lift the front-to-rear locking lever to unlock the front section of your Rally from its rear. See figure 18.
10. While pulling up on the front-to-rear locking lever with one hand, use your other hand to push on the seat pedestal to pivot the Rally's seat section backwards.
11. With one hand on the seat pedestal and one hand on the lowered tiller, gently slide the front and rear sections apart.



Figure 16. Rear Shroud

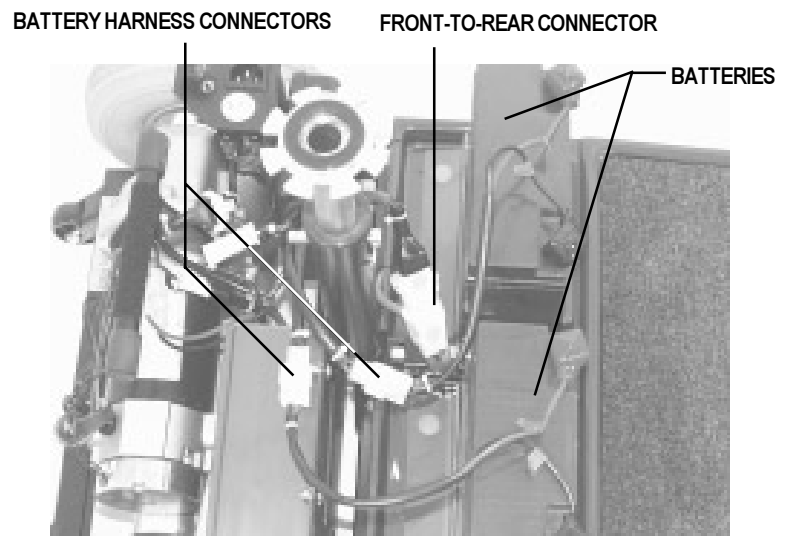

Figure 17. Battery Harness Connectors, Front-to-Rear Connector

VIII. DISASSEMBLY AND ASSEMBLY

ASSEMBLY

1. Pull up on the manual freewheel lever. Putting your Rally in freewheel mode makes it easier for you to maneuver the rear section because the drive wheels are free to turn. See IV. “Description.”
2. Position the front and rear sections of your Rally as shown in figure 19.
3. Align the lower slots on the rear of the front section onto the corresponding pegs on the front of the rear section. See figure 19.
4. Gently pull up on the seat pedestal on the rear section of your Rally, so the rear section pivots into place.
5. The rear section pivots forward and locks in place with a “click.”
6. Raise the tiller to the upright position by turning the tiller adjustment lever until it is loose. Raise the tiller to the desired position. Tighten the tiller adjustment lever.
7. Connect the large, white, 9-pin connector located on the harness coming out of the Rally’s front section to the connector’s mating socket found near the front of the Rally’s rear section. See figure 17.
8. Place the batteries in the battery wells and strap them in place. See figure 17.
9. Connect the 2-pin battery harnesses into the mating harnesses that extend from the electronic controller assembly. See figure 17.
10. Gently place the rear shroud over the seat pedestal and slide it down into position. See figure 16. The reusable fasteners hold it in place.
11. Carefully lift the seat and slide the seat post (on the bottom of the seat frame) into the seat pedestal. See figure 15.
12. Rotate the seat until it locks into place to complete the assembly of your Rally.



Figure 18. Front-to-Rear Locking Lever



Figure 19. Front and Rear Sections

IX. TROUBLESHOOTING

Any electromechanical device occasionally requires some troubleshooting. However, most of the problems that may arise can usually be solved with a bit of thought and common sense. Many of these problems occur because the batteries are not fully charged or because the batteries are worn down and can no longer hold a charge.

What if all the systems on my Rally seem to be “dead”?

- Make certain that the key is fully inserted in the key switch.
- Check that the batteries are fully charged. See V. “Batteries and Charging.”
- Push the reset button in to reset the main circuit breaker. See IV. “Description.”
- Make certain that both battery harnesses are firmly connected to the electronic controller assembly and to the battery terminals. See VIII. “Disassembly and Assembly.”
- Make sure that the front-to-rear harness connector is firmly connected. See VIII. “Disassembly and Assembly.”

What if the motor runs but my Rally does not move?

- Your Rally was probably left in manual freewheel mode.
- When the freewheel lever is pushed down, the brakes are disengaged and all power to the transaxle is cut.
- Push down the freewheel lever to restore normal operation to your Rally. See IV. “Description.”

What if the main circuit breaker repeatedly trips?

- Charge the Rally’s batteries more frequently. See V. “Batteries and Charging.”
- If the problem continues, have both of your Rally’s batteries load tested by your authorized Pride provider.
- Or, test the batteries yourself. Battery load testers are available at most automotive parts stores.
- Follow the directions supplied with the load tester.
- See V. “Batteries and Charging” for information about your Rally’s battery type.

What if the battery condition meter dips way down and the motor surges or hesitates when I press my Rally’s throttle control lever?

- Fully charge your Rally’s batteries. See V. “Batteries and Charging.”
- Have your authorized Pride provider load test each battery.
- Or, see the previous troubleshooting question for load testing the batteries yourself.

If you experience any problems with your Rally that you are unable to handle, immediately contact your authorized Pride provider for information, maintenance, and service.

X. CARE AND MAINTENANCE

Your Rally requires a minimal amount of care and maintenance. If you do not feel confident in your ability to perform the maintenance listed below, you may schedule inspection and maintenance at your authorized Pride provider.

The following areas require periodic inspection and/or care and maintenance.

TYRE PRESSURE

- We recommend that the tyre pressure be maintained at 30 psi. For optimum Scooter performance, do not exceed that pressure; overinflating a tyre can cause it to explode.

TYRE CONDITION AND TREAD WEAR

Regularly inspect your Rally's tyres for signs of wear.

- Use a rubber conditioner on your Rally's tyres to help preserve them.
- Do not put rubber conditioner on tread area of tyres; the tyres may become dangerously slippery.

EXTERIOR SURFACES

- Bumpers and trim also benefit from an occasional application of rubber or vinyl conditioner.

REMOVABLE FLOORMAT

- Your Rally's carpet floormat is held on by reusable fasteners. You may remove, clean, and reinstall the floormat at your convenience.

BATTERY TERMINAL CONNECTIONS

- Make certain that the terminal connections remain tight and uncorroded.
- The batteries must sit flat in the battery wells.
- The battery terminals should face the rear of the Rally.

WIRING HARNESSES

- Regularly check all wiring connections.
- Regularly check all wiring insulation, including the charger power cord, for wear or damage.
- Have your authorized Pride provider repair or replace any damaged connector, connection, or insulation that you find before using your Rally again.

ABS PLASTIC SHROUDS

- The front console shroud and the rear shroud are formed from durable ABS plastic and coated with an advanced formula urethane paint.
- A light application of car wax helps the shrouds retain their high gloss.

AXLE BEARINGS AND THE MOTOR/TRANSAXLE ASSEMBLY

- These items are all prelubricated, sealed, and require no subsequent lubrication.

CONSOLE, CHARGER, AND ELECTRONIC CONTROLLER ASSEMBLY

- Keep these areas free of moisture.
- If any of these items become exposed to moisture, let them dry thoroughly before operating your Rally again.

STORAGE

See "How should I store my Rally and its batteries?" in V. "Batteries and Charging."

X I . W A R R A N T Y

TWO-YEAR LIMITED WARRANTY

Structural frame components; including platform, fork, seat post, and frame welds.
Drive train; including differential, motor, and brake.

ONE-YEAR LIMITED WARRANTY

Your Pride Scooter is fully guaranteed for twelve (12) months from the date of purchase against faults arising due to defects in manufacture or materials. This warranty does not detract from, but is in addition to your legal rights.

All electronic parts including controllers and battery chargers have a one (1) year warranty. Servicing to the controller or battery charger must be carried out by your Pride provider. Any attempt to open or dismantle these items renders the guarantee void on that item.

NOT COVERED UNDER WARRANTY

This guarantee does not extend to those items which may need replacement due to normal wear and tear (tyres, belts, bulbs, upholstery, plastic shrouds, motor brushes, fuses, batteries - see "Batteries," below), or damage to the product caused by misuse or accident for which Pride or its agent cannot be held responsible. This warranty does not include labor or service calls.

BATTERIES

Batteries are covered by a six (6) month warranty from the original manufacturer.

Gradual deterioration in performance (due to being left in a discharged state, in cold condition for long periods of time, or worn out through heavy use) is not covered.

SERVICE CHECKS AND WARRANTY SERVICE

Warranty service can be performed by an authorized Pride provider. Please contact your Pride provider who can advise you on the current cost affecting this service visit.