

If you require any assistance with these instructions, please call Quantum Technical Service at 1-877-800-1248. Canada providers, call 1-888-570-1113.



WARNING! Prior to performing any actions to the power chair, ensure the power is turned off at the joystick and the power base is in drive mode.



NOTE: Only the right side is shown. The left side installation mirrors the right.



NOTE: The following symbol  will be used to indicate the size of the Hex Key needed in millimeters. Example:  is a 6 millimeter Hex Key.  is an 8mm Hex Key.

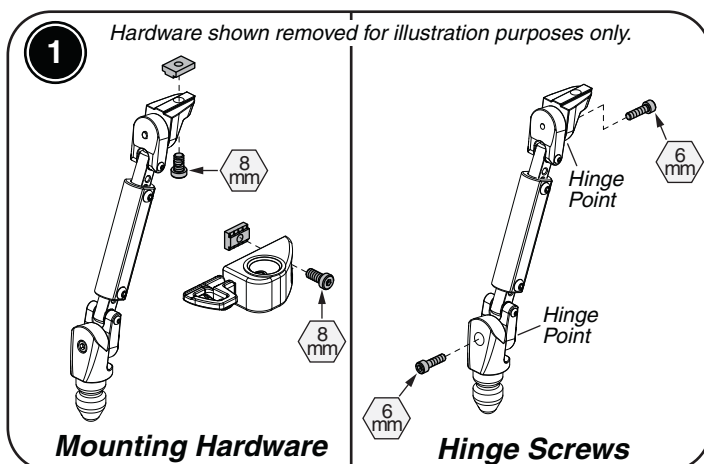
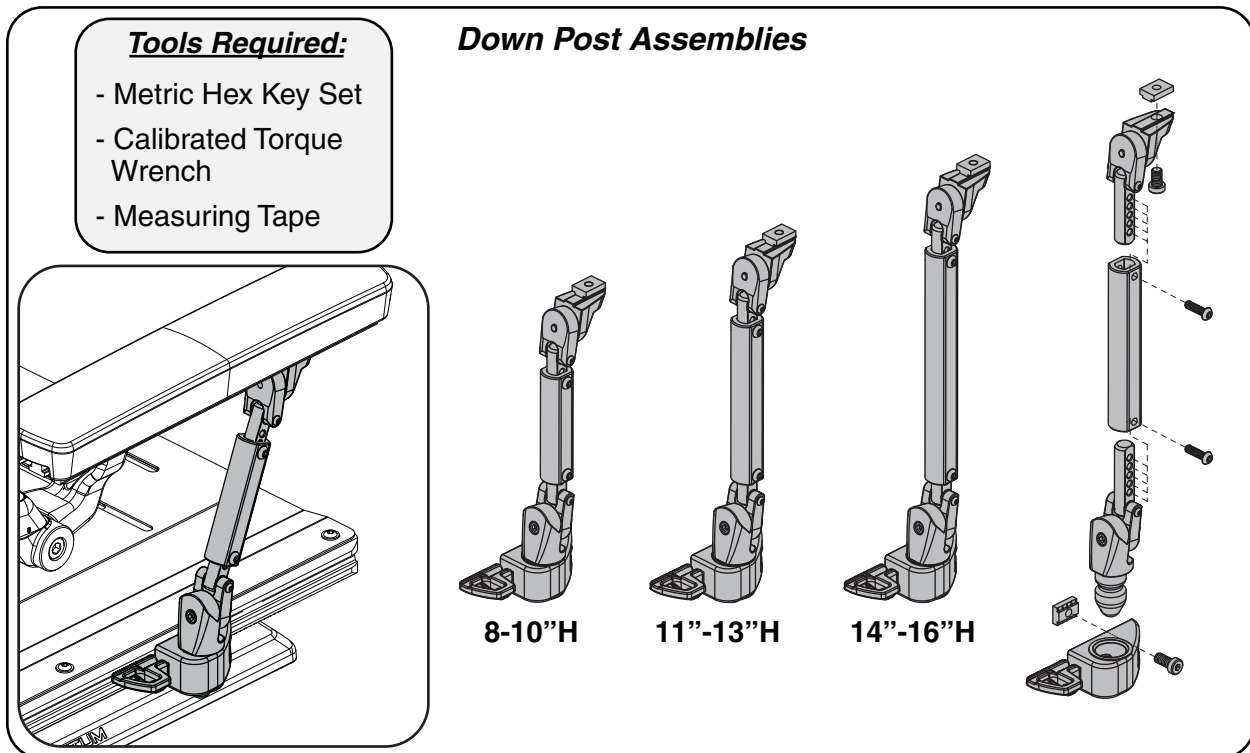

- Loosen the **Mounting Hardware** and **Hinge Screws**. The Hinge Points should be loose but remain connected.

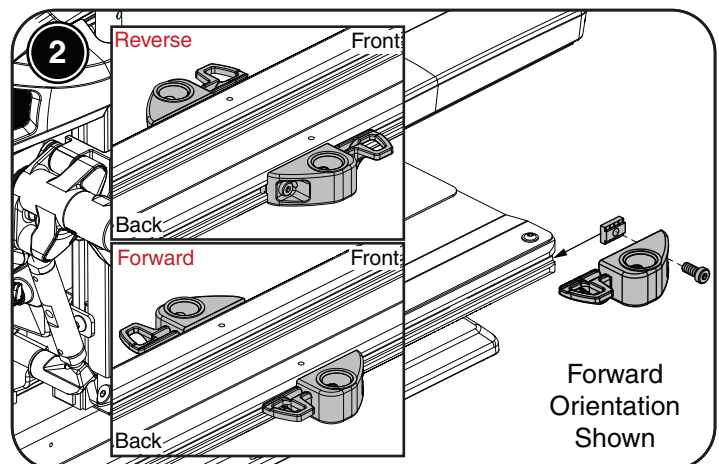

- Slide the receiver block into the side rail. The **Reverse** orientation is used for 8" - 10" high armrests, the **Forward** orientation is used for all other armrest heights.

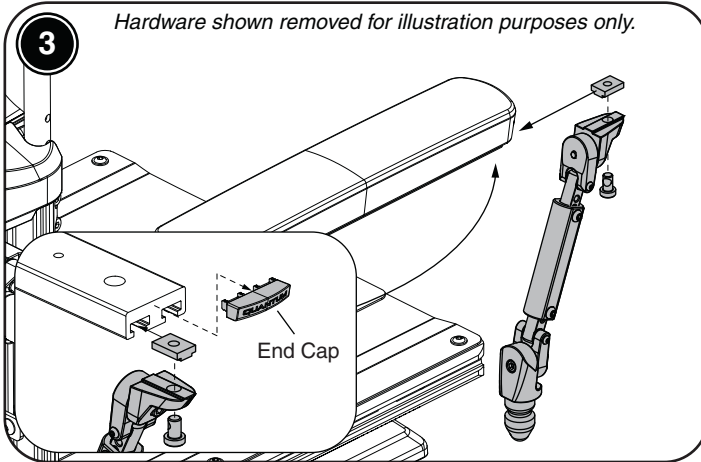

- Remove the armrest end cap.
- Slide the down post assembly into the outermost armrest channel. Do not tighten.

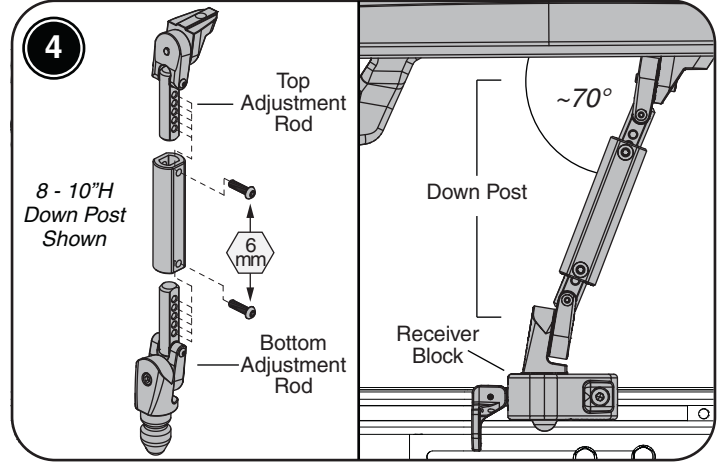

- Set the Top and Bottom Adjustment Rods so the Down Post can be inserted into the Receiver Block.
- The down post should form an approximate angle of 70° with the top of the armrest.

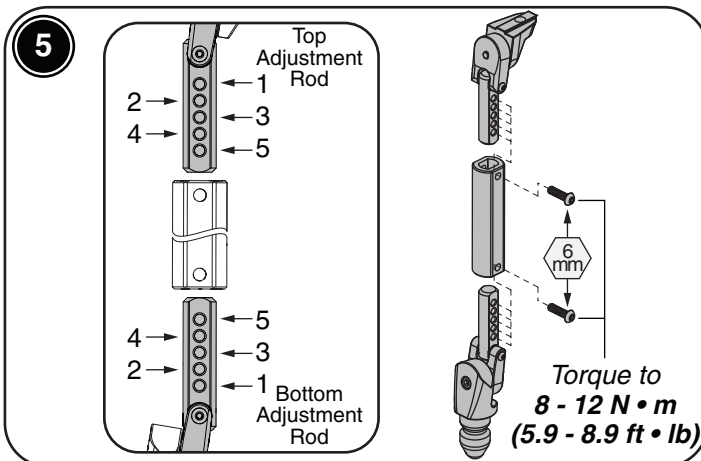

- The Top and Bottom Adjustment Rods should be kept within one setting of each other, i.e. If the top is set to 4 the bottom should have a setting of 3, 4, or 5.
- Torque the screws to the values shown.

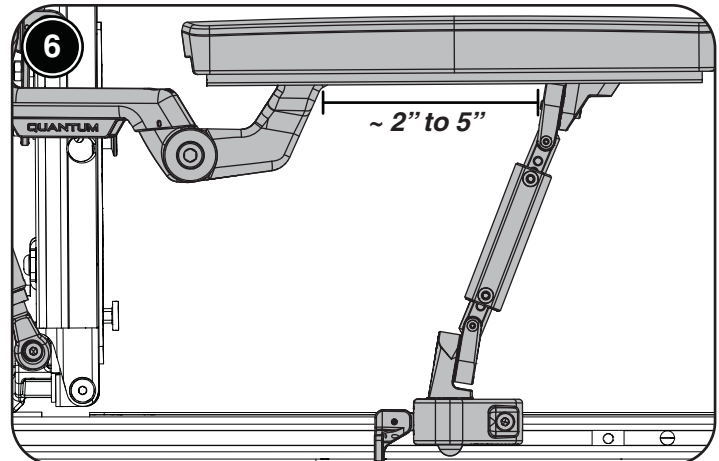

- Align the down post and receiver block so the top of the down post is 2" to 5" away from the armrest while maintaining the approximate 70° angle from Step 4.

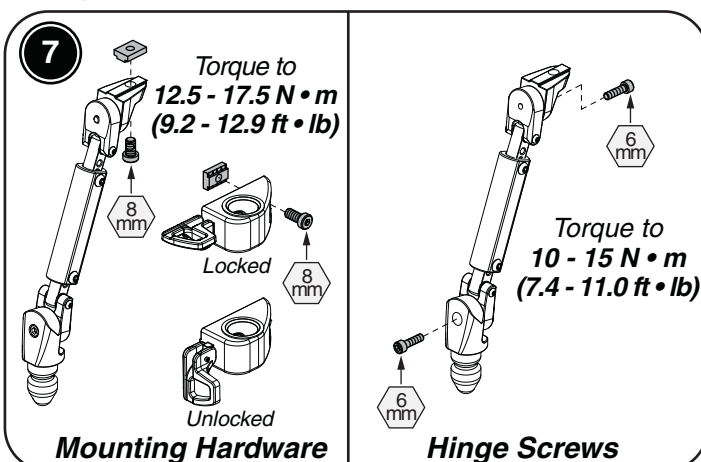

- Torque the remaining hardware to the values shown.
- Ensure the receiver block is in the locked position.
- Reinstall the endcap from Step 3.

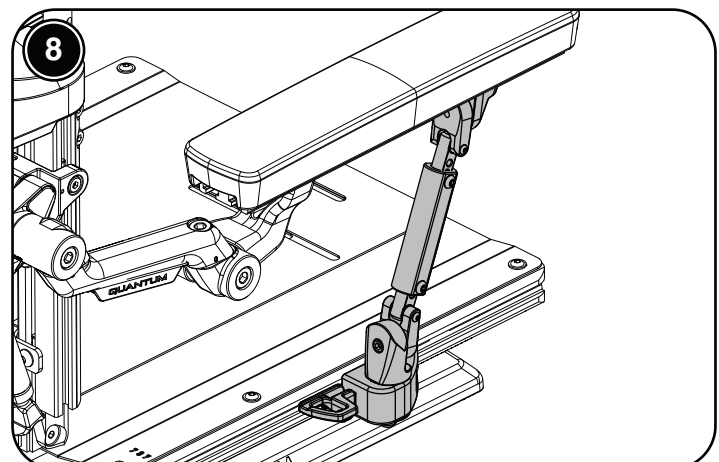

- Ensure the down post is secure.
- If the unit is equipped with a recline back, run the recline and make sure the down post has full range of motion. Adjust if necessary.