

BASIC OPERATION INSTRUCTIONS

Euro Seat System

ACN# 088 609 661

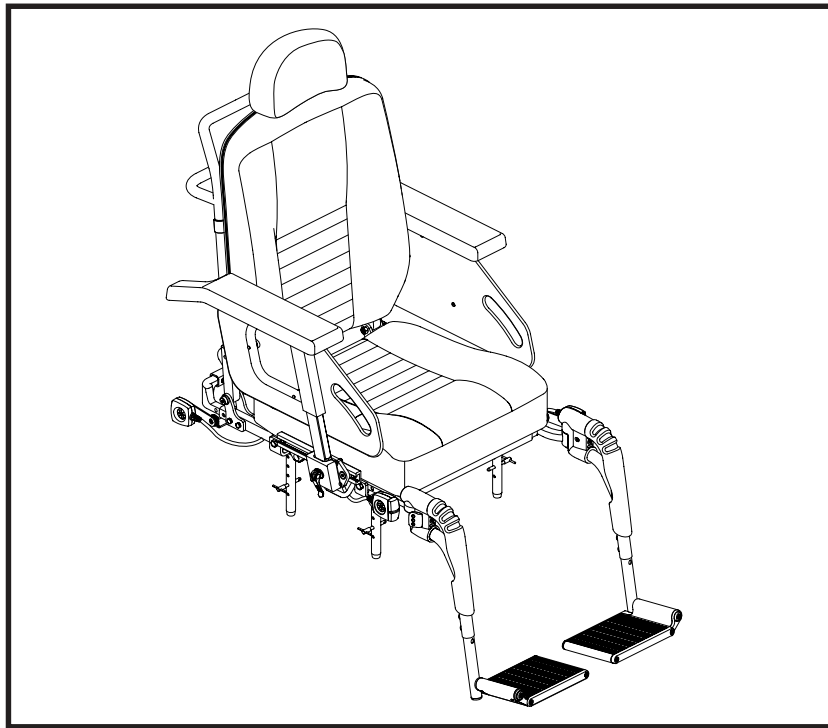

Pride
Mobility Products Corp.

SAFETY GUIDELINES



WARNING! An authorized Pride Provider or a qualified technician must perform the initial setup of this product and must perform all of the instructions in this manual.

The symbols below are used throughout this owner's manual and on the product to identify warnings and important information. It is very important for you to read them and understand them completely.



WARNING! Indicates a potentially hazardous condition/situation. Failure to follow designated procedures can cause either personal injury, component damage, or malfunction. On the product, this icon is represented as a black symbol on a yellow triangle with a black border.



MANDATORY! These actions should be performed as specified. Failure to perform mandatory actions can cause personal injury and/or equipment damage. On the product, this icon is represented as a white symbol on a blue dot with a white border.



PROHIBITED! These actions are prohibited. These actions should not be performed at any time or in any circumstances. Performing a prohibited action can cause personal injury and/or equipment damage. On the product, this icon is represented as a black symbol with a red circle and a red slash.

NOTE: These instructions are compiled from the latest specifications and product information available at the time of publication. We reserve the right to make changes as they become necessary. Any changes to our products may cause slight variations between the illustrations and explanations in this manual and the product you have purchased. The latest/current version of this manual is available on our website.

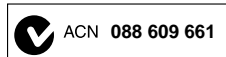

Copyright © 2008
Pride Mobility Products Corporation
INFMANU3621/Rev A/March 2008

Euro Seat System

www.pridemobility.com

TABLE OF CONTENTS

LABEL INFORMATION	4
INTRODUCTION	5
THE EURO SEAT SYSTEM	7
PRECAUTIONARY GUIDELINES	7
COMFORT ADJUSTMENTS	9
CONTROLLER POSITION	20
POSITIONING BELT	22
POWER ACCESSORIES	24
CARE AND MAINTENANCE	25
WARRANTY	25
APPENDIX I - SPECIFICATIONS	26

LABEL INFORMATION

PRODUCT SAFETY SYMBOLS

The symbols below are used on the seating system to identify warnings, mandatory actions, and prohibited actions. It is very important for you to read and understand them completely.



Read and follow the information in the owner's manual.



Avoid exposure to rain, snow, ice, salt, or standing water whenever possible. Maintain and store in a clean and dry condition.



EMI-RFI - This product has been tested and passed at an immunity level of 20 V/m.



Use correct tie-down points for controller harness to prevent the harness from getting caught in the drive tires, pinched in the seat frame, or damaged when passing through doorways.

INTRODUCTION

WELCOME to Pride Mobility Products Corporation (Pride). The product you have purchased combines state-of-the-art components with **safety**, comfort, and styling in mind. We are confident that the design features will provide you with the conveniences you expect during your daily activities. Understanding how to **safely** operate and care for this product should bring you years of trouble free operations and service.

Read and follow all instructions, warnings, and notes in this manual before attempting to operate your product for the first time. You must also read all instructions, warnings, and notes contained in any supplemental instructional booklets for the controller, front riggings, and/or seating system that accompanied your power chair before initial operation. Your **safety** depends upon you, as well as your provider, caretaker, or healthcare professional in using good judgement.

This manual is to be used in addition to the power base owner's manual that came with your power chair. If there is any information in this manual which you do not understand, or if you require additional assistance for setup or operation, please contact your authorized Pride Provider. **Failure to follow the instructions, warnings, and notes in this manual and those located on your Pride product can result in personal injury and/or product damage and will void Pride's product warranty.**

PURCHASER'S AGREEMENT

By accepting delivery of this product, you promise that you will not change, alter, or modify this product or remove or render inoperable or unsafe any guards, shields, or other safety features of this product; fail, refuse, or neglect to install any retrofit kits from time to time provided by Pride to enhance or preserve the safe use of this product.

INFORMATION EXCHANGE

We want to hear your questions, comments, and suggestions about this manual. We would also like to hear about the safety and reliability of your new Pride product, and about the service you received from your authorized Pride Provider. Please notify us of any change of address, so we can keep you apprised of important information about safety, new products, and new options that can increase your ability to use and enjoy your Pride product.

NOTE: If you ever lose or misplace your product registration card or your copy of this manual, contact us and we will be glad to send you a new one immediately.

My Authorized Pride Provider Is:

Name: _____

Address: _____

Phone Number: _____

Purchase Date: _____

THE EURO SEAT SYSTEM

The Euro Seat System is a unique seating system designed specifically for the Pride Power Chair. It is fully adjustable to meet the individual needs of the user, and it is mounted to a Pride power base to provide maximum maneuverability.

Reusable hook and loop fasteners are included in your owner's package for use in attaching the seat cushion to the seat base. These fasteners are not intended for use on cushions with anti-skid material, as they may damage the seat cushion.

Figure 1 provides information on the Euro Seat System components. Use this diagram to familiarize yourself with the function and location of each component before using the Euro Seat System.

PRECAUTIONARY GUIDELINES

Before using the Euro Seat System, please read the following. These guidelines are provided for your benefit and will aid you in the safe operation of the seating system.

- Turn off the power before you are seated in the Euro Seat System.
- Always have assistance when you are being seated in the Euro Seat System.
- Follow all of the procedures and heed the warnings as explained in your power chair owner's manual.

WARNING! Your authorized Pride Provider configured your Euro Seat System to suit your specific requirements. Do not change the original configuration without first contacting your authorized Pride Provider.

WARNING! Should the fittings on your Euro Seat System become loose, report the problem immediately to your authorized Pride Provider.



WARNING! Your Euro Seat System is not approved for use as a seat in any vehicle. Use the seats and occupant restraints provided by the manufacturer of the vehicle.

WARNING! Do not exceed the weight capacity listed in your power chair owner's manual or 136 kg (300 lbs.), whichever is less.

WARNING! Extreme temperatures can affect the temperature of Euro Seat System components and may cause skin irritation. Use caution when your power chair has been used or stored in an extremely hot or cold environment.

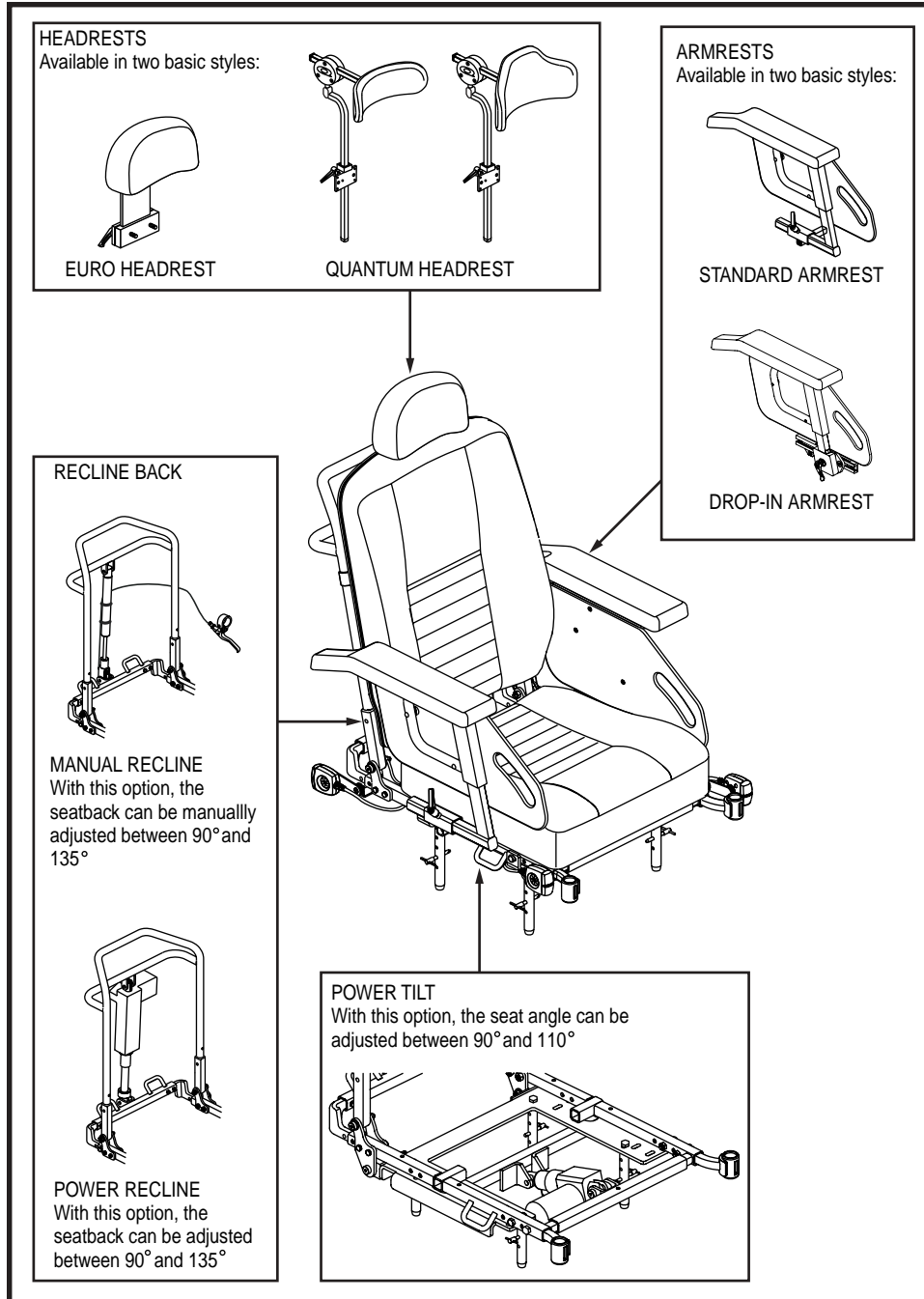

Figure 1. Euro Seat System and Options

COMFORT ADJUSTMENTS

There are several adjustments that can be made to the Euro Seat System to increase your comfort, such as seat height and angle, armrest position, and controller position.



WARNING! Some power chair components are heavy. You may need assistance to lift or carry them. Please refer to the specifications table for specific component weights before you disassemble the power chair.

WARNING! Remove the occupant from the power chair before making any adjustments.

WARNING! Be sure that the controller's power is turned off and the power chair is not in freewheel mode before performing any adjustment procedures.

You may need the following to make comfort adjustments:

- metric/standard socket set and ratchet
- adjustable wrench
- metric/standard hex key set

Seat Height and Angle Adjustment

The Euro Seat System is usually connected to a power base with four steel towers. You can change the seat height by raising these towers. If you raise or lower only one set of seat towers (front or rear), you can also change the seat base angle.

NOTE: If your Euro Seat is mounted on a Vibe/R-4000/1120RWD Euro power base, contact your authorized Pride Provider for information on adjusting the seat height and angle.

To change the seat height or seat angle:

1. Remove the retaining pin from each of the four seat mount connectors. See figure 2.
2. Raise or lower each seat tower to the desired position. To change the angle, set either the front or rear seat towers higher or lower than the other.
3. Reinstall the retaining pin into each seat mount connector.

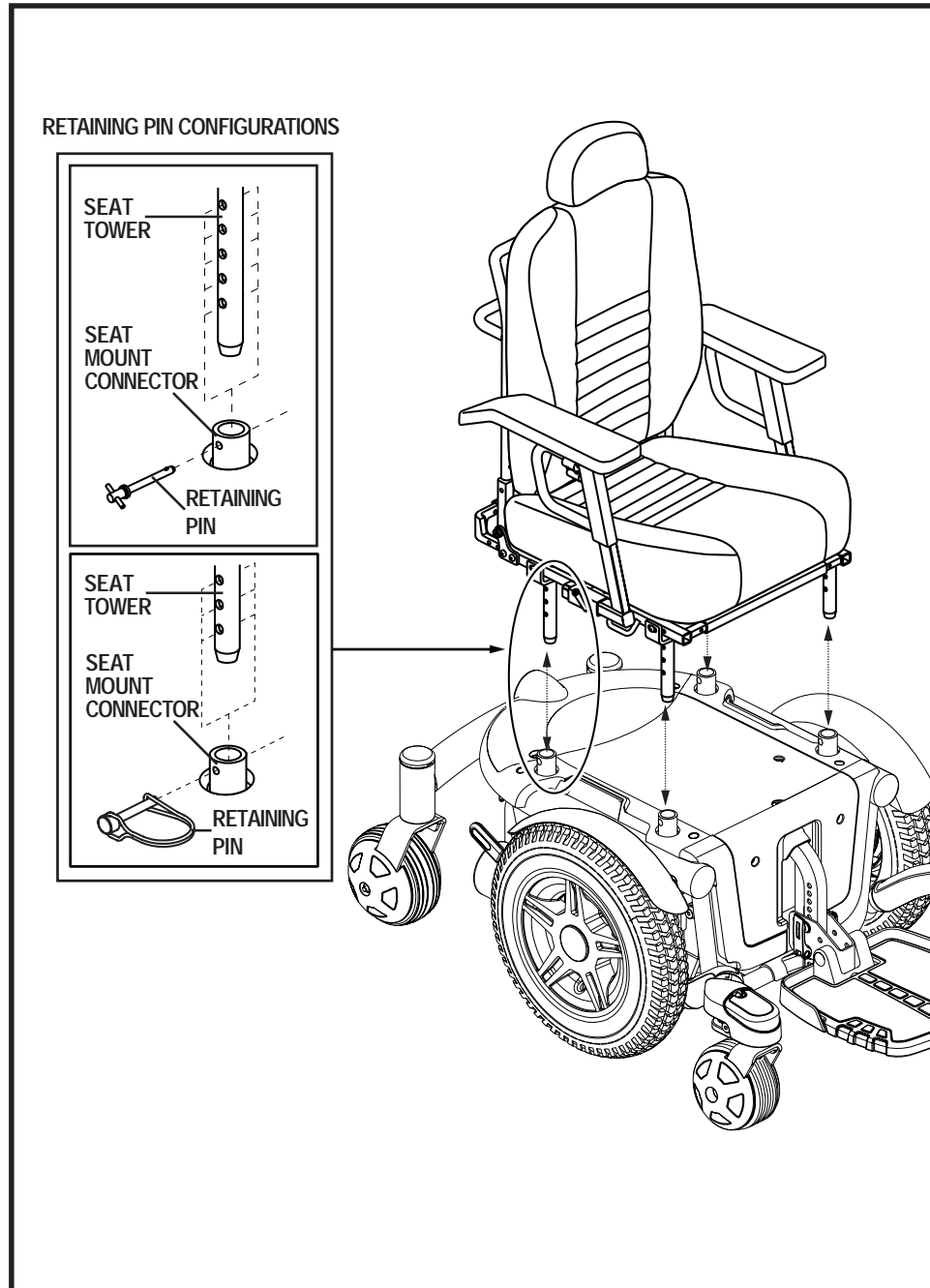

Figure 2. Seat Height/Angle Adjustment (Standard Configuration)

Manual Recline Seatback Adjustment

Your seat may be equipped with a manual recline lever that allows you to adjust the seatback angle from the minimum recline position (90° from the seat base) to the maximum recline position (135° from the seat base). See figures 3 and 4.

To adjust the seatback angle:

1. With your back pressed firmly against the seatback, squeeze the manual recline lever mounted to the armrest. See figure 3.
2. Set the seatback at the desired angle by leaning forward or back.
3. Release the manual recline lever when the seatback is at the desired angle.

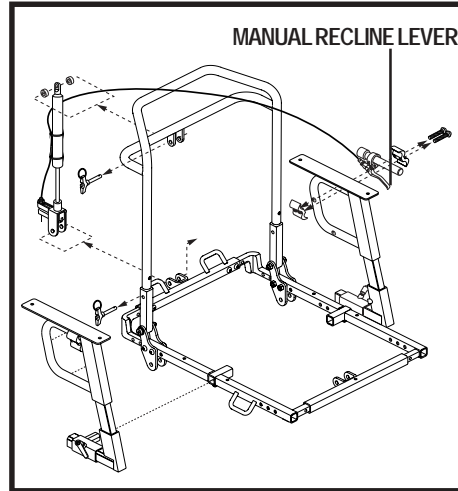

Figure 3. Manual Recline Seatback Adjustment

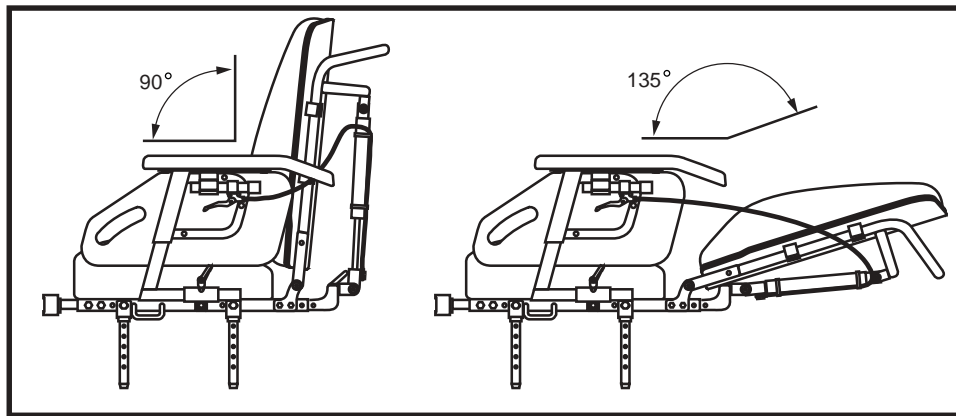

Figure 4. Minimum and Maximum Manual Recline Angles



WARNING! Do not attempt to lift or move your power chair or seating system by any of its removable parts, including the armrests, front riggings, seat cushions, seatback, shrouds, or controller. Use only solid, non-removable frame components to lift or move your power chair or seating system.

WARNING! Avoid putting all of your weight on the Euro Seat armrests and do not use the armrests for weight bearing purposes, such as transfers. Such use may cause the power chair to tip, resulting in a fall from the power chair and personal injury.

Armrest Position Adjustment

The armrest position can be adjusted forward or back for operator comfort.

To adjust the armrest position:

1. Loosen the armrest receiver lock lever. See figure 5.
2. Slide the armrest forward or back to the desired position.
3. Tighten the armrest receiver lock to secure the armrest in the desired position.

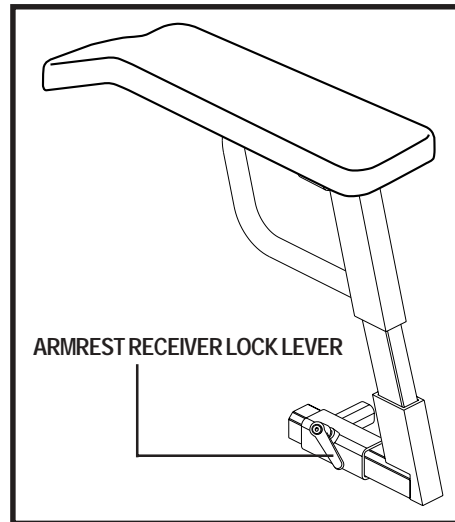

Figure 5. Armrest Position Adjustment

Armrest Width Adjustment

The armrest width can be adjusted for operator comfort.

To adjust the armrest width:

1. Loosen the securement screw located on the bottom of the armrest receiver bracket. See figure 6.
2. Slide the armrest in or out to the desired position.
3. Tighten the screw to secure the armrest.

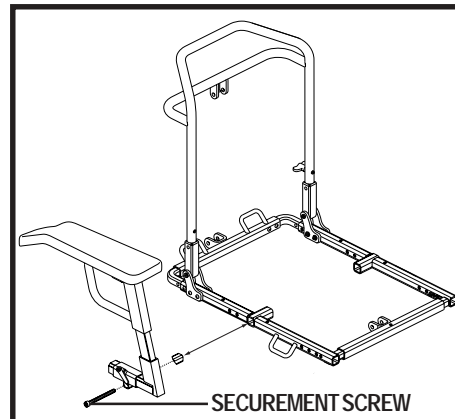

Figure 6. Armrest Width Adjustment

Armrest Height Adjustment

You can adjust the armrest height to one of four positions in either 1,27 cm (0,50 in.) or 2,5 cm (1 in.) increments.

To adjust the height in 1,27 cm (0,50 in.) increments:

1. Remove the height adjustment screw from the armrest. See figure 7.
2. Raise or lower the upper armrest.
3. Align the adjustment holes in the lower armrest with the bottom hole in the upper armrest.
4. Reinstall the screw to secure the armrest.

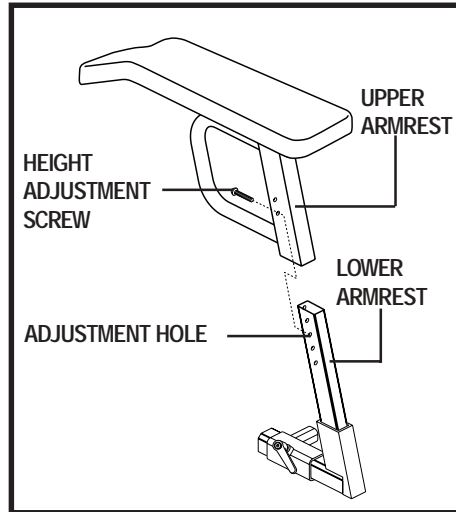

Figure 7. Armrest Height Adjustment

To adjust the height in 2,5 cm (1 in.) increments:

1. Remove the height adjustment screw from the armrest. See figure 7.
2. Raise or lower the armrest.
3. Align the adjustment holes in the lower armrest with the top hole in the upper armrest.
4. Reinstall the screw to secure the armrest.

Armrest Pad Position Adjustment

The armrest pad position can be adjusted forward or back an overall distance of 5 cm (2 in.) and left to right an overall distance of 2,5 cm (1 in.).

NOTE: *Both the standard and drop-in armrest pads are adjusted in the same manner as described below.*

To adjust the forward/back armrest pad position:

1. Remove each adjustment screw from the underside front and back of the armrest pad. See figure 8.
2. Move the pad forward or back to the desired position.
3. Align the adjustment holes in the armrest pad and the armrest pad receiver.
4. Reinstall the screws to secure the armrest pad.

To adjust the left to right armrest pad position:

1. Remove each adjustment screw from the underside front and back of the armrest pad. See figure 8.
2. Move the pad left or right to the desired position.
3. Align the adjustment holes in the armrest pad and the armrest pad receiver.
4. Reinstall the screws to secure the armrest pad.

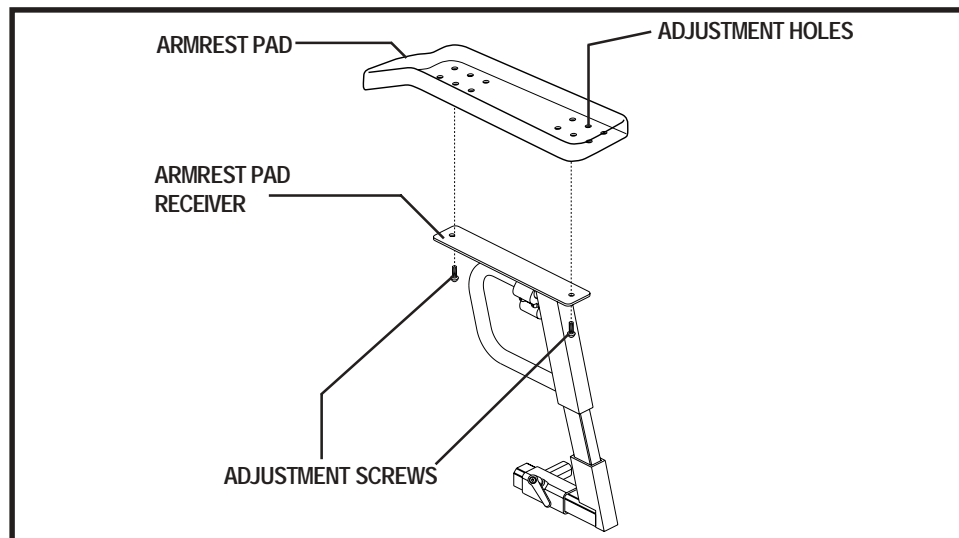

Figure 8. Armrest Pad Position Adjustment

Drop-in Armrest Position Adjustment

The drop-in armrest position can be adjusted forward or back for operator comfort.

To adjust the drop-in armrest position:

1. Remove the two screws from the armrest receiver bracket. See figure 9.
2. Slide the armrest forward or back to the desired position.
3. Reinstall the two screws into the armrest receiver bracket.

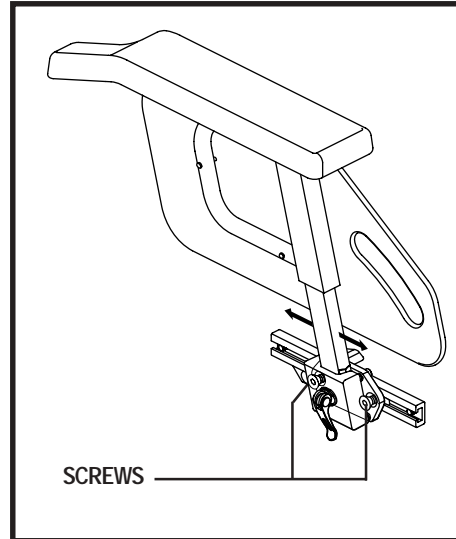

Figure 9. Drop-in Armrest Position Adjustment

Drop-in Armrest Width Adjustment

To adjust the drop-in armrest width:

1. Loosen the securement screw located on the bottom of the armrest receiver bracket. See figure 10.
2. Slide the armrest in or out to the desired position.
3. Tighten the screw to secure the armrest.

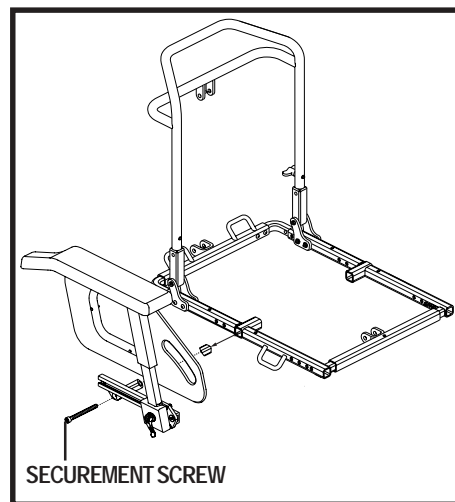

Figure 10. Armrest Width Adjustment

Drop-in Armrest Height Adjustment

You can adjust the drop-in armrest height to one of four positions in either 1,27 cm (0,50 in.) or 2,5 cm (1 in.) increments.

To adjust the height in 1,27 cm (0,50 in.) increments:

1. Remove the height adjustment screw from the armrest. See figure 11.
2. Raise or lower the upper armrest.
3. Align the adjustment hole in the lower armrest with the bottom hole in the upper armrest.
4. Reinstall the screw to secure the armrest.

To adjust the height in 2,5 cm (1 in.) increments:

1. Remove the height adjustment screw from the armrest. See figure 11.
2. Raise or lower the armrest.
3. Align the adjustment hole in the lower armrest with the top hole in the upper armrest.
4. Reinstall the screw to secure the armrest.

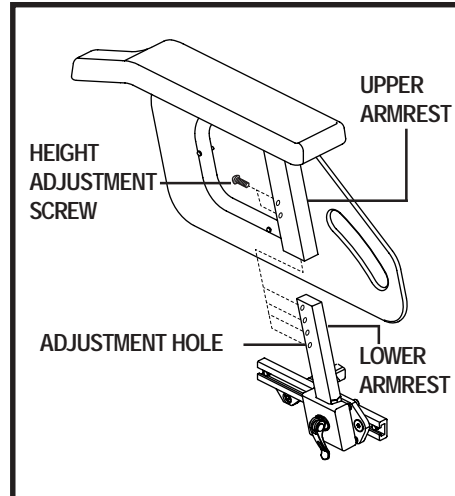

Figure 11. Armrest Height Adjustment

Drop-in Armrest Removal

You can easily remove the drop-in armrests for assistance in transporting or transferring onto or off of your power chair.

To remove the drop-in armrests:

1. Loosen the armrest receiver lock lever. See figure 12.
2. Remove the drop-in armrest.

Headrest Adjustment

Your seat is equipped with either a Euro-style or Quantum-style headrest.

To adjust the Euro-style headrest height:

1. Loosen the headrest receiver lock lever. See figure 13.
2. Slide the headrest up or down to the desired position.
3. Tighten the headrest receiver lock lever to secure the headrest to the desired position.

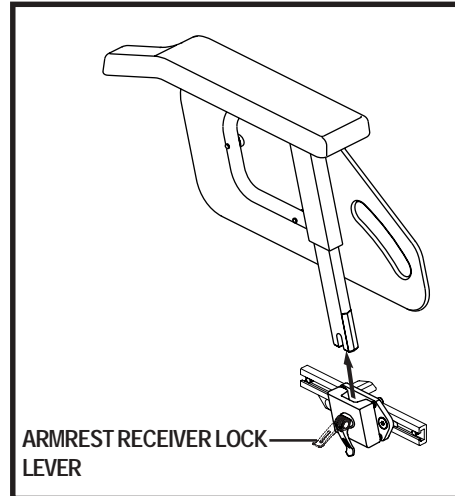

Figure 12. Armrest Removal

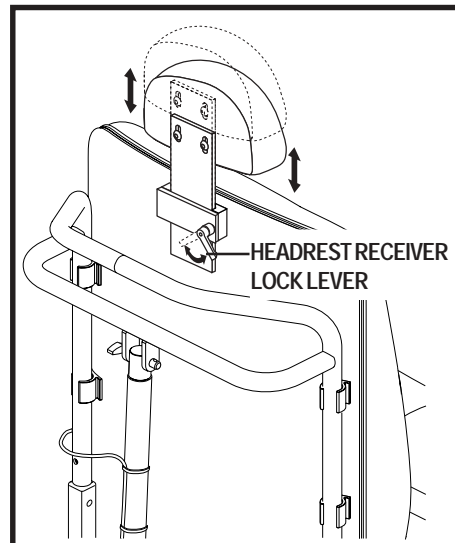

Figure 13. Euro-style Headrest Height Adjustment

To adjust the Quantum-style headrest height:

1. Loosen the height adjustment lever. See figure 14.
2. Position the headrest to the desired height.
3. Tighten the height adjustment lever.

To adjust the Quantum-style headrest horizontal angle, vertical angle, and headrest depth:

1. Loosen the three adjustment screws as necessary for desired movement. See figure 14.
2. Adjust the headrest to the desired position.
3. Tighten the three adjustment screws.

To swivel the Quantum-style headrest:

1. Pull the rubber cover back. See figure 14.
2. Loosen the two headrest angle adjustment screws. See figure 14.
3. Swivel the headrest to the desired angle.
4. Tighten the two headrest angle adjustment screws.
5. Replace the rubber cover.

NOTE: Once adjustments have been made and the headrest is in the desired position, make sure that all of the hardware is tight.

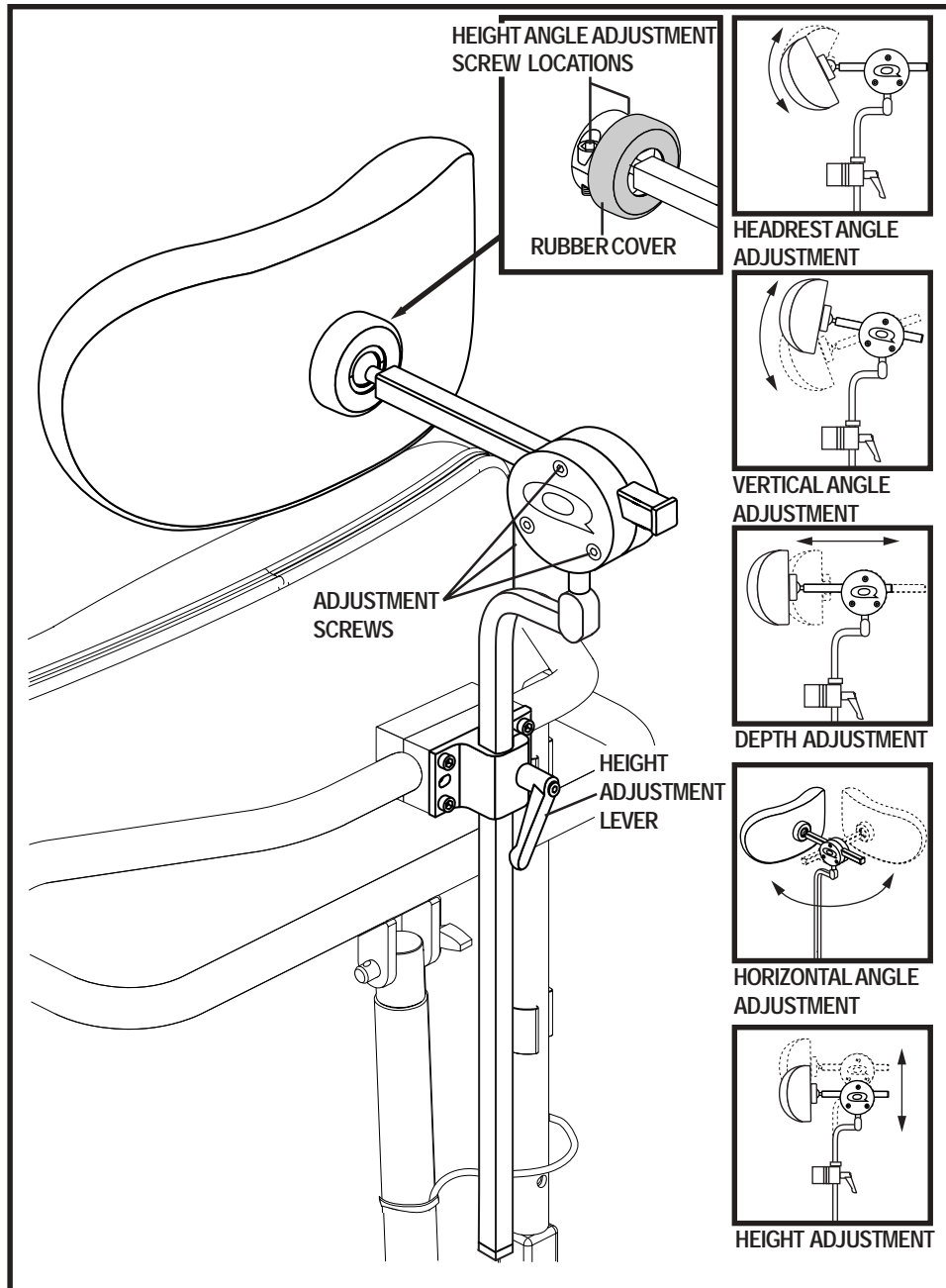

Figure 14. Quantum-style Headrest Adjustments

CONTROLLER POSITION

You can position the controller for either left-hand or right-hand use. You can also adjust the extension of the controller from the armrest.



MANDATORY! Use correct tie-down points for controller harness to prevent the harness from getting caught in the drive tires, pinched in the seat frame, or damaged when passing through doorways.

To change the controller position:

1. Turn off the power to the controller.
2. Unplug the controller connector(s) from the power base. Refer to the power base owner's manual.
3. Remove any wire ties securing the controller cable to the Euro Seat.
4. Loosen the socket head screws on the figure 8 clamp assembly located on the armrest. See figure 15.
5. Slide the controller out of the loosened clamp assembly.
6. Loosen the socket head screws on the clamp assembly on the other armrest.
7. Remove the manual recline lever assembly and insert it into the clamp assembly on the opposite armrest.
8. Tighten the socket head screws to secure the manual recline lever assembly in the figure 8 clamp.
9. Insert the controller into the remaining open clamp assembly.
10. Tighten the socket head screws to secure the controller in the figure 8 clamp.
11. Route the controller cable to the back of the power base and reconnect the controller. See figure 16.
12. Use wire ties to secure the controller cable and the manual recline lever cable to the armrest.

To change the controller extension:

1. Turn off the power to the controller.
2. Loosen the socket head screws on the figure 8 clamp assembly located on the armrest. See figure 15.
3. Slide the controller into or out of the clamp assembly to the desired position.
4. Tighten the socket head screws to secure the controller in the figure 8 clamp assembly.

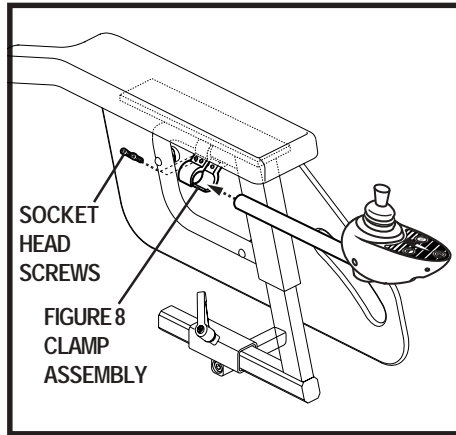

Figure 15. Controller Position Adjustment

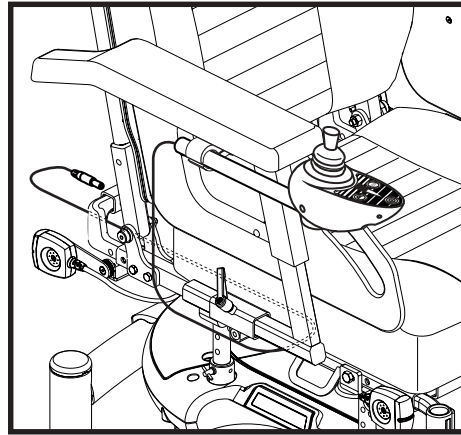

Figure 16. Cable Routing

POSITIONING BELT

Your Euro Seat may be equipped with a positioning belt that can be adjusted for operator comfort. See figure 17. The positioning belt is designed to support the operator so that he/she does not slide down or forward in the seat. The positioning belt is not designed for use as a restraining device in a motor vehicle.

To install the positioning belt:

1. Insert the button head socket cap screw through the washer and the mounting tab at the end of the positioning belt.
2. Install the screw through the spacer and the large black plastic spacer, then insert the screw through the seat base rail at the rear of the seat.
3. Install the nylon insert lock nut to the assembly, and then tighten the screw and nut.
4. Repeat steps 1-3 for the other side.

To adjust the positioning belt for operator comfort:

1. Once seated, insert the metal tab on one side of the belt into the plastic housing on the opposite side until you hear a click. See figure 17.
2. Pull the excess strap attached to the metal tab until it is secure, but not so tight as to cause discomfort.

To release the positioning belt:

1. Press the push button mechanism on the plastic housing.



MANDATORY! Make sure the positioning belt is properly secured to the power chair and is adjusted for operator comfort before each use.

MANDATORY! Inspect the positioning belt for loose or damaged parts before each use of the power chair. If you discover a problem, contact your authorized Pride Provider for maintenance and repair.

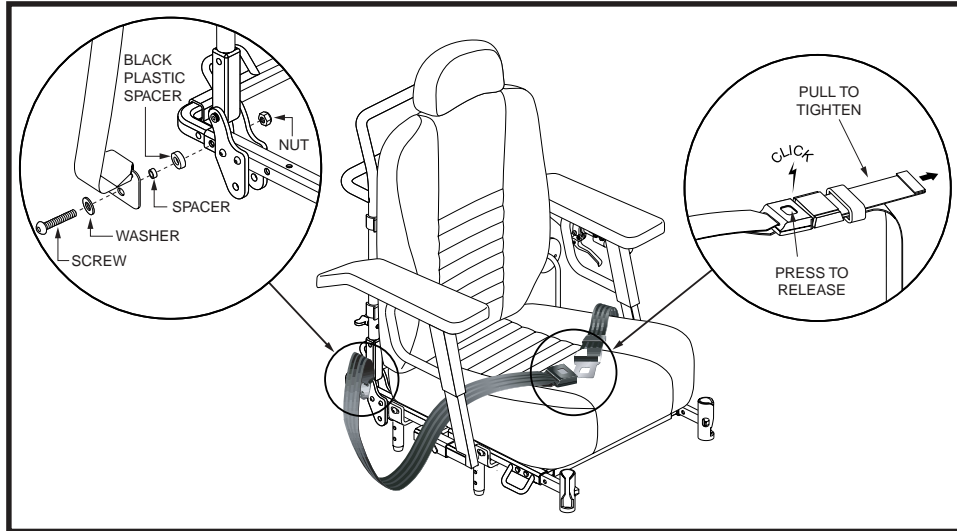

Figure 17. Positioning Belt Attachment

POWER ACCESSORIES

Your Euro Seat System may be equipped with optional power positioning such as a power tilt, power recline, and power front riggings. Refer to the supplemental controller information supplied with your power chair owner's manual for instructions on how to operate power accessories. See figures 18 and 19 for range of motion of the power tilt and recline.

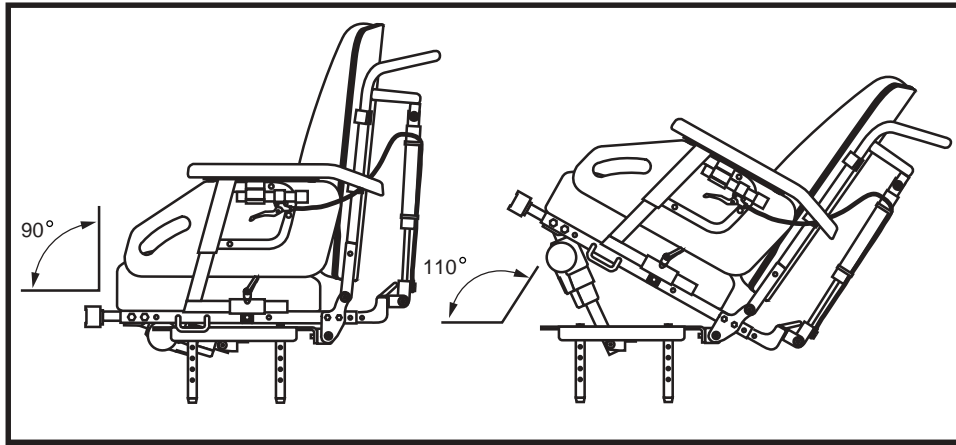

Figure 18. Euro Seat Power Tilt Range of Motion

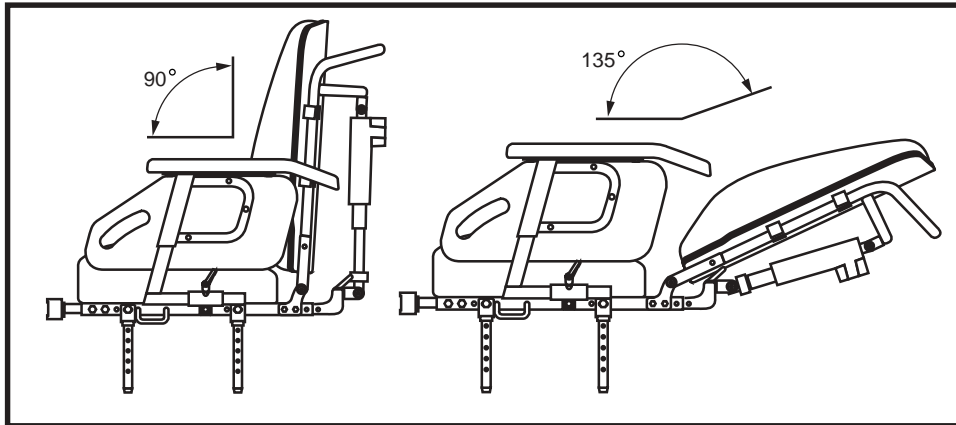

Figure 19. Euro Seat Power Recline Range of Motion

NOTE: When the seat is tilted or reclined past 110°, an inhibit switch will cut power to the motors of your power chair. Returning the seat to an angle of less than 110° degrees will restore power to the motors.

CARE AND MAINTENANCE

- Make sure all hardware is secured properly, but do not overtighten any hardware.
- To clean the Euro Seat System, wipe it with a cloth dampened with mild soap and water. Thoroughly dry the unit before using.



PROHIBITED! Avoid exposure to rain, snow, ice, salt, or standing water whenever possible. Maintain and store in a clean and dry condition.

WARNING! Pride strongly recommends that you do not smoke cigarettes while seated in your Euro Seat System, although the seating system has passed the necessary testing requirements for cigarette smoking. You must adhere to the following safety guidelines if you decide to smoke cigarettes while seated in your seating system.



- Do not leave lit cigarettes unattended.
- Keep ashtrays a safe distance from the seat cushions.
- Always make sure cigarettes are completely extinguished before disposal.

WARNING! Never use any chemicals to clean a vinyl seat, as they may cause the seat to become slippery or dry out and crack. Use soapy water and dry the seat thoroughly.

WARRANTY

Refer to your power base owner's manual for warranty information.

APPENDIX I - SPECIFICATIONS

Euro Seat Specifications Table	
Seat Weight:	Manual Recline: 26 kg (57,5 lbs.) Power Tilt: 17 in. seat: 32 kg (71,5 lbs.) 19 in. seat: 34 kg (75,5 lbs.) Power Recline: 28 kg (62 lbs.) Power Tilt/Power Recline: 17 in. seat: 34 kg (75,5 lbs.) 19 in. seat: 36 kb (79 lbs.)
Seat Dimensions:	17 in. x 17 in., 19 in. x 19 in.
Back Height:	22 in.
Seat Upholstery:	Vinyl
Armrests:	Standard Drop-in (optional)
Headrests:	Euro-style Quantum Headrest (optional; 2 styles)
Weight Capacity:	136 kg (300 lbs.)

NOTES



Pride Mobility Products Corporation

182 Susquehanna Avenue
Exeter, PA 18643-2694
USA

Pride Mobility Products Company

380 Vansickle Road Unit 350
St. Catharines, Ontario L2R 6P7
Canada

Pride Mobility Products Ltd.

32 Wedgwood Road
Bicester, Oxon OX26 4UL
UK

Pride Mobility Products Australia Pty. Ltd.

21 Healey Road
Dandenong, 3175
Victoria, Australia

Pride Mobility Products Italia S.r.l.

Via del Progresso - ang. Via del Lavoro
Loc. Prato della Corte
00065-Fiano Romano (RM)

Pride Mobility Products Europe B.V.

Tijnmuiden 28
1046 AL Amsterdam
The Netherlands

www.pridemobility.com www.prideservice.com www.prideprovider.com

* I NFMANU3621 *