

INSTALLATION AND CARE INSTRUCTIONS

Synergy[®] Shape GP

ACN# 088 609 661

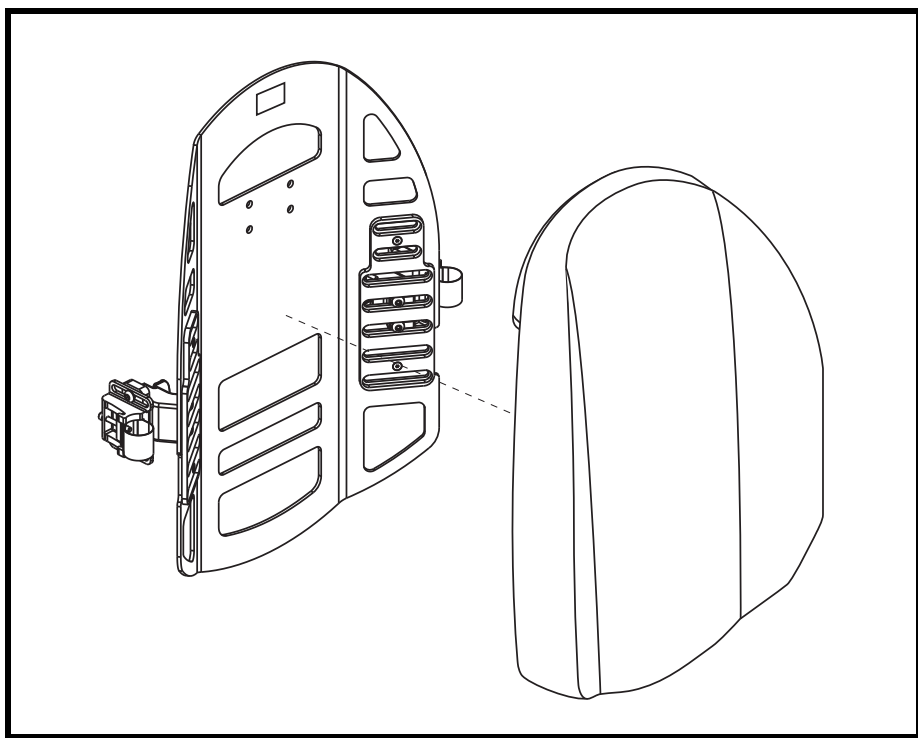

QUANTUM[®]
REHAB

A Division of Pride Mobility Products[®] Corp.

SAFETY GUIDELINES



WARNING! A Quantum Rehab Provider or a qualified technician must perform the initial setup of this product and must perform all of the instructions in this manual.

The symbols below are used throughout this owner's manual and on the product to identify warnings and important information. It is very important for you to read them and understand them completely.



WARNING! Indicates a potentially hazardous condition/ situation. Failure to follow designated procedures can cause either personal injury, component damage, or malfunction. On the product, this icon is represented as a black symbol on a yellow triangle with a black border.



MANDATORY! These actions should be performed as specified. Failure to perform mandatory actions can cause personal injury and/or equipment damage. On the product, this icon is represented as a white symbol on a blue dot with a white border.



PROHIBITED! These actions are prohibited. These actions should not be performed at any time or in any circumstances. Performing a prohibited action can cause personal injury and/or equipment damage. On the product, this icon is represented as a black symbol with a red circle and a red slash.

NOTE: These instructions are compiled from the latest specifications and product information available at the time of publication. We reserve the right to make changes as they become necessary. Any changes to our products may cause slight variations between the illustrations and explanations in this manual and the product you have purchased. The latest/ current version of this manual is available on our website.

NOTE: This product is compliant with WEEE, RoHS, and REACH directives and requirements.

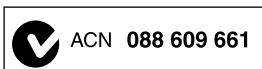

Copyright © 2010
Pride Mobility Products Corporation
INFMANU3963/Rev A/May 2010

TABLE OF CONTENTS

LABEL INFORMATION	4
INTRODUCTION	5
THE SHAPE GP	7
SHAPE GP INSTALLATION	9
COMFORT ADJUSTMENTS	12
REMOVING THE SHAPE GP	14
CLEANING	15
STORAGE	16
CARE AND MAINTENANCE	16
WARRANTY	17

LABEL INFORMATION

PRODUCT SAFETY SYMBOLS

The symbols below are used on the product to identify warnings, mandatory actions, and prohibited actions. It is very important for you to read and understand them completely.



Read and follow the information in the owner's manual.



Maximum seating weight.



Disposal and recycling - Contact your Quantum Rehab Provider for information on proper disposal and recycling of your Pride product and its packaging.



Maximum washing temperature 140°F (60°C)



Do not tumble dry.



Do not iron.



Do not expose to heat sources such as open flame or sparks.



No smoking.

INTRODUCTION

WELCOME to Quantum Rehab, a division of Pride Mobility Products (Pride). The product you have purchased combines state-of-the-art components with **safety**, comfort, and styling in mind. We are confident that the design features will provide you with the conveniences you expect during your daily activities. Understanding how to **safely** use and care for this product should bring you years of trouble free operations and service.

Read and follow all instructions, warnings, and notes in this manual before attempting to operate your product for the first time. You must also read all instructions, warnings, and notes contained in any supplemental instructional booklets for the controller, front riggings, and/or seating system that accompanied your mobility product before initial operation. Your **safety** depends upon you, as well as your provider, caretaker, or healthcare professional in using good judgement.

This manual is to be used in addition to the owner's manual that came with your chair. If there is any information in this manual which you do not understand, or if you require additional assistance for setup or operation, please contact your Quantum Rehab Provider. **Failure to follow the instructions, warnings, and notes in this manual and those located on your Pride product can result in personal injury and/or product damage and will void Pride's product warranty.**

PURCHASER'S AGREEMENT

By accepting delivery of this product, you promise that you will not change, alter, or modify this product or remove or render unusable or unsafe any guards, shields, or other safety features of this product; fail, refuse, or neglect to install any retrofit kits from time to time provided by Pride to enhance or preserve the safe use of this product.

INFORMATION EXCHANGE

We want to hear your questions, comments, and suggestions about this manual. We would also like to hear about the safety and reliability of your new Pride product, and about the service you received from your Quantum Rehab Provider. Please notify us of any change of address, so we can keep you apprised of important information about safety, new products, and new options that can increase your ability to use and enjoy your Pride product.

Please feel free to contact us at the address below:

Pride Mobility Products Corporation
Attn: Customer Care Department
182 Susquehanna Avenue
Exeter, PA 18643-2694

NOTE: If you ever lose or misplace your product registration card or your copy of this manual, contact us and we will be glad to send you a new one immediately.

My Quantum Rehab Provider Is:

Name: _____

Address: _____

Phone Number: _____

Purchase Date: _____

THE SHAPE GP

The Shape GP is a unique seatback system that is available with an adjustable mounting system to accommodate user comfort and positioning needs.

Figures 1, 2, and 3 provide information on the Shape GP components and cushions.

Use these diagrams to familiarize yourself with the function and location of each component before using the Shape GP.



MANDATORY! Do not exceed the weight capacity listed in your mobility product owner's manual or 300 lbs. (136 kg), whichever is less, including accessories.



WARNING! This product is not rated for use with a power or manual tilt system.

WARNING! This product is not rated for use in conjunction with any crash tested unit per ANSI-RESNA WC/Vol. 4 Section 19 or ISO 7176-19 standards.

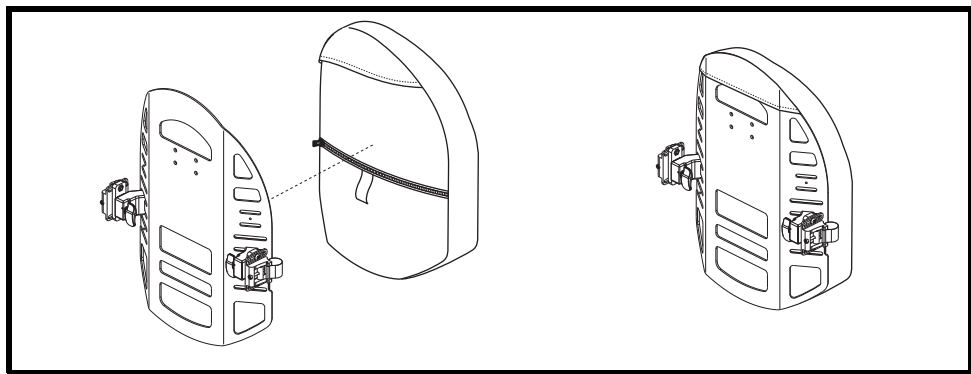

Figure 1. Shape GP Cushion

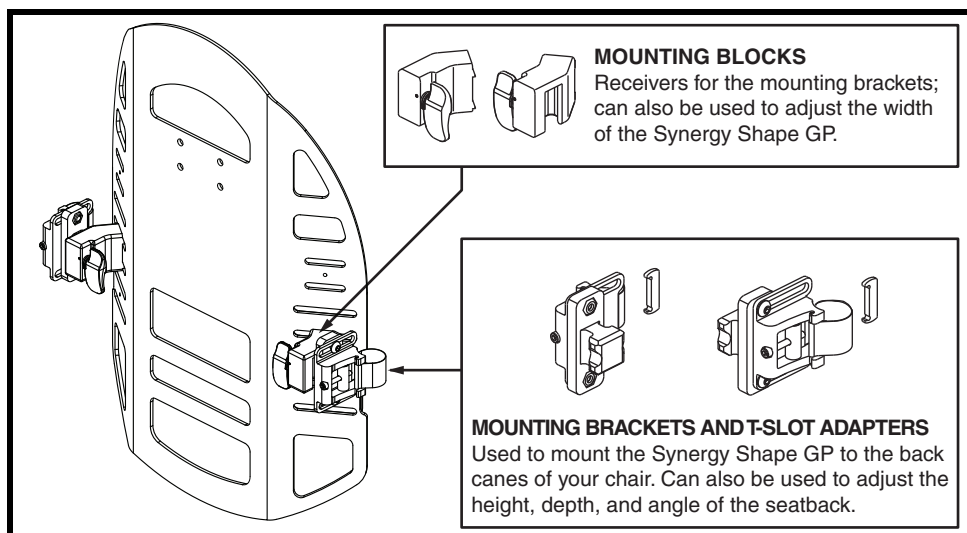

Figure 2. Shape GP - Mounting Bracket Components

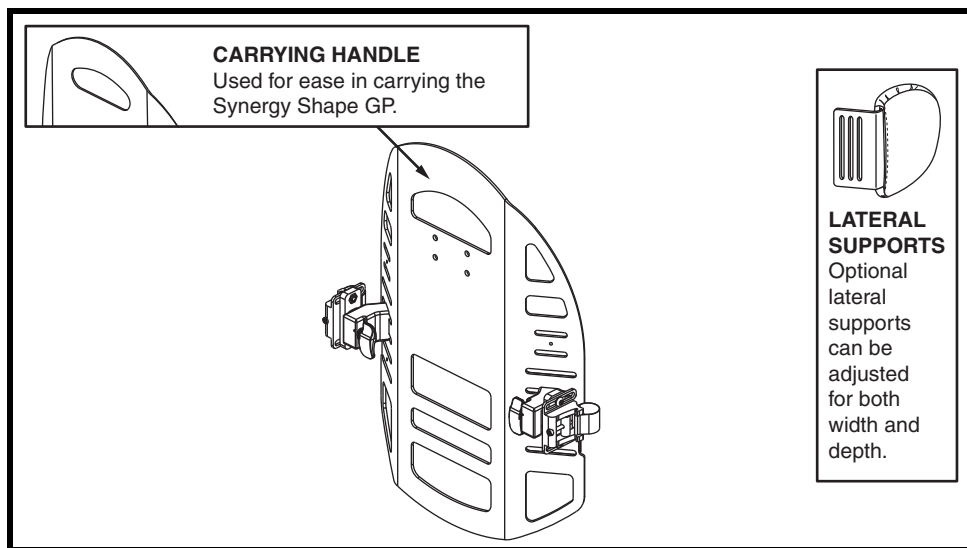

Figure 3. Shape GP - Back and Lateral Components

SHAPE GP INSTALLATION

To install the Shape GP:

1. Hold the Shape GP up to the desired height on the back canes and make note of where the mounting brackets will be located.
2. Install the T-slot adapter if necessary (for slotted canes).
3. Starting on the inside of the back cane that faces the center of the chair, wrap the mounting band around the outside of the back cane. Fasten the mounting pin on the mounting band into the slot on the receiver. **See figure 4.**
4. Tighten the mounting screw.
5. Repeat for the other side.



WARNING! Ensure the hardware is tight.

6. Once the mounting brackets are in place, stand behind the chair and align the mounting blocks on the seatback with the mounting brackets making sure that the seatback is positioned just inside the “L” of the mounting block. **See figure 5.** Push the seatback downward until it clicks into place.
7. Install the Shape GP cushion.

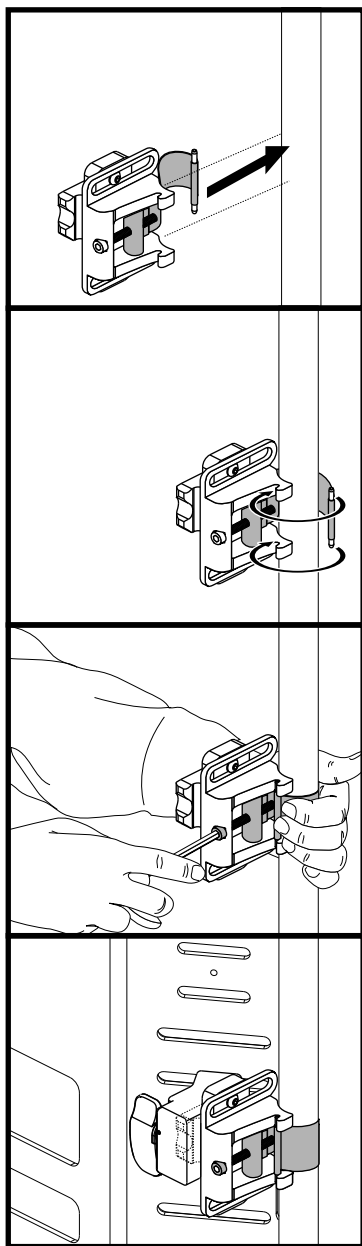

Figure 4. Mounting Bracket Installation on Solid Canes

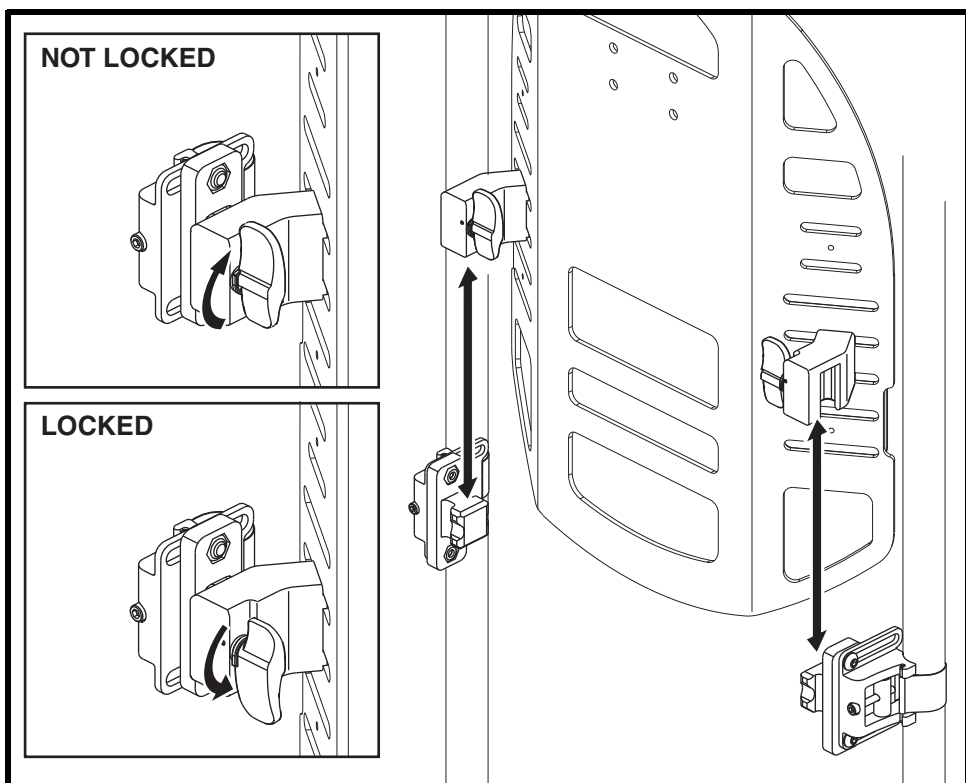

Figure 5. Installing the Shape GP

NOTE: The seatback width adjustment range is 2 in. (5 cm) to accommodate different chair widths.

To adjust for different chair widths:

1. Loosen the positioning screws in the mounting block. **See figure 6.**
2. Slide the mounting blocks closer to the edge of the seatback for wider chairs and closer to the middle of the seatback for narrower chairs. **See figure 6.**
3. Tighten the positioning screws in the mounting block.
4. Repeat for the other side.

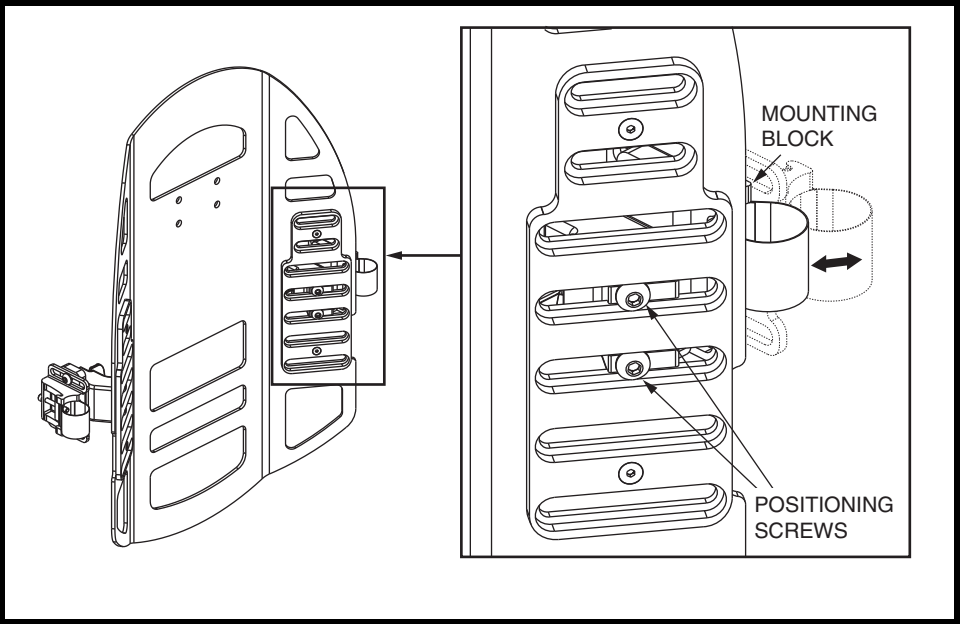

Figure 6. Seatback Width Adjustment

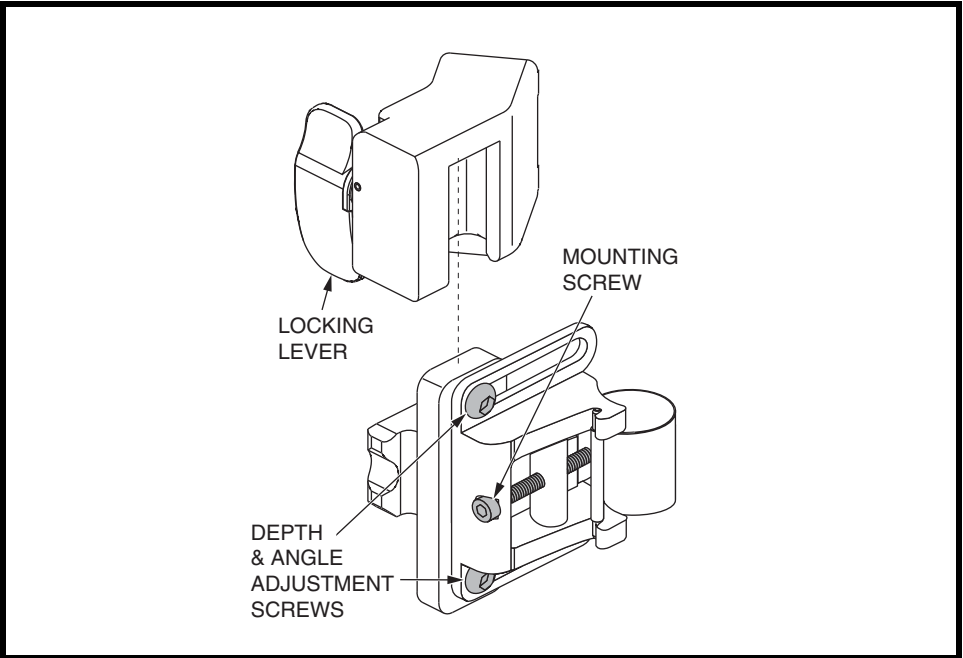

Figure 7. Mounting Components

COMFORT ADJUSTMENTS

Once you are familiar with the operation of your chair, there are adjustments you can make to your Shape GP to increase your comfort, like seatback depth, recline angle, and seatback height. See figures 7, 8, 9, and 10.

WARNING! If your Shape GP was configured by your Quantum Rehab Provider, please consult your healthcare professional before changing the position of your Shape GP.



WARNING! While Pride recommends that comfort adjustments be made without the occupant in the chair, it is possible to adjust the seatback depth and recline angle with the occupant in the chair so that the required changes can be made for positioning requirements and optimal user comfort. The occupant must be removed before making changes to the seatback height and seatback width.

Seatback Depth

The seatback depth adjustment range is 2 in. (5 cm).

To change seatback depth:

1. Loosen both depth adjustment screws. See figure 8.
2. Position the seatback to the desired depth.
3. Tighten both depth adjustment screws.



WARNING! When adjustments are complete, be sure both depth adjustment screws are tight.

Recline Angle

The recline angle can be adjusted from -33° to 57°.

To increase the recline or precline angle:

1. Loosen the angle adjustment screw on each mounting block. See figure 9.
2. Position the seatback to the desired angle.
3. Tighten the angle adjustment screw on each mounting block.



WARNING! When adjustments are complete, be sure both angle adjustment screws are tight.

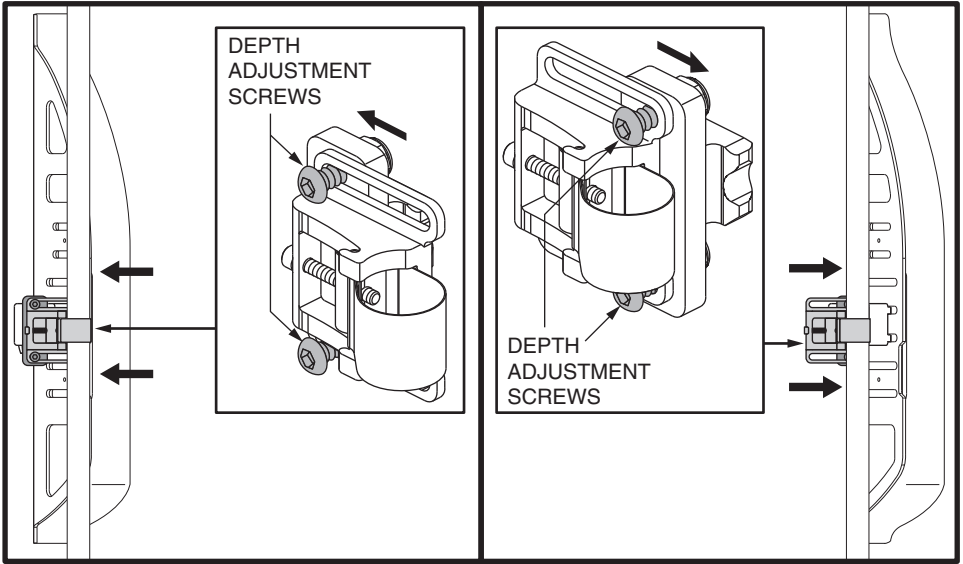

Figure 8. Seatback Depth Adjustment

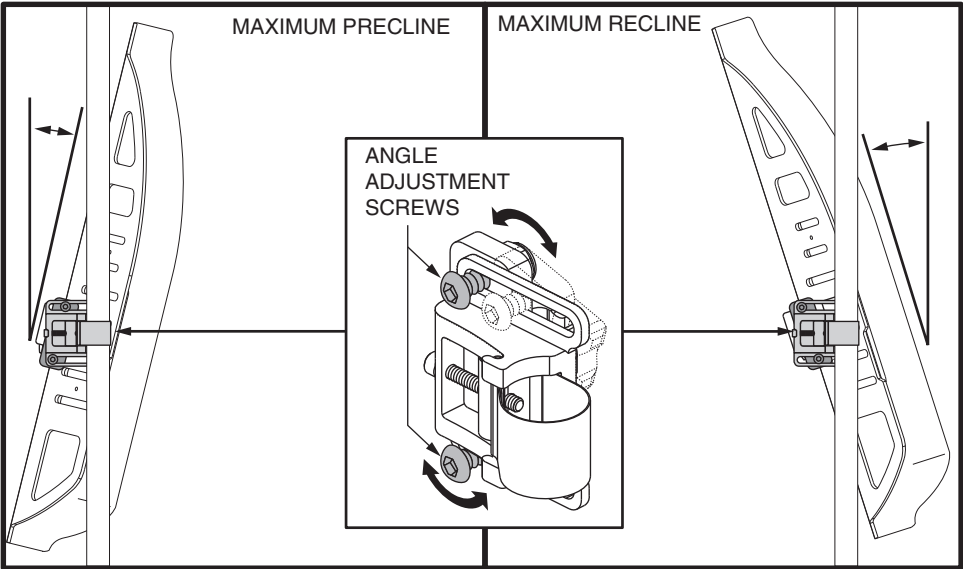

Figure 9. Maximum Recline and Preline Angle Adjustment

Seatback Height

The seatback height adjustment range depends on the length of your back canes.



WARNING! The occupant must be removed from the chair before adjusting the seatback height.

To adjust the seatback height:

1. Set the wheel lock or turn the controller off, if equipped.
2. Loosen the mounting screw on each mounting bracket.
3. Position the seatback to the desired height. **See figure 10.**
4. Tighten the mounting screws.



WARNING! When adjustments are complete, be sure to tighten both mounting screws.

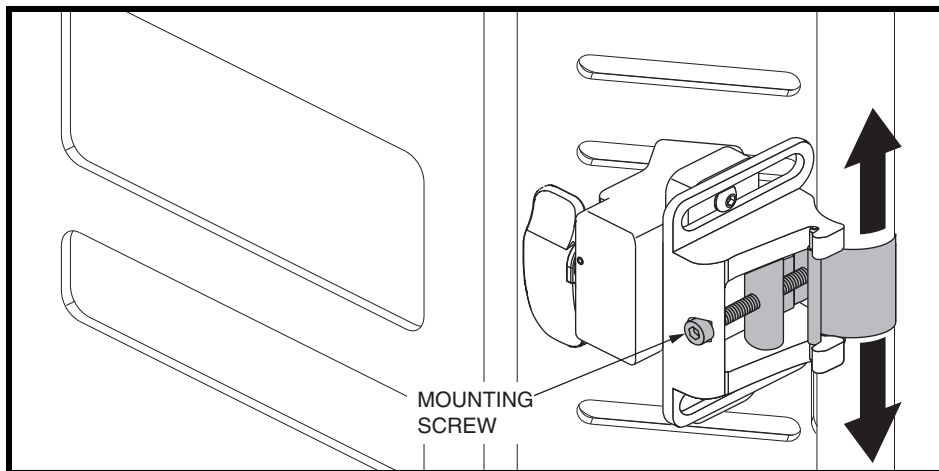

Figure 10. Seatback Height Adjustment

REMOVING THE SHAPE GP

Your Shape GP can be easily removed using the quick-release system.



WARNING! Do not attempt to remove the Shape GP when the chair is occupied.

To remove the Shape GP:

1. Set the wheel lock or turn the controller off, if equipped.
2. Unlock both release levers and lift the Shape GP up and off of the chair. **See figure 5.**

CLEANING

The Shape GP can be easily cleaned.

To clean the Shape GP:

1. Locate the zipper on the back side of the outer cover. See figure 11.
2. Unzip the cover and pull out the inner cushion.
3. Wash the outer cover in a washing machine on the COLD setting.

WARNING! Do not use bleach when washing the cover.



WARNING! Never submerge the inner cushion of your Shape GP in water. The inner cushion is protected by a fluid-resistant cover, but it is not intended for direct exposure to water.

4. Allow the outer cover to air dry.



WARNING! Do not attempt to put the outer cover in a dryer. This may cause shrinking.

5. Once dry, put the inner cushion back inside the cover. Zip the cover closed, and replace the Shape GP onto the seat of your chair.

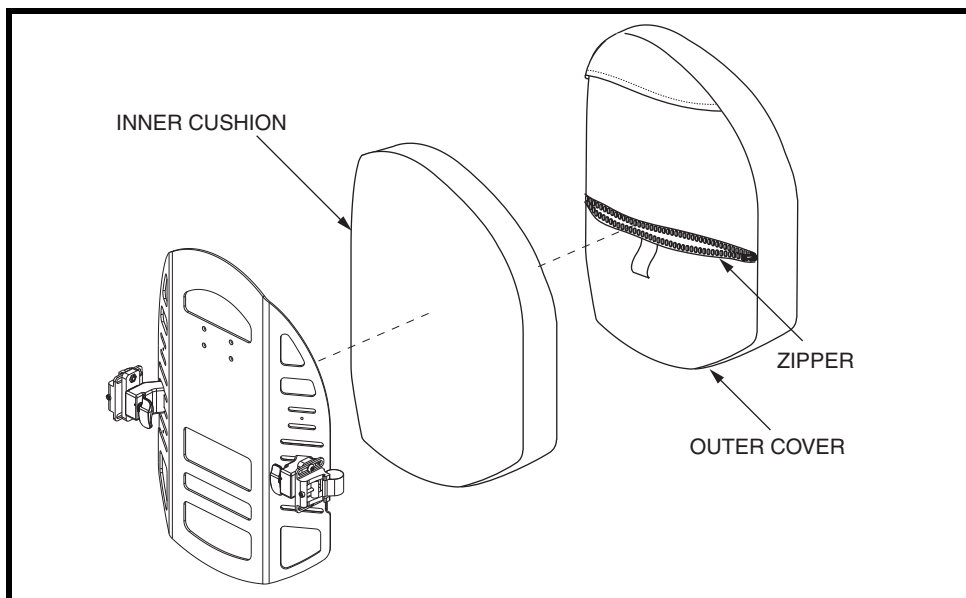

Figure 11. Shape GP Cover Removal

STORAGE

The Shape GP should not be stored in extremely hot or cold temperatures.



WARNING! Extreme temperatures can affect the temperature of your seating system components and may cause skin irritation. Use caution when your mobility product has been used or stored in an extremely hot or cold environment.

CARE AND MAINTENANCE

Your mobility product must be disposed of according to applicable local and national statutory regulations. Contact your local waste disposal agency or Quantum Rehab Provider for information on proper disposal of mobility product packaging, metal frame components, plastic components, electronics, batteries, neoprene, silicone, and polyurethane materials.

Be aware of safety issues while smoking.



WARNING! Pride strongly recommends that you do not smoke cigarettes while seated in your seating system although the seating system has passed the necessary testing requirements for cigarette smoking. You must adhere to the following safety guidelines if you decide to smoke cigarettes while seated in your seating system.

- **Do not leave lit cigarettes unattended.**
- **Keep ashtrays a safe distance from the seating system.**
- **Always make sure cigarettes are completely extinguished before disposal.**

All hardware on the Shape GP should be checked monthly to ensure that it is tight.



WARNING! Tighten any hardware immediately to prevent damage to your mobility product and personal injury to the rider or others.

Claims and repairs should be processed through the nearest Quantum Rehab Provider.

Take your mobility product to your Quantum Rehab Provider at least once a year to have a complete inspection, safety check, and for any required service. This helps ensure that your mobility product is functioning properly and helps prevent future complications.

WARRANTY

The Shape GP system is designed and produced to the highest of standards. Our Shape GP cushion is guaranteed to be free of defects in material and workmanship for a period of 24 months. The outer cover is guaranteed to be free of defects in material and workmanship for a period of 90 days. If any defect in material or workmanship is found, Pride Mobility Products will repair or replace, at our discretion, the Shape GP cushion. This warranty does not apply to cushions abused or misused by the user and deemed such by Pride Mobility Products.

NOTES

NOTES

QUANTUM[®] **REHAB**

A Division of Pride Mobility Products[®] Corp.

Pride Mobility Products Corporation

182 Susquehanna Avenue

Exeter, PA 18643-2694

USA

Pride Mobility Products Company

380 Vansickle Road Unit 350

St. Catharines, Ontario L2R 6P7

Canada

Pride Mobility Products Ltd.

32 Wedgwood Road

Bicester, Oxon OX26 4UL

UK

Pride Mobility Products Australia Pty. Ltd.

21 Healey Road

Dandenong, 3175

Victoria, Australia

Pride Mobility Products Italia S.r.l.

Via del Progresso - ang. Via del Lavoro

Loc. Prato della Corte

00065-Fiano Romano (RM)

Pride Mobility Products Europe B.V.

Castricummer Werf 26

1901 RW Castricum

The Netherlands

Pride[®]
Mobility Products Corp.



I N F M A N U 3 9 6 3