

NOTE: The following information is an addition to the “Operation” section in the lift system owner’s manual. It describes the RF wireless pendant for your lift system. You must read the lift system owner’s manual and all supplemental information before use. Please retain this information for your records, and contact your authorized Pride Provider with any questions.

RF (RADIO FREQUENCY) WIRELESS PENDANT

The RF wireless pendant was developed for your convenience.

NOTE: Only operate the lift system when the vehicle’s safety hatch is fully opened. When the hatch is closed, the safety hatch switch will activate and the lift system will not operate.

WARNING! Inspect vehicle safety latch for damage prior to lift operation. See figure 1.

WARNING! Keep the wireless pendant in your possession at all times while operating the lift system.

WARNING! Only the person operating the lift system should operate the wireless pendant.

WARNING! In the event your wireless pendant is lost or misplaced, or the vehicle safety latch is damaged, the wireless pendant should be deactivated to prevent any unintended movement and you should contact your authorized Pride Provider.

WARNING! To prevent unintended movement the RF wireless pendant should not be placed in a pocket.

WARNING! Due to the nature of the radio frequency propagations, numerous factors can affect range. Range measurements can change based on environmental conditions surrounding the lift system.

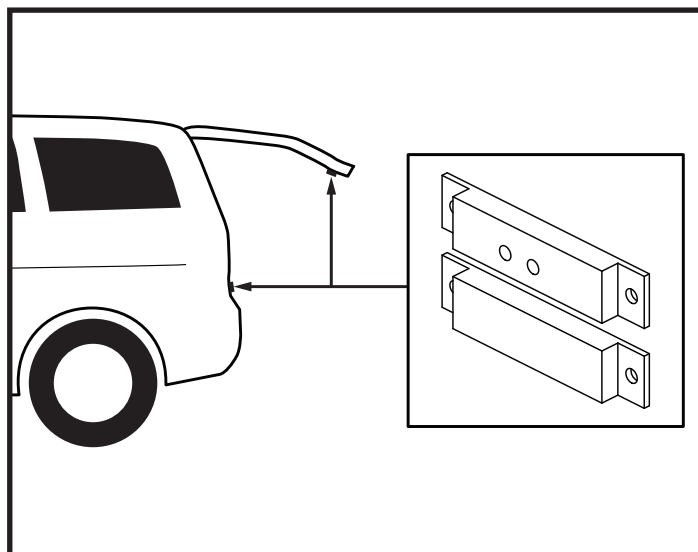

Figure 1. Safety Latch



Lock/Unlock Lift System

To lock the lift system:

1. Using the wired hand control, press and hold the left “lock” button for approximately five seconds. The puddle light will flash once, and the unit will beep once. Release the lock button.
2. Verify that the lift system is not operating by pressing the up and down buttons on the pendant and/or hand control. The lift system should not move.
3. This confirms that the lift system is locked.

To unlock the lift system:

1. Using the wired hand control, press and hold the left “lock” button for approximately five seconds. The puddle light will flash twice, and the unit will beep twice. Release the lock button.
2. Verify that both the wireless pendant and wired hand control are operating by pushing the up and down buttons on both controls. The lift system should operate normally.
3. This confirms that the lift system is unlocked.

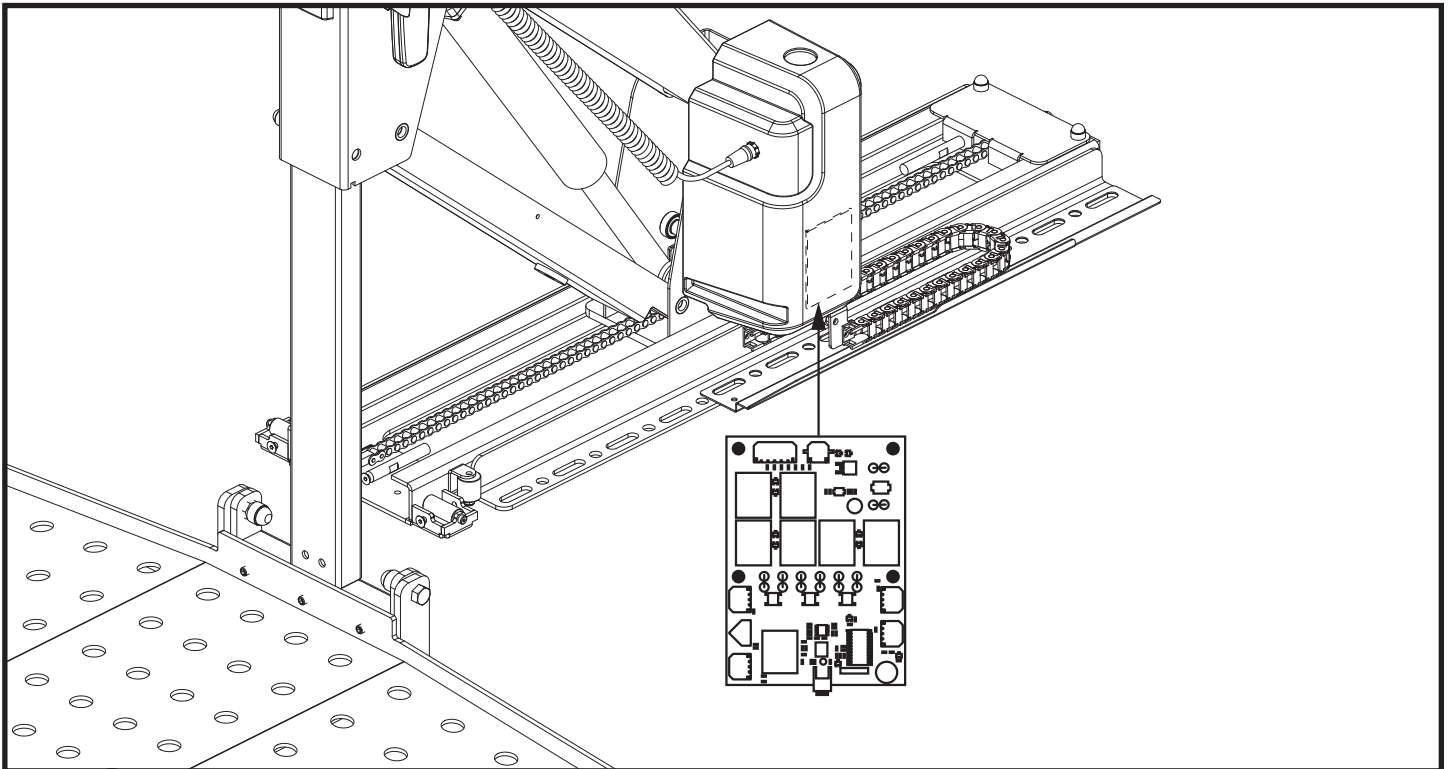

Figure 2. RF Wireless Pendant Internal Control Board Location



Deactivating your Wireless Pendant (If the Wireless Pendant is Misplaced or Lost)

To deactivate your wireless pendant:

1. Locate the black box attached to the lift mechanism. **See figure 2.** Once located, remove the four screws that hold the box into place. **See figure 3.**
2. Allow the box to tilt forward to reveal the circuit board, and locate the program button at the bottom of the board. **See figure 3.**
3. Push and **hold** down the program button for 10 seconds. The LED light inside the box will illuminate. When the LED light turns off, the receiver has been reset.
4. The wireless pendant will no longer function.

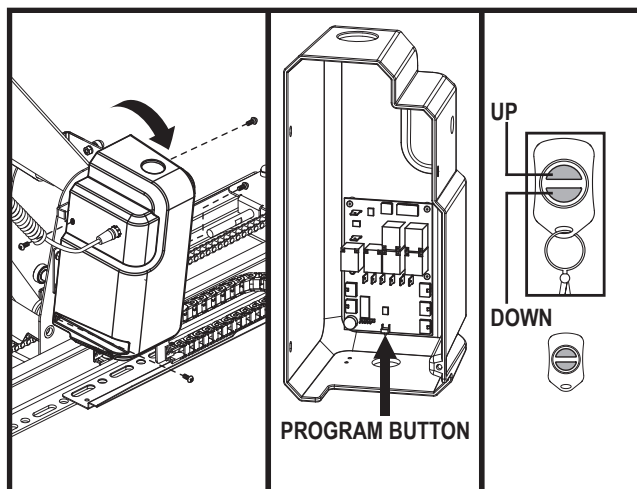

Figure 3. Receiver Chip Location

Programming the Wireless Pendant

When the wireless pendant is purchased, it will arrive preprogrammed to work with your lift system.



WARNING! Do not reprogram the wireless pendant when operating any other product that uses an RF frequency, such as another lift system or a garage door opener.

Preparing your replacement pendant:

1. Locate the small access port on the back of the replacement wireless pendant.
2. Insert a thin wire, such as a paper clip, into the access port. **See figure 4.**
3. The LED on the front of the wireless pendant will flash.
4. Press the buttons on the wireless pendant in any order.
5. Reinsert the thin wire into the access port, or wait 10 seconds until the LED stops flashing.
6. Ensure the LED on the front of the wireless pendant is no longer flashing. If the LED continues to flash, begin again with Step 2.
7. Follow steps to program the replacement wireless pendant.

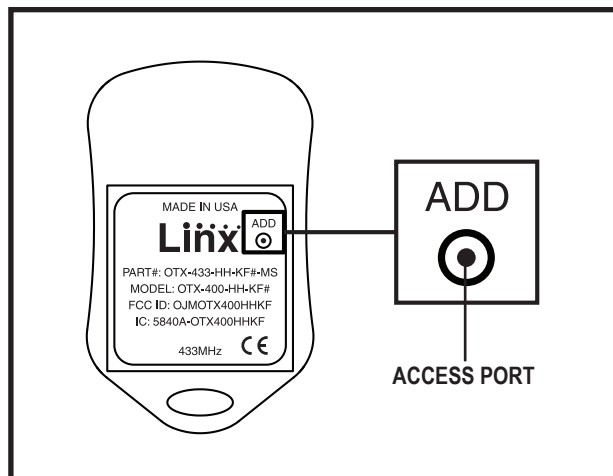

Figure 4. Access Port



To program a replacement wireless pendant:

1. Locate the black box attached to the lift mechanism. **See figure 2.** Once located, remove the four screws that hold the box into place. **See figure 3.**
2. Allow the box to tilt forward to reveal the circuit board, and locate the program button at the bottom of the board. **See figure 3.**
3. Push the button once and the LED light inside the box will start flashing. Once the LED light begins flashing, press the wireless pendant's up and down buttons one time, in either order. Push the button inside the black box again and the LED light will turn off. Once the LED light turns off, the wireless pendant is programmed for your lift system only.
4. Verify the wireless pendant is functioning by pushing the up and down buttons.
5. If the wireless pendant does not function properly, begin again with Step 3.
6. Once the wireless pendant is programmed, reinstall the four screws to hold the black box into place.

NOTE: Up to five wireless pendants can be programmed to work with your lift system at one time.

Battery Replacement

To replace the battery in the wireless pendant:

1. Remove the back by gently prying apart the two halves of the wireless pendant at the seam. Once open, the internal components of the wireless pendant move freely. Take care not to drop or lose any of the internal components.
2. Remove the coin cell battery. **See figure 5.**
3. Slide the replacement battery in, positive side up. **See figure 6.**
4. Replace the back of the wireless pendant. It will snap into place.
5. Verify the function of the wireless pendant by pushing the up and down arrow buttons.

NOTE: If there is any hesitation in the lift system's movement, the battery in the wireless pendant may need to be replaced.

NOTE: The wireless pendant battery should be replaced annually. However, if you experience diminished power or intermittent operation, replace the battery sooner.

NOTE: The wired hand control will always work regardless of the wireless pendant's battery level.

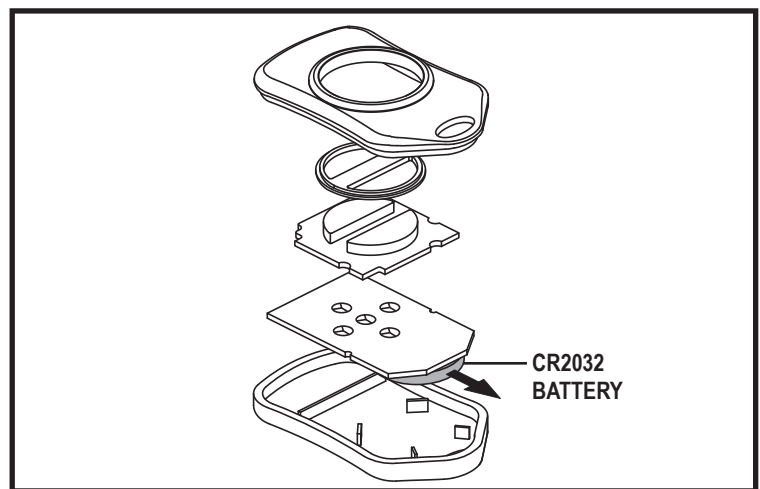

Figure 5. Battery Replacement

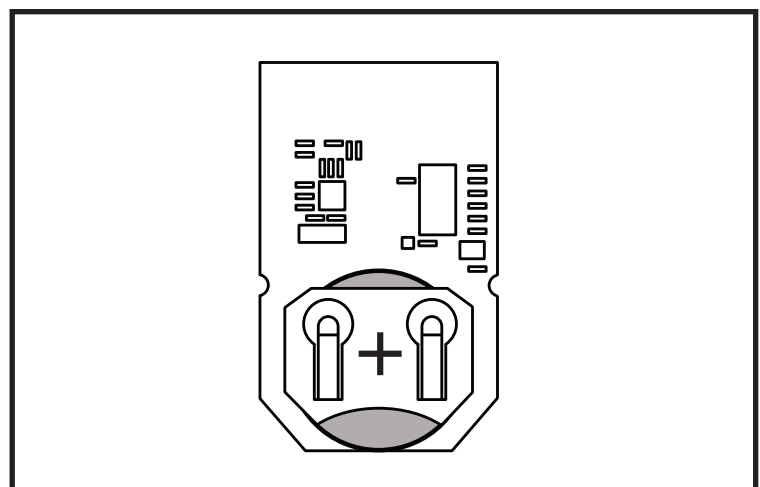

Figure 6. Battery Replacement



Wireless Pendant and Wired Hand Control

The lift system can be operated by the wireless pendant or by the wired hand control; however, both cannot be used at the same time.

Range

Continuous operation may occur up to 15 feet or more. Only the person operating the lift system should operate the wireless pendant.



WARNING! Due to the nature of the radio frequency propagations, numerous factors can affect range. Range measurements can change based on environmental conditions surrounding the lift system.

Contact with Liquids

If the wireless pendant comes in contact with liquids, remove RF wireless battery and allow the pendant to dry completely for 24-36 hours before use. If the wireless pendant continues not to function, a replacement wireless pendant may be ordered from your authorized Pride Provider. See “Programming the Wireless Pendant.”

TROUBLESHOOTING

What if my wireless pendant will not operate?

- Make sure that your vehicle’s hatch is fully open. If the safety hatch switch is activated, your lift system will not operate.
- Ensure that the wireless pendant is programmed to work with your lift system. See “Programming the Wireless Pendant.”
- If the hand control is fully operational but the wireless pendant does not work, the battery may need to be changed. See “Battery Replacement.”

What if my lift system stops working?

- Make sure the onboard battery or vehicle battery is fully charged.
- Make sure all connections to the motor and battery are secure.
- Check the wiring harness for signs of wear and decay. Contact your authorized Pride Provider to replace the harness if necessary.
- Ensure that the wireless pendant is properly programmed to the lift system. Reset the circuit board and reprogram the wireless pendant. See “Programming the Wireless Pendant.”

NOTE: *The puddle light will flash three (3) times then beep three (3) times continuously if there is a low battery voltage condition. If this occurs, your car battery or battery pack may be low. Allow the vehicle to run for 15 minutes to charge the battery, or recharge your battery pack. If the “low voltage” warning continues, contact your automotive service provider to check the battery.*



RF Wireless Pendant Warranty

All RF wireless pendants are covered against manufacturer defects by a 90-day warranty effective from date of purchase. Warranty excludes loss of pendant.

INSTRUCTION TO THE USER

This device complies with Part 15 of the FCC Rules.

Operation of this device is subject to the following two conditions:

- 1. This device may not cause harmful interference, and**
- 2. This device must accept any interference received, including interference that may cause undesired operation.**

This equipment has been tested and found to comply with the limits for a Class B digital device, pursuant to Part 15 of the FCC Rules. These limits are designed to provide reasonable protection against harmful interference in a residential installation. This equipment generates, uses, and can radiate radio frequency energy and, if not installed and used in accordance with the instructions, may cause harmful interference to radio communications. However, there is no guarantee that interference will not occur in a particular installation. If this equipment does cause harmful interference to radio or television reception, which can be determined by turning the equipment off and on, the user is encouraged to try to correct the interference by one or more of the following measures:

Reorient or relocate the receiving antenna.

Increase the separation between the equipment and receiver.

Connect the equipment into an outlet on a circuit different from that to which the receiver is connected.

Consult the dealer or an experienced radio/TV technician for help.

This equipment has been certified to comply with the limits for a Class B computing device, pursuant to FCC Rules. In order to maintain compliance with FCC Regulations, shielded cables must be used with this equipment. Operation with non-approved equipment or unshielded cables is likely to result in interference to radio and TV reception. The user is cautioned that changes and modifications made to the equipment without the approval of manufacturer could void the user's authority to operate this equipment.

NOTE: Boxed statement required for FCC compliance. Industry Canada only requires the bold text portion. EU does not require a statement.



Electromagnetic and Radio Frequency Interference (EMI/RFI)



WARNING! Laboratory tests have shown that electromagnetic and radio frequency waves can have an adverse effect on the performance of electrically powered devices, such as lift systems.

Electromagnetic and Radio Frequency Interference can come from sources such as cellular phones, mobile two-way radios (such as walkie-talkies), radio stations, TV stations, amateur radio (HAM) transmitters, wireless computer links, microwave signals, paging transmitters, and medium-range mobile transceivers used by emergency vehicles. In some cases, these waves can cause unintended movement or damage to the control system of electrically powered devices. The lift system user can help prevent electromagnetic interference by maintaining a minimum distance between portable and mobile RF communications equipment. It is recommended that at least 9 feet (3 meters) of distance be maintained between the lift system and any handheld equipment emitting 10 W or more of output power. Refer to the manufacturer's literature for the handheld device to determine the maximum output of that device. Every electrically powered device has an immunity (or resistance) to EMI. The higher the immunity level, the greater the protection against EMI. Therefore, its RF emissions are very low and are not likely to cause any interference in nearby electronic equipment, making the lift system suitable for use in all establishments.



WARNING! Be aware that cell phones, two-way radios, laptops, and other types of radio transmitters may cause unintended movement of your electrically powered device due to EMI. Exercise caution when using any of these items while operating your lift system.



WARNING! Your lift system itself can disturb the performance of other electrical devices located nearby, such as alarm systems.

NOTE: *If unintended motion occurs, discontinue use of the lift system. Contact your authorized Pride Provider to report the incident.*



