

SilverStar™

Silver Boom 130



OWNER'S MANUAL

SAFETY GUIDELINES



WARNING! An authorized Pride Provider or qualified technician must perform the initial setup of this lift and must perform all of the instructions in this manual.

The symbols below are used throughout this owner's manual and on the product to identify warnings and important information. It is very important for you to read them and understand them completely.



WARNING! Indicates a potentially hazardous condition/situation. Failure to follow designated procedures can cause either personal injury, component damage, or malfunction. On the product, this icon is represented as a black symbol on a yellow triangle with a black border.



MANDATORY! These actions should be performed as specified. Failure to perform mandatory actions can cause personal injury and/or equipment damage. On the product, this icon is represented as a white symbol on a blue dot with a white border.



PROHIBITED! These actions are prohibited. These actions should not be performed at any time or in any circumstances. Performing a prohibited action can cause personal injury and/or damage to equipment. On the product, this icon is represented as a black symbol with a red circle and red slash.

Please fill out the following information for quick reference:

Pride Provider: _____
Address: _____
Phone Number: _____
Purchase Date: _____ Serial Number: _____

NOTE: *This owner's manual is compiled from the latest specifications and product information available at the time of publication. We reserve the right to make changes as they become necessary. Any changes to our products may cause slight variations between the illustrations and explanations in this manual and the product you have purchased. The latest version of this manual is available on our website.*



Copyright © 2007
Pride Mobility Products Corp.
INFMANU3530/Rev A/February 2007

C O N T E N T S

I. INTRODUCTION.....	4
II. SAFETY	6
III. INSTALLATION	8
IV. OPERATION.....	14
V. TROUBLESHOOTING	16
VI. WARRANTY	17

I . I N T R O D U C T I O N

Welcome to Silver Star, a division of Pride Mobility Products Corporation (Pride). Congratulations on the purchase of your SilverBoom 130 lift. The SilverBoom 130 design combines the most advanced state-of-the-art components with modern, attractive styling. We are certain that the design features and trouble-free operation will add convenience to your daily living and ensure complete satisfaction.

At Pride, your safety is important to us. **Please read and follow all instructions in this manual before using your product for the first time.** These instructions were produced for your benefit. Your understanding of these instructions is essential for the safe operation of your new SilverBoom 130.

Pride is not liable for damage to property or personal injury arising out of the unsafe use of the SilverBoom 130. Pride is also not liable for any property damage or personal injury arising out of the failure of any person and/or user to follow the instructions and recommendations set forth in this manual or any other instructions or recommendations contained in other ramp related literature issued by Pride or contained on the SilverBoom 130 themselves.

INTERNET AND PRIVATE PURCHASES

If you purchased your product over the internet or from a previous owner and you have any questions about the safe use and/or maintenance of the product, please visit Silver Star's web site www.silverstarmobility.com or contact your authorized Pride Provider.

PURCHASER'S AGREEMENT

By accepting delivery of this product, you promise that you will not change, alter, or modify this product or remove or render inoperable or unsafe any guards, shields, or other safety features of this product; fail, refuse, or neglect to install any retrofit kits from time to time provided by Pride to enhance or preserve the safe use of this product.

INFORMATION EXCHANGE

We want to hear your questions, comments, and suggestions about this manual. We would also like to hear about the safety and reliability of your new SilverBoom 130, and about the service you received from your authorized Pride Provider.

Please notify us of any change of address, so we can keep you apprised of important information about safety, new products, and new options that can increase your ability to use and enjoy your new SilverBoom 130.

NOTE: If you ever lose or misplace your product registration card or your copy of this manual, contact us and we will be glad to send you a new one immediately.

I . I N T R O D U C T I O N

PRIDE OWNERS CLUB

As an owner of a Pride product, you are encouraged to enroll in the Pride Owners Club. Complete and return your enclosed product registration card or visit Pride's web site at www.pridemobility.com. As a registered member, each time you visit our site, you have access to the most interactive, educational venue available today for people with mobility needs, their families, and friends.

From our home page, select "Owners Club" to enter a page dedicated to current and potential Pride product owners. You will gain access to interviews, stories, recreation ideas, daily living tips, product and funding information, and interactive message boards. These message boards invite you to communicate with other Pride customers as well as Pride representatives who are available to assist you with any questions or concerns you may have.

NOTE: On-line product registration and enrollment in the Pride Owner's Club valid for residents of the United States, Canada, Latin America, and the Caribbean only.

II. SAFETY

PRODUCT SAFETY SYMBOLS

The symbols below are used on the mobility product to identify warnings, mandatory actions, and prohibited actions. It is very important for you to read and understand them completely.



Read and follow the information in the owner's manual.

Do not lift the mobility product while being seated in it.

Do not lift people.



Maximum lifting capacity.

Pinch/Crush points created during assembly and/or operation.

Do not lift pets.



Do not extend the lifting strap past the warning label located on it.

II. SAFETY

LIFTING CAPABILITIES

The maximum weight the SilverBoom 130 was designed to lift is 130 lbs. Under no circumstances should the SilverBoom 130 be made to lift more than 130 lbs. Subjecting the SilverBoom 130 to the strain of hoisting more than it is designed to lift may cause it to fail, damaging your mobility product, injuring the person operating the lift, or both.



WARNING! Adding accessories, oversize batteries, or a different seat will increase the weight of your mobility product. Verify with your authorized Pride Provider that the total weight of your mobility product, after the additions, does not exceed 130 lbs.

INSTALLATION

Your SilverBoom 130 system was designed to be mounted primarily in a vehicle. Mounting your SilverBoom 130 on a platform, where the height of the lift may cause the lifting strap to extend beyond a safe point, can damage the SilverBoom 130 and injure the operator of the lift. The distance between the top of the boom arm and the mobility product should not exceed 70 in. when the boom arm is fully extended.

Read and fully understand the directions for drilling the mounting holes for the SilverBoom 130 base.



WARNING! Before drilling the mounting holes in your vehicle, make absolutely certain, through a visual inspection, there are no obstructions in the path of the drill bit, such as the fuel tank, exhaust pipes, or electrical wires.

LIFTING NON PRIDE ITEMS

The SilverBoom 130 is an extremely versatile device, which users may employ to lift items other than Pride products. Pride has no control over such use, nor can Pride anticipate every possible use to which a SilverBoom 130 may be put. Lifting non-Pride products with the SilverBoom 130 is done at the operator's own risk, and Pride accepts no liability for damage or injury resulting from such use.

PRELIFT INSPECTION

Inspect the lifting strap of the SilverBoom 130 before every use for twisting, fraying, and signs of wear. If signs of wear become evident, have the strap replaced by your authorized Pride Provider.



WARNING! A frayed or worn lifting strap can snap, resulting in damage to the mobility product being lifted and injury to the lift operator.

To find the weight of the mobility product you are lifting, refer to its owner's manual.

OPERATOR POSITIONING

Keep hands clear of the lifting strap while the SilverBoom 130 is lifting/lowering a mobility product. The operator of the lift should stand a safe distance from the unit being lifted/lowered to ensure that his/her feet are never positioned under a raised mobility product.

TRANSPORT VEHICLE POSITIONING

Be sure your vehicle is parked on flat, level ground before attempting to lift a mobility product.



WARNING! Attempting to lift a mobility product when a vehicle is not on level ground will cause the mobility product to swing toward or away from the vehicle, making it difficult to get the mobility product into the vehicle.

III. INSTALLATION

The SilverBoom 130 can be installed in either side of your vehicle. The illustrations demonstrate installation on the right side.

NOTE: Most roads have a crown to help with water runoff. However, if the crown is severe enough, it may cause difficulty getting your mobility product into the vehicle. In this case it may be better to install the lift on the left side.

DETERMINE L-BASE LOCATION

1. Assemble the L-Base. See **figure 1**. For optimal use, insert the base extensions into the L-base at their farthest extension point and install the hardware (nuts and bolts). The base extensions can be adjusted to accommodate obstructions.

NOTE: Always insert the bolt from the inside of the L-base. This allows the base extensions to be properly tightened without rattling.

2. Before permanently installing the lift, place the L-base inside your vehicle in the area in which you intend to install it. See **figure 2** for L-base positioning in vehicles with hatchbacks, or **figure 3** for trunk installation.

Positioning the L-base close to the rear allows the boom-arm to stay as short as possible; this enables the boom arm to swing freely without making contact with the vehicle.

VEHICLES WITH TRUNKS

Position the L-base as shown in **figure 3**. You may need to situate the L-base so the wheel well doesn't interfere with the L-base extensions. Ensure there is adequate room for a mobility product to comfortably fit into the trunk.

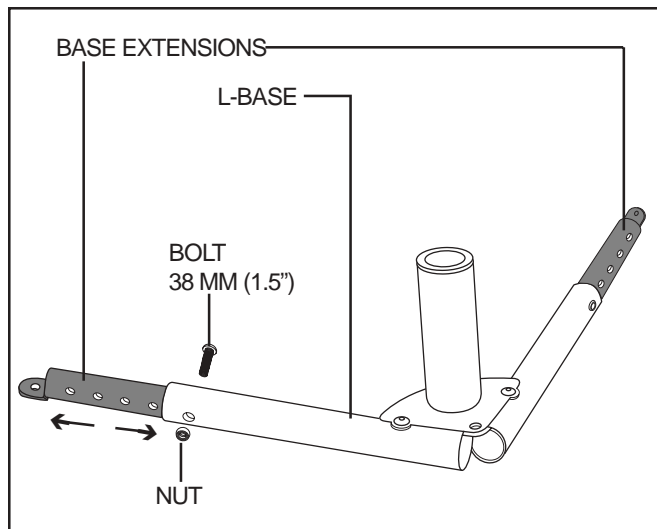

Figure 1. L-Base Extensions

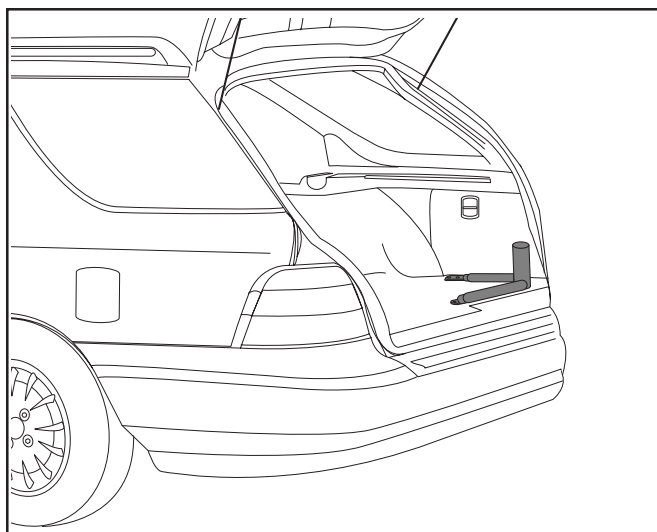

Figure 2. L-Base (Hatchback Installation)

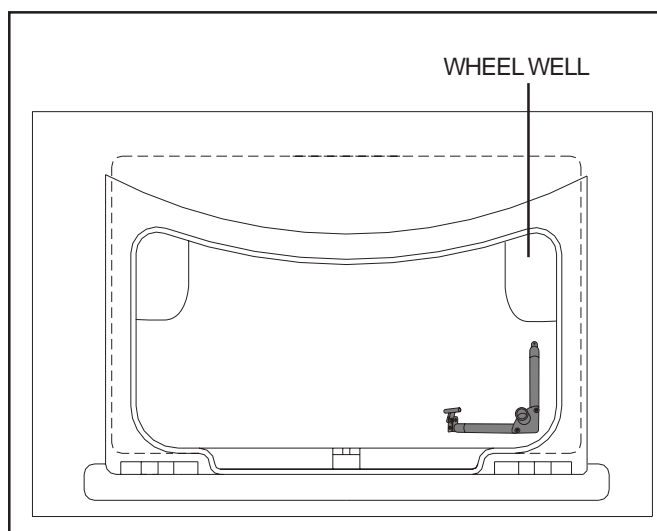

Figure 3. L-Base (Trunk Installation)

III. INSTALLATION

ASSEMBLING THE LIFT

1. Insert the upper post into the L-base. **See figure 4.**
2. Assemble the split ring collar. **See figure 5.**
3. Slide the split ring collar over the upper post and tighten both screws (a good starting point is approximately 12 in. down from the top of the upper post). **See figure 4.** To ensure safe operation, the split ring collar must be secured no closer than 5 in. from the top of the upper post.



WARNING! Failing to tighten both screws of the split ring collar could cause damage to your lift, mobility product, and vehicle.

NOTE: *The split ring collar may need to be adjusted down so the boom arm has sufficient head room to swing into a vehicle, or adjusted up so the mobility product being lifted has ample room to clear obstructions.*

4. Lower the motor housing over the upper post until it rests on the split ring collar. **See figure 6.**



WARNING! Prevent injury! Keep hands clear of the upper post when lowering the motor housing.



WARNING! The lift will be top heavy until mounted securely. Get assistance to help stabilize the lift while swinging the boom arm.

VEHICLES WITH HATCHBACKS - MINI VANS, STATION WAGONS, ETC.

Once the lift is assembled and seated on the L-base, close the hatch slowly to make sure the lift doesn't make contact with it. If the lift is too close to the rear, adjust its position slightly until the hatch can close without making contact with the lift. Positioning the L-base close to the rear allows the boom-arm to stay as short as possible. This enables the lift to swing into the vehicle without contacting the far side of the vehicle.

You may need to adjust the height of the motor housing (see figures 6 and 7) or the length of the boom-arm (see figure 8) so the boom arm can swing freely without hitting at any point inside the vehicle.

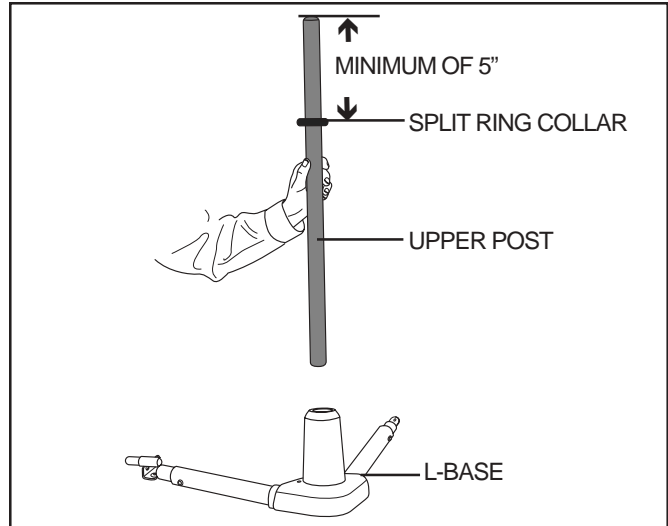

Figure 4. Upper Post Installation

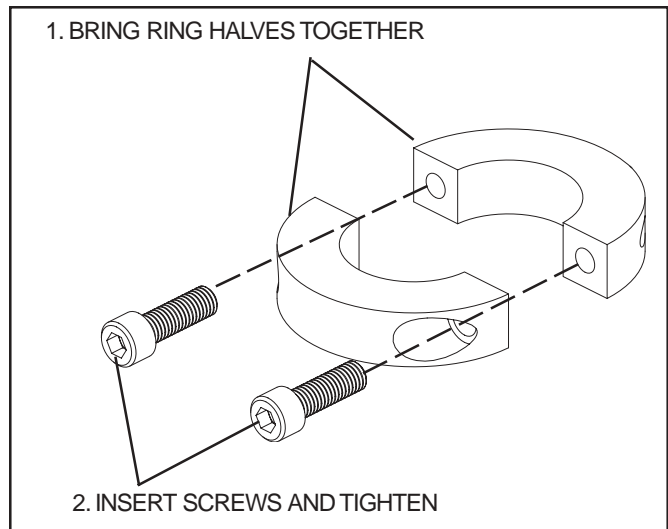

Figure 5. Split Ring Collar Assembly

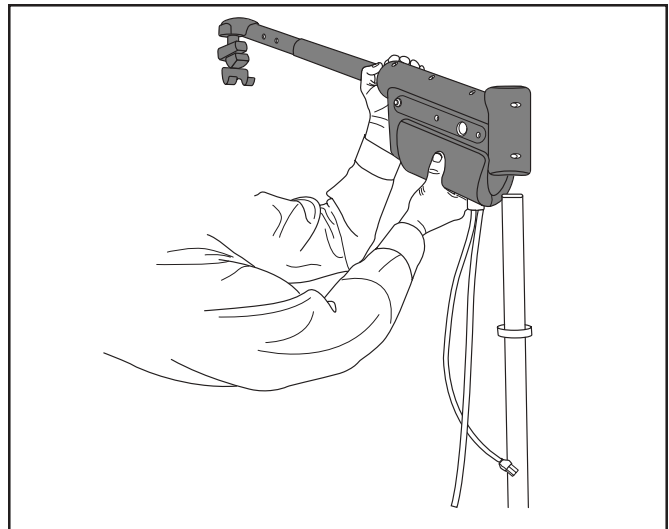

Figure 6. Motor Housing Installation

III. INSTALLATION

2. If all is clear under the L-base, mark the position of the five (5) mounting holes and drill them using a 3/8-in. drill bit. Drill all mounting holes from inside the vehicle. **See figure 9.**
3. Reinstall the L-base and align the mounting holes of the L-base with the holes you just drilled.
4. Position the T-bar on the end of the base support that runs parallel with the rear of the vehicle, and install a mounting bolt and washer through it and the L-base. **See figure 9.**

NOTE: The T-bar need only be installed in van or SUV installations. When the lift is installed inside a trunk, it is necessary to remove the motor housing and upper post for the trunk to close.

5. Install the four (4) remaining mounting bolts and washers onto the L-base.

NOTE: Choosing the correct length bolt allows enough bolt-thread to pass through the undercarriage, ensuring enough room for the mounting washer and nut to be installed securely.

6. From under the vehicle, install the mounting washers and nuts to all five (5) mounting bolts and tighten. **See figure 9.**

NOTE: The two holes in the mounting washers are for working around obstructions. Choose the hole that best works in the area you are installing the mounting bolts.

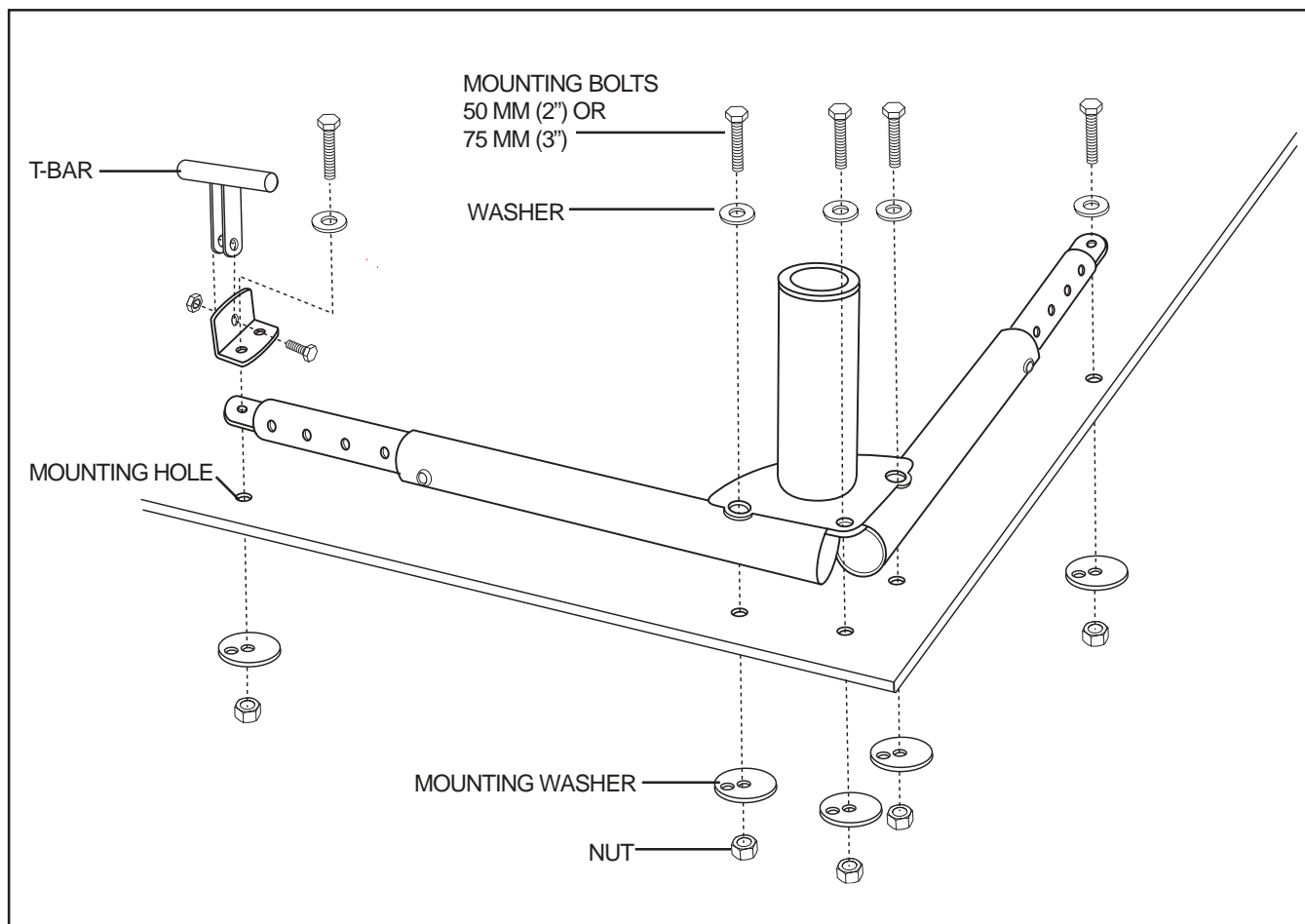

Figure 9. Securing The L-Base

III. INSTALLATION

7. Place the L-base cap over the L-base and secure it with the supplied screws. **See figure 10.**
8. Reinstall the upper post.
9. Reinstall the motor housing and make adjustments as necessary.

The lift is now fully assembled. **See figure 11.**

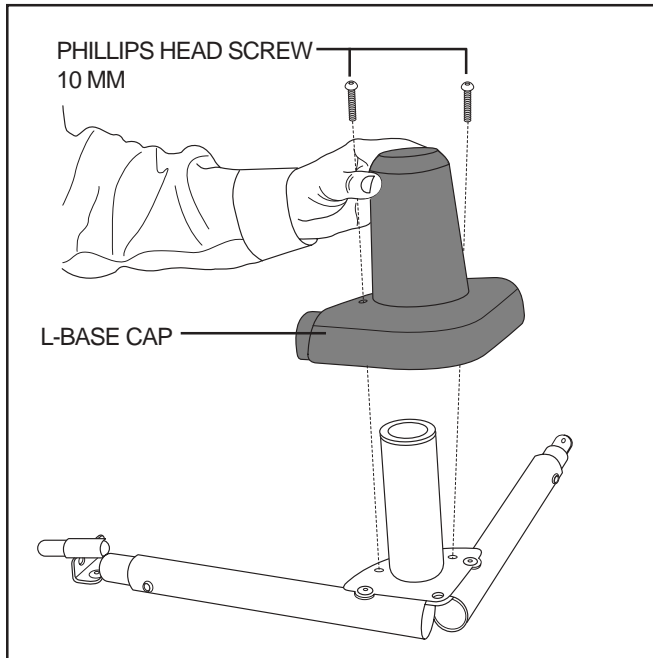

Figure 10. L-Base Cap

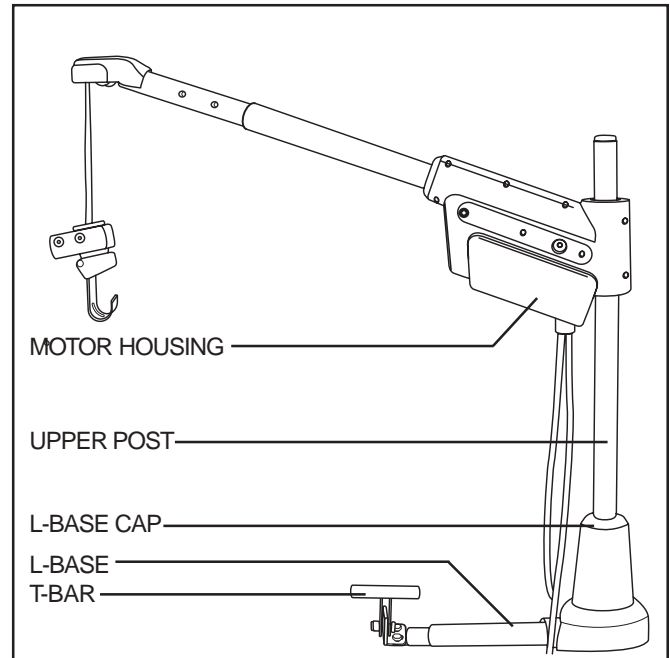

Figure 11. Fully Assembled Lift

ELECTRICAL WIRING INSTALLATION

1. Route the lift's long red positive (+) power wire (starting at the lift) through the interior of the vehicle until you reach the automobile battery. **See figure 12.** Conceal the wire behind or under the interior panels (there should be existing holes). Be certain that the wire is protected with a rubber grommet when passing it through the metal panels and into the engine compartment. Inside the engine compartment, secure the wire to the firewall and the inner fender with the supplied plastic wire ties. Use care not to cause abrasions to the power wire. It is important to secure the power wire at various points along its run.



WARNING! The red positive (+) wire must be connected directly to the positive (+) battery terminal.

2. Connect the short portion (with fuse) of the red positive (+) power wire to the positive (+) battery terminal.
3. Insert the end of the long portion of the red power wire into the yellow connector of the short portion and crimp it securely. Once crimped, pull on the wire gently to ensure a good connection. Wrapping the connector with electrical tape will help prevent moisture from corroding the connection.

III. INSTALLATION

4. Connect the short black (ground) wire to a clean, bare metal area of the vehicle using the 12 mm (1/2 in.) sheet metal screw provided. Mount to an area close to the base of the lift. This allows adequate slack in the wire to make the harness connections.
 - Drill a 1/16-in. pilot hole where the ground wire will be attached to the vehicle.
 - Insert the screw through the ring at the end of the black (ground) wire and install the screw into the pilot hole.



WARNING! DO NOT attach the black (ground) wire to the lift.

5. Connect the harness of wires leading to the battery and ground to the harness that extends from the motor housing (black to black and red to red).

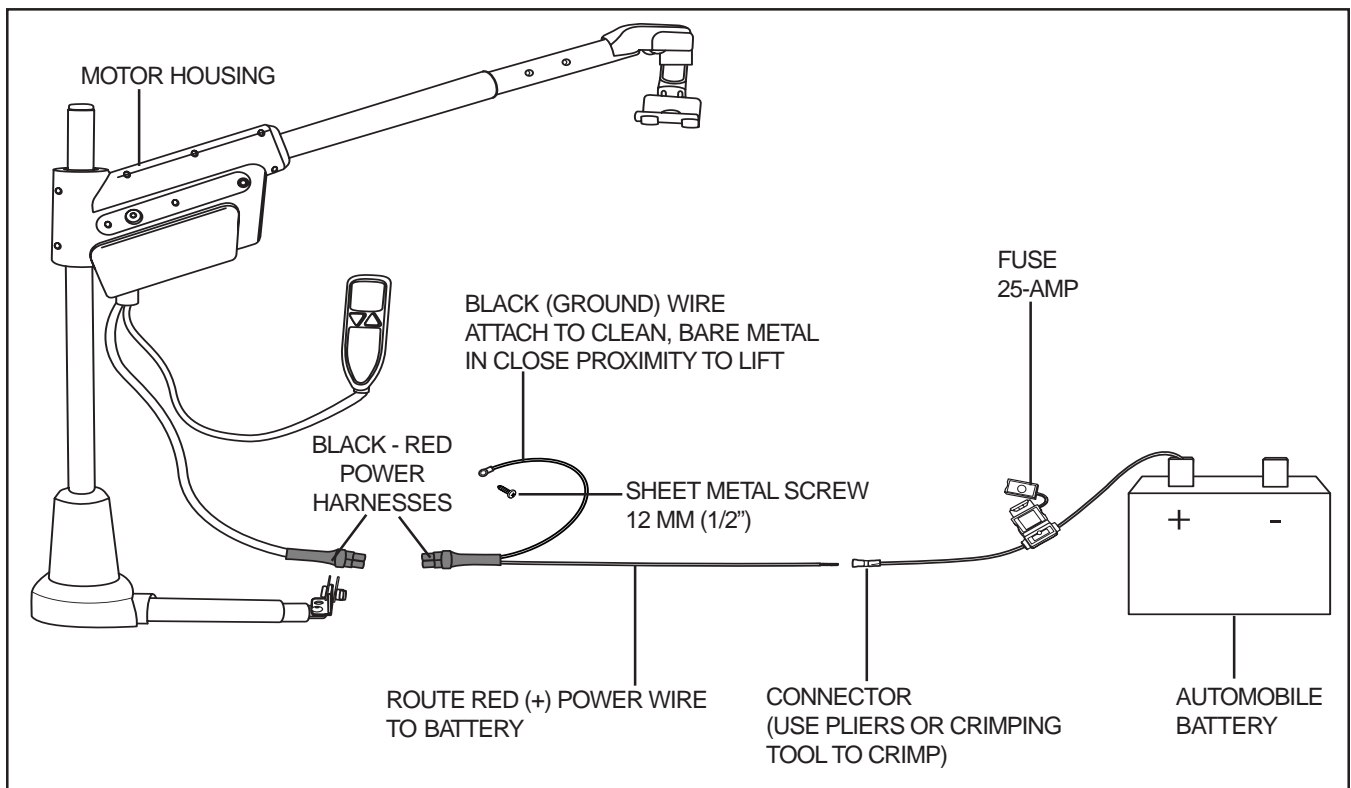

Figure 12. Electrical Wiring Connections

IV. OPERATION

LIFTING THE MOBILITY PRODUCT



WARNING! Before operating the SilverBoom 130 for the first time, be absolutely sure you have the proper docking device for your mobility product.

1. Position your mobility product (if lifting a scooter, ensure the key is removed and the tiller is fully lowered; if lifting a power chair, ensure the power is off) on the ground behind the installed lift. Be sure that there is ample space between the mobility product and the vehicle bumper to ensure that the mobility product will not hit the bumper while being raised. If the mobility product is too far from the vehicle's bumper, the mobility product will be dragged when attempting to lift it.
2. Position the boom arm over the mobility product.
3. Operate the lift (use the hand control—see **figure 13**) in the downward direction until the lifting hook reaches the T-bar. The lift strap should drop straight down to the T-bar. See **figure 14**.



WARNING! Inspect the lifting strap before each use for twisting, fraying, and signs of wear.

- Keep tension on the lifting strap with your free hand when lowering the lifting hook.
- Lower the lifting hook only to the T-bar of the docking device.



WARNING! Do not extend the lifting strap past the warning label located on it. See **figure 15**.

4. Place the lifting hook onto the docking device T-bar. See **figure 14**.
5. Operate the lift in the upward direction.



WARNING! Always keep hands clear of the lifting strap while the SilverBoom 130 is lifting/lowering a mobility product. The operator of the lift should stand a safe distance away from the mobility product being lifted/lowered to ensure that feet are never positioned under a raised mobility product.

Do not drag the mobility product into position using the lift. If dragging occurs, your mobility product is too far away from the vehicle. To prevent dragging:

- Release the lifting strap tension then remove

PRESS TO OPERATE LIFT IN A DOWNWARD DIRECTION PRESS TO OPERATE LIFT IN AN UPWARD DIRECTION

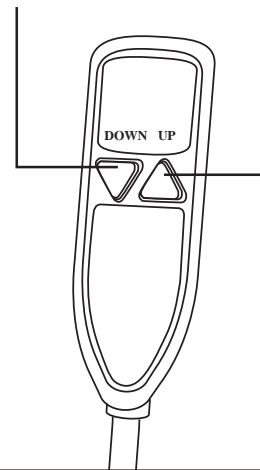

Figure 13. Hand Control

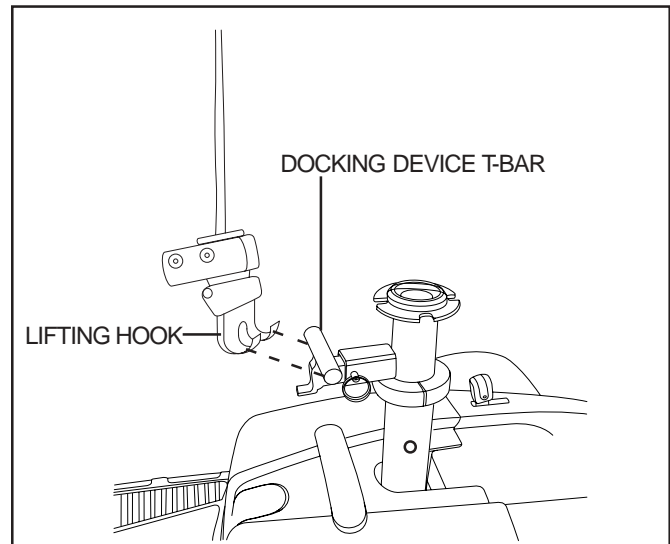

Figure 14. Lifting Hook Placement

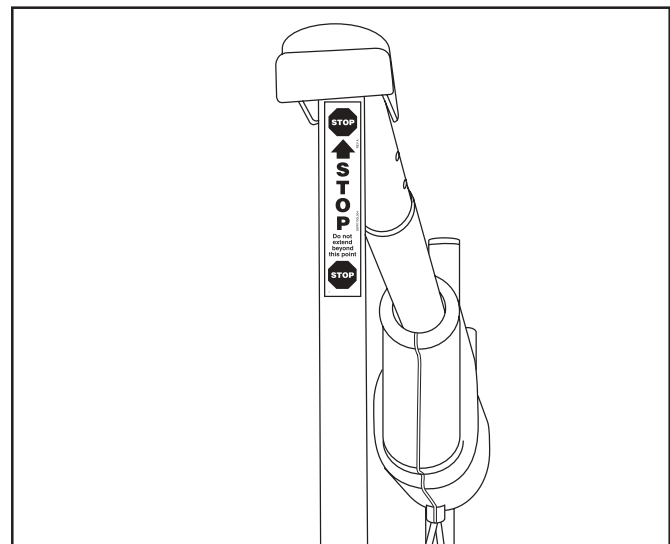

Figure 15. Lifting Strap Warning Label

IV. OPERATION

the hook from the docking device.

- Reposition the mobility product.
- Attempt the lift again.



WARNING! The maximum weight the SilverBoom 130 was designed to lift is 130 lbs. Subjecting the SilverBoom 130 to the strain of hoisting more than it is designed to may cause it to fail, damaging your mobility product, injuring the person operating the lift, or both.

6. If the mobility product begins to tilt, lower it completely and adjust the docking device by moving the pick-up bar in the direction of the tilt (*when using a C-arm*).
7. Tighten the pick-up bar once the proper balance point has been found (*when using a C-arm*).
8. Once the mobility product is raised high enough to fit into the vehicle, stop the lift. **See figure 16.**
9. Swing the boom arm toward the vehicle. When the mobility product is securely in the vehicle, lower the lift strap until all of the mobility product's wheels are on a solid surface.
10. If installed in a van, disconnect the hook from the docking device and attach it to the T-bar on the base extension. (This prevents the boom arm from swinging freely while the automobile is in motion.) Operate the lift in the upward direction until the strap is snug. **See figure 17.**

WARNING! When transporting the lift, secure the boom arm to prevent it from rotating in any direction. A swinging boom arm can be a hazard. If you can't secure the boom arm to prevent it from swinging freely, remove the motor housing and lay it flat inside the vehicle.



WARNING! Do not overtighten the strap. Doing so may put unwanted strain on the motor, causing the circuit breaker to trip.

NOTE: *If installed in a trunk, disconnect the black-red power harness (see figure 12) and remove the motor housing and upper post and place it in an area where it will be secure. The height of the boom arm will not allow the trunk to close.*

11. Disconnect the power to the SilverBoom 130 to prevent any accidental movement when transporting your mobility product.



WARNING! Your SilverBoom 130 was designed to be mounted primarily in a vehicle. Mounting your SilverBoom 130 on a platform, where the height of the lift may cause the lifting strap to extend beyond a safe point, can damage the SilverBoom 130 and injure the operator of the lift.

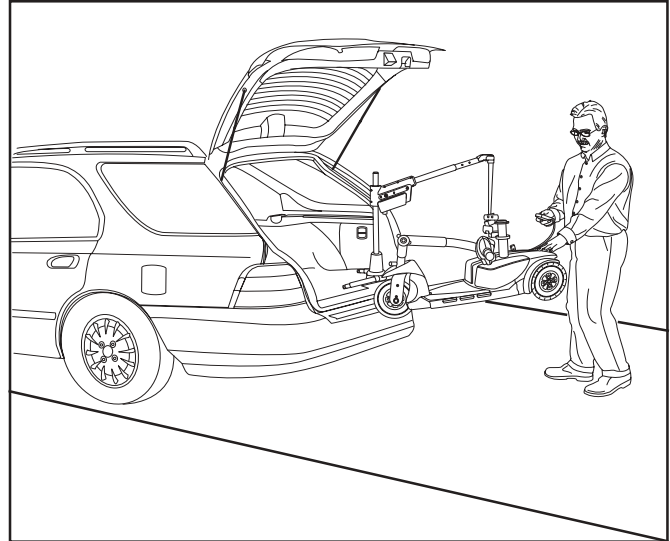

Figure 16. Lifting The Mobility product

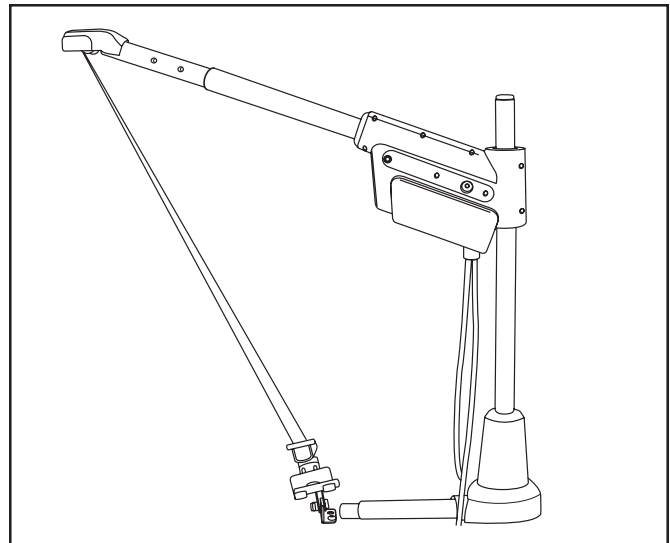

Figure 17. Securing The Boom Arm

V. TROUBLESHOOTING

LIFT WILL NOT OPERATE

- Check the circuit breaker reset button. Reset if necessary. **See figure 18.**
- Ensure all harness connections are secure.
- Ensure the power wire leading to the positive battery terminal is tight and not corroded.
- Check the fuse located on the red power wire near the battery. If blown, replace with a new 25-amp fuse. **See figure 19.**



WARNING! Do not use a higher rated fuse than 25-amp. Doing so may damage the lift's electrical system.

LIFT STOPS OPERATING

If your SilverBoom 130 is heavily strained because of excessive loads, the main circuit breaker (**see figure 18**) may trip to protect the motor and electronics from damage. When the breaker trips, the entire electrical system shuts down.



WARNING! Never attempt to lift more than 130 lbs. with the SilverBoom 130.

To reset the main circuit breaker:

1. Allow a minute or so for the electronics to “cool.”
2. Push in the reset button to reset the breaker.

If the breaker trips frequently, contact your authorized Pride Provider.

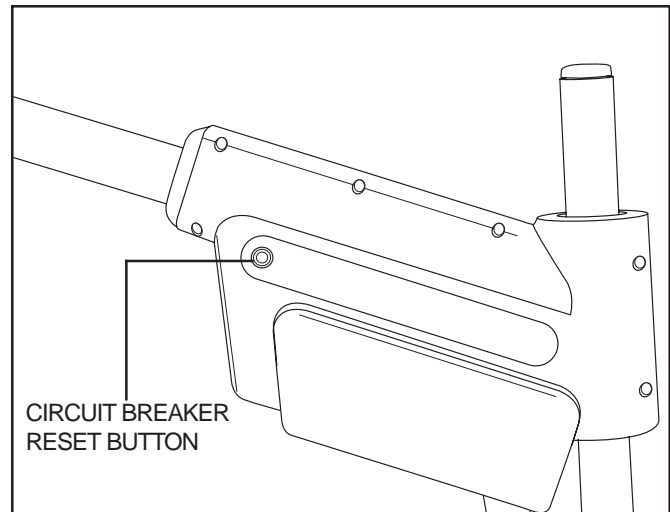

Figure 18. Circuit Breaker Reset Button

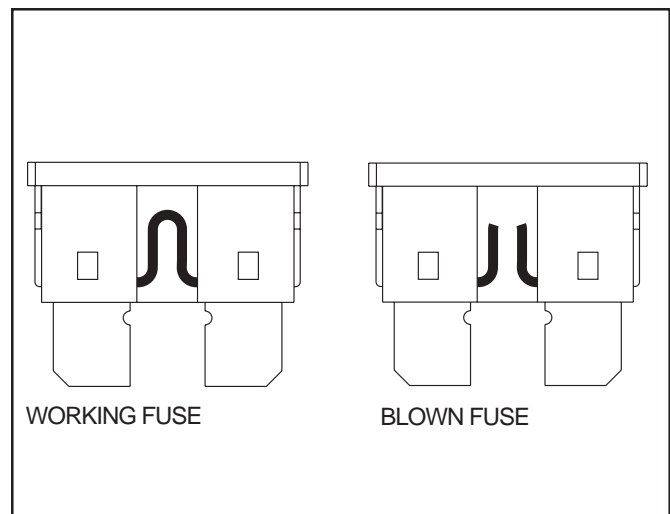

Figure 19. Fuse Replacement

LIFTING STRAP TRAVELS IN THE OPPOSITE DIRECTION OF THE BUTTON BEING PUSHED ON HAND CONTROL

Before each use, check that the lifting strap is traveling in the proper direction. If the belt travels in the wrong direction when you press either the up or down button, you must restore proper lifting strap travel.

To restore proper lifting strap travel:

1. Pull slightly on the strap and operate the lift until the strap is extended completely past the “stop” warning label.
2. Allow the strap to rewind itself. Do not allow any twists in the belt.

Observe the travel of the belt: it should correspond with the button being pushed on the hand control. If you are still experiencing problems, contact your authorized Pride Provider.

V I . W A R R A N T Y

ONE YEAR LIMITED WARRANTY

For one year from the date of purchase, Pride Mobility Products Corporation will repair or replace at our option to the original purchaser, free of charge, any of the following parts found upon examination by an authorized representative of Pride Mobility Products Corporation to be defective in material and/or workmanship:

- Main frame
- Electronic switch assemblies
- Motor/gearbox assembly

Warranty service can be performed by an authorized Pride Provider or by Pride Mobility Products Corporation. Do not return faulty parts to Pride Mobility Products Corporation without prior consent. All transportation costs and shipping damage incurred while submitting parts for repair or replacement are the responsibility of the original purchaser.

WARRANTY EXCLUSIONS

Damage caused by:

- Abuse, misuse, accident, or negligence.
- Improper operation, installation, maintenance, or storage.
- Commercial use or other than intended use.
- Repairs and/or modifications made to any part without specific consent from Pride Mobility Products Corporation.
- Circumstances beyond the control of Pride.

Labor, service calls, shipping, and other charges incurred for repair of the product unless specifically authorized by Pride.

There is no other express warranty.

Implied warranties, including those of merchantability and fitness for a particular purpose, are limited to one year from the date of purchase and to the extent permitted by law. Any and all implied warranties are excluded. This is the exclusive remedy. Liabilities for consequential damages under all warranties are excluded. Some states do not allow limitations on how long an implied warranty lasts or do not allow the exclusion of limitation of incidental or consequential damages, so the above limitation or exclusion may not apply to you. This warranty gives you specific rights and you may also have other rights, which vary from state to state.

Please fill out and return the warranty card to Pride. This will aid Pride in providing the best possible technical and customer service.



SilverStar[™] 
A Division of Pride Mobility Products[®] Corp.

Pride Mobility Products Corp.
182 Susquehanna Avenue
Exeter, PA 18643
www.pridemobility.com
www.silverstarmobility.com

I NFMANU3530