

# QUICK REFERENCE GUIDE:

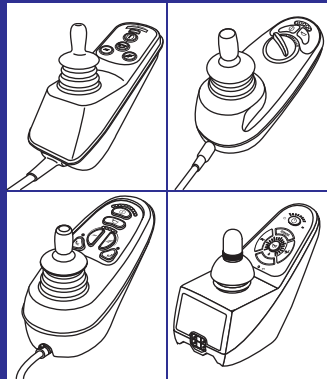

## Lock/Unlock Instructions

INFINFB2311/Rev. B/May 2009

### VSI CONTROLLER



#### INDICATION



Profile LEDs scroll left to right.

#### TO UNLOCK:

Push joystick forward until beep then pull joystick back until beep. Unit is now unlocked.

#### TO LOCK:

Hold On/Off Key  until beep, then release. Push Joystick forward until beep, then pull Joystick back until beep. There will be a long beep indicating unit is locked.

### GC/GC2 CONTROLLER

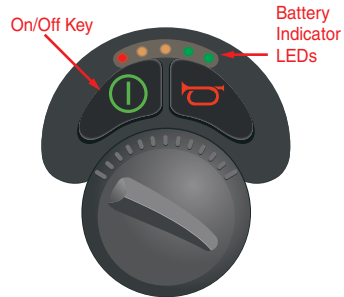

#### INDICATION

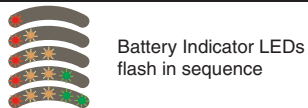

Battery Indicator LEDs flash in sequence

#### TO UNLOCK:

Hold joystick forward until beep, then pull joystick back until beep. Unit is now unlocked.

#### TO LOCK:

While powered on, hold On/Off Key  until beep, then release. Push Joystick forward until beep, then pull Joystick back until beep. Unit is now locked.

### VR2 CONTROLLER

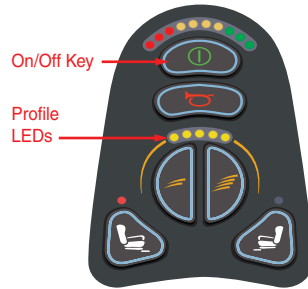

#### INDICATION



Profile LEDs scroll left to right.

#### TO UNLOCK:

Hold Joystick forward until beep, then pull Joystick back until beep. There will be a long beep indicating unit is unlocked.

#### TO LOCK:

While powered on, hold On/Off Key  until beep, then release. Push Joystick forward until beep, then pull Joystick back until beep. Unit is now locked.

### DYNAMIC CONTROLLER

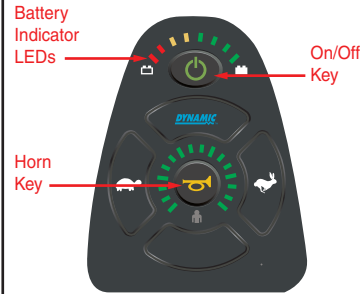

#### INDICATION



Battery Indicator LEDs scroll right to left.

#### TO UNLOCK:

Press the Horn Key  twice during the 10 seconds (approximately) that the indicator LEDs are scrolling. The controller is now unlocked.

#### TO LOCK:

While the power is on, press and hold the On/Off Key  for 4 seconds. The display will turn off immediately. After 4 seconds, all LEDs will flash briefly and the horn will sound a short beep.

# QUICK REFERENCE GUIDE:

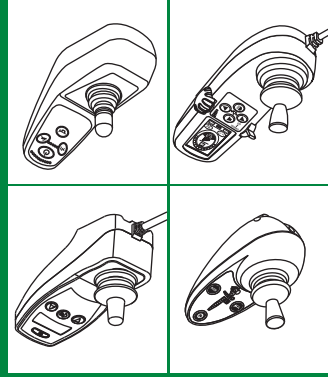

# Lock/Unlock Instructions

INFINIB2311/Rev. B/May 2009

## REMOTE PLUS CONTROLLER

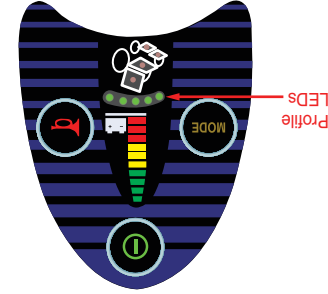

### INDICATION

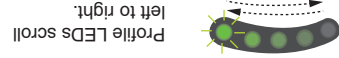

### TO UNLOCK:

Insert and then remove special 3-pin key to unlock, or unplug joystick cable to reset.



### TO LOCK:

Insert and then remove special 3-pin key to lock.



## NE+ CONTROLLER

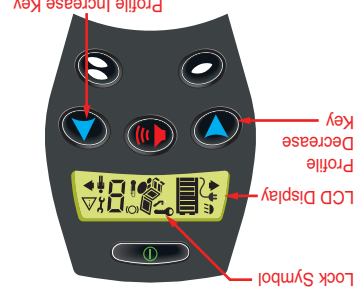

### INDICATION



Lock Symbol flashes

### TO UNLOCK:

Push joystick forward until beep, release joystick to center, pull joystick back until beep. Unit is now unlocked.

### TO LOCK:

Hold Profile Increase and Profile Decrease keys together until unit turns off. Unit is now locked. (The controller must be programmed for lock)

## G-LOGIC CONTROLLER



### INDICATION



LCD Display states "System Lock"

### TO UNLOCK:

Push joystick forward until beep, release joystick to center, pull joystick back until beep. Unit is now unlocked.

### TO LOCK:

Push Mode Select Lever forward until unit shuts off. Use an external switch or set a profile to AUX and lock will appear in AUX menu. (Must be programmed for lock)

## FLIGHT CONTROLLER

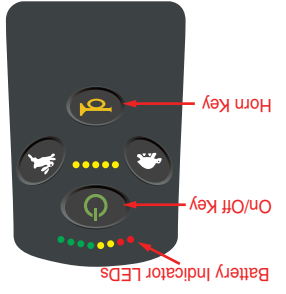

### INDICATION



Battery Indicator LEDs will scroll from right to left.

### TO UNLOCK:

Press the Horn Key twice before the LED ripple has completed, approximately 10 seconds. The unit is now unlocked.

### TO LOCK:

Press and hold the On/Off Key immediately. After 2 seconds, all LEDs will flash briefly and the horn will sound a short beep. Unit is now locked.